

NOTE:
Hypsograph does not include
Mud Lakes

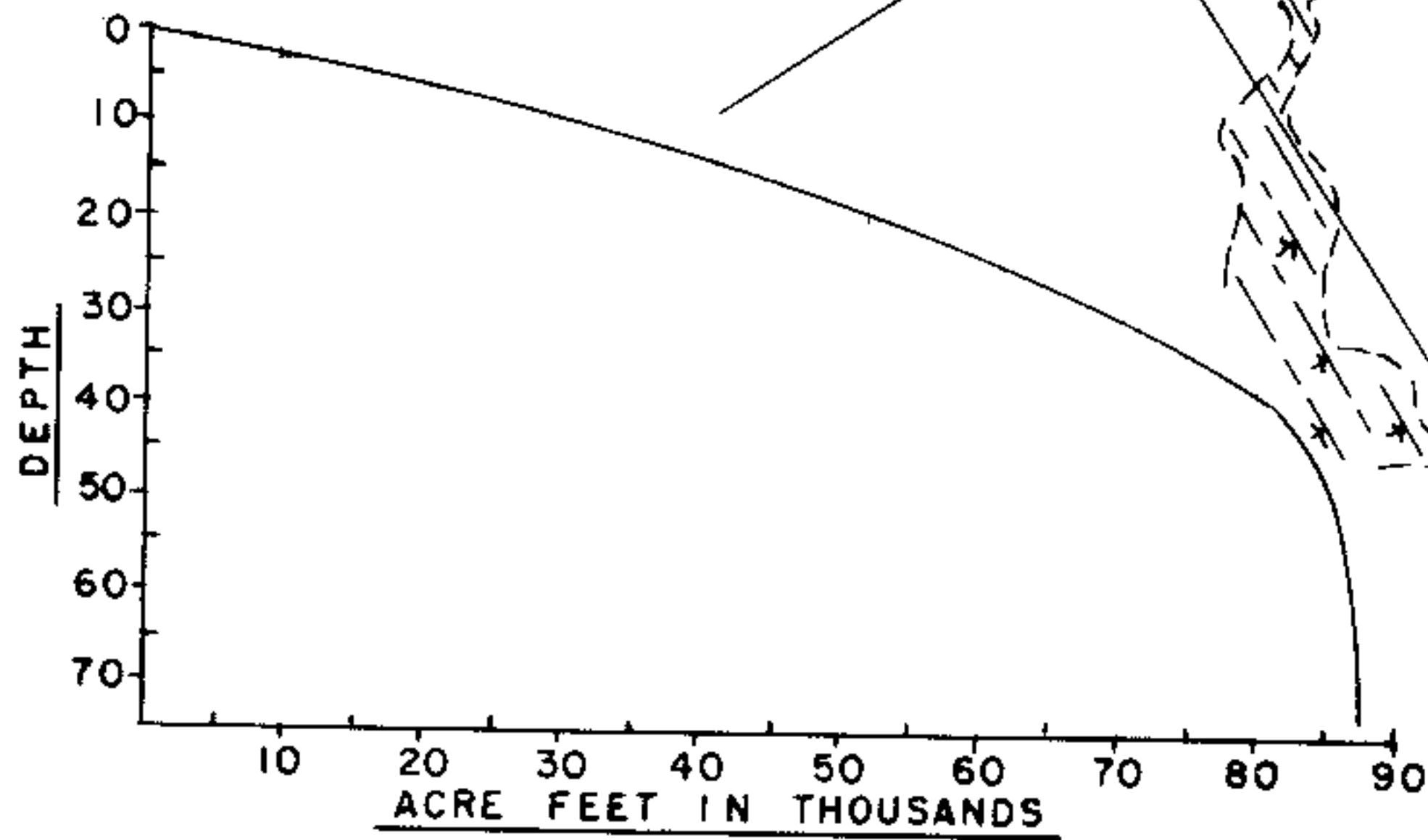

EQUIPMENT RECORDING SONAR MAPPED SEPTEMBER 1965
MO. YR.

WATER ELEV. 96.30'

- TOPOGRAPHIC SYMBOLS
- (B) Brush
 - (PW) Partially wooded
 - (W) Wooded
 - (C) Cleared
 - (P) Pastured
 - (A) Agricultural
 - B.M. Bench Mark
 - Dwelling
 - Resort
 - ||||| Steep slope
 - - - Indefinite shoreline
 - Marsh
 - o Spring
 - - - Intermittent stream
 - Permanent inlet
 - Permanent outlet
 - Dam

- LAKE BOTTOM SYMBOLS
- P. Peat
 - Mk. Muck
 - C. Clay
 - M. Marl
 - Sd. Sand
 - St. Silt
 - Gr. Gravel
 - R. Rubble
 - Br. Bedrock
 - T Submergent vegetation
 - ↓ Emergent vegetation
 - ⊃ Floating vegetation
 - o Stumps & Snags



◇ Access ◇ Access with Parking ◆ Boat Livery
Field work by G. Miller, C. Olson, L. Sather Drawn by E. Eaton

SPECIES OF FISH		
	Abundant	Rare
Muskie		
N Pike	X	
Walleye	X	
L.M. Bass	X	
S.M. Bass	X	X
Panfish	X	
Trout		
Cisco	X	

3,333.2 WITH ISLANDS
AREA 3,289.7 ACRES
UNDER 3FT. 5 %
OVER 20FT. 63 %
VOLUME 86,967 ACRE FT.
TOTAL ALK. 86 P.P.M.
SHORELINE 35.6 MILES
MAX. DEPTH 74 FEET

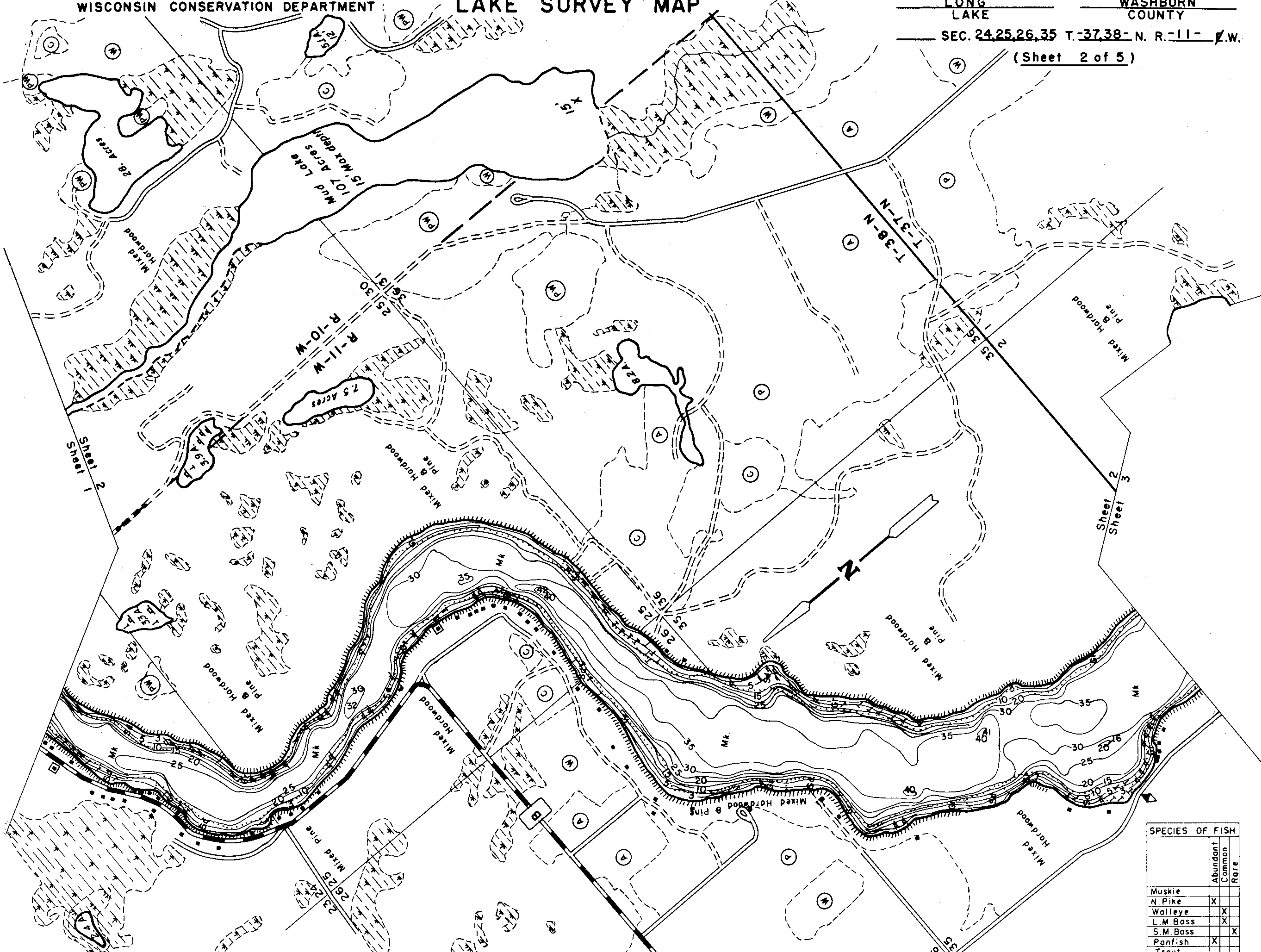

EQUIPMENT RECORDING SONAR MAPPED SEPTEMBER 1965
MO. YR.

- TOPOGRAPHIC SYMBOLS
- (B) Brush
 - (PW) Partially wooded
 - (W) Wooded
 - (C) Cleared
 - (P) Pastured
 - (A) Agricultural
 - B.M. Bench Mark
 - Dwelling
 - Resort
 - ||||| Steep slope
 - ~ Indefinite shoreline
 - Marsh
 - Spring
 - Intermittent stream
 - Permanent inlet
 - Permanent outlet
 - Dam

WATER ELEV. 96.30'

- LAKE BOTTOM SYMBOLS
- P. Peat
 - Mk. Muck
 - C. Clay
 - M. Marl
 - Sd. Sand
 - St. Silt
 - Gr. Gravel
 - R. Rubble
 - Br. Bedrock
 - T. Submergent vegetation
 - Emergent vegetation
 - Floating vegetation
 - Stumps & Snags

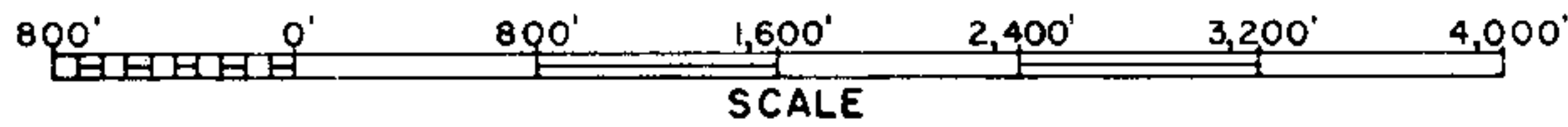

◇ Access ◇ Access with Parking ◇ Boat Livery
Field work by G. Miller, C. Olson, L. Sother. Drawn by E. Eaton

SPECIES OF FISH		
	Abundant	Rare
Muskie		
N Pike	X	
Walleye	X	
L.M. Bass	X	
S.M. Bass	X	X
Panfish	X	
Trout		
Cisco	X	

3,333.2 WITH ISLANDS
AREA 3,289.7 ACRES
UNDER 3FT. 5 %
OVER 20FT. 63 %
VOLUME 86,967 ACRE FT.
TOTAL ALK. 86 PPM
SHORELINE 38 WITH ISLANDS MILES
MAX. DEPTH 74 FEET

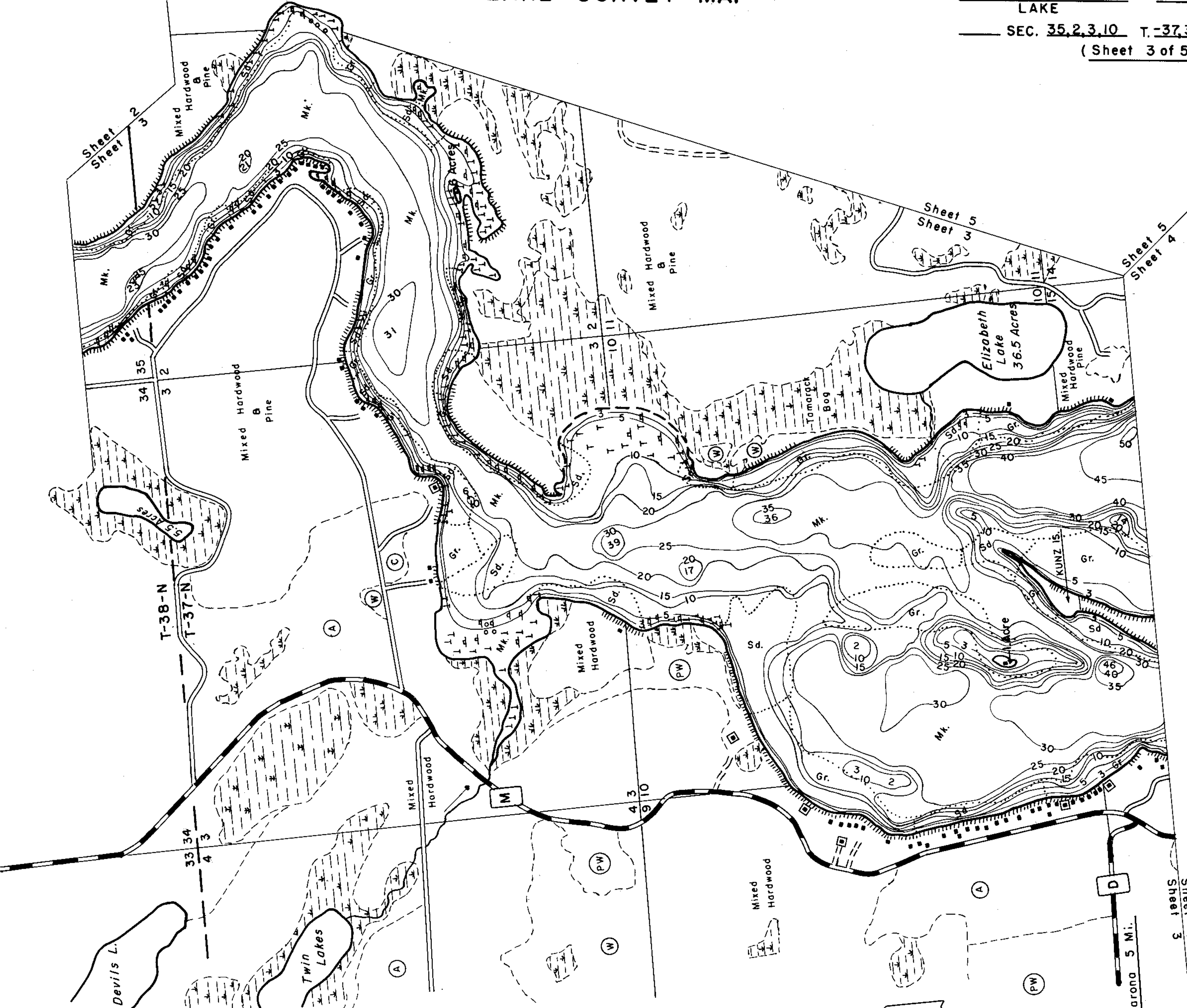

EQUIPMENT RECORDING SONAR MAPPED SEPTEMBER 1965
MO. YR.

- TOPOGRAPHIC SYMBOLS
- (B) Brush
 - (PW) Partially wooded
 - (W) Wooded
 - (C) Cleared
 - (P) Pastured
 - (A) Agricultural
 - B.M. Bench Mark
 - Dwelling
 - Resort
 - ||||| Steep slope
 - - - Indefinite shoreline
 - ||||| Marsh
 - o Spring
 - - - Intermittent stream
 - ||| Permanent inlet
 - ||| Permanent outlet
 - ⊥ Dam
- LAKE BOTTOM SYMBOLS
- P. Peat
 - Mk. Muck
 - C. Clay
 - M. Marl
 - Sd. Sand
 - St. Silt
 - Gr. Gravel
 - R. Rubble
 - Br. Bedrock
 - T Submergent vegetation
 - ⊥ Emergent vegetation
 - - - Floating vegetation
 - ⊙ Stumps & Snags

WATER ELEV. 96.30'

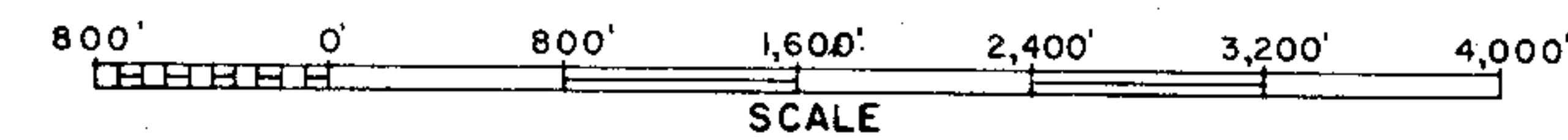

◇ Access ◇ Access with Parking ◇ Boat Livery
Field work by: G. Miller, C. Olson, L. Sather Drawn by: E. Eaton

SPECIES OF FISH		
	Abundant	Rare
Muskie		
N. Pike	X	
Walleye	X	
L.M. Bass	X	
S.M. Bass		X
Panfish	X	
Trout		
Cisco		X

AREA 3,333.2 WITH ISLANDS
3,289.7 ACRES
UNDER 3FT. 5 %
OVER 20FT. 63 %
VOLUME 86,967. ACRE FT.
TOTAL ALK. 86 P.P.M.
SHORELINE 35.6 MILES
MAX. DEPTH 74 FEET

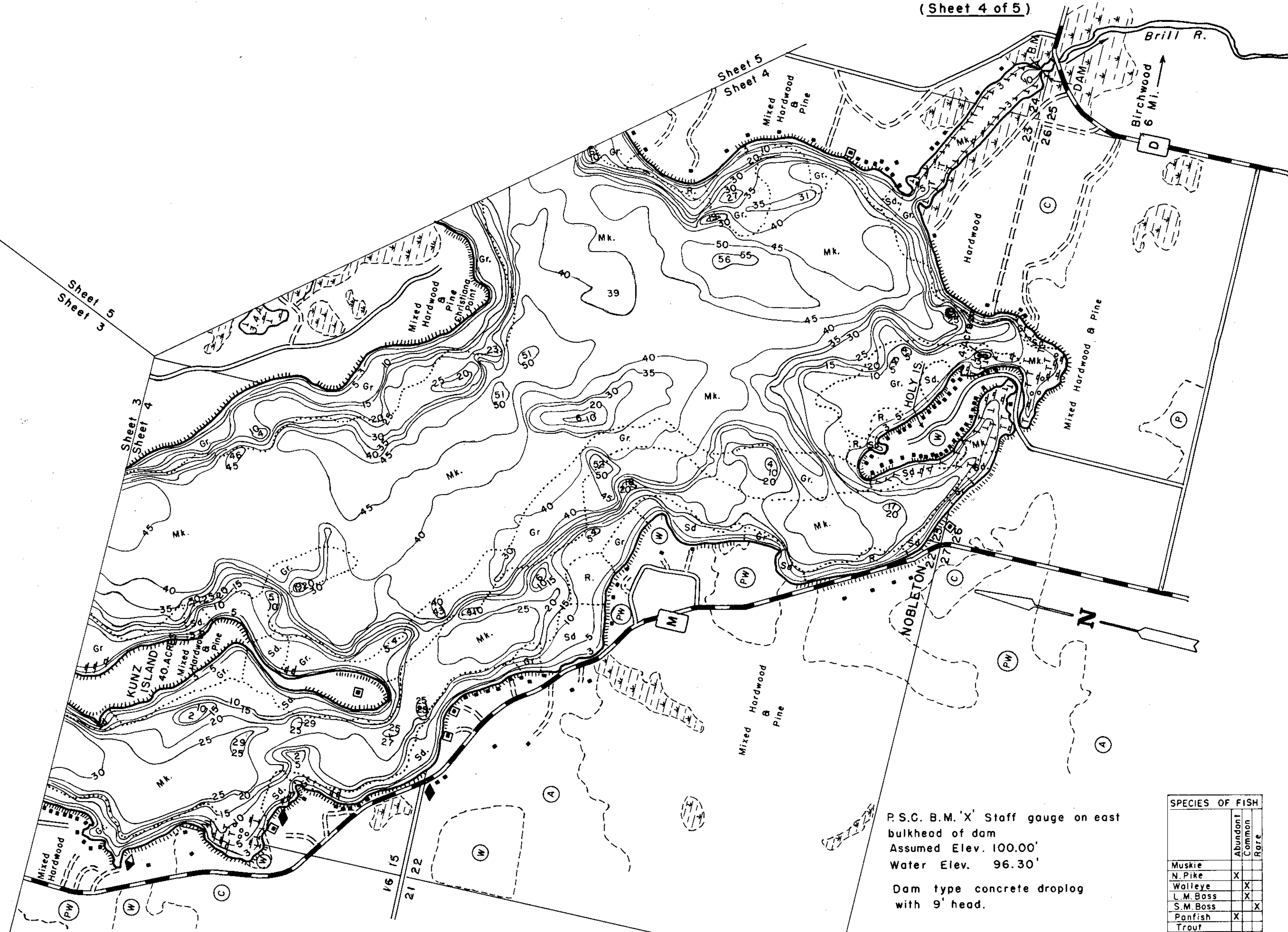

P.S.C. B.M. 'X' Staff gauge on east bulkhead of dam
 Assumed Elev. 100.00'
 Water Elev. 96.30'
 Dam type concrete droplog with 9' head.

SPECIES OF FISH			
	Abundant	Common	Rare
Muskie			
N. Pike	X		
Walleye		X	
L. M. Boss		X	
S. M. Boss			X
Panfish	X		
Trout			
Cisco			X

3,333.2 WITH ISLANDS
 AREA 3,289.7 ACRES
 UNDER 3FT. 5 %
 OVER 20FT. 63 %
 VOLUME 86,967 ACRE FT.
 TOTAL ALK. 86 P.P.M.
 SHORELINE 35.6 MILES
 MAX. DEPTH 74 FEET

EQUIPMENT RECORDING SONAR MAPPED SEPTEMBER 1965
 MO. YR.

- TOPOGRAPHIC SYMBOLS
- (B) Brush
 - (PW) Partially wooded
 - (W) Wooded
 - (C) Cleared
 - (P) Pastured
 - (A) Agricultural
 - B.M. Bench Mark
 - Dwelling
 - Resort
 - ||||| Steep slope
 - - - Indefinite shoreline
 - Marsh
 - Spring
 - Intermittent stream
 - Permanent inlet
 - Permanent outlet
 - Dam
- LAKE BOTTOM SYMBOLS
- P. Peat
 - Mk. Muck
 - C. Clay
 - M. Marl
 - Sd. Sand
 - St. Silt
 - Gr. Gravel
 - R. Rubble
 - Br. Bedrock
 - T Submergent vegetation
 - ⊥ Emergent vegetation
 - ⊥ Floating vegetation
 - ⊙ Stumps & Snags

WATER ELEV. 96.30'

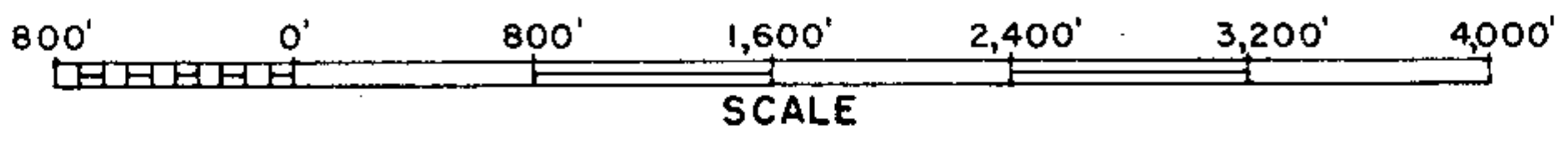

◇ Access ◇ Access with Parking ◆ Boat Livery
 Field work by G. Miller, C. Olson, L. Sather Drawn by E. Eaton

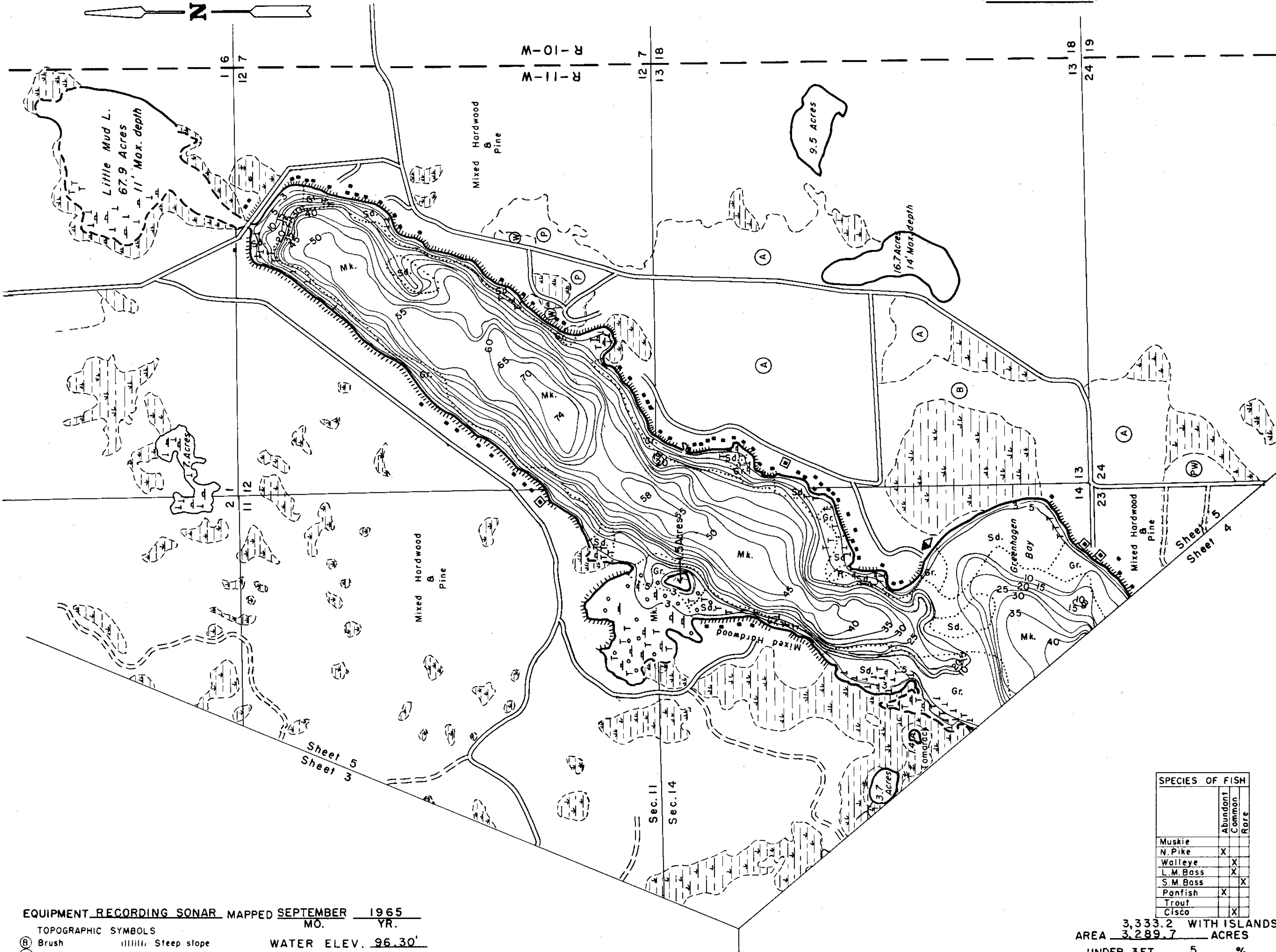

EQUIPMENT RECORDING SONAR MAPPED SEPTEMBER 1965
MO. YR.

- TOPOGRAPHIC SYMBOLS
- (B) Brush
 - (PW) Partially wooded
 - (W) Wooded
 - (C) Cleared
 - (P) Pastured
 - (A) Agricultural
 - B.M. Bench Mark
 - Dwelling
 - Resort
 - ||||| Steep slope
 - - - Indefinite shoreline
 - Marsh
 - Spring
 - Intermittent stream
 - Permanent inlet
 - Permanent outlet
 - Dam

WATER ELEV. 96.30'

- LAKE BOTTOM SYMBOLS
- P. Peat
 - Mk. Muck
 - C. Clay
 - M. Marl
 - Sd. Sand
 - St. Silt
 - Gr. Gravel
 - R. Rubble
 - Br. Bedrock
 - T. Submergent vegetation
 - ⊥ Emergent vegetation
 - ⊢ Floating vegetation
 - Stumps & Snags

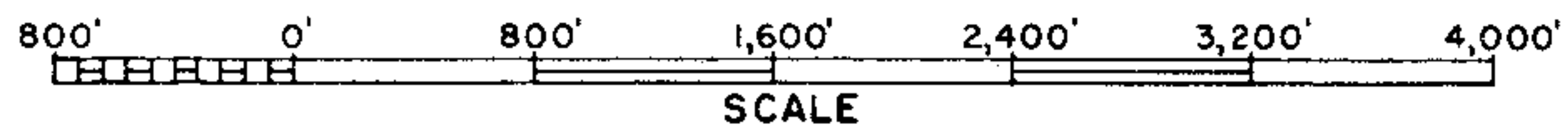

- ◇ Access
 - ◀ Access with Parking
 - ◆ Boat Livery
- Field work by G. Miller, C. Olson, L. Sather Drawn by: E. Eaton

SPECIES OF FISH	Abundance	
	Common	Rare
Muskie		
N. Pike	X	
Walleye	X	
L. M. Bass	X	
S. M. Bass		X
Panfish	X	
Trout		
Cisco		X

AREA 3,333.2 WITH ISLANDS
3,289.7 ACRES
UNDER 3FT. 5 %
OVER 20FT. 63 %
VOLUME 86,967 ACRE FT.
TOTAL ALK. 86 P.P.M.
SHORELINE 38.6 WITH ISLANDS MILES
MAX. DEPTH 74 FEET

Source: Wisconsin Department of Natural Resources 608-266-2621
Long Lake - Washburn County, Wisconsin DNR Lake Map
Date – Sep 1965 - Historical Lake Map - Not for Navigation
A Public Document - Please Identify the Source when using it.

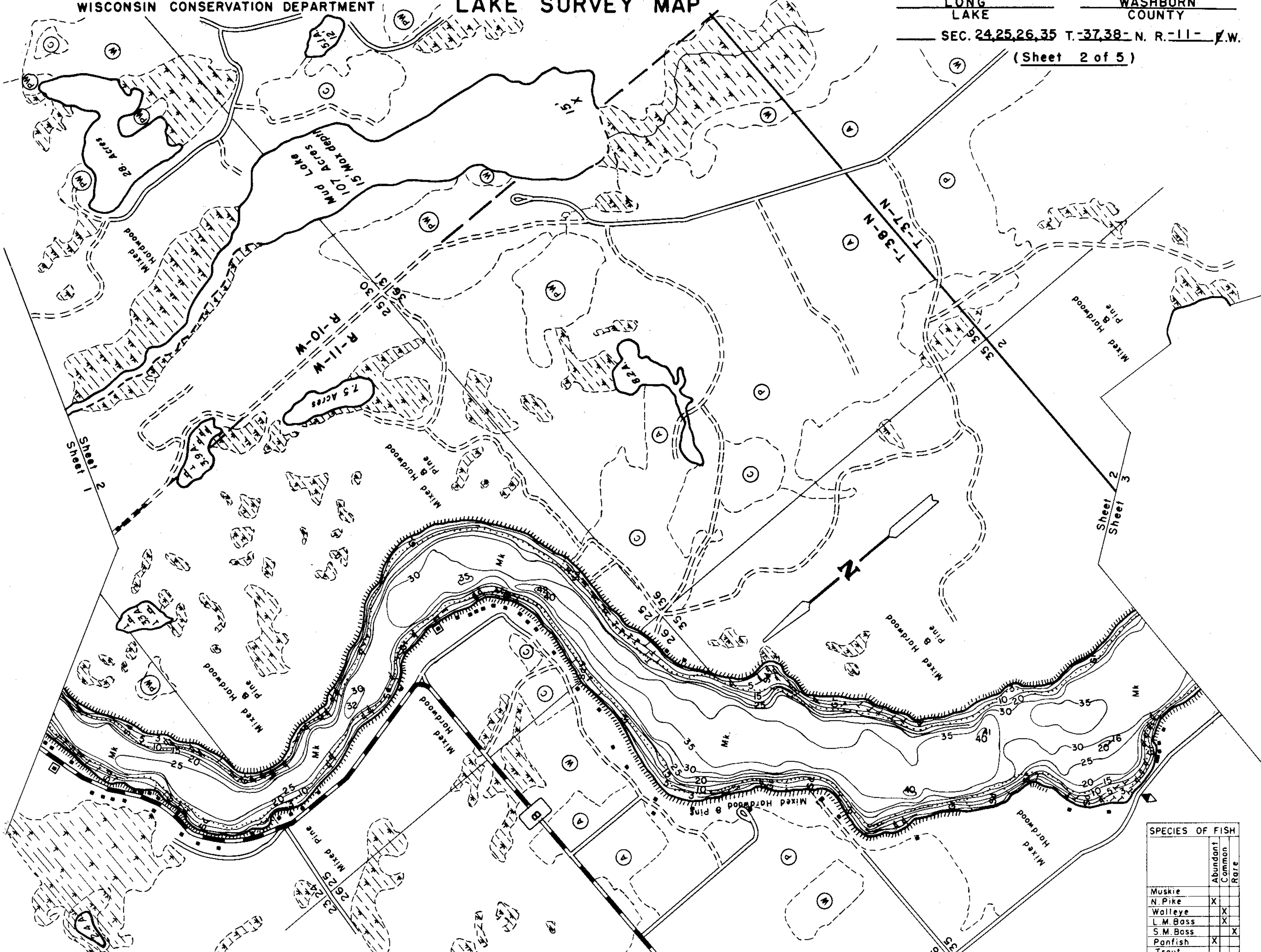

EQUIPMENT RECORDING SONAR MAPPED SEPTEMBER 1965
MO. YR.

- TOPOGRAPHIC SYMBOLS
- (B) Brush
 - (PW) Partially wooded
 - (W) Wooded
 - (C) Cleared
 - (P) Pastured
 - (A) Agricultural
 - B.M. Bench Mark
 - Dwelling
 - Resort
 - ||||| Steep slope
 - ~ Indefinite shoreline
 - Marsh
 - Spring
 - Intermittent stream
 - Permanent inlet
 - Permanent outlet
 - Dam

- LAKE BOTTOM SYMBOLS
- P. Peat
 - Mk. Muck
 - C. Clay
 - M. Marl
 - Sd. Sand
 - St. Silt
 - Gr. Gravel
 - R. Rubble
 - Br. Bedrock
 - T. Submergent vegetation
 - Emergent vegetation
 - Floating vegetation
 - Stumps & Snags

WATER ELEV. 96.30'

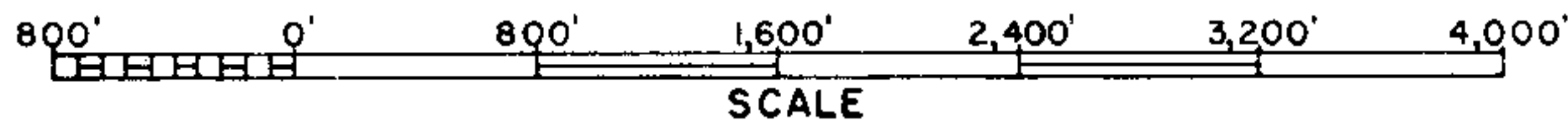

◇ Access ◇ Access with Parking ◆ Boat Livery
Field work by G. Miller, C. Olson, L. Sother. Drawn by E. Eaton

SPECIES OF FISH		
	Abundant	Rare
Muskie		
N. Pike	X	
Walleye	X	
L. M. Bass	X	
S. M. Bass	X	X
Panfish	X	
Trout		
Cisco	X	

3,333.2 WITH ISLANDS
AREA 3,289.7 ACRES
UNDER 3FT. 5 %
OVER 20FT. 63 %
VOLUME 86,967 ACRE FT.
TOTAL ALK. 86 PPM
SHORELINE 38 WITH ISLANDS
MAX. DEPTH 74 FEET

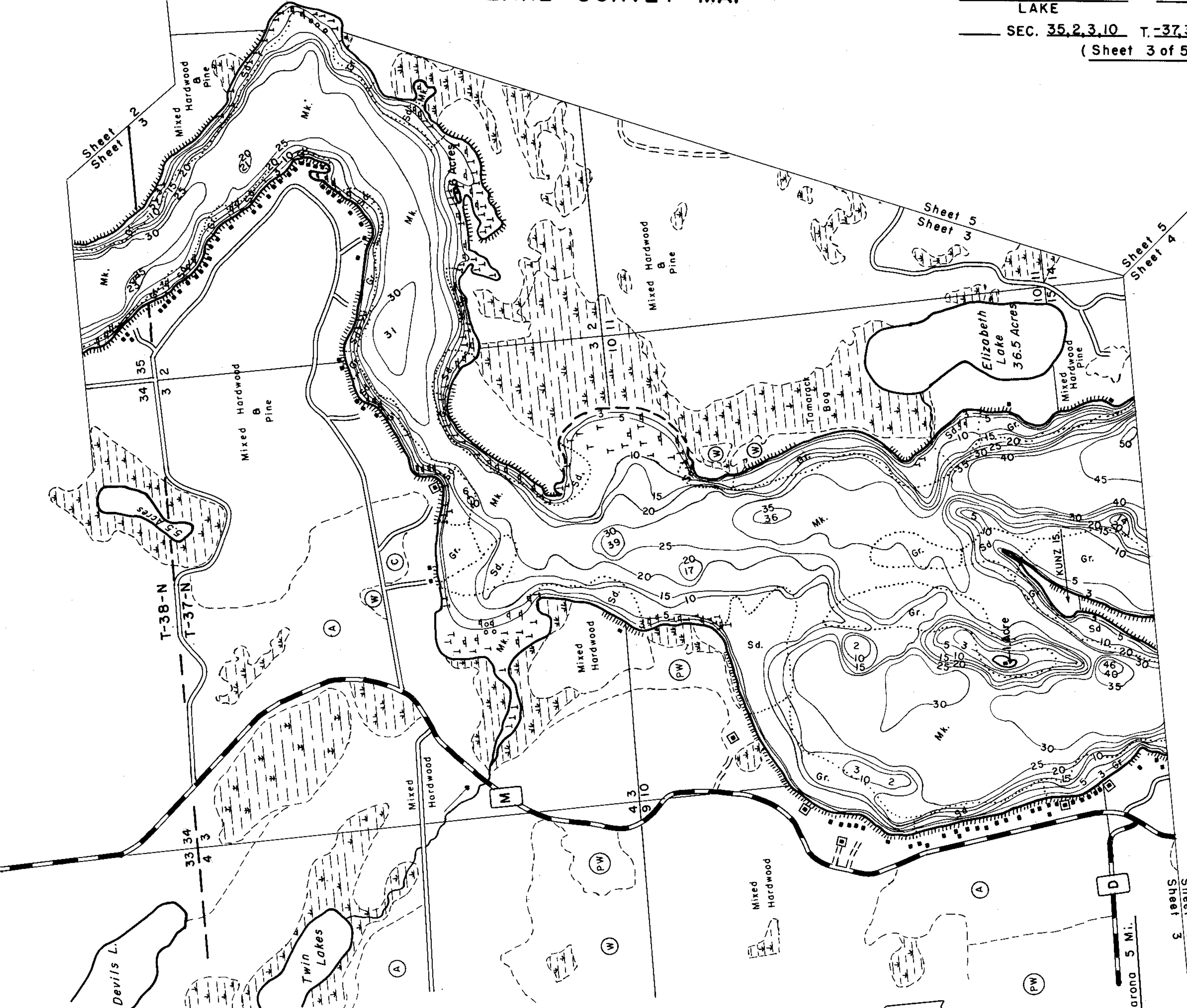

EQUIPMENT RECORDING SONAR MAPPED SEPTEMBER 1965
MO. YR.

- TOPOGRAPHIC SYMBOLS
- (B) Brush
 - (PW) Partially wooded
 - (W) Wooded
 - (C) Cleared
 - (P) Pastured
 - (A) Agricultural
 - B.M. Bench Mark
 - Dwelling
 - Resort
 - ||||| Steep slope
 - - - Indefinite shoreline
 - ||||| Marsh
 - o Spring
 - - - Intermittent stream
 - ==== Permanent inlet
 - ==== Permanent outlet
 - ⊥ Dam
- LAKE BOTTOM SYMBOLS
- P. Peat
 - Mk. Muck
 - C. Clay
 - M. Marl
 - Sd. Sand
 - St. Silt
 - Gr. Gravel
 - R. Rubble
 - Br. Bedrock
 - T Submergent vegetation
 - ⊥ Emergent vegetation
 - - - Floating vegetation
 - ⊙ Stumps & Snags

WATER ELEV. 96.30'

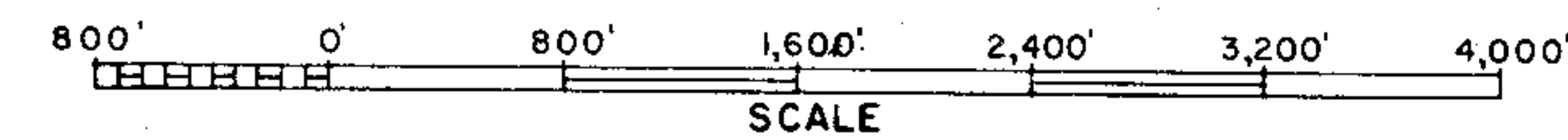

◇ Access ◇ Access with Parking ◇ Boat Livery
Field work by: G. Miller, C. Olson, L. Sather Drawn by: E. Eaton

SPECIES OF FISH		
	Abundant	Rare
Muskie		
N. Pike	X	
Walleye	X	
L.M. Bass	X	
S.M. Bass		X
Panfish	X	
Trout		
Cisco		X

AREA 3,333.2 WITH ISLANDS
3,289.7 ACRES
UNDER 3FT. 5 %
OVER 20FT. 63 %
VOLUME 86,967. ACRE FT.
TOTAL ALK. 86 P.P.M.
SHORELINE 35.6 MILES
MAX. DEPTH 74 FEET

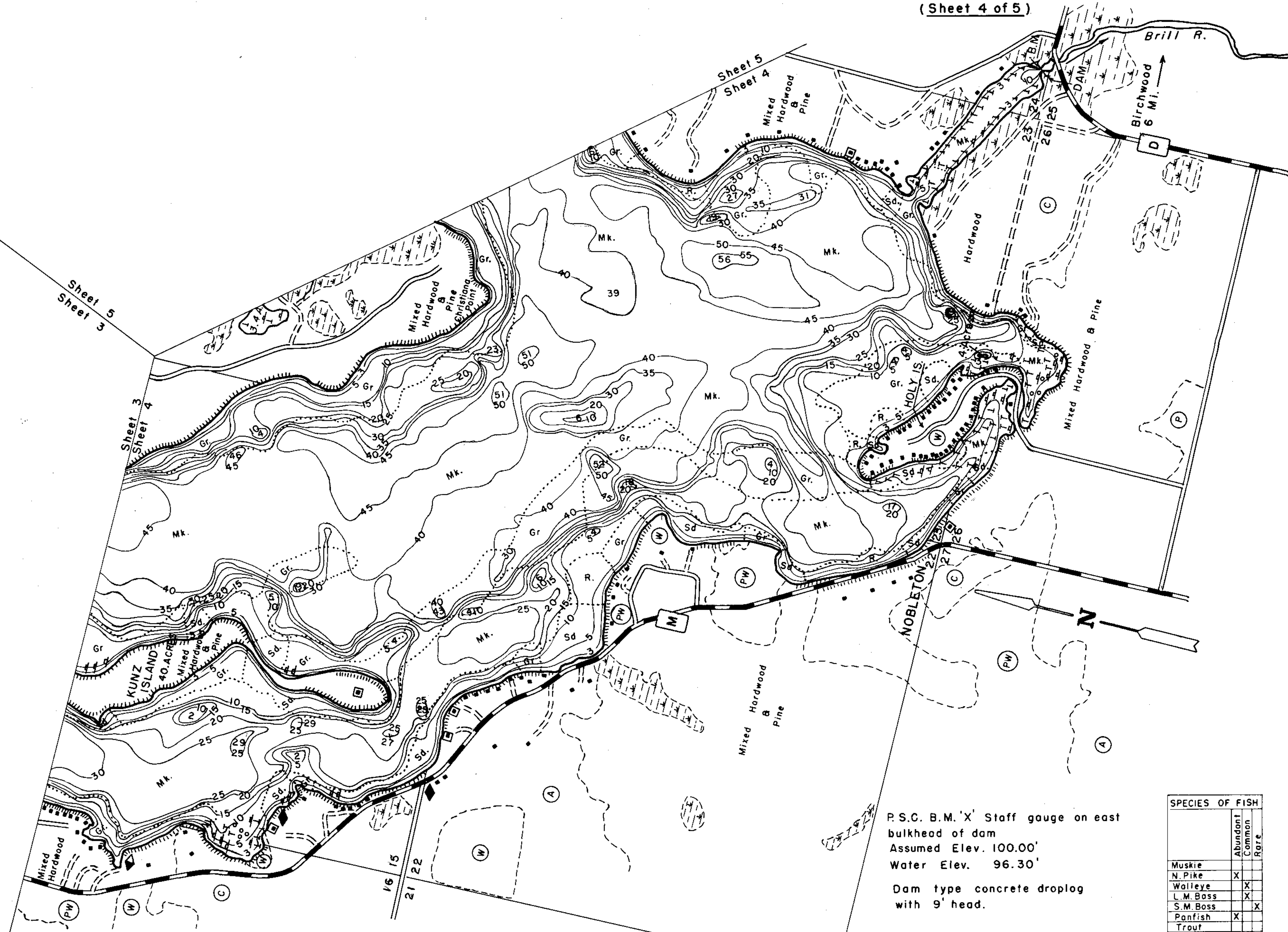

P.S.C. B.M. 'X' Staff gauge on east bulkhead of dam
 Assumed Elev. 100.00'
 Water Elev. 96.30'
 Dam type concrete droplog with 9' head.

SPECIES OF FISH			
	Abundant	Common	Rare
Muskie			
N. Pike	X		
Walleye		X	
L.M. Boss		X	
S.M. Boss			X
Panfish	X		
Trout			
Cisco			X

3,333.2 WITH ISLANDS
 AREA 3,289.7 ACRES
 UNDER 3FT. 5 %
 OVER 20FT. 63 %
 VOLUME 86,967 ACRE FT.
 TOTAL ALK. 86 P.P.M.
 SHORELINE 35.6 MILES
 MAX. DEPTH 74 FEET

EQUIPMENT RECORDING SONAR MAPPED SEPTEMBER 1965
 MO. YR.

- WATER ELEV. 96.30'
- | TOPOGRAPHIC SYMBOLS | | LAKE BOTTOM SYMBOLS | |
|-----------------------|----------------------------|---------------------|-------------------------|
| (B) Brush | Steep slope | P. Peat | Gr. Gravel |
| (PW) Partially wooded | - - - Indefinite shoreline | Mk. Muck | R. Rubble |
| (W) Wooded | Marsh | C. Clay | Br. Bedrock |
| (C) Cleared | o Spring | M. Marl | T Submergent vegetation |
| (P) Pastured | — Intermittent stream | Sd. Sand | ⊥ Emergent vegetation |
| (A) Agricultural | — Permanent inlet | St. Silt | ⊥ Floating vegetation |
| B.M. Bench Mark | — Permanent outlet | | |
| ■ Dwelling | ⊥ Dam | | |
| ■ Resort | | | |

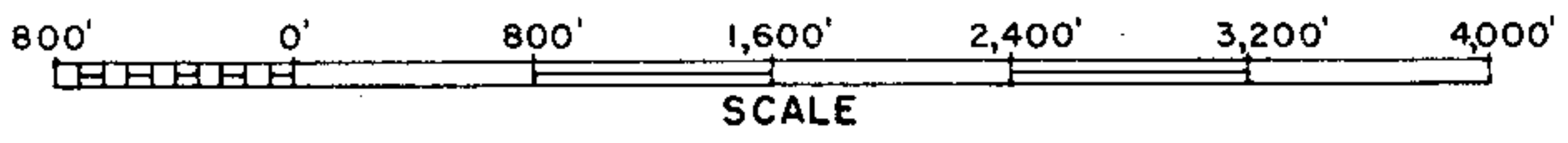

◇ Access ◇ Access with Parking ◆ Boat Livery
 Field work by G. Miller, C. Olson, L. Sather Drawn by E. Eaton

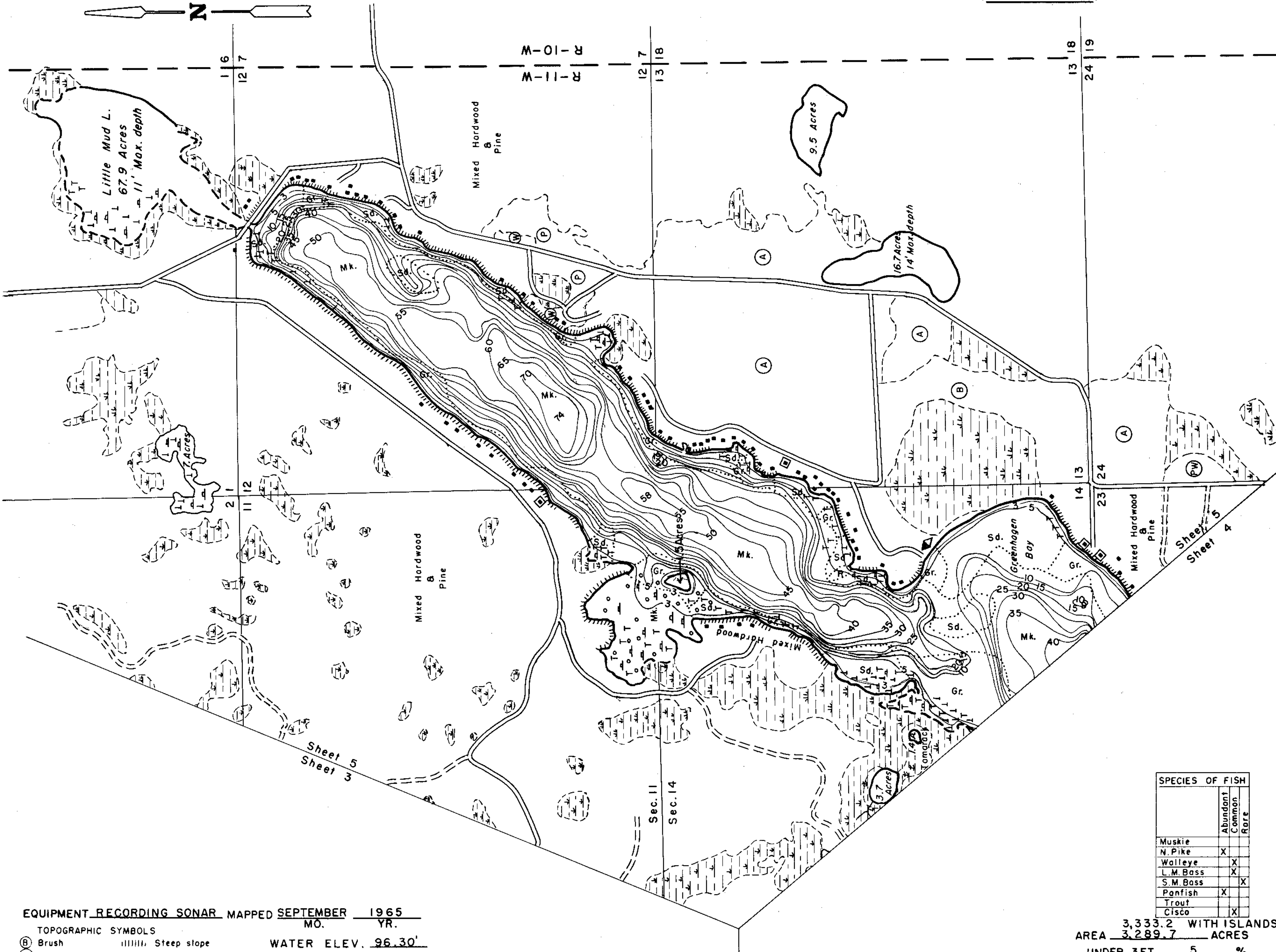

EQUIPMENT RECORDING SONAR MAPPED SEPTEMBER 1965
MO. YR.

TOPOGRAPHIC SYMBOLS

- (B) Brush
- (PW) Partially wooded
- (W) Wooded
- (C) Cleared
- (P) Pastured
- (A) Agricultural
- B.M. Bench Mark
- Dwelling
- Resort
- ||||| Steep slope
- - - Indefinite shoreline
- Marsh
- Spring
- Intermittent stream
- Permanent inlet
- Permanent outlet
- Dam

WATER ELEV. 96.30'

LAKE BOTTOM SYMBOLS

- P. Peat
- Mk. Muck
- C. Clay
- M. Marl
- Sd. Sand
- St. Silt
- Gr. Gravel
- R. Rubble
- Br. Bedrock
- T. Submergent vegetation
- ⊥ Emergent vegetation
- ⊢ Floating vegetation
- Stumps & Snags

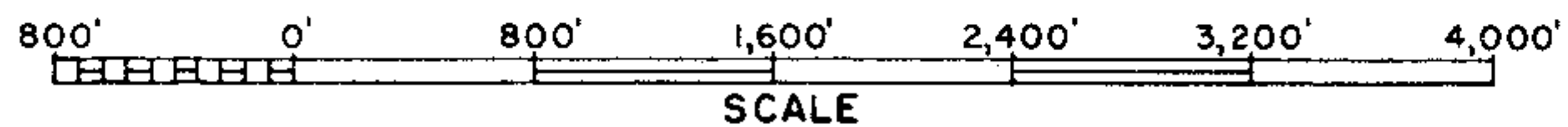

- ◇ Access
- ◈ Access with Parking
- ◆ Boat Livery

Field work by G. Miller, C. Olson, L. Sather Drawn by: E. Eaton

SPECIES OF FISH

	Abundant	Common	Rare
Muskie			
N. Pike	X		
Walleye		X	
L. M. Bass		X	
S. M. Bass			X
Panfish	X		
Trout			
Cisco			X

AREA 3,333.2 WITH ISLANDS
3,289.7 ACRES
UNDER 3FT. 5 %
OVER 20FT. 63 %
VOLUME 86,967 ACRE FT.
TOTAL ALK. 86 P.P.M.
SHORELINE 38.6 WITH ISLANDS MILES
MAX. DEPTH 74 FEET