

B.M. 'X' D.N.R. 1611-A Chiseled square in the footing on the S.E. corner of a green cement block house 90' N. of waters edge, 105' S. of the centerline of town road on the N. side of lake
Assumed elevation, 100.00'
Water level 91.21'

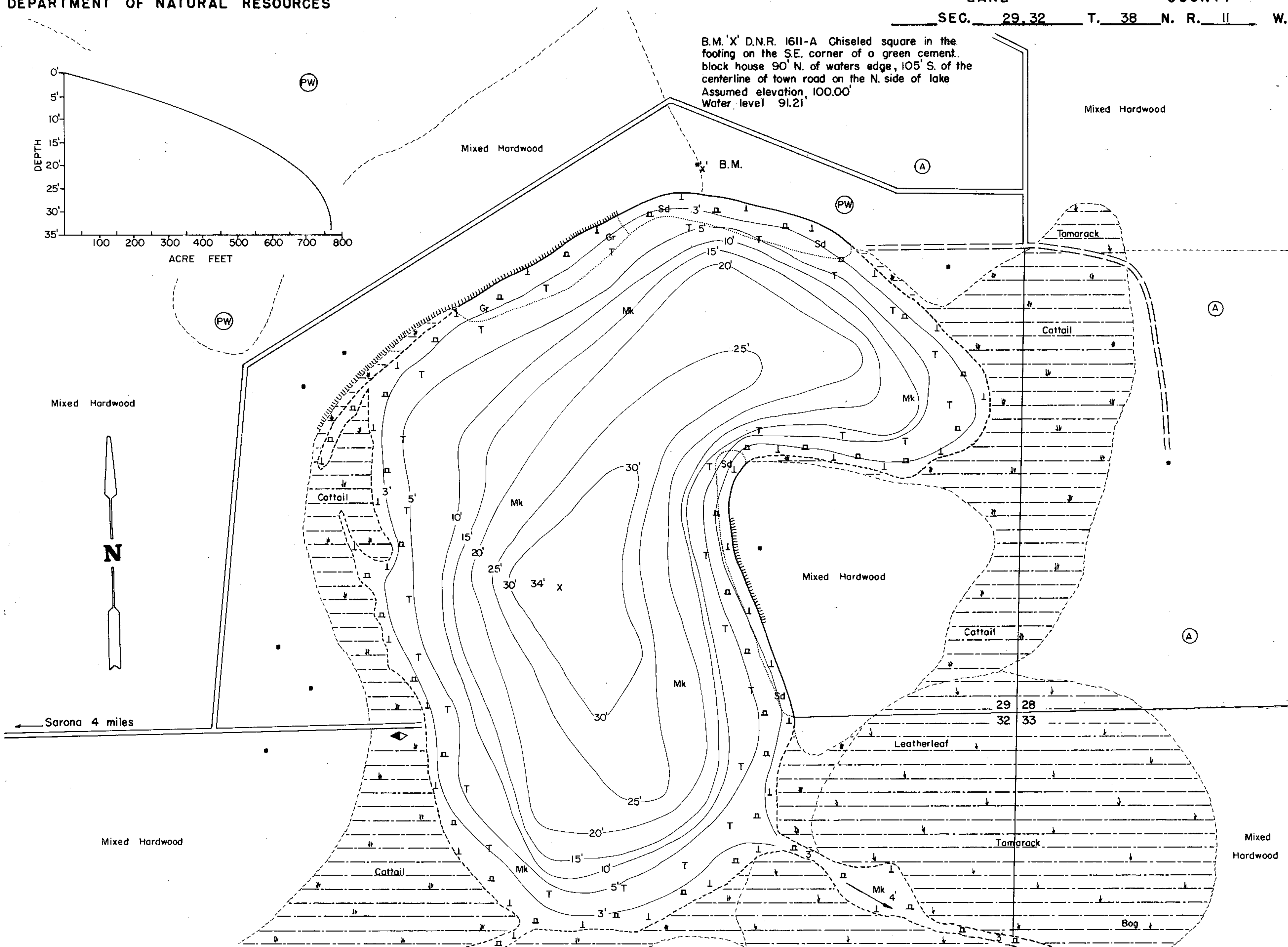
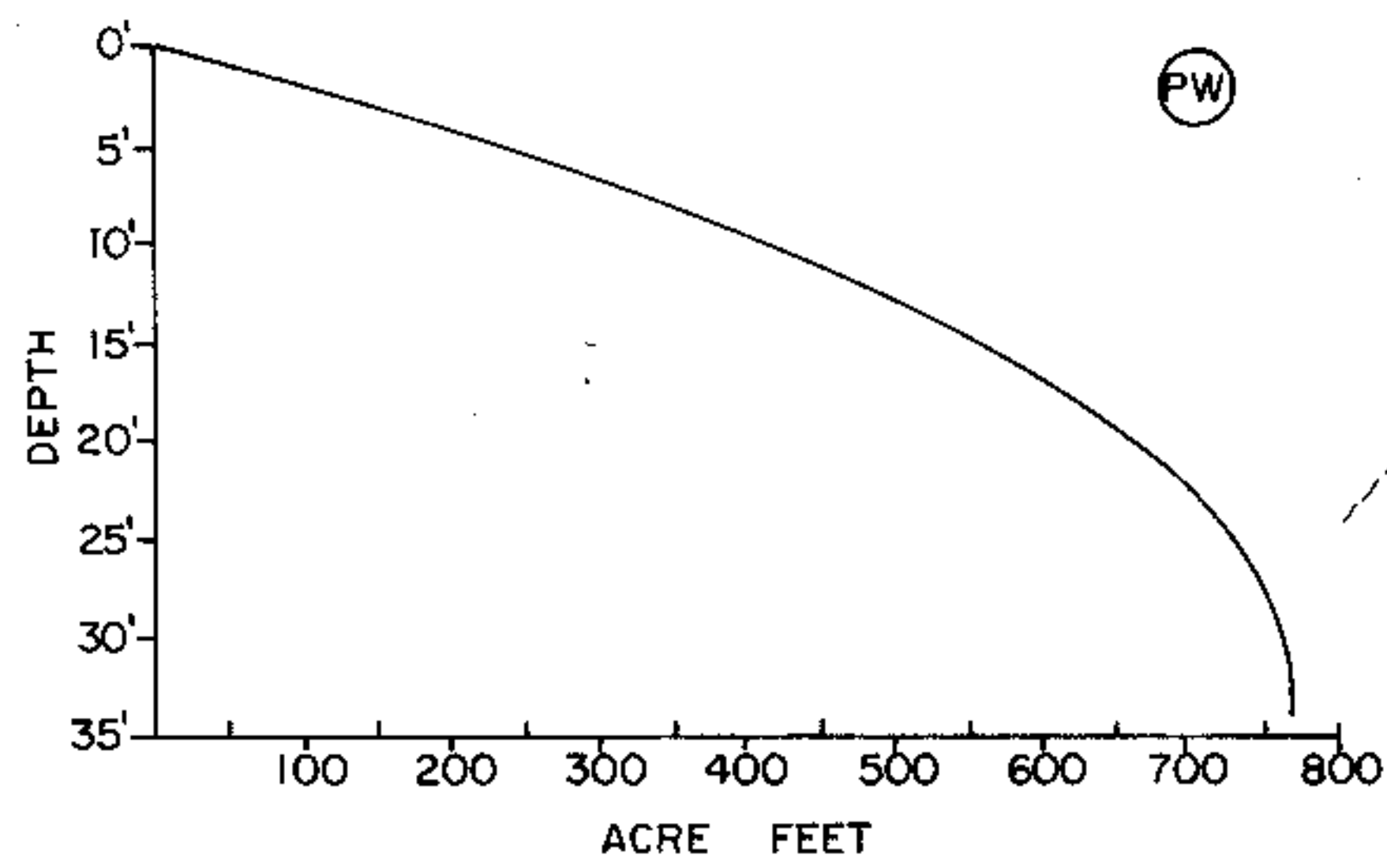

EQUIPMENT RECORDING SONAR MAPPED AUG. 1971

- TOPOGRAPHIC SYMBOLS
- (B) Brush
 - (PW) Partially wooded
 - (W) Wooded
 - (C) Cleared
 - (P) Pastured
 - (A) Agricultural
 - B.M. Bench Mark
 - Dwelling
 - Resort
 - Camp
 - ||||| Steep slope
 - ~ Indefinite shoreline
 - Marsh
 - Spring
 - Intermittent stream
 - Permanent inlet
 - Permanent outlet
 - Dam
 - D.N.R. State owned land

- LAKE BOTTOM SYMBOLS
- P. Peat
 - Mk. Muck
 - C. Clay
 - M. Marl
 - Sd. Sand
 - St. Silt
 - Gr. Gravel
 - R. Rubble
 - Br. Bedrock
 - B Boulders
 - Stumps & Snags
 - Rock danger to navigation
 - T Submergent vegetation
 - Emergent vegetation
 - Floating vegetation
 - Brush shelters

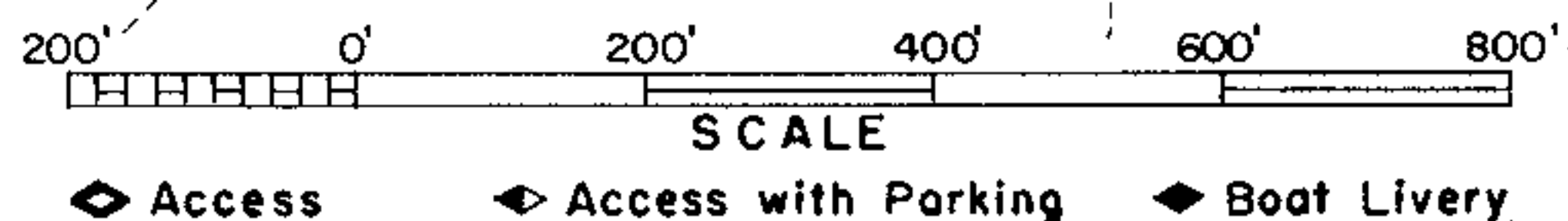

Drawn by: C. Holt
Field work by: C. Busch, G. Lund, J. Sather

SPECIES OF FISH	ABUNDANCE		
	Abundant	Common	Present
Muskie			
N. Pike		X	
Walleye		X	
L.M. Bass		X	
S.M. Bass		X	
Panfish	X		
Trout			

WATER AREA 55.6 ACRES
UNDER 3 FT. 14 %
OVER 20 FT. 33 %
MAX. DEPTH 34 FEET.
TOTAL ALK. 89 P.P.M.
VOLUME 767 ACRE FT.
SHORELINE 2.16 MILES

Source: Wisconsin Department of Natural Resources 608-266-2621
Little Devils Lake - Washburn County, Wisconsin DNR Lake Map
Date – Aug 1971 - Historical Lake Map - Not for Navigation
A Public Document - Please Identify the Source when using it.