

LAKE SURVEY MAP

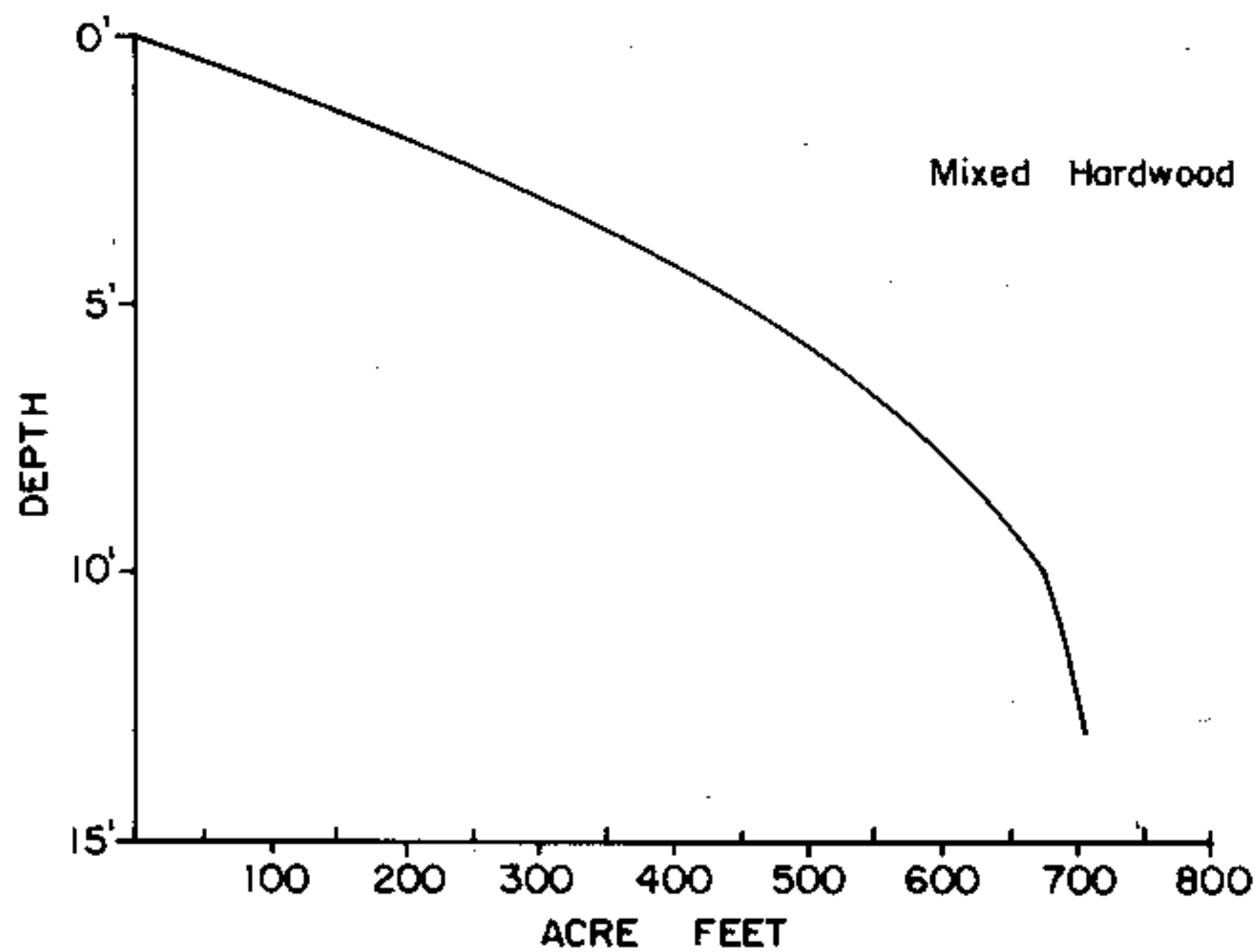

B.M. 'X' Chisled square on porch floor on the S. side of cottage, 72' N. of water, 94' E. of house on the SW. side of lake at farm on dead end road
Assumed elevation 100.00'
Water level 91.53'

EQUIPMENT RECORDING SONAR MAPPED

SEPT 1971
MONTH YEAR

- TOPOGRAPHIC SYMBOLS**
- (B) Brush
 - (PW) Partially wooded
 - (W) Wooded
 - (C) Cleared
 - (P) Pastured
 - (A) Agricultural
 - B.M. Bench Mark
 - Dwelling
 - Resort
 - Camp
 - Steep slope
 - Indefinite shoreline
 - Marsh
 - Spring
 - Intermittent stream
 - Permanent inlet
 - Permanent outlet
 - Dam
 - D.N.R. State owned land

- LAKE BOTTOM SYMBOLS**
- P. Peat
 - Mk. Muck
 - C. Clay
 - M. Marl
 - Sd. Sand
 - St. Silt
 - Gr. Gravel
 - R. Rubble
 - Br. Bedrock
 - B Boulders
 - S Stumps & Snags
 - Rock danger to navigation
 - T Emergent vegetation
 - Emergent vegetation
 - Floating vegetation
 - Brush shelters



Access Access with Parking Boat Livery

Drawn by: C. Holt
Field work by: C. Busch, G. Lund, L. Sather

SPECIES OF FISH	ABUNDANCE	
	Abundant	Common
Muskie		
N. Pike	X	
Walleye		X
L. N. Bass	X	
S. N. Bass		
Panfish	X	
Trout		

WATER AREA 102.7 ACRES
UNDER 3 FT. 14.6 %
OVER 20 FT. 0 %
MAX. DEPTH 13 FEET
TOTAL ALK. 121 P.P.M.
VOLUME 707 ACRE FT.
SHORELINE 3.85 MILES

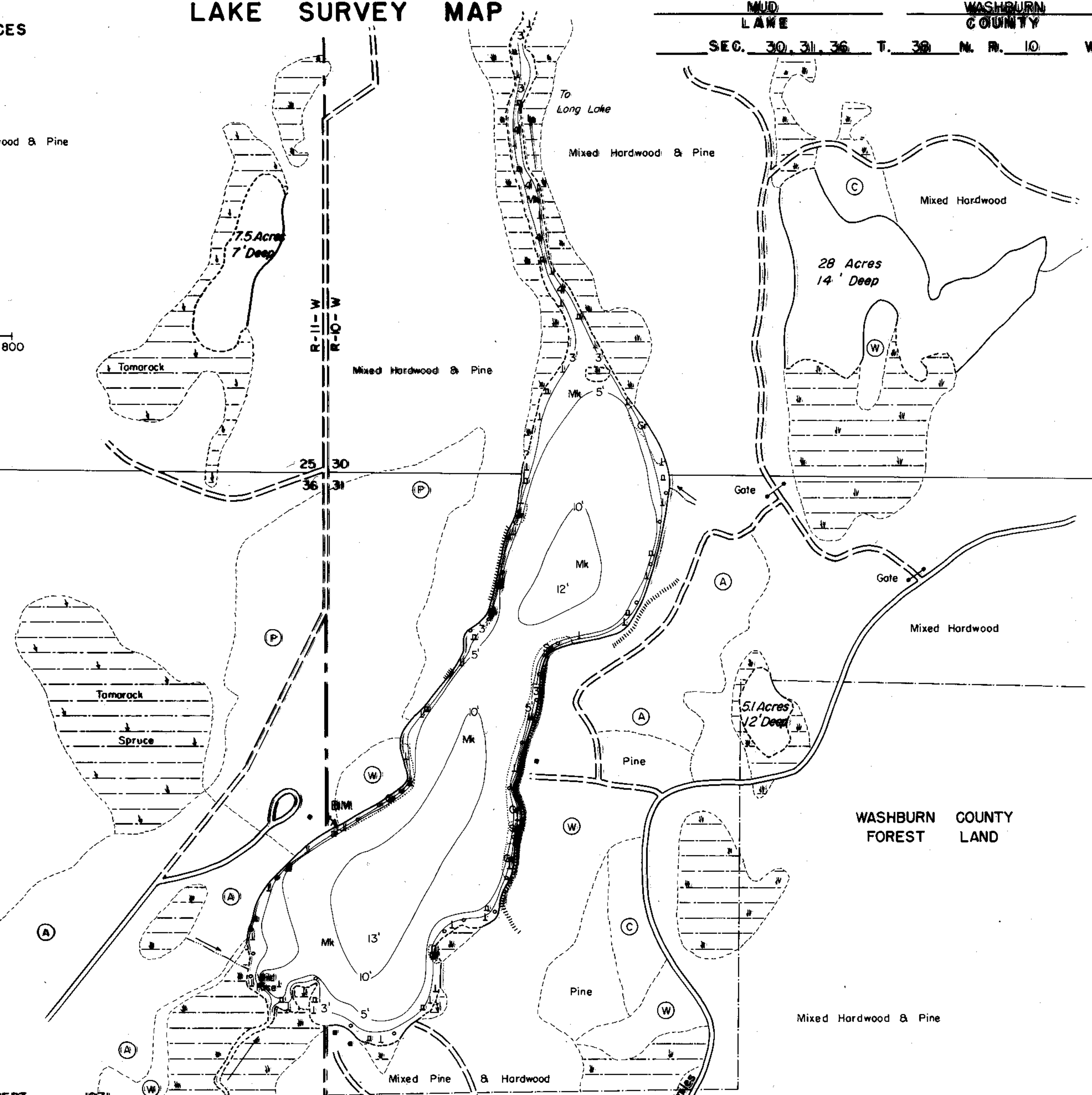

Source: Wisconsin Department of Natural Resources 608-266-2621
Mud Lake - Washburn County, Wisconsin DNR Lake Map
Date – Sep 1971 - Historical Lake Map - Not for Navigation
A Public Document - Please Identify the Source when using it.