

LAKE SURVEY MAP

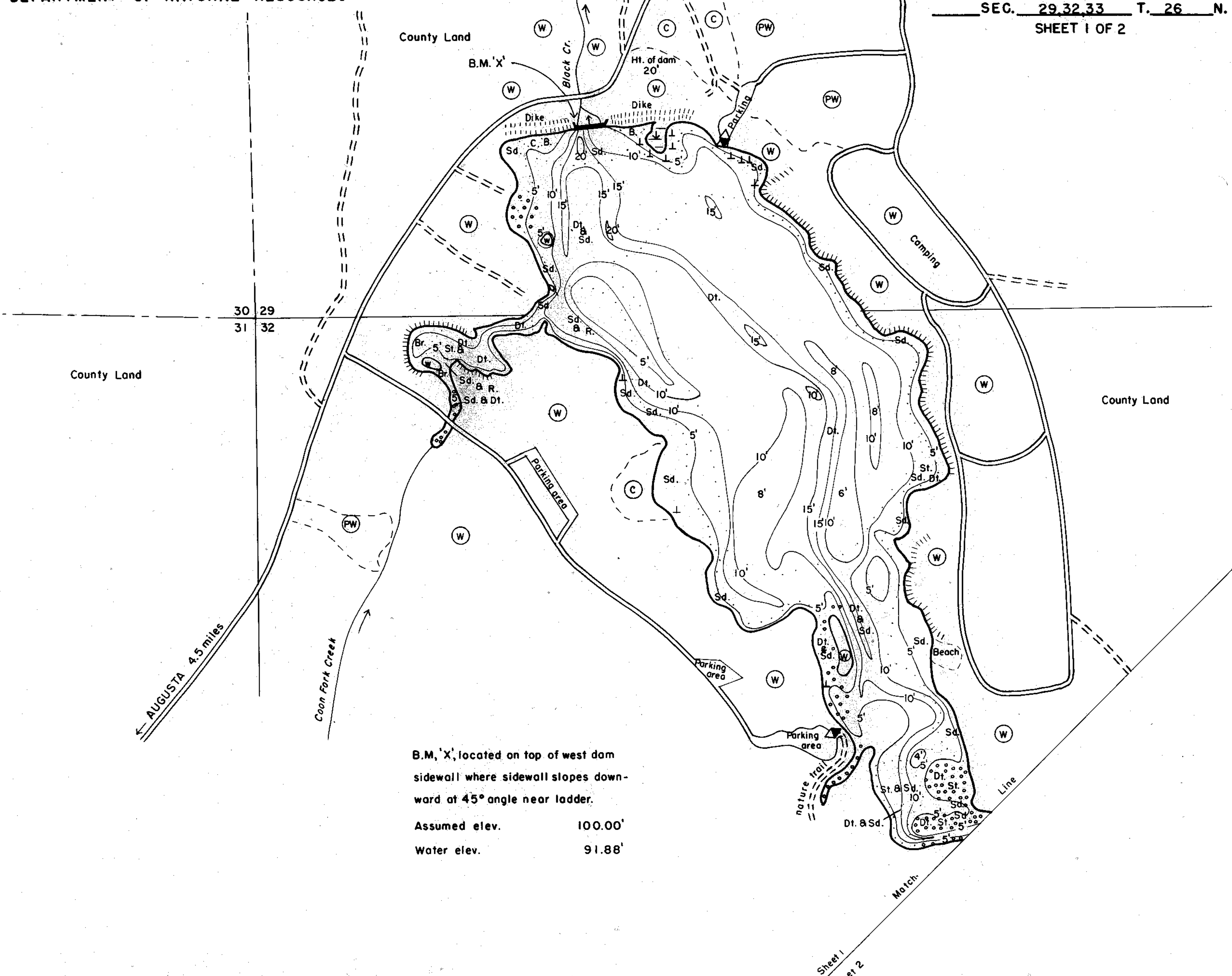

B.M. 'X' located on top of west dam
sidewall where sidewall slopes down-
ward at 45° angle near ladder.

Assumed elev. 100.00'
Water elev. 91.88'

EQUIPMENT SONAR & RANGE POLE MAPPED JUNE 1969
MONTH YEAR

- TOPOGRAPHIC SYMBOLS**
- (B) Brush
 - (PW) Partially wooded
 - (W) Wooded
 - (C) Cleared
 - (P) Pastured
 - (A) Agricultural
 - B.M. Bench Mark
 - Dwelling
 - Resort
 - ▭ D.N.R. State owned land
 - ||||| Steep slope
 - - - Indefinite shoreline
 - Marsh
 - Spring
 - Intermittent stream
 - Permanent inlet
 - Permanent outlet
 - Dam

- LAKE BOTTOM SYMBOLS**
- P. Peat
 - Mk. Muck
 - C. Clay
 - M. Marl
 - Sd. Sand
 - St. Silt
 - Gr. Gravel
 - R. Rubble
 - Br. Bedrock
 - B Boulders
 - Stumps & Snags
 - Rock danger to navigation
 - T Submergent vegetation
 - ↓ Emergent vegetation
 - Floating vegetation
 - Brush shelters
 - Dt. Detritus



Access Access with Parking Boat Livery

Drawn by: T. Ginder
Field work by: S. Hagen

SPECIES OF FISH	Abundance		
	Abundant	Common	Present
Muskie			X
N. Pike			
Walleye			
L. M. Bass	X		
S. M. Bass			
Panfish	X		
Trout			

WATER AREA 74.51 ACRES
UNDER 3 FT. 25 %
OVER 20 FT. 0 %
MAX. DEPTH 20 FEET.
TOTAL ALK. 10 P.P.M.
VOLUME 563.30 ACRE FT.
SHORELINE 5.2 MILES
INCLUDING ISLANDS 5.7 MILES

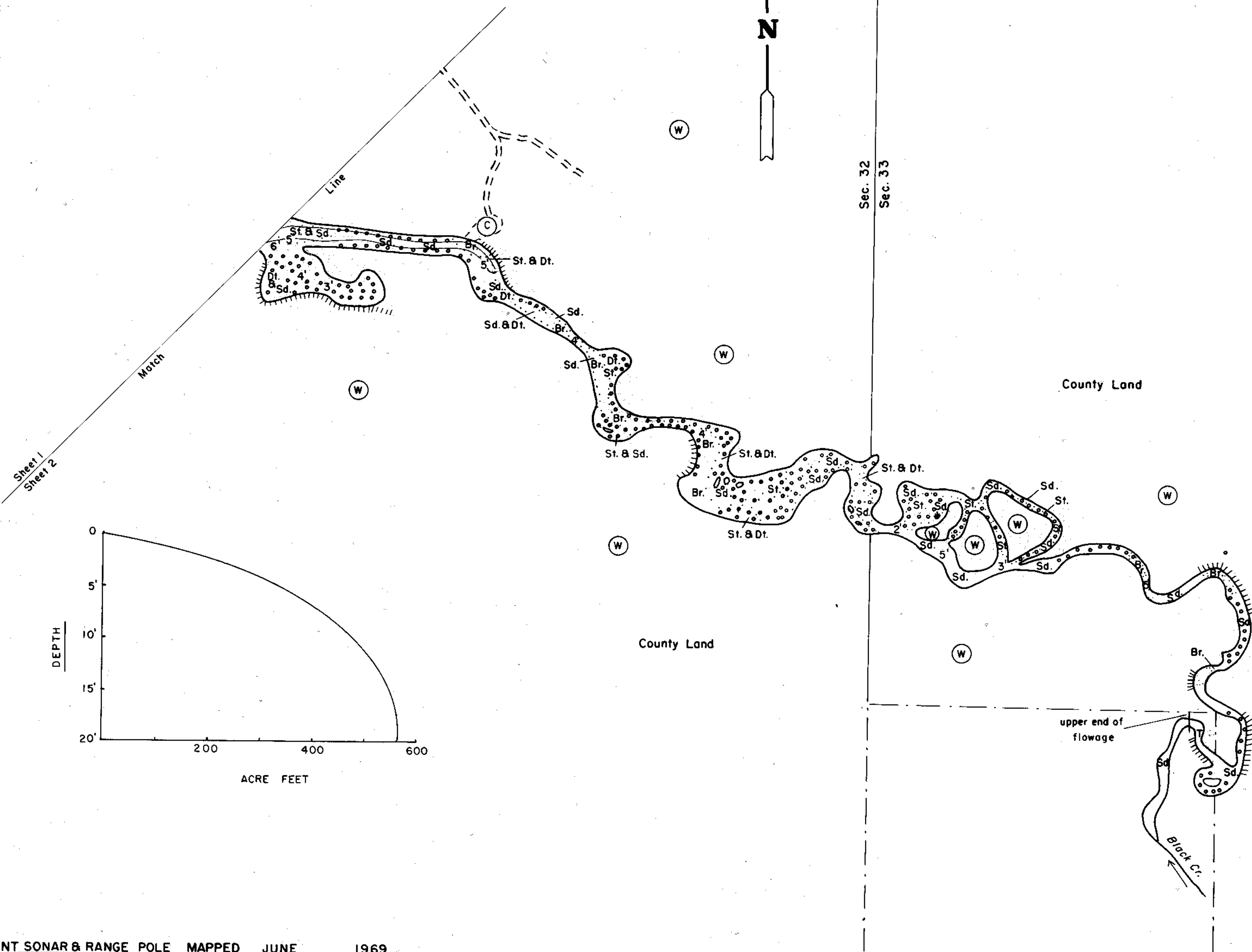

Sheet 1
Sheet 2

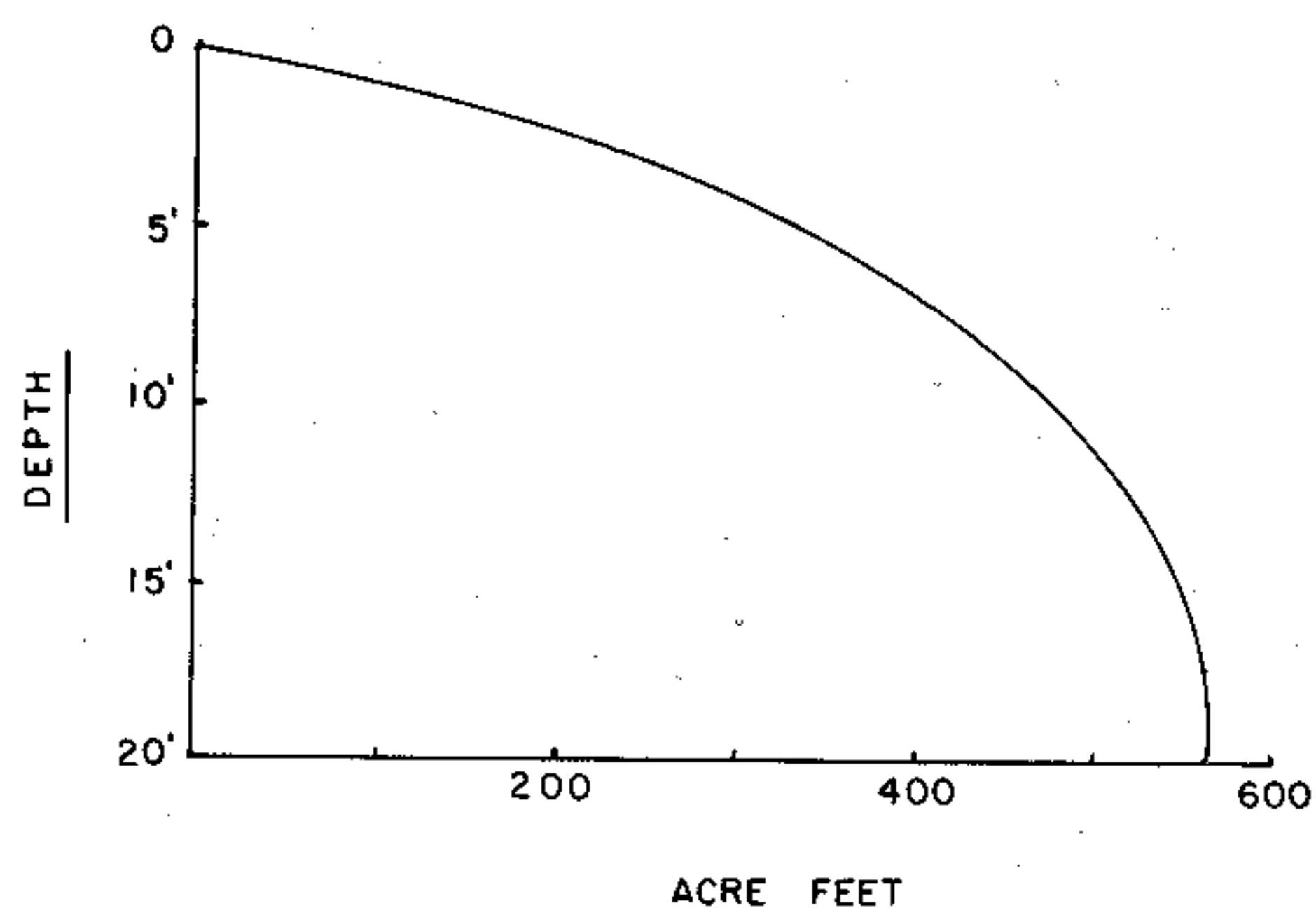

EQUIPMENT SONAR & RANGE POLE MAPPED JUNE 1969

TOPOGRAPHIC SYMBOLS		LAKE BOTTOM SYMBOLS	
(B) Brush	Steep slope	P. Peat	B Boulders
(PW) Partially wooded	----- Indefinite shoreline	Mk. Muck	o Stumps & Snags
(W) Wooded	----- Marsh	C. Clay	o Rock danger to navigation
(C) Cleared	o Spring	M. Marl	T Submergent vegetation
(P) Pastured	----- Intermittent stream	Sd. Sand	⊥ Emergent vegetation
(A) Agricultural	----- Permanent inlet	St. Silt	⊥ Floating vegetation
B.M. Bench Mark	----- Permanent outlet	Gr. Gravel	⊥ Brush shelters
■ Dwelling	⊥ Dam	R. Rubble	Dt. Detritus
□ Resort	D.N.R. State owned land	Br. Bedrock	
□ Camp			

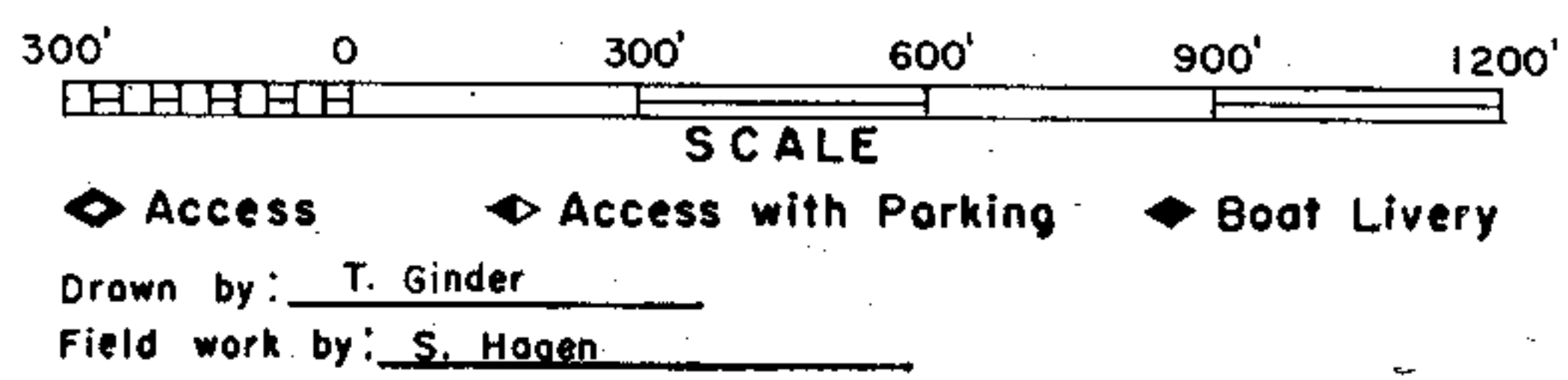

SPECIES OF FISH	Abundance		
	Abundant	Common	Present
Muskie			X
N. Pike			
Walleye			
L.M. Bass	X		
S.M. Bass			
Panfish	X		
Trout			X

WATER AREA 74.51 ACRES
 UNDER 3 FT. 25 %
 OVER 20 FT. 0 %
 MAX. DEPTH 20 FEET.
 TOTAL ALK. 10 P.P.M.
 VOLUME 563.30 ACRE FT.
 SHORELINE 5.2 MILES
 INCLUDING ISLANDS 5.7 MILES

Source: Wisconsin Department of Natural Resources 608-266-2621
Coon Fork Flowage – Eau Claire County, Wisconsin DNR Lake Map
Date – Jun 1969 - Historical Lake Map - Not for Navigation
A Public Document - Please Identify the Source when using it.