

LAKE SURVEY MAP

TILDEN MILL POND
LAKE
CHIPPEWA COUNTY
SEC. 13, 24 T. 29 N. R. 9 W.

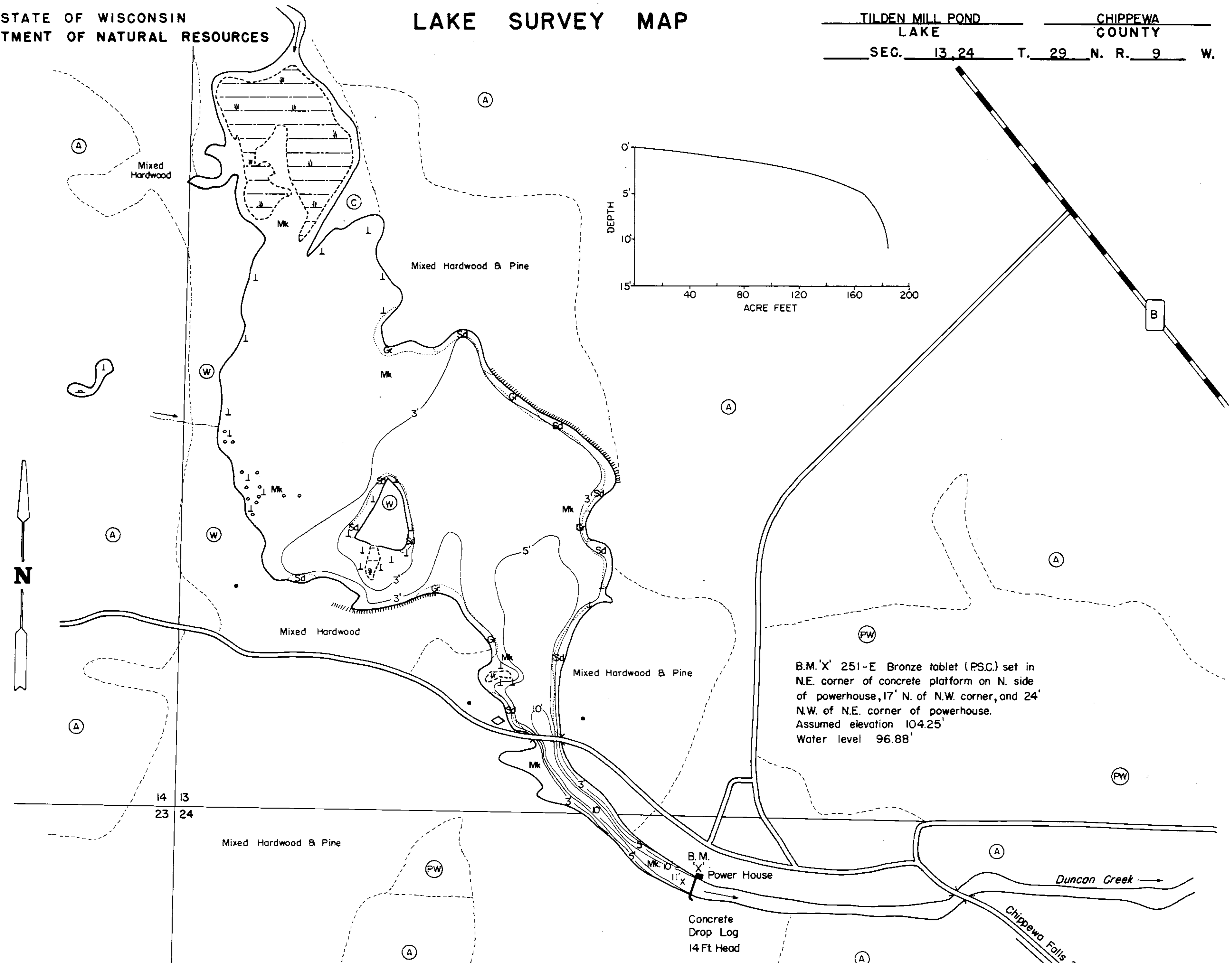

B.M. 'X' 251-E Bronze tablet (P.S.C.) set in N.E. corner of concrete platform on N. side of powerhouse, 17' N. of N.W. corner, and 24' N.W. of N.E. corner of powerhouse. Assumed elevation 104.25'. Water level 96.88'.

EQUIPMENT RECORDING SONAR MAPPED AUG 1969

- | TOPOGRAPHIC SYMBOLS | | LAKE BOTTOM SYMBOLS | |
|-----------------------|----------------------------|---------------------|---------------------------|
| (B) Brush | Steep slope | P. Peat | B Boulders |
| (PW) Partially wooded | - - - Indefinite shoreline | Mk. Muck | o Stumps & Snags |
| (W) Wooded | Marsh | C. Clay | Rock danger to navigation |
| (C) Cleared | Spring | M. Marl | T Submergent vegetation |
| (P) Pastured | Intermittent stream | Sd. Sand | l Emergent vegetation |
| (A) Agricultural | Permanent inlet | St. Silt | Fl. Floating vegetation |
| B.M. Bench Mark | Permanent outlet | Gr. Gravel | Br. Brush shelters |
| ■ Dwelling | Dam | R. Rubble | |
| □ Resort | D.N.R. State owned land | Bc. Bedrock | |
| □ Camp | | | |



◆ Access ◆ Access with Parking ◆ Boat Livery
 Drawn by: C. Holt
 Field work by: C. Busch, C. Belter

SPECIES OF FISH	Abundance		
	Abundant	Common	Present
Muskie			
N. Pike			
Walleye			
L.M. Bass	X		
S.M. Bass			
Panfish	X		
Trout			

WATER AREA 60.7 ACRES
 UNDER 3 FT. 53.7 %
 OVER 20 FT. 0 %
 MAX. DEPTH 11 FEET.
 TOTAL ALK. 41 P.P.M.
 VOLUME 1852 ACRE FT.
 SHORELINE 2.0 MILES
 SHORELINE 22 MILES WITH IS.

Source: Wisconsin Department of Natural Resources 608-266-2621
Tilden Mill Pond Lake – Chippewa County, Wisconsin DNR Lake Map
Date – Aug 1969 - Historical Lake Map - Not for Navigation
A Public Document - Please Identify the Source when using it.