

Compiled from Photogrammetric methods by
Abrams Aerial Survey Corporation
Owen Ayres & Associates
Consulting Engineers
Eau Claire, Wisconsin

EQUIPMENT (SEE NOTE)		MAPPED MARCH 1968	
TOPOGRAPHIC SYMBOLS		LAKE BOTTOM SYMBOLS	
(B) Brush	Steep slope	P. Peat	B Boulders
(W) Partially wooded	----- Indefinite shoreline	Mk. Muck	o Stumps & Snags
(W) Wooded	----- Marsh	C. Clay	o Rock danger to navigation
(C) Cleared	----- Spring	M. Marl	T Submergent vegetation
(P) Pastured	----- Intermittent stream	Sd. Sand	l Emergent vegetation
(A) Agricultural	----- Permanent inlet	St. Silt	f Floating vegetation
B.M. Bench Mark	----- Permanent outlet	Gr. Gravel	♣ Brush shelters
■ Dwelling	----- Dam	R. Rubble	
■ Resort	----- D.N.R. State owned land	Bc. Bedrock	
■ Camp			

SPECIES OF FISH	Abundance		
	Abundant	Common	Present
Muskie			
N. Pike			
Walleye		X	
L.M. Bass	X		
S.M. Bass			
Panfish	X		
Trout			

WATER AREA	661	ACRES
UNDER 3 FT.	10.55	%
OVER 20 FT.	5.05	%
MAX. DEPTH	43	FEET.
TOTAL ALK.	45	P.P.M.
VOLUME	6918.39	ACRE FT.
MAIN SHORELINE	15.5	MI.
ISLAND SHORELINE	4.5	MI.

400' 0' 400' 800' 1200' 1600'
SCALE
◆ Access ◆ Access with Parking ◆ Boat Livery
Drawn by: G. Thuesen, F. Eaton
Field work by: T. Kroos

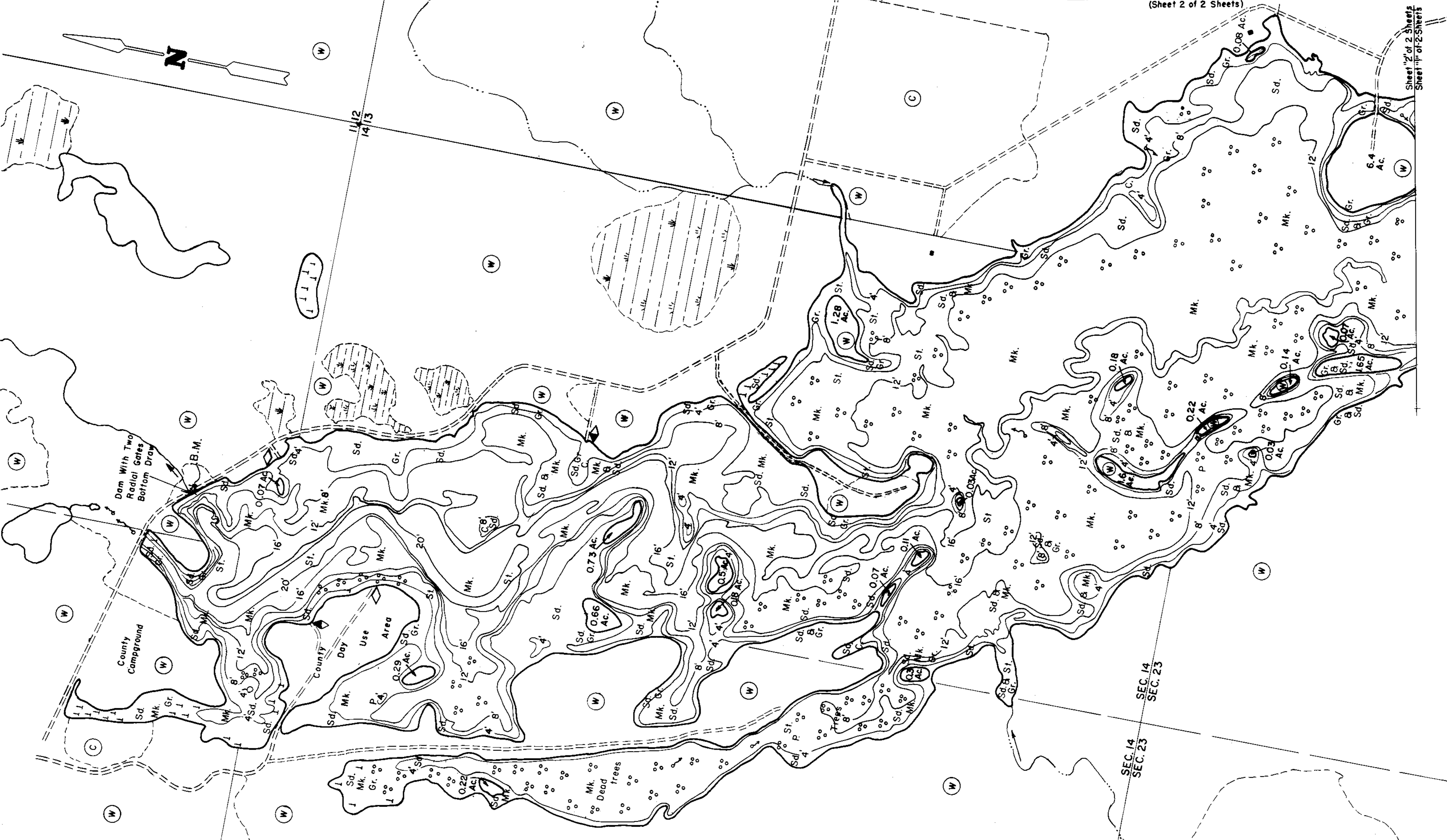

B.M. 1055 - B 'X' is a chiseled square in the roadway over dam, located 3' from S. E. corner of cement slab, on lake side of roadway
Elevation sea level 1149.80
Water level 1140.59 taken 10/15/76

EQUIPMENT (SEE NOTE)	MAPPED MONTH	1968 YEAR
TOPOGRAPHIC SYMBOLS		
(B) Brush	() Steep slope	P. Peat
(PW) Partially wooded	(---) Indefinite shoreline	Mk. Muck
(W) Wooded	(---) Marsh	C. Clay
(C) Cleared	(---) Spring	M. Marl
(P) Pastured	(---) Intermittent stream	Sd. Sand
(A) Agricultural	(---) Permanent inlet	St. Silt
B.M. Bench Mark	(---) Permanent outlet	Gr. Gravel
(■) Dwelling	(---) Dam	R. Rubble
(■) Resort	(---) D.N.R. State owned land	Br. Bedrock
(□) Camp		
		B. Boulders
		⊙ Stumps & Snags
		⊙ Rock danger to navigation
		T Submergent vegetation
		⊥ Emergent vegetation
		⊥ Floating vegetation
		⊥ Brush shelters

400' 0' 400' 800' 1200' 1600'
SCALE
◆ Access ◆ Access with Parking ◆ Boat Livery
Drawn by: G. Thuesen, E. Eaton
Field work by: T. Krass

SPECIES OF FISH	Abundance		
	Abundant	Common	Present
Muskie			
N. Pike		X	
Walleye			
L. M. Bass		X	
S. M. Bass			
Panfish	X		
Trout			

WATER AREA 661 ACRES
UNDER 3 FT. 10.55 %
OVER 20 FT. 5.05 %
MAX. DEPTH 43 FEET.
TOTAL ALK. 45 P.P.M.
VOLUME 6918.39 ACRE FT.
MAIN SHORELINE 15.5 MI.
ISLAND SHORELINE 4.5 MI.

Source: Wisconsin Department of Natural Resources 608-266-2621
Otter Lake (Browns Lake, Otter Flowage) – Chippewa County, Wisconsin DNR Lake Map
Date – Mar 1968 - Historical Lake Map - Not for Navigation
A Public Document - Please Identify the Source when using it.