

LAKE SURVEY MAP

WISCONSIN CONSERVATION DEPARTMENT
 BIOLOGY DIVISION
 LAKE AND STREAM IMPROVEMENT SECTION

LAKE HIGHLAND
 SECTION 33-34
 TOWNSHIP 32 N
 RANGE 8 W
 TOWN OF SAMPSON
 COUNTY CHIPPEWA

FORM FI-117

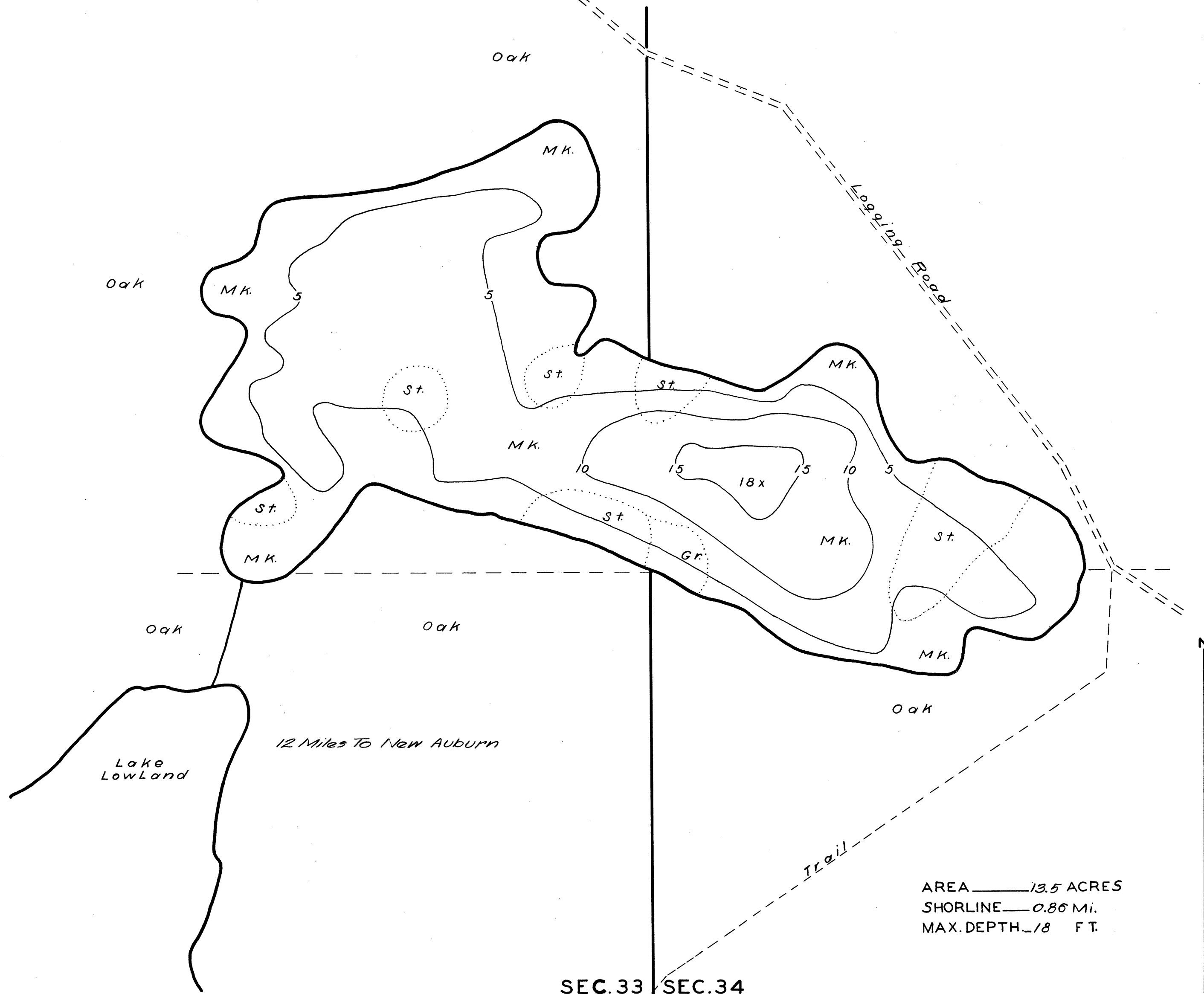

Oak

Oak

Mk.

Mk.

5

St.

St.

St.

Mk.

Mk.

10

15

18x

15

10

5

Mk.

St.

St.

Mk.

St.

Gr.

Mk.

Oak

Oak

Oak

Lake Lowland

12 Miles To New Auburn

AREA 13.5 ACRES
 SHORLINE 0.86 Mi.
 MAX. DEPTH 18 FT.

SEC. 33 SEC. 34

DATE May 20, 1940
 COMPILED BY _____
 TRACED BY R.C. (W.P.A.)
 SOURCE OF INFORMATION _____
W.P.A. Lake Survey Project

SOUNDINGS At 99 Ft. Intervals

DATES OF MAP REVISION _____
April 8, 1940

WORK AGENCY W.P.A.

CHECKED BY W.R.S.

3-20-41

LAKE IMPROVEMENT RECORD

TYPE	DATE			
BRUSH REFUGES				
SAPLING TANGLES				
SPAWNING BOXES				
MINNOW SPAWNERS				
TOTAL				

SCALE 1 inch Equal 132 Ft.

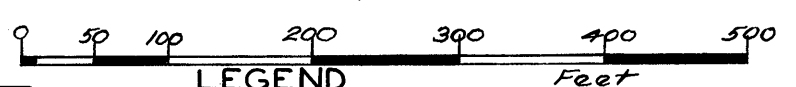

- LEGEND
- WEED BEDS
 - ROCKY SHOALS
 - Sd.* SAND
 - Cl.* CLAY
 - Gr.* GRAVEL
 - Mk.* MUCK
 - DWELLING
 - ABANDONED DWELLING
 - RESORT
 - St.* Silt

Source: Wisconsin Department of Natural Resources 608-266-2621
Highland Lake – Chippewa County, Wisconsin DNR Lake Map
Date – May 1940 - Historical Lake Map - Not for Navigation
A Public Document - Please Identify the Source when using it.