

LAKE SURVEY MAP

POPPLE LAKE
CHIPPEWA COUNTY
SEC. 24, 25 T. 30 N. R. 8 W.

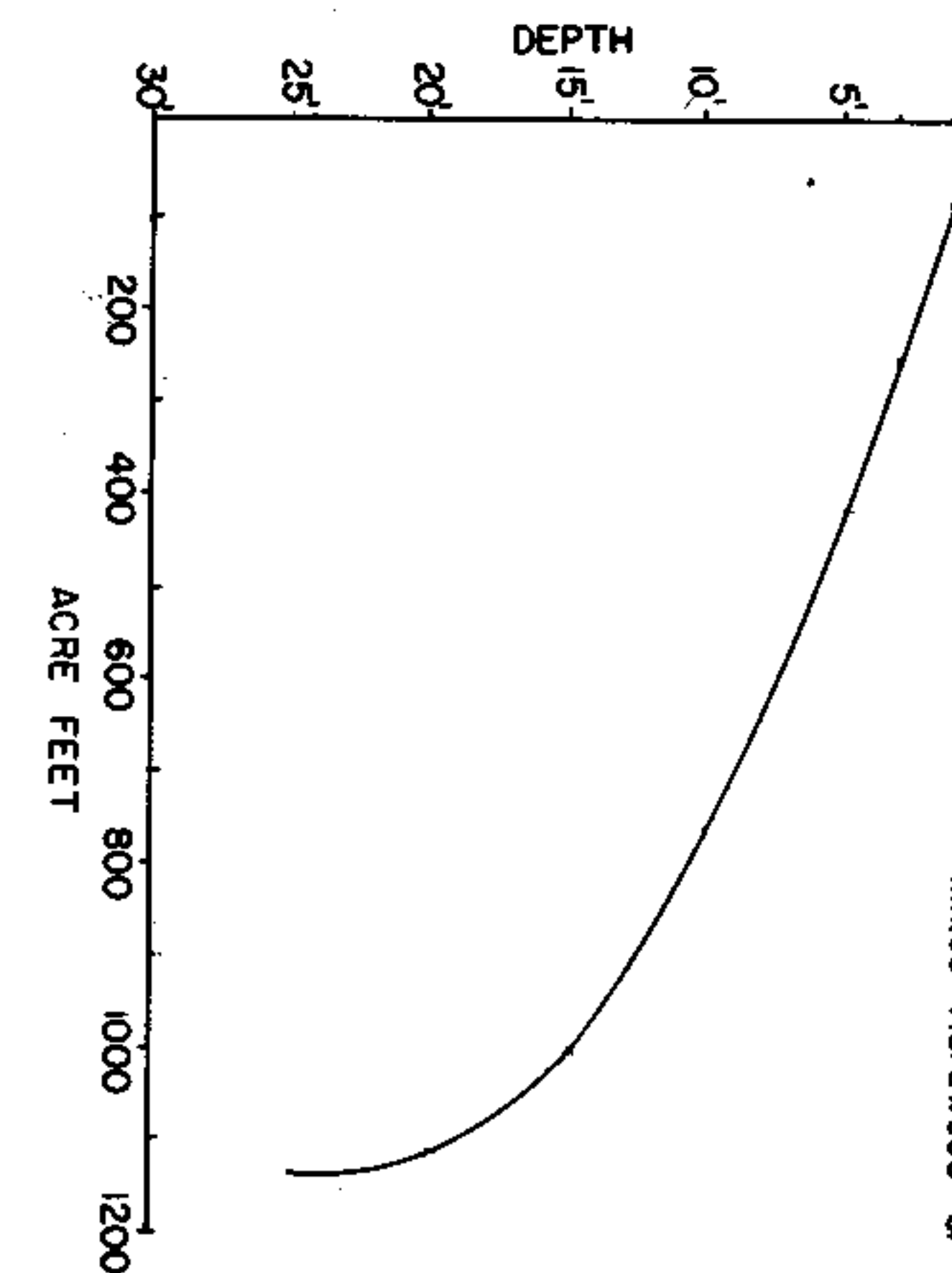
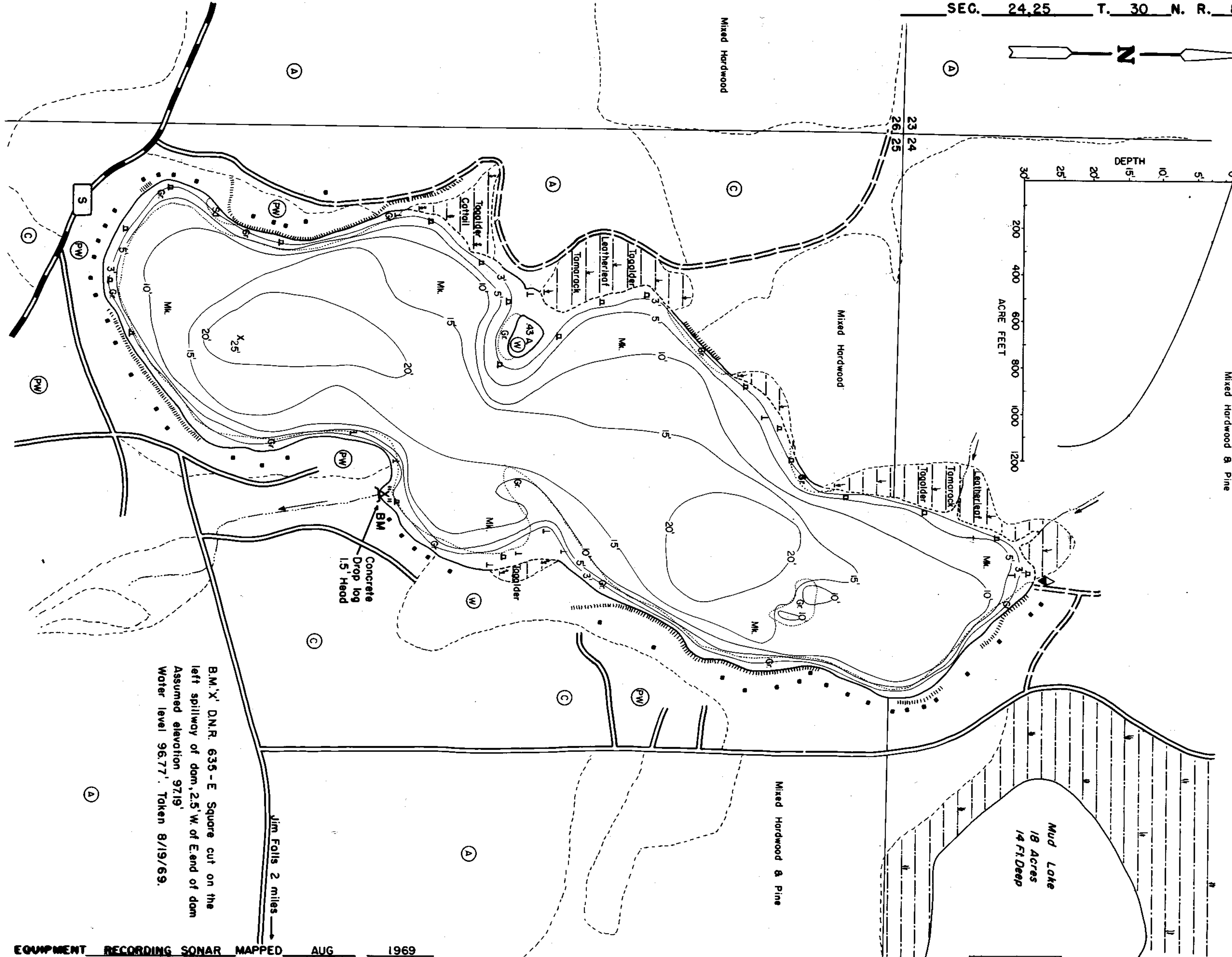

B.M. 'X' D.N.R. 635-E Square cut on the left spillway of dam, 2.5' W. of E. end of dam. Assumed elevation 9719'. Water level 96.77'. Taken 8/19/69.

EQUIPMENT RECORDING SONAR MAPPED

AUG 1969

- TOPOGRAPHIC SYMBOLS**
- ⊙ Brush
 - ⊙ Partially wooded
 - ⊙ Wooded
 - ⊙ Cleared
 - ⊙ Pastureland
 - ⊙ Agricultural
 - B.M. Bench Mark
 - ⊙ Ditching
 - ⊙ Restort
 - ⊙ Camp
 - ⊙ Steep slope
 - ⊙ Indefinite shoreline
 - ⊙ Marsh
 - ⊙ Spring
 - ⊙ Intermittent stream
 - ⊙ Permanent inlet
 - ⊙ Permanent outlet
 - ⊙ Dam
 - D.N.R. State owned land

- LAKE BOTTOM SYMBOLS**
- P. Peat
 - Mk. Muck
 - C. Clay
 - M. Marl
 - Sd. Sand
 - St. Silt
 - Gr. Gravel
 - R. Rubble
 - Bc. Bedrock
 - B Boulders
 - ⊙ Stumps & Snags
 - ⊙ Rock danger to navigation
 - T Submergent vegetation
 - ⊙ Emergent vegetation
 - ⊙ Floating vegetation
 - ⊙ Brush shelters



Access Access with Parking Boat Livery

Drawn by: C. Holt
Field work by: C. Busch, C. Belter, S. Johannes.

SPECIES OF FISH	WATER AREA		
	Under 3 FT.	3 to 20 FT.	Over 20 FT.
Muskie			
N. Pike		X	
Walleye		X	
L.M. Bass		X	
S.M. Bass		X	
Panfish	X		
Trout			

WATER AREA 900 ACRES
 UNDER 3 FT. 9 %
 OVER 20 FT. 10 %
 MAX. DEPTH 25 FEET.
 TOTAL ALK. 54 P.P.M.
 VOLUME 11399 ACRE FT.
 SHORELINE 1.97 MILES
 SHORELINE 2.06 MILES WITH IS.

Source: Wisconsin Department of Natural Resources 608-266-2621
Popple Lake – Chippewa County, Wisconsin DNR Lake Map
Date – Aug 1969 - Historical Lake Map - Not for Navigation
A Public Document - Please Identify the Source when using it.