

# LAKE SURVEY MAP

WISCONSIN CONSERVATION DEPARTMENT  
BIOLOGY DIVISION  
LAKE AND STREAM IMPROVEMENT SECTION

LAKE ODD  
SECTION 12 13  
TOWNSHIP 31 N  
RANGE 8 W  
TOWN OF CLEVELAND  
COUNTY CHIPPEWA

FORM FI-117

4 1/2 Mi. N. To M

3 1/2 Mi. N. On E  
To Firth School

16 1/2 Mi. W. To 70

7 Mi. E. To Cornell  
R.R. Station →

1 Mi. E. To E →

Spruce +  
Tamarack

SEC 12

SEC. 13

5 Mi. W. To Pine Corners  
School

3 Mi. S. On E To 64

363 Ft. S. To Black Lake.

2. AREA ACRES 2.  
0.2 TOTAL SHORELINE 0.2 Mi.  
MAX. DEPTH 28 Feet  
SCALE 1 inch Equals 33 Ft.

DATE April 30 1941  
COMPILED BY \_\_\_\_\_  
TRACED BY W.T.Z. (W.P.A.)  
SOURCE OF INFORMATION W.P.A. Lake Survey Project  
SOUNDINGS 66 Ft. Intervals  
DATES OF MAP REVISION \_\_\_\_\_  
WORK AGENCY W. P. A.

LAKE IMPROVEMENT RECORD			
TYPE	DATE		
BRUSH REFUGES			
SAPLING TANGLES			
SPAWNING BOXES			
MINNOW SPAWNERS			
TOTAL			

LEGEND	
	WEED BEDS
	ROCKY SHOALS
	Sd SAND
	Cl. CLAY
	Gr. GRAVEL
	Mk. MUCK
	DWELLING
	ABANDONED DWELLING
	RESORT

*Checked by  
W.P.S.-C.B.K.  
6-5-41*

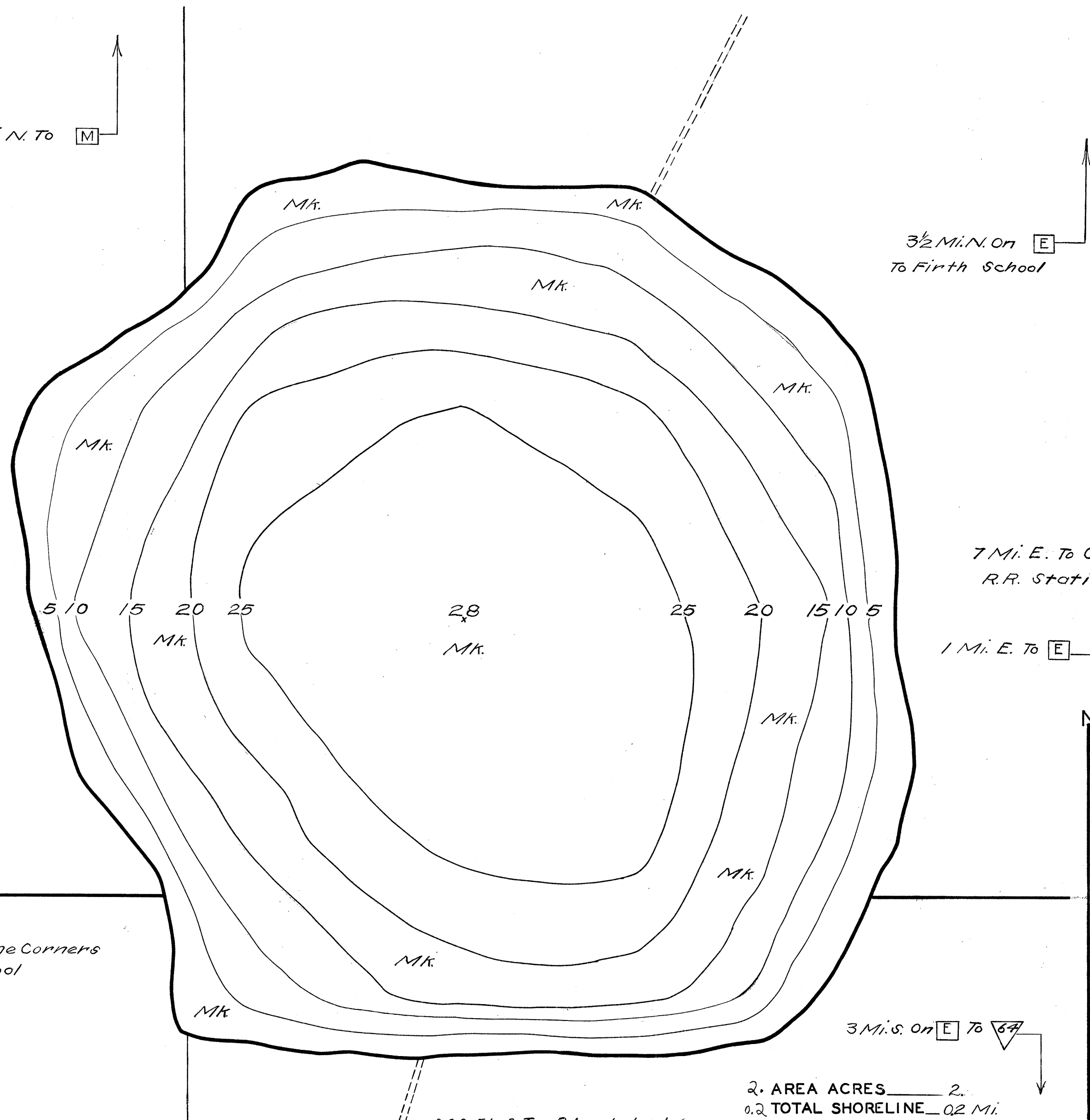

Source: Wisconsin Department of Natural Resources 608-266-2621  
Odd Lake – Chippewa County, Wisconsin DNR Lake Map  
Date – Apr 1941 - Historical Lake Map - Not for Navigation  
A Public Document - Please Identify the Source when using it.