

LAKE SURVEY MAP

DUROY LAKE PRICE COUNTY
SEC. 7,8,17,18 T. 37 N. R. 1 E.
Sheet "1" of "2"

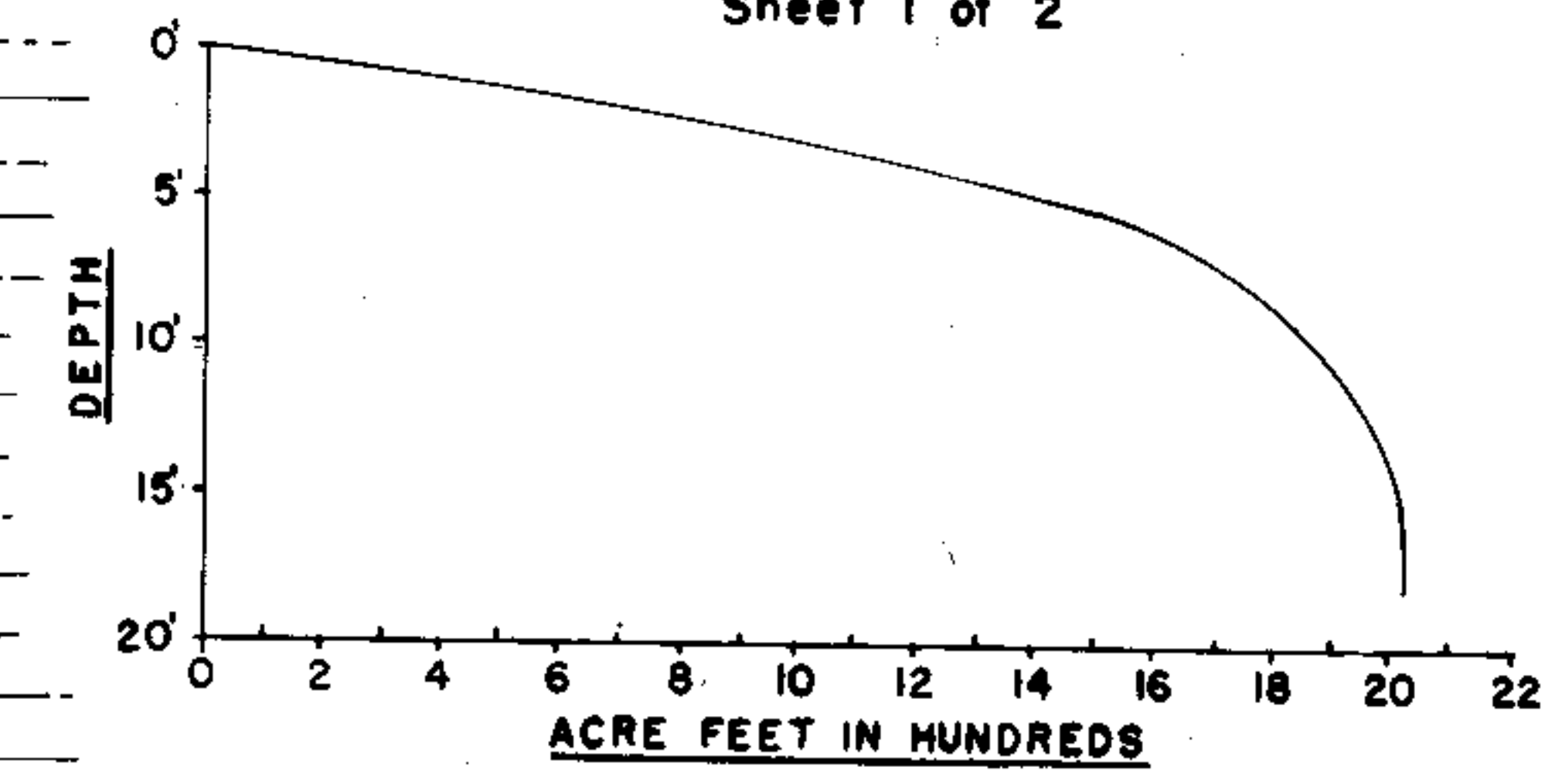
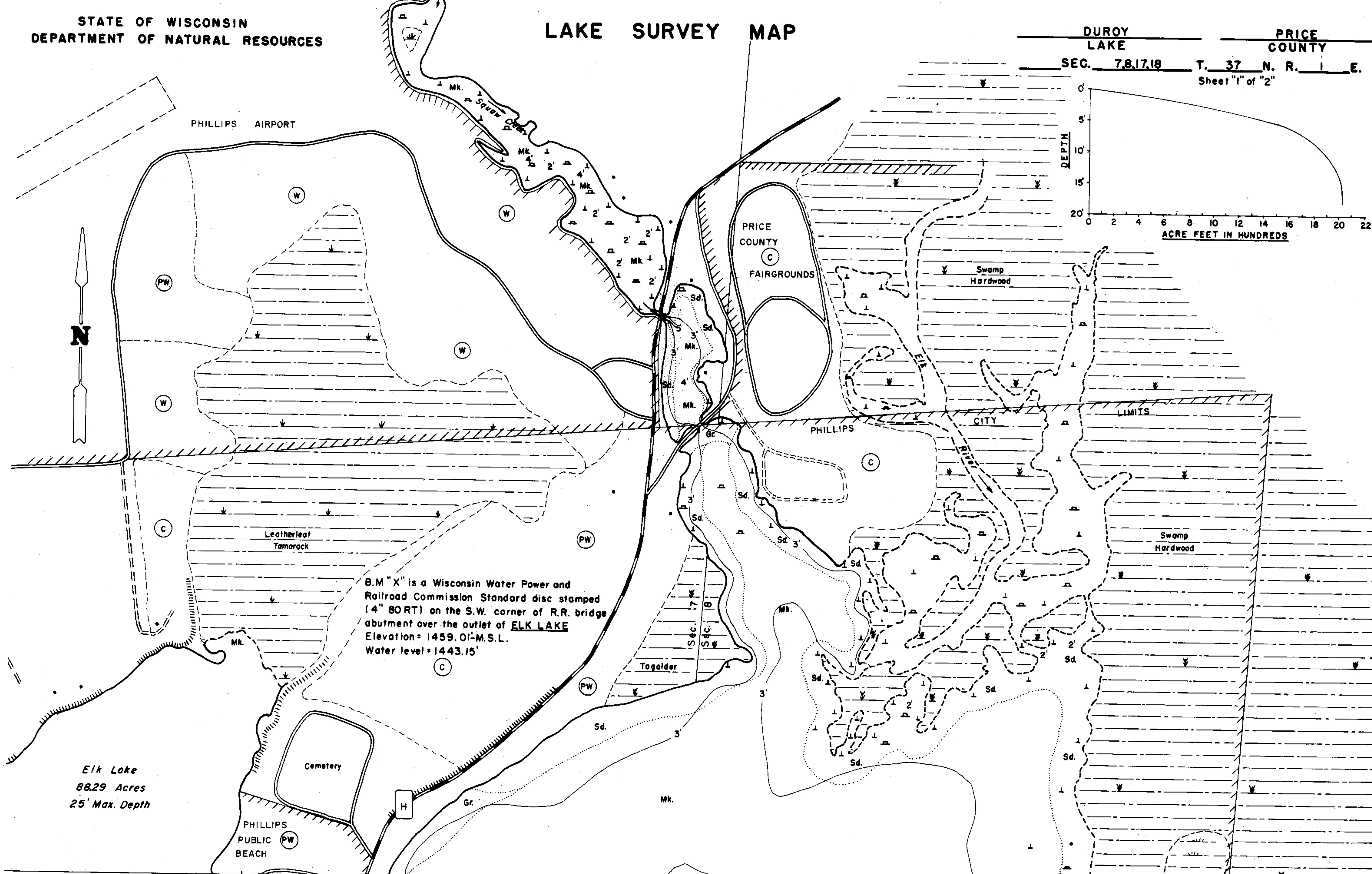

B.M. "X" is a Wisconsin Water Power and Railroad Commission Standard disc stamped (4" BORT) on the S.W. corner of R.R. bridge abutment over the outlet of ELK LAKE Elevation = 1459.01 M.S.L. Water level = 1443.15'

Elk Lake
88.29 Acres
25' Max. Depth

EQUIPMENT RECORDING SONAR MAPPED SEPT 1973
MONTH YEAR

- | TOPOGRAPHIC SYMBOLS | | LAKE BOTTOM SYMBOLS | |
|-----------------------|-------------------------------|---------------------|-----------------------------|
| (B) Brush | Steep slope | P. Peat | B. Boulders |
| (PW) Partially wooded | ----- Indefinite shoreline | Mk. Muck | o Stumps & Snags |
| (W) Wooded | ----- Marsh | C. Clay | o Rock danger to navigation |
| (C) Cleared | ----- Spring | M. Marl | T Submergent vegetation |
| (P) Pastured | ----- Intermittent stream | Sd. Sand | ↓ Emergent vegetation |
| (A) Agricultural | ----- Permanent inlet | St. Silt | ↑ Floating vegetation |
| B.M. Bench Mark | ----- Permanent outlet | Gr. Gravel | ↓ Brush shelters |
| ■ Dwelling | ----- Dam | R. Rubble | |
| □ Resort | ----- D.N.R. State owned land | Br. Bedrock | |
| □ Camp | | | |

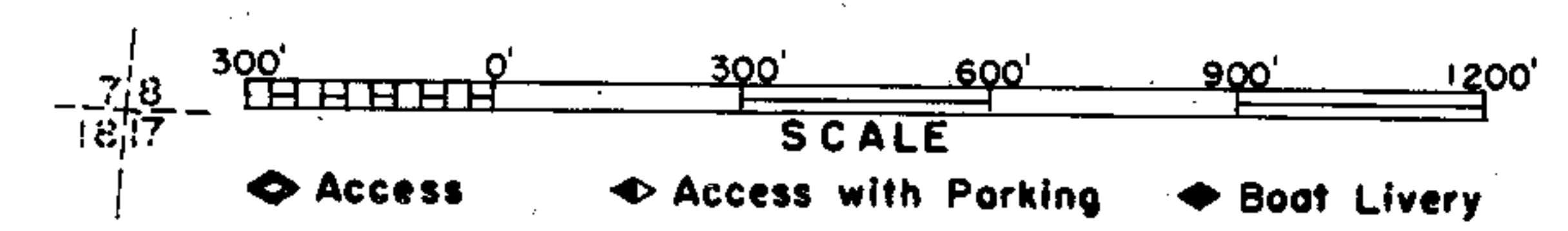

Drawn by: G. Thuesen
Field work by: C. Busch, K. Cable, L.M. Sather

SPECIES OF FISH	Abundance		
	Abundant	Common	Present
Muskie			X
N. Pike			X
Walleye	X		X
L.M. Bass			X
S.M. Bass			X
Panfish	X		
Trout			

WATER AREA 379.26 ACRES
UNDER 3 FT. 27 %
OVER 20 FT. 0 %
MAX. DEPTH 18 FEET.
TOTAL ALK. 22 P.P.M.
VOLUME 2016.6 ACRE FT.
MAIN SHORELINE 9.66 MI.
ISLAND SHORELINE 0.40 MI.

Sheet "1"
Sheet "2"

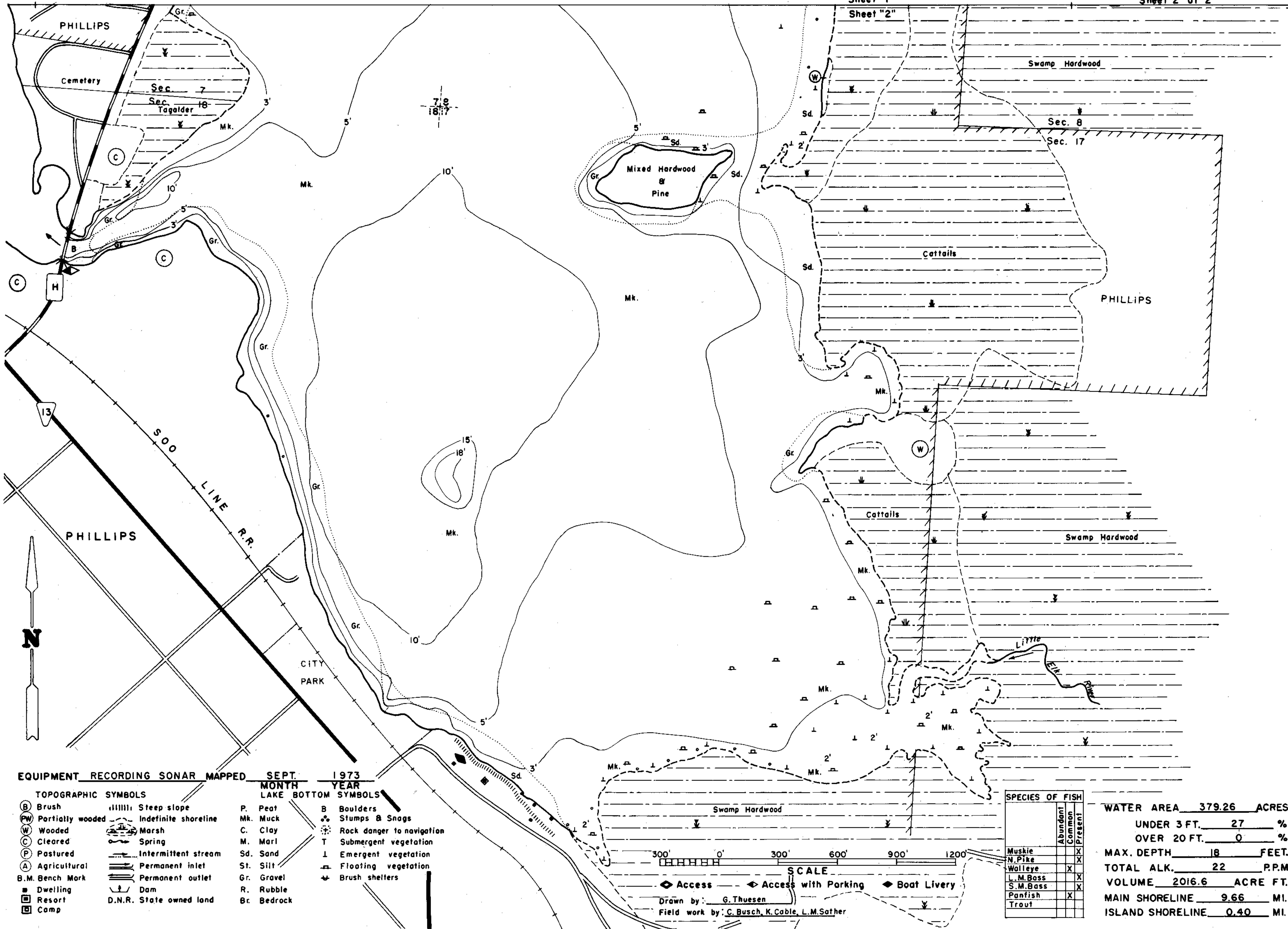

EQUIPMENT RECORDING SONAR MAPPED		SEPT. 1973	
TOPOGRAPHIC SYMBOLS		LAKE BOTTOM SYMBOLS	
(B) Brush	() Steep slope	P. Peat	B Boulders
(PW) Partially wooded	(---) Indefinite shoreline	Mk. Muck	(X) Stumps & Snags
(W) Wooded	(---) Marsh	C. Clay	(*) Rock danger to navigation
(C) Cleared	(---) Spring	M. Marl	(T) Submergent vegetation
(P) Pastured	(---) Intermittent stream	Sd. Sand	(L) Emergent vegetation
(A) Agricultural	(---) Permanent inlet	St. Silt	(F) Floating vegetation
B.M. Bench Mark	(---) Permanent outlet	Gr. Gravel	(S) Brush shelters
(D) Dwelling	(---) Dam	R. Rubble	
(R) Resort	(---) D.N.R. State owned land	Bc. Bedrock	
(C) Camp			

SPECIES OF FISH	ABUNDANCE		
	Abundant	Common	Present
Muskie			X
N. Pike			X
Walleye	X		X
L.M. Bass	X		X
S.M. Bass	X		X
Panfish	X		X
Trout			X

WATER AREA 379.26 ACRES
 UNDER 3 FT. 27 %
 OVER 20 FT. 0 %
 MAX. DEPTH 18 FEET.
 TOTAL ALK. 22 P.P.M.
 VOLUME 2016.6 ACRE FT.
 MAIN SHORELINE 9.66 MI.
 ISLAND SHORELINE 0.40 MI.

300' 0' 300' 600' 900' 1200'
 SCALE
 Access Access with Parking Boat Livery
 Drawn by: G. Thuesen
 Field work by: C. Busch, K. Cable, L.M. Sather

Source: Wisconsin Department of Natural Resources 608-266-2621
Duroy Lake – Price County, Wisconsin DNR Lake Map
Date – Sep 1973 - Historical Lake Map - Not for Navigation
A Public Document - Please Identify the Source when using it.