



LAKE SURVEY MAP

LAKE FULLER
 SECTION 3-10
 TOWNSHIP 39 N
 RANGE 4 E
 TOWN OF MINOCQUA
 COUNTY ONEIDA

FORM FH17

WISCONSIN CONSERVATION DEPARTMENT
 BIOLOGY DIVISION
 LAKE AND STREAM IMPROVEMENT SECTION

16 Mi. E On  To Minocqua
 2 1/2 Mi To 

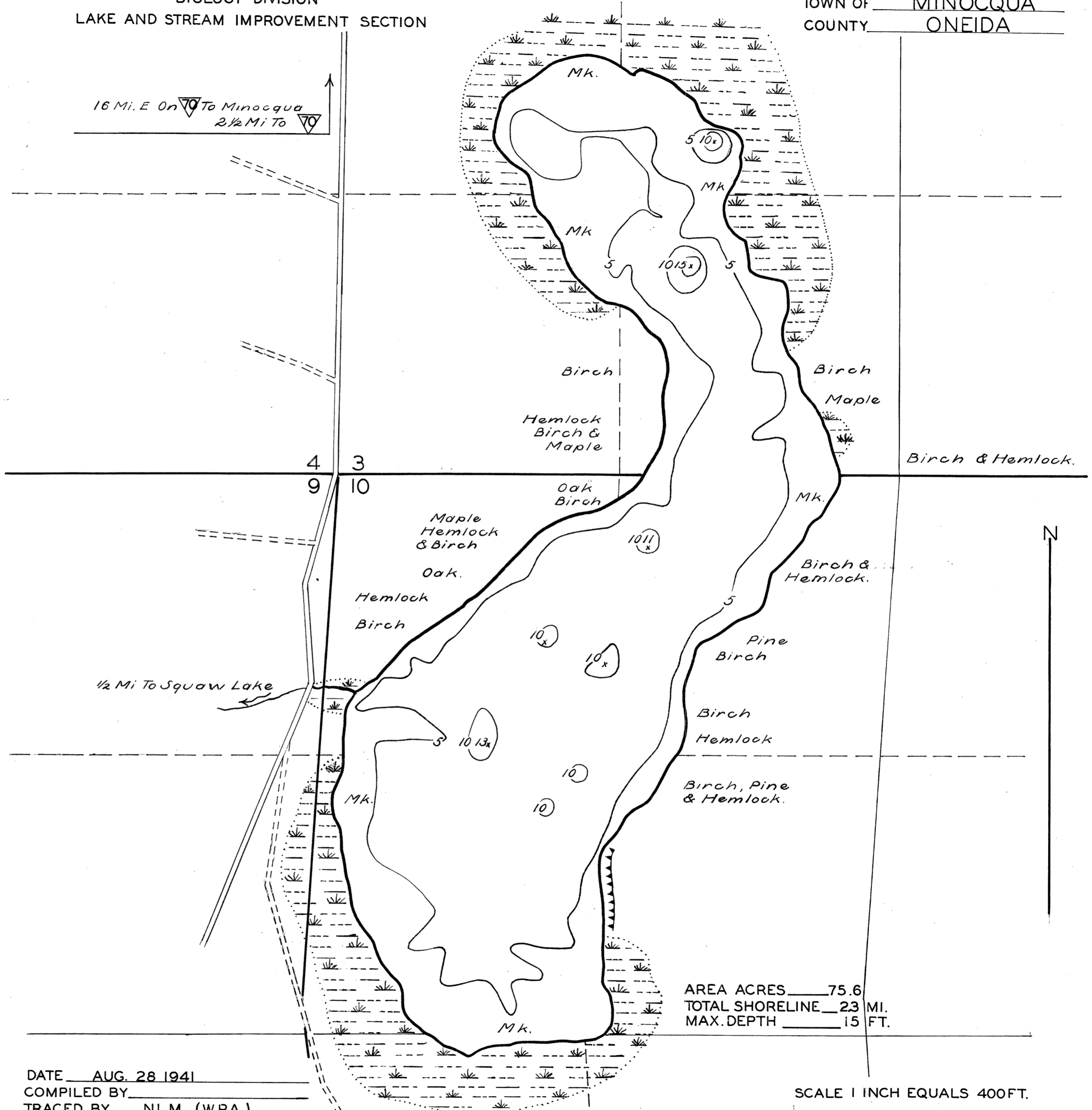

AREA ACRES 75.6
 TOTAL SHORELINE 23 MI.
 MAX. DEPTH 15 FT.

DATE AUG. 28 1941
 COMPILED BY _____
 TRACED BY N.L.M. (W.P.A.)
 SOURCE OF INFORMATION _____
CAMP BLUE LAKE C.C.C. 57-S
LAKE SURVEY PROJECT FEB. 1941
 SOUNDINGS AT 150 OR LESS FT.
 _____ INTERVALS
 DATES OF MAP REVISION _____
 WORK AGENCY C.C.C.

LAKE IMPROVEMENT RECORD

TYPE	DATE								
BRUSH REFUGES	_____	_____	_____	_____	_____	_____	_____	_____	_____
SAPLING TANGLES	_____	_____	_____	_____	_____	_____	_____	_____	_____
SPAWNING BOXES	_____	_____	_____	_____	_____	_____	_____	_____	_____
MINNOW SPAWNERS	_____	_____	_____	_____	_____	_____	_____	_____	_____
TOTAL	_____	_____	_____	_____	_____	_____	_____	_____	_____

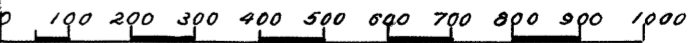
SCALE 1 INCH EQUALS 400 FT.

- LEGEND**
- WEED BEDS
 - ROCKY SHOALS
 - SD. SAND
 - CL. CLAY
 - GR. GRAVEL
 - MK. MUCK
 - DWELLING
 - ABANDONED DWELLING
 - RESORT
 - STEEP SLOPE

Source: Wisconsin Department of Natural Resources 608-266-2621
Fuller Lake – Oneida County, Wisconsin DNR Lake Map
Date – Aug 1941 - Historical Lake Map - Not for Navigation
A Public Document - Please Identify the Source when using it.