

B.M. "X" is a railroad spike in the base of a 24" White Pine, located 9' East of center of access road and 87' North of lake on the North side of lake.
Assumed Elevation = 100.00'
Water level = 94.93'

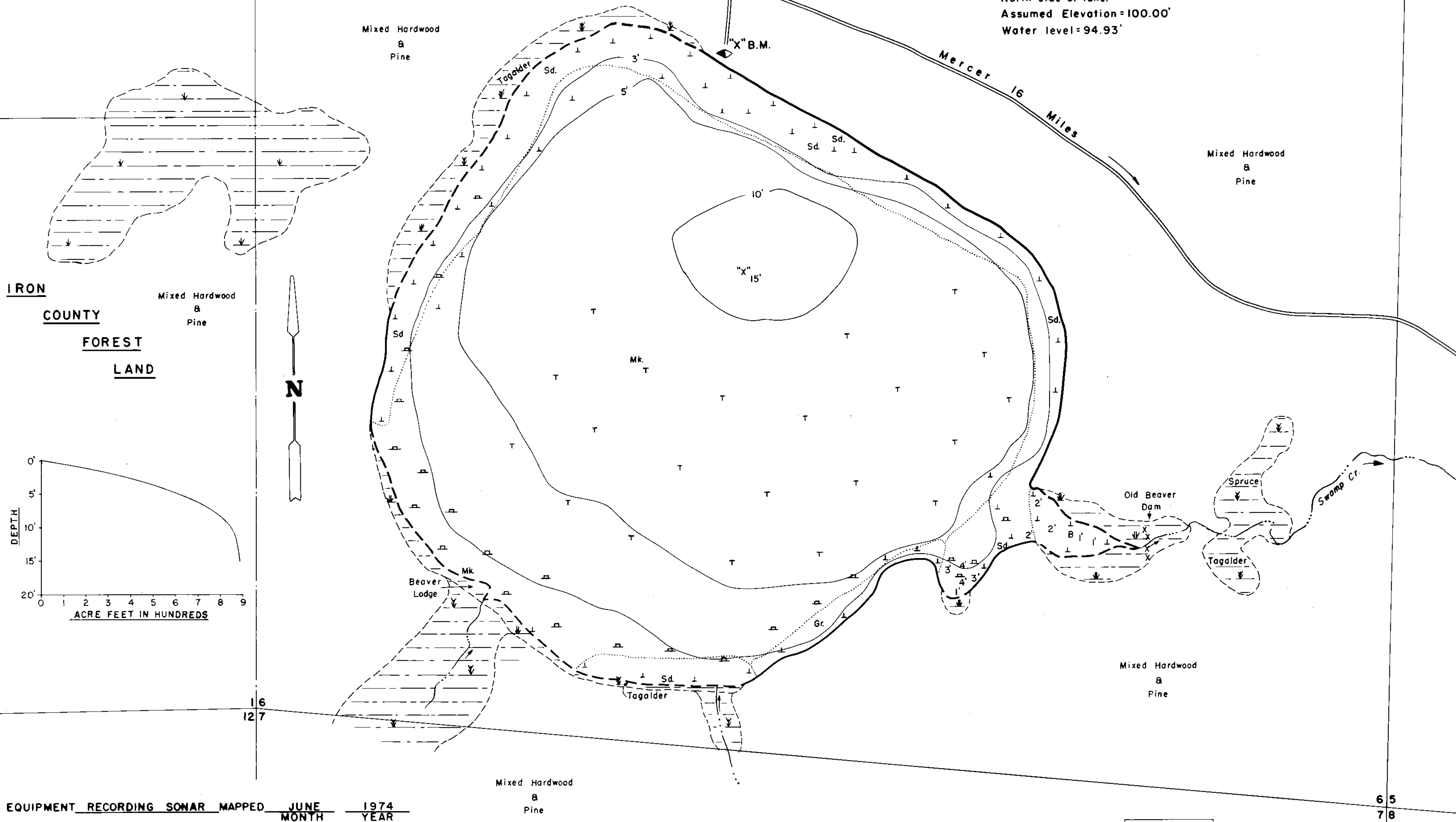

IRON COUNTY FOREST LAND
Mixed Hardwood & Pine

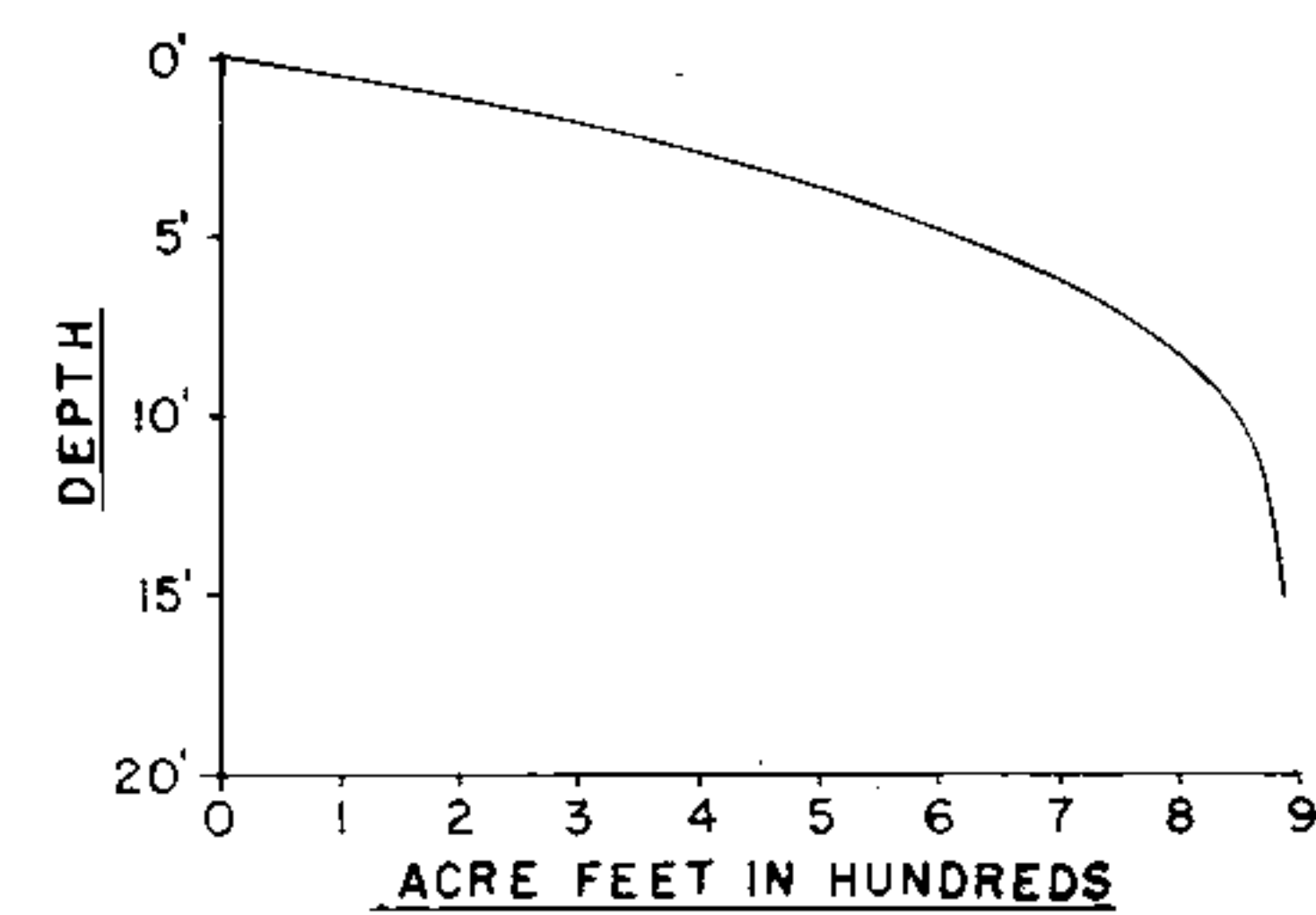

EQUIPMENT RECORDING SONAR MAPPED MONTH YEAR
JUNE 1974

- | TOPOGRAPHIC SYMBOLS | | LAKE BOTTOM SYMBOLS | |
|-----------------------|----------------------------|---------------------|-----------------------------|
| (B) Brush | Steep slope | P. Peat | B Boulders |
| (PW) Partially wooded | - - - Indefinite shoreline | Mk. Muck | ⊙ Stumps & Snags |
| (W) Wooded | Marsh | C. Clay | ⊙ Rock danger to navigation |
| (C) Cleared | Spring | M. Marl | T Submergent vegetation |
| (P) Pastured | Intermittent stream | Sd. Sand | ⊥ Emergent vegetation |
| (A) Agricultural | Permanent inlet | St. Silt | ⊥ Floating vegetation |
| B.M. Bench Mark | Permanent outlet | Gr. Gravel | ⊥ Brush shelters |
| ■ Dwelling | Dam | R. Rubble | |
| □ Resort | D.N.R. State owned land | Br. Bedrock | |
| ⊠ Camp | | | |



Access Access with Parking Boat Livery
Drawn by: G. Thuesen
Field work by: C. Busch, K. Cople, L. Sather

SPECIES OF FISH	Abundance		
	Abundant	Common	Present
Muskie			
N. Pike			X
Walleye			
L. M. Bass			
S. M. Bass			
Panfish			X
Trout			

WATER AREA 148.3 ACRES
UNDER 3 FT. 18 %
OVER 20 FT. 0 %
MAX. DEPTH 15 FEET.
TOTAL ALK. 34 P.P.M.
VOLUME 885.8 ACRE FT.
MAIN SHORELINE 1.96 MI.
ISLAND SHORELINE 0 MI.

Source: Wisconsin Department of Natural Resources 608-266-2621
Six Lake - Iron County, Wisconsin DNR Lake Map
Date: Jun 1974 - Historical Lake Map - Not for Navigation
A Public Document - Please Identify the Source when using it.