

Bench Mark 1405-A is a Chiseled square on N.E. corner of a concrete pump platform on north side of lake by public access
Assumed Elevation 100.00'
Water Elevation 90.01' taken 7/15/68

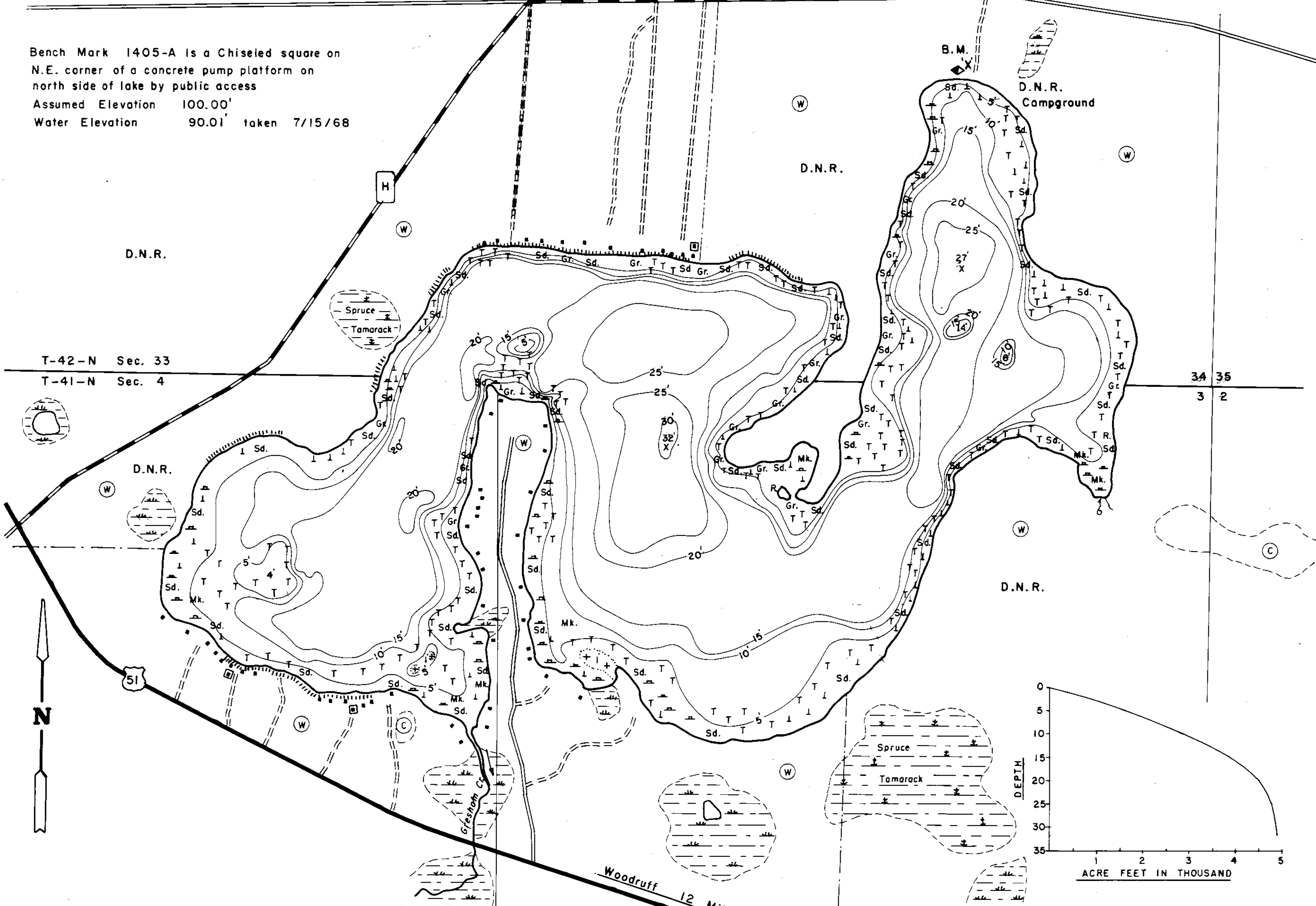

EQUIPMENT RECORDING SONAR MAPPED SEPT. 1968
MONTH YEAR

- | TOPOGRAPHIC SYMBOLS | | LAKE BOTTOM SYMBOLS | |
|-----------------------|----------------------------|---------------------|-----------------------------|
| (B) Brush | Steep slope | P. Peat | B Boulders |
| (PW) Partially wooded | - - - Indefinite shoreline | Mk. Muck | ⊙ Stumps & Snags |
| (W) Wooded | ⊞ Marsh | C. Clay | ⊛ Rock danger to navigation |
| (C) Cleared | ○ Spring | M. Marl | T Submergent vegetation |
| (P) Pastured | - - - Intermittent stream | Sd. Sand | ⊥ Emergent vegetation |
| (A) Agricultural | ≡ Permanent inlet | Sl. Silt | ⊥ Floating vegetation |
| B.M. Bench Mark | ≡ Permanent outlet | Gr. Gravel | ⊥ Brush shelters |
| ■ Dwelling | ⊥ Dam | R. Rubble | |
| ⊞ Resort | ⊞ D.N.R. State owned land | Bc. Bedrock | |
| ⊞ Camp | | | |

500' 0 500' 1,000' 1,500' 2,000'
SCALE
◆ Access ◆ Access with Parking ◆ Boat Livery
Drawn by: E. Eaton
Field work by: J. Smith, R. Theis

SPECIES OF FISH	Abundance		
	Abundant	Common	Present
Muskie		X	
N. Pike		X	
Walleye		X	
L.M. Bass		X	
S.M. Bass		X	
Panfish	X		
Trout			

WATER AREA 365.5 ACRES
UNDER 3 FT. 12 %
OVER 20 FT. 20 %
MAX. DEPTH 32 FEET.
TOTAL ALK. 39 P.P.M.
VOLUME 4,869.5 ACRE FT.
SHORELINE 5.79 MILES

Source: Wisconsin Department of Natural Resources 608-266-2621
Upper Gresham Lake - Vilas County, Wisconsin DNR Lake Map
Date – Sep 1968 - Historical Lake Map - Not for Navigation
A Public Document - Please Identify the Source when using it.