

LAKE SURVEY MAP

LITTLE ROUND LAKE
SAWYER COUNTY
SEC. 1, 2, 35, 36 T. 41 N. R. 8 W.

Round Lake
2783.5 Acres
74' Deep

B.M. 'X' D.N.R. 1127-D Square cut
in the S. curb of C.T.H. 'B'
Assumed elevation 83.69'
Water level 77.65'
Maximum level 77.25'

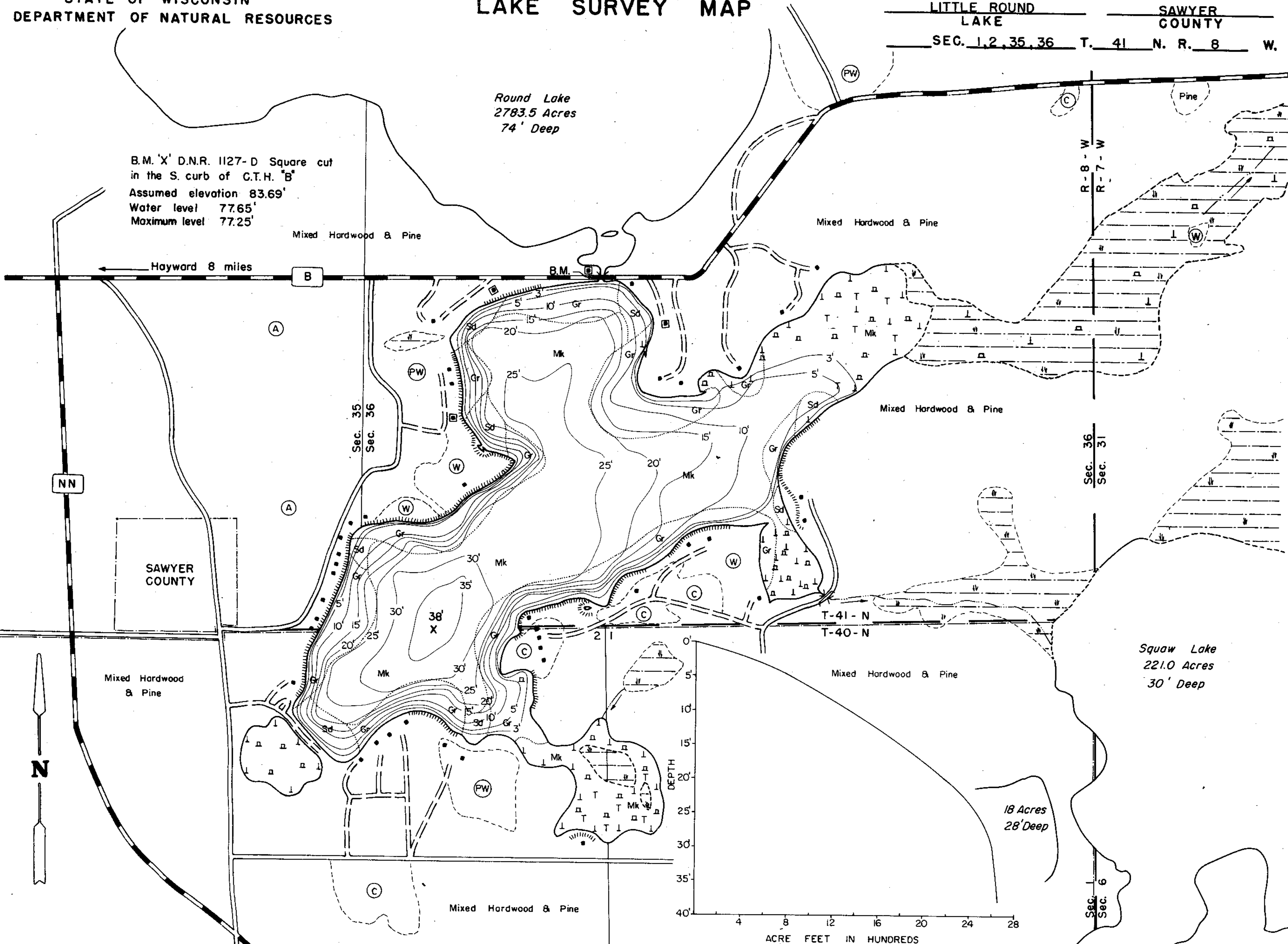

Squaw Lake
221.0 Acres
30' Deep

18 Acres
28' Deep

- EQUIPMENT RECORDING SONAR MAPPED OCT 1972
- | TOPOGRAPHIC SYMBOLS | | LAKE BOTTOM SYMBOLS | |
|-----------------------|-------------------------------|---------------------|---------------------------------|
| (B) Brush | () Steep slope | P. Peat | B Boulders |
| (PW) Partially wooded | (---) Indefinite shoreline | Mk. Muck | ⊙ Stumps & Snags |
| (W) Wooded | (---) Marsh | C. Clay | (---) Rock danger to navigation |
| (C) Cleared | (---) Spring | M. Marl | T Submergent vegetation |
| (P) Pastured | (---) Intermittent stream | Sd. Sand | ⊥ Emergent vegetation |
| (A) Agricultural | (---) Permanent inlet | St. Silt | (---) Floating vegetation |
| B.M. Bench Mark | (---) Permanent outlet | Gr. Gravel | (---) Brush shelters |
| (■) Dwelling | (---) Dam | R. Rubble | |
| (■) Resort | (---) D.N.R. State owned land | Br. Bedrock | |
| (■) Camp | | | |

LAC COURT ORELLES INDIAN RESERVATION



◆ Access ◆ Access with Parking ◆ Boat Livery

Drawn by: C. Holt
Field work by: C. Busch, G. Lund, L. Sother

SPECIES OF FISH	ABUNDANCE		
	Abundant	Common	Present
Muskie		X	
N. Pike	X		
Walleye	X		
L. M. Bass		X	
S. M. Bass	X		
Panfish	X		
Trout			X
Cisco			X

WATER AREA 228.7 ACRES
 UNDER 3 FT. 41 %
 OVER 20 FT. 29 %
 MAX. DEPTH 38 FEET.
 TOTAL ALK. 47 P.P.M.
 VOLUME 2653 ACRE FT.
 SHORELINE 6.4 MILES
 SHORELINE 6.5 MILES WITH IS.

Source: Wisconsin Department of Natural Resources 608-266-2621
Little Round Lake – Sawyer County, Wisconsin DNR Lake Map
Date – Oct 1972 - Historical Lake Map - Not for Navigation
A Public Document - Please Identify the Source when using it.