

LAKE SURVEY MAP

Lower Clam Lake

WISCONSIN DEPARTMENT OF NATURAL RESOURCES  
BIOLOGY DIVISION  
LAKE AND STREAM IMPROVEMENT SECTION

SECTION 1, 2, 11, 12  
TOWNSHIP 42  
RANGE 5  
SPIDER LAKE  
COUNTY SAWYER

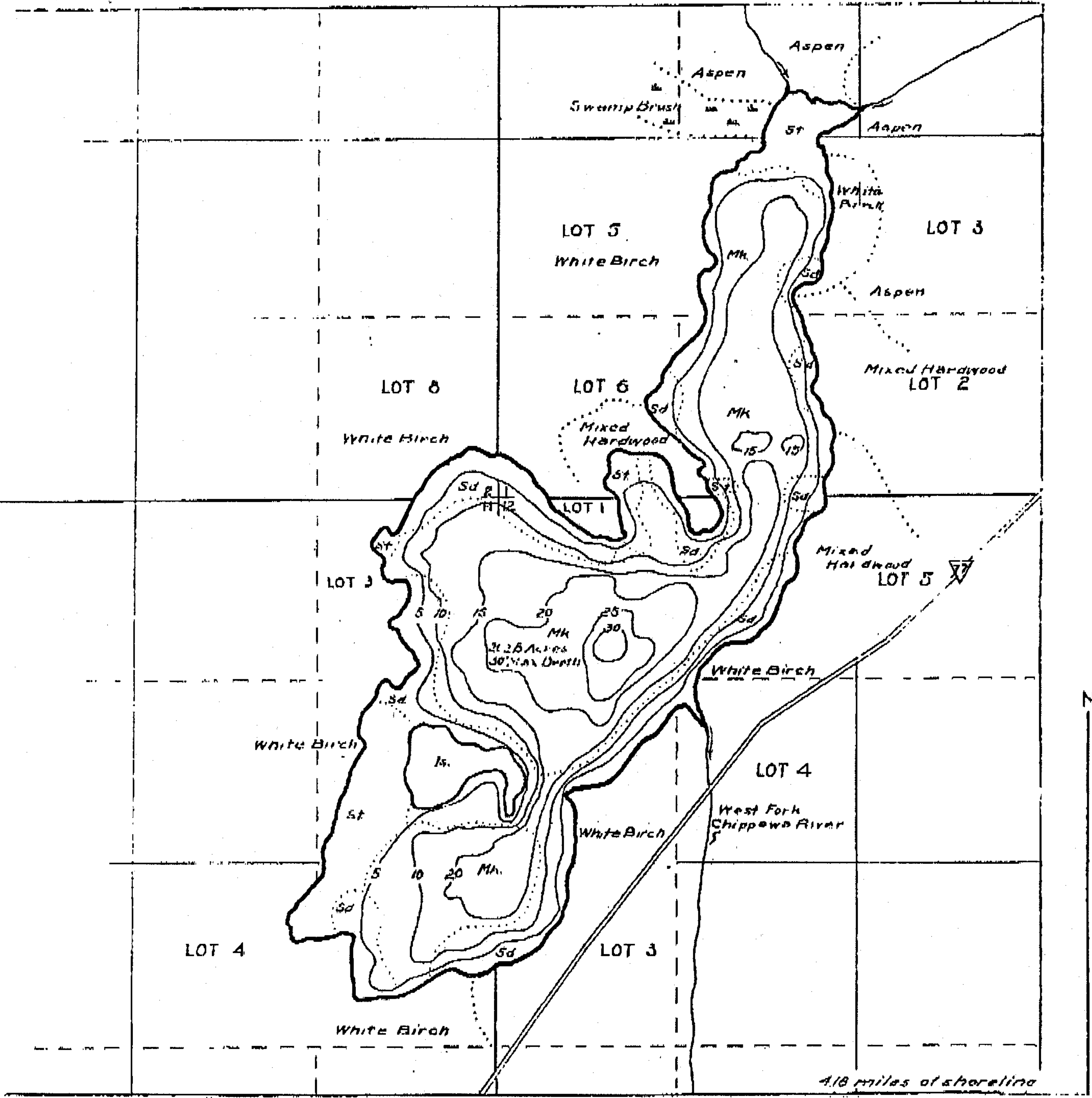

September 6, 1938  
COMPILED BY  
DRAWN BY L. E. K.  
SOURCE OF INFORMATION  
U.S. Forest Service  
Lake and Stream Survey  
FINDINGS  
REVISIONS OF MAP REVISION  
AGENCY W. P. A.

LAKE IMPROVEMENT RECORD

TYPE	DATE	TOTAL
BRUSH REFUGES		
SAPLING TANGLES		
SPAWNING BOXES		
MINNOW SPAWNERS		

SCALE: 8 inches = 1 mile

- LEGEND
- BRUSH REFUGES
  - ⊖ SAPLING TANGLES
  - SPAWNING BOXES
  - MINNOW SPAWNERS
  - Sd SAND
  - Cl CLAY
  - Cr GRAVEL
  - Mk MUCK
  - St SILT

Source: Wisconsin Department of Natural Resources 608-266-2621  
Lower Clam Lake – Sawyer County, Wisconsin DNR Lake Map  
Date – Sep 1938 - Historical Lake Map - Not for Navigation  
A Public Document - Please Identify the Source when using it.