

LAKE SURVEY MAP

WHITE BASS LAKE
BAYFIELD COUNTY
SEC. 25 T. 43 N. R. 5 E.W.

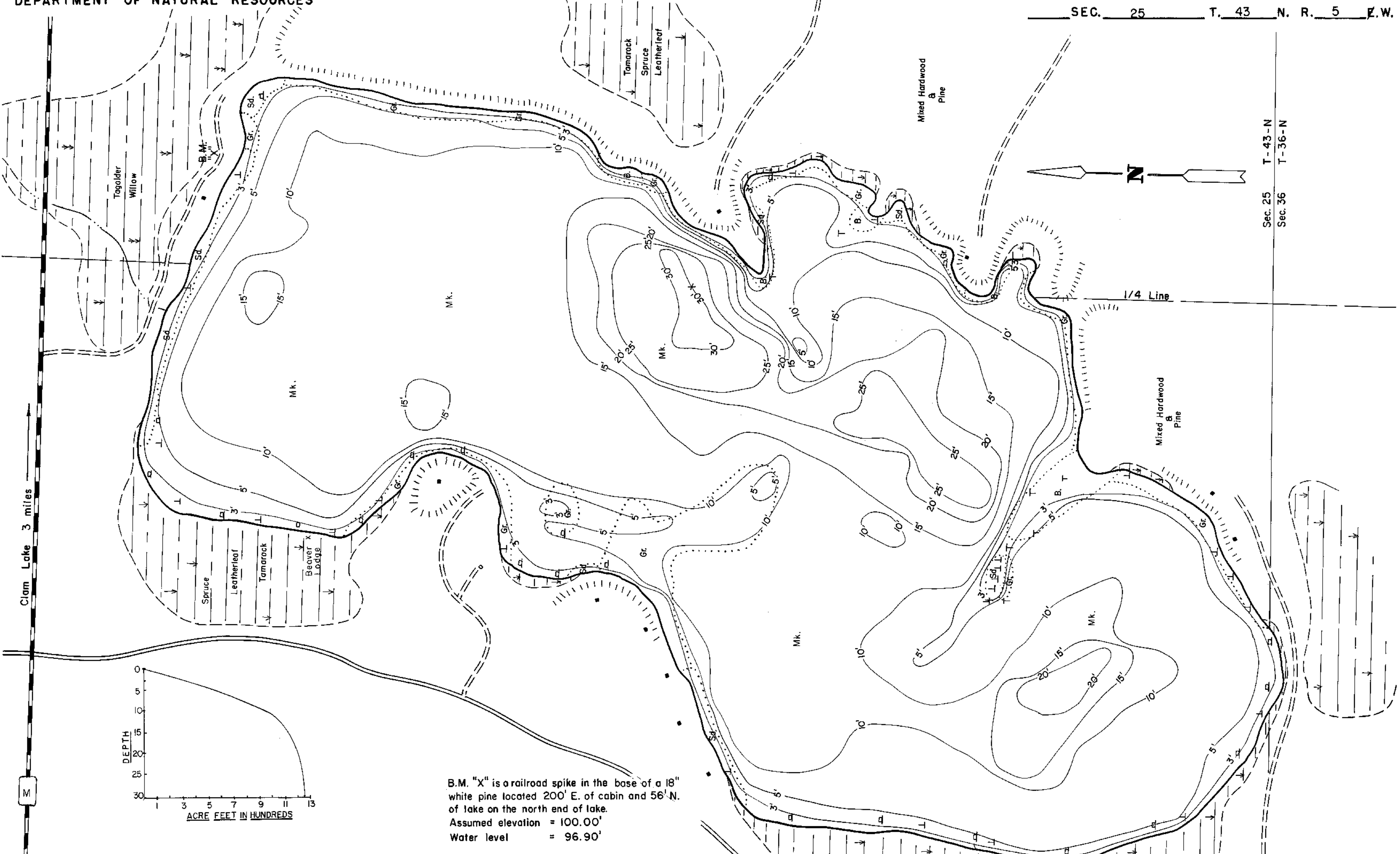

Clam Lake 3 miles

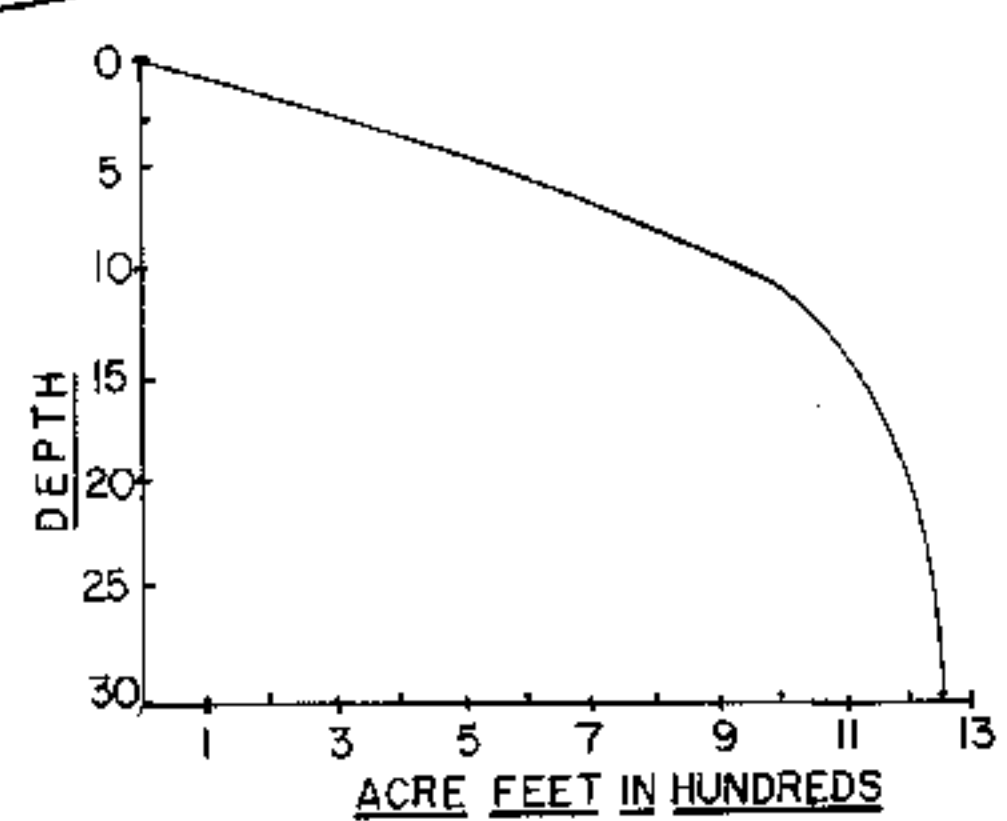

B.M. "X" is a railroad spike in the base of a 18" white pine located 200' E. of cabin and 56' N. of lake on the north end of lake.
Assumed elevation = 100.00'
Water level = 96.90'

EQUIPMENT RECORDING SONAR MAPPED JULY 1978

TOPOGRAPHIC SYMBOLS		LAKE BOTTOM SYMBOLS	
(B) Brush	Steep slope	P. Peat	B Boulders
(PW) Partially wooded	----- Indefinite shoreline	Mk. Muck	o Stumps & Snags
(W) Wooded	Marsh	C. Clay	⊗ Rock danger to navigation
(C) Cleared	o Spring	M. Marl	T Submergent vegetation
(P) Pastured	--- Intermittent stream	Sd. Sand	⊥ Emergent vegetation
(A) Agricultural	Permanent inlet	St. Silt	⊥ Floating vegetation
B.M. Bench Mark	Permanent outlet	Gr. Gravel	⊥ Brush shelters
■ Dwelling	⊥ Dam	R. Rubble	
■ Resort	--- D.N.R. State owned land	Br. Bedrock	
⊠ Camp			

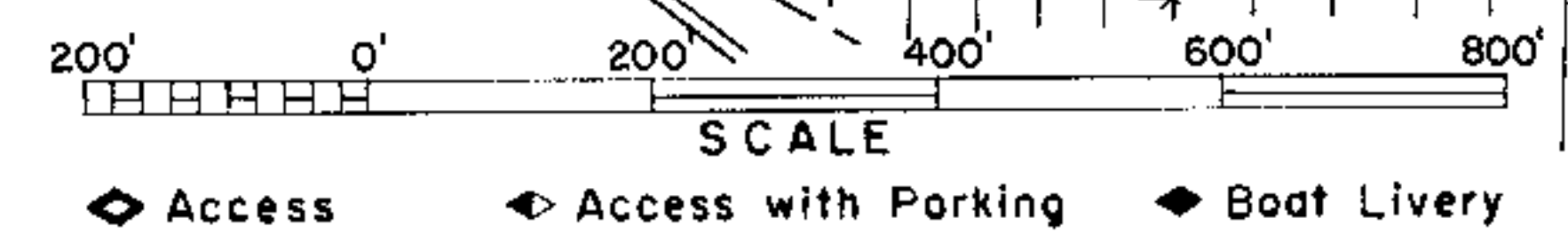

SPECIES OF FISH	Abundance		
	Abundant	Common	Present
Muskie			X
N. Pike			X
Walleye			
L. M. Bass			X
S. M. Bass			
Panfish		X	
Trout			

WATER AREA 111.7 ACRES
 UNDER 3 FT. 6 %
 OVER 20 FT. 9 %
 MAX. DEPTH 30 FEET.
 TOTAL ALK. 13 P.P.M.
 VOLUME 1256.95 ACRE FT.
 MAIN SHORELINE 2.12 MI.
 ISLAND SHORELINE 0 MI.

Drawn by: R. Williams
 Field work by: C. Busch, K. Cable, J. Sather

Source: Wisconsin Department of Natural Resources 608-266-2621
White Bass Lake – Bayfield County, Wisconsin DNR Lake Map
Date – Jul 1978 - Historical Lake Map - Not for Navigation
A Public Document - Please Identify the Source when using it.