

B.M. 'X' Railroad spike set in S. side of double
10" elm tree, 25' S. of centerline of town road,
12' E. of mobile home and 45' N. of lake
Assumed elevation 100.00'
Water level 95.58'

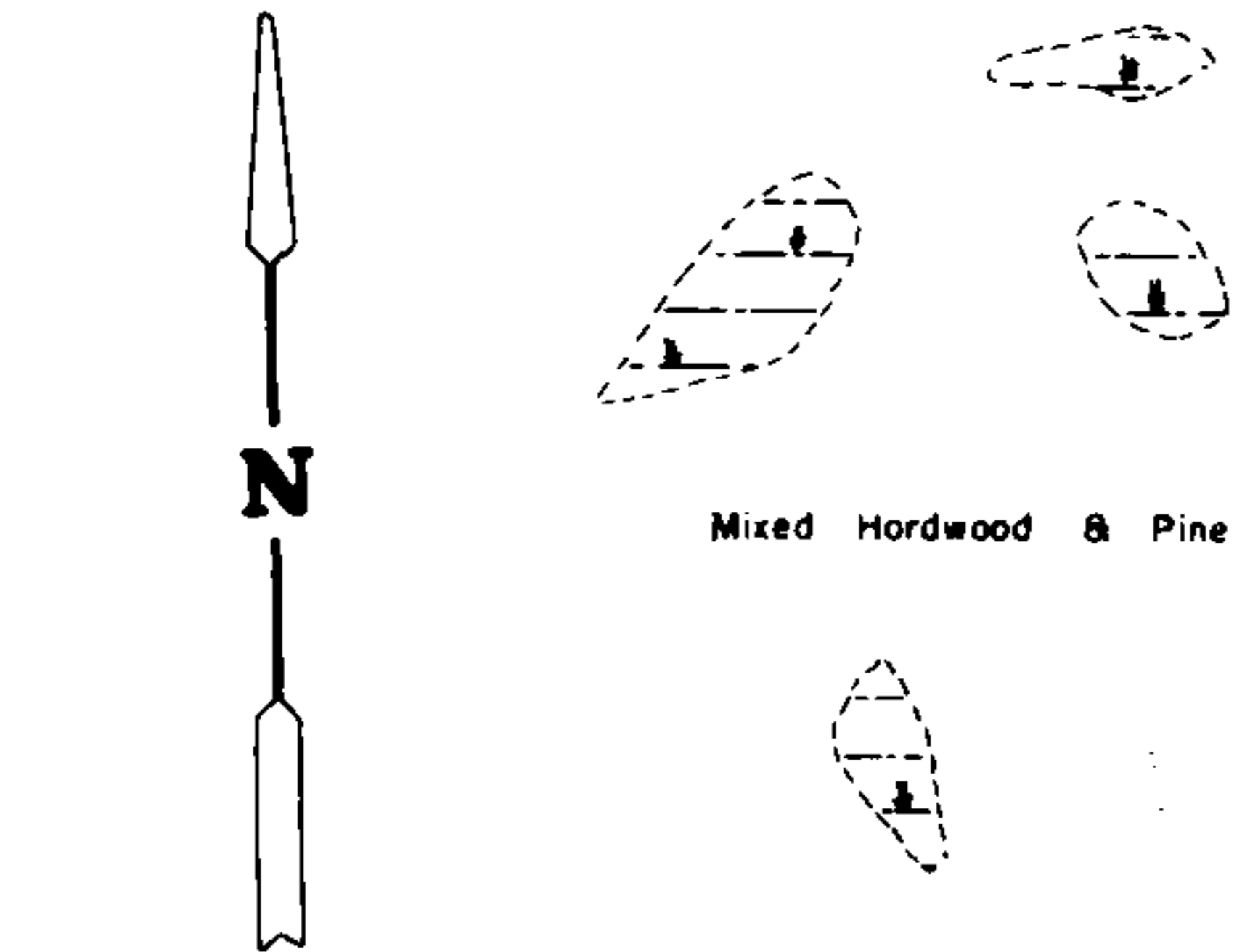
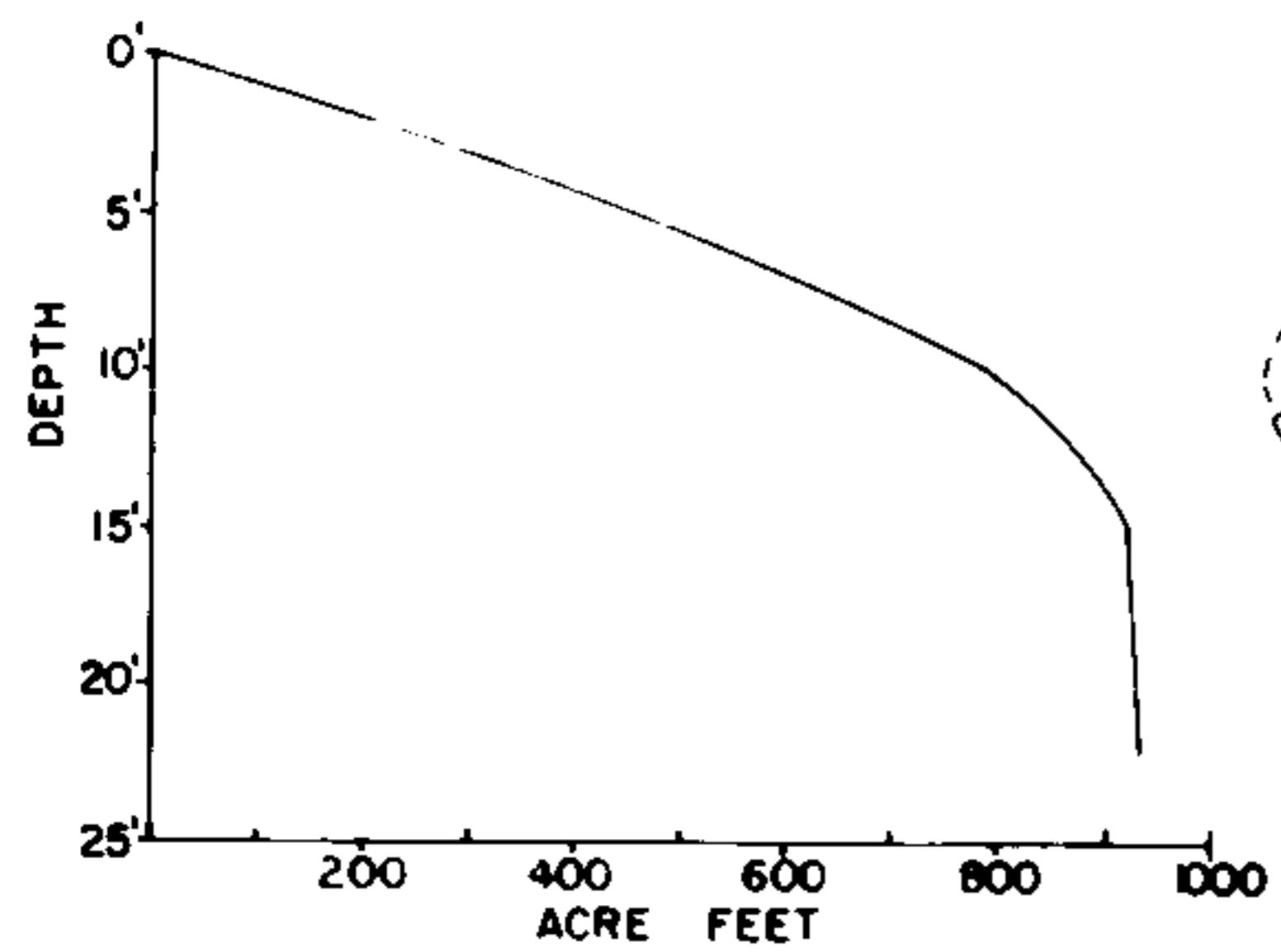
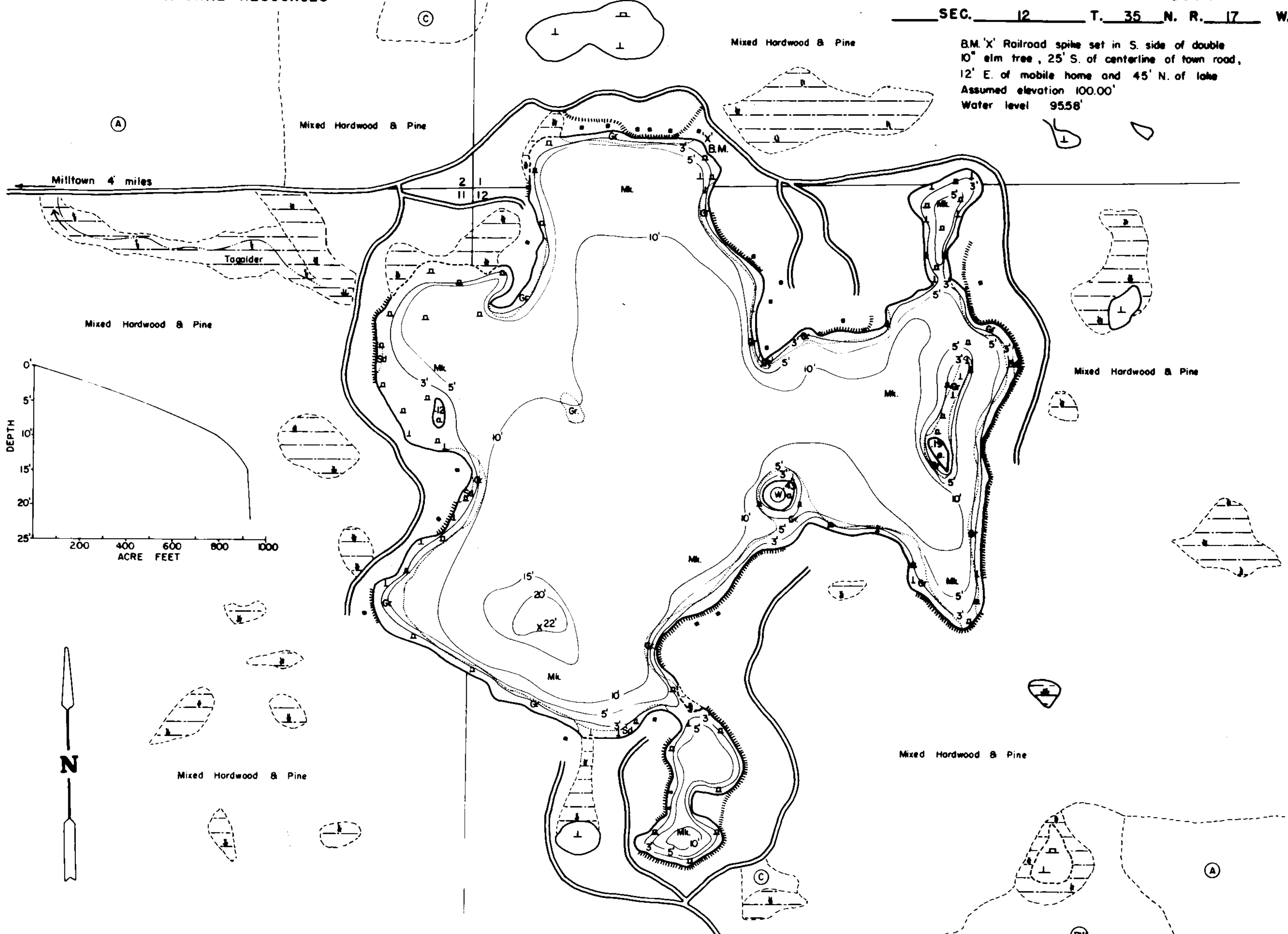

EQUIPMENT RECORDING SONAR MAPPED AUG 1969
MONTH YEAR

- TOPOGRAPHIC SYMBOLS**
- (B) Brush
 - (PW) Partially wooded
 - (W) Wooded
 - (C) Cleared
 - (P) Pastured
 - (A) Agricultural
 - B.M. Bench Mark
 - Dwelling
 - Resort
 - ⊠ Camp

- LAKE BOTTOM SYMBOLS**
- P. Peat
 - Mk. Muck
 - C. Clay
 - M. Marl
 - Sd. Sand
 - Sf. Silt
 - Gr. Gravel
 - R. Rubble
 - Bc. Bedrock
 - B Boulders
 - ⊙ Stumps & Snags
 - ⊙ Rock danger to navigation
 - T Submergent vegetation
 - ⊙ Emergent vegetation
 - ⊙ Floating vegetation
 - ⊙ Brush shelters



◆ Access ◆ Access with Parking ◆ Boat Livery

Drawn by: C. Holt
Field work by: C. Busch, C. Belter, S. Johannes

SPECIES OF FISH	Abundant Common Present		
	Abundant	Common	Present
Muskie			
N. Pike		X	
Walleye			
L. M. Bass		X	
S. M. Bass			
Panfish	X		
Trot			

WATER AREA 101.4 ACRES
 UNDER 3 FT. 12 %
 OVER 20 FT. 1.0 %
 MAX. DEPTH 22 FEET.
 TOTAL ALK. 14 P.P.M.
 VOLUME 932.4 ACRE FT.
 SHORELINE 2.77 MILES
 SHORELINE 2.97 MILES WITH IS.

Source: Wisconsin Department of Natural Resources 608-266-2621
Antler Lake – Polk County, Wisconsin DNR Lake Map
Date – Aug 1969 - Historical Lake Map - Not for Navigation
A Public Document - Please Identify the Source when using it.