

LAKE SURVEY MAP

BAKER LAKE
WASHBURN COUNTY
SEC. 2,3,10,11 T. 38 N. R. 11 W.

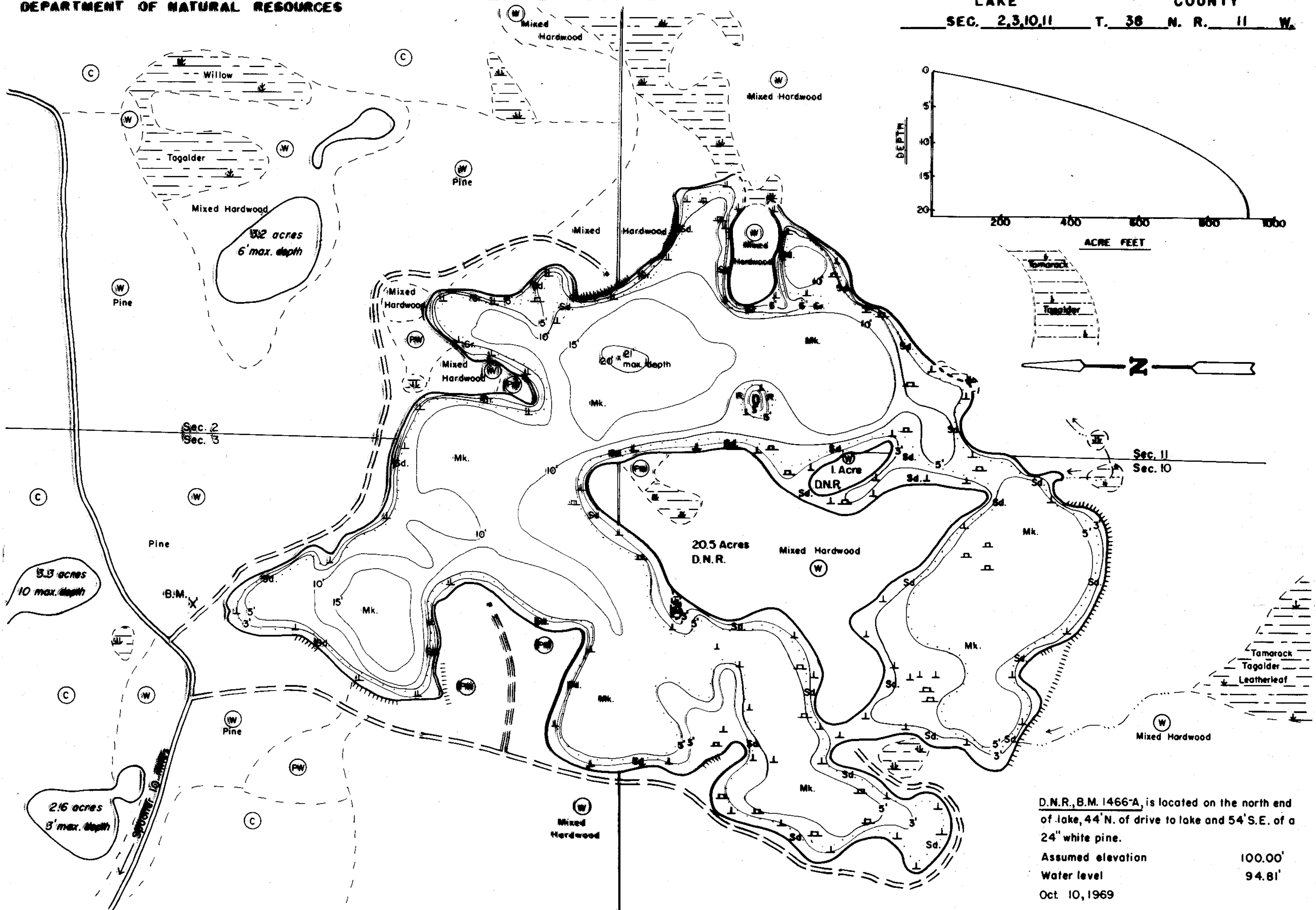
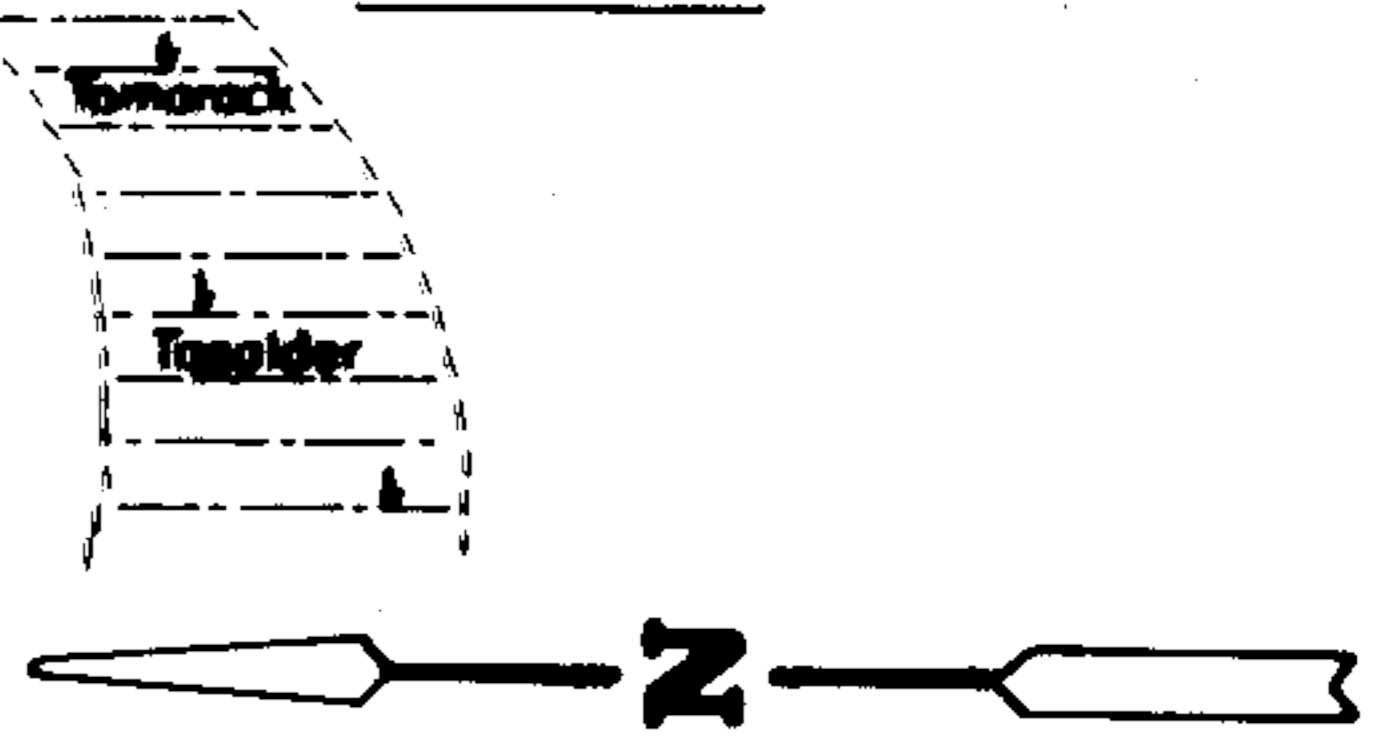
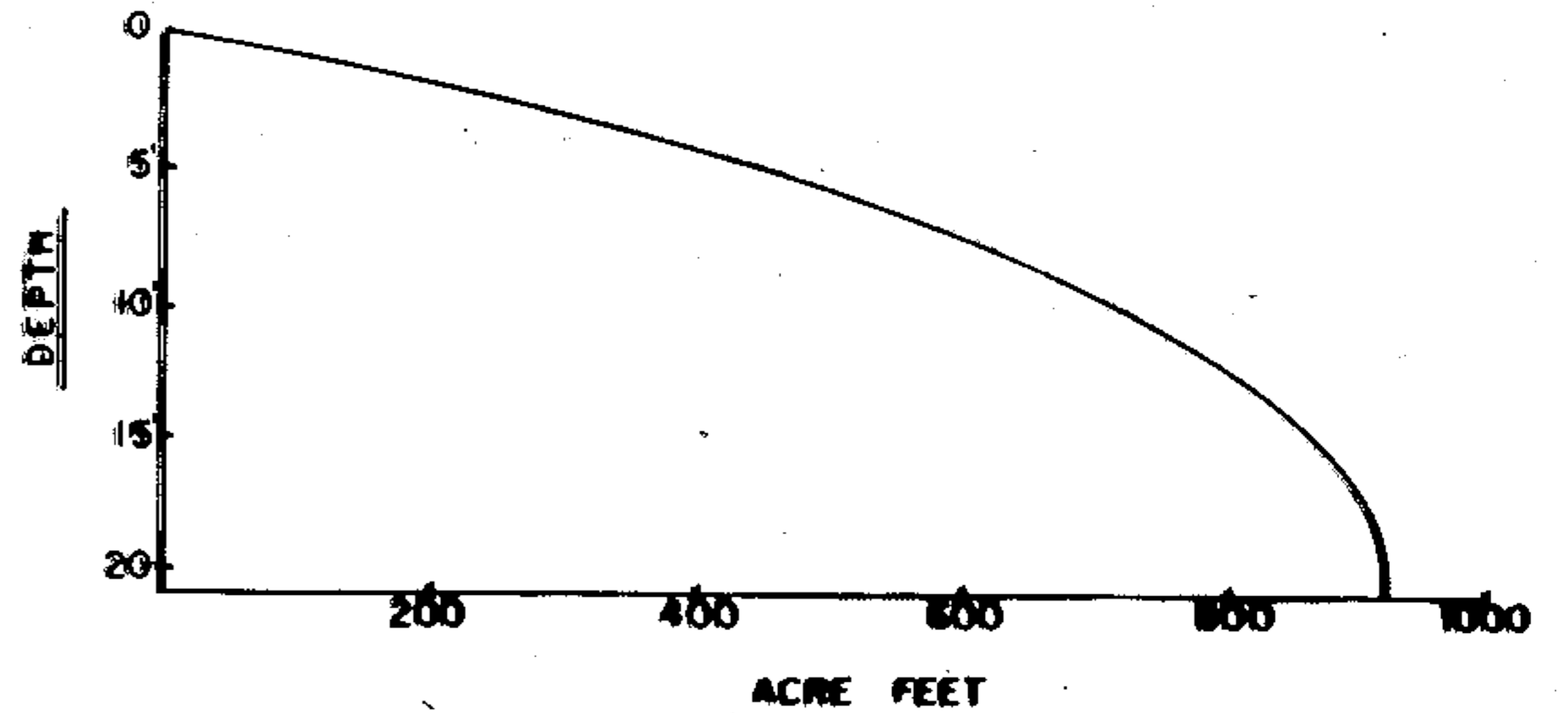

D.N.R. B.M. 1466-A, is located on the north end of lake, 44' N. of drive to lake and 54' S.E. of a 24" white pine.
Assumed elevation 100.00'
Water level 94.81'
Oct. 10, 1969

EQUIPMENT RECORDING MONTH YEAR

- | TOPOGRAPHIC SYMBOLS | | LAKE BOTTOM SYMBOLS | |
|---------------------|---------------------------|---------------------|-----------------------------|
| ● Brush | ▨ Steep slope | P. Peat | B Boulders |
| ◐ Partially wooded | --- Indefinite shoreline | Mk. Muck | ⊙ Stumps & Snags |
| ⊙ Wooded | ▨ Marsh | C. Clay | ⊙ Rock danger to navigation |
| ○ Cleared | ⊙ Spring | M. Marl | T Submergent vegetation |
| ⊙ Pastured | --- Intermittent stream | Sd. Sand | ⊥ Emergent vegetation |
| ⊙ Agricultural | --- Permanent inlet | Sl. Silt | ⊥ Floating vegetation |
| B.M. Bench Mark | --- Permanent outlet | Gr. Gravel | ⊙ Brush shelters |
| ■ Dwelling | ⊥ Dam | R. Rubble | |
| □ Resort | ⊥ D.N.R. State owned land | Br. Bedrock | |
| ⊙ Camp | | | |

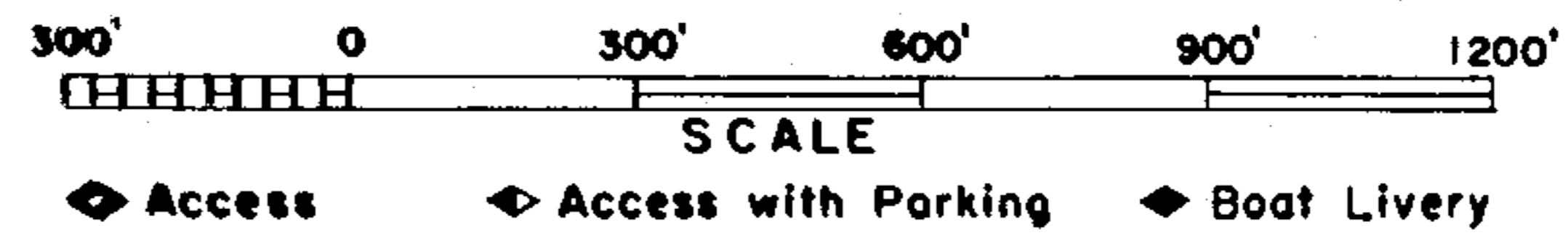

Drawn by: T. Ginder
Field work by: C. Busch, G. Lund, B.S. Johannes

SPECIES OF FISH	ABUNDANCE	
	Abundant	Common
Muskie		
N. Pike	X	
Walleye		X
L. M. Bass		X
S. M. Bass		X
Panfish	X	
Trout		

WATER AREA 113.7 ACRES
UNDER 3 FT. 13 %
OVER 20 FT. 0.5 %
MAX. DEPTH 21 FEET.
TOTAL ALK. 9 P.P.M.
VOLUME 902.5 ACRE FT.
SHORELINE 3.09 MILES
WITH ISLANDS 4.30 MILES

Source: Wisconsin Department of Natural Resources 608-266-2621
Baker Lake - Washburn County, Wisconsin DNR Lake Map
Date – Oct 1969 - Historical Lake Map - Not for Navigation
A Public Document - Please Identify the Source when using it.