

WISCONSIN CONSERVATION DEPARTMENT  
 BIOLOGY DIVISION  
 LAKE AND STREAM IMPROVEMENT SECTION

LAKE SURVEY MAP

LAKE BLUEGILL  
 SECTION 15 AND 16  
 TOWNSHIP 43 N  
 RANGE 12 W  
 TOWN OF WASCOTT  
 COUNTY DOUGLAS

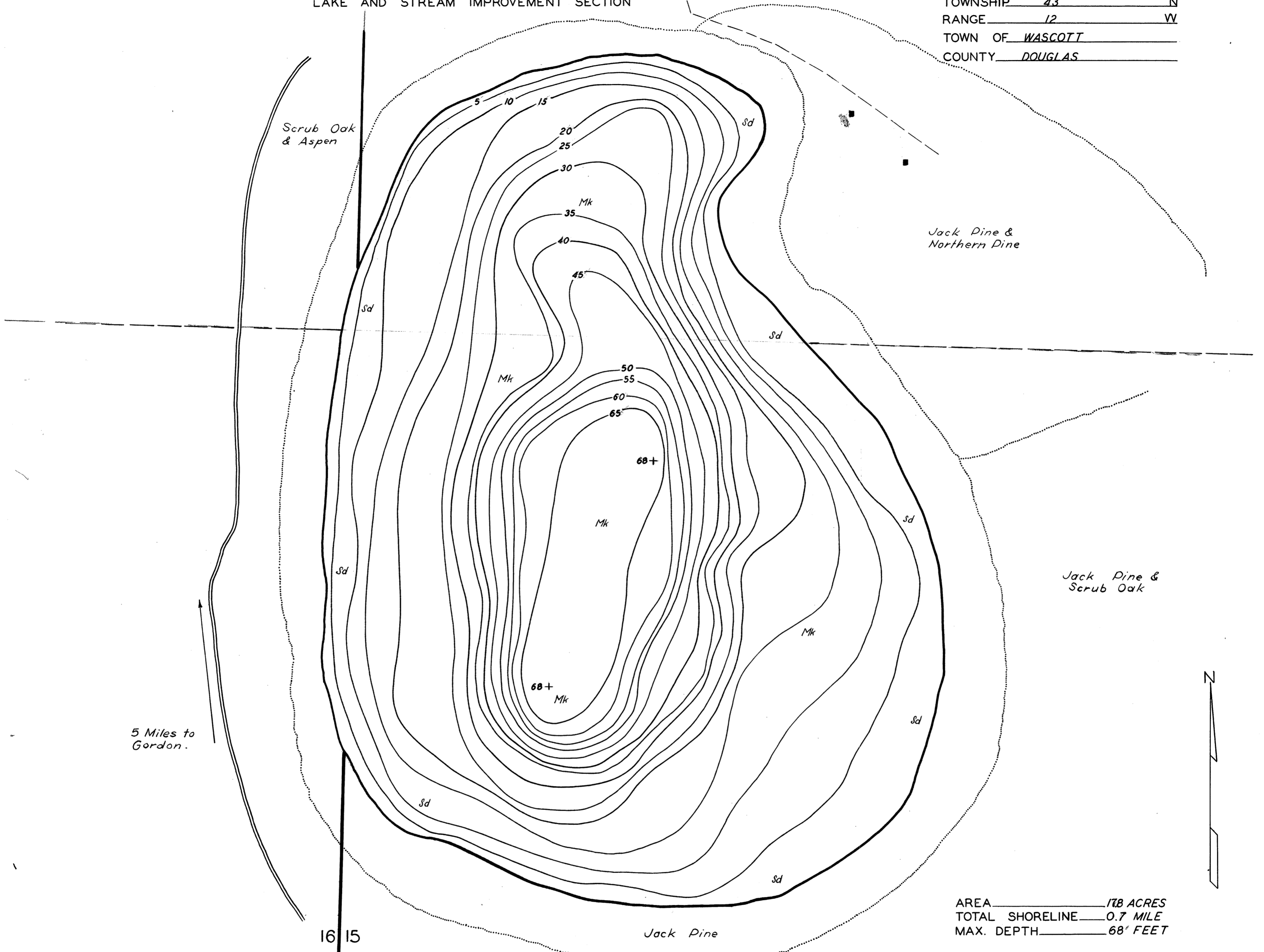

5 Miles to Gordon.

16 15

AREA 178 ACRES  
 TOTAL SHORELINE 0.7 MILE  
 MAX. DEPTH 68' FEET

SCALE 1 inch = 100 Feet

*Checked*  
 W.P.S.  
 E.M.  
 6/17/51

DATE DECEMBER 1939  
 COMPILED BY O.S.B.  
 TRACED BY JTK CCC  
 SOURCE OF INFORMATION AERIAL PHOTOGRAPH  
BRS-5-69 FL. II, AND W.P.A.  
LAKE SURVEY PROJECT  
 SOUNDINGS AT 165' INTERVALS  
 DATES OF MAP REVISION \_\_\_\_\_  
 WORK AGENCY W.P.A.

LAKE IMPROVEMENT RECORD

TYPE	DATE	1940		
⊕ BRUSH REFUGES	<u>145</u>			
w SAPLING TANGLES				
□ SPAWNING BOXES				
* MINNOW SPAWNERS				
TOTAL				

- LEGEND
- ⊕ WEED BEDS
  - \* ROCKY SHOALS
  - Sd SAND
  - Cl CLAY
  - Gr GRAVEL
  - Mk MUCK
  - DWELLING
  - ABANDONED DWELLING
  - ▣ RESORT

Source: Wisconsin Department of Natural Resources 608-266-2621  
Bluegill Lake - Douglas County, Wisconsin DNR Lake Map  
December, 1939 Historical Lake Map Not for Navigation  
A Public Document - Please Identify the Source when using it.