

# LAKE SURVEY MAP

WISCONSIN CONSERVATION DEPARTMENT  
BIOLOGY DIVISION  
LAKE AND STREAM IMPROVEMENT SECTION

LAKE CROTTY  
SECTION 32  
TOWNSHIP 43 N  
RANGE 11 W  
TOWN OF WASCOTT  
COUNTY DOUGLAS

FORM F-117

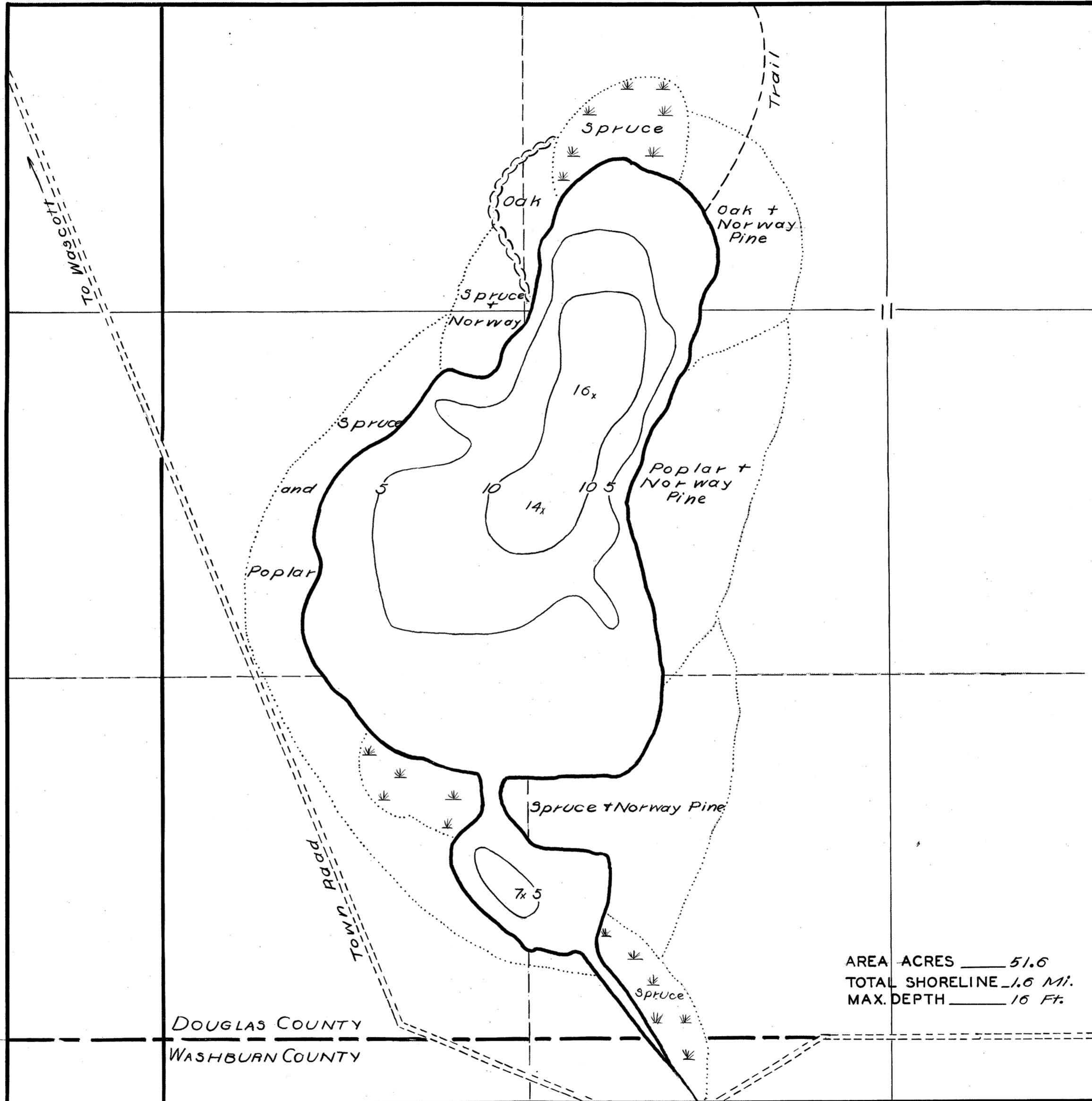

AREA ACRES 51.6  
TOTAL SHORELINE 1.6 Mi.  
MAX. DEPTH 16 Ft.

DATE June 9, 1939  
COMPILED BY \_\_\_\_\_  
TRACED BY W.P.S.  
SOURCE OF INFORMATION  
W.P.A. Lake Survey Project  
SOUNDINGS  
W.P.A. Lake Survey Project  
DATES OF MAP REVISION \_\_\_\_\_  
WORK AGENCY W.P.A.  
CHECKED BY  
W.P.S. 4-18-41

SCALE 1 inch = 330 Ft.

### LAKE IMPROVEMENT RECORD

TYPE	DATE				
⊕ BRUSH REFUGES	_____	_____	_____	_____	_____
- SAPLING TANGLES	_____	_____	_____	_____	_____
□ SPAWNING BOXES	_____	_____	_____	_____	_____
* MINNOW SPAWNERS	_____	_____	_____	_____	_____
TOTAL	_____	_____	_____	_____	_____

- LEGEND
- ⊕ WEED BEDS
  - ⊗ ROCKY SHOALS
  - Sd SAND
  - Cl CLAY
  - Gr GRAVEL
  - M MUCK
  - DWELLING
  - ABANDONED DWELLING
  - ▣ RESORT
  - ~ Pronounced Ridge

Source: Wisconsin Department of Natural Resources 608-266-2621  
Crotty Lake - Douglas County, Wisconsin DNR Lake Map  
June, 1939 Historical Lake Map Not for Navigation  
A Public Document - Please Identify the Source when using it.