

LAKE SURVEY MAP

WISCONSIN CONSERVATION DEPARTMENT
 BIOLOGY DIVISION
 LAKE AND STREAM IMPROVEMENT SECTION

LAKE FLAT
 SECTION 3-4
 TOWNSHIP 44 N
 RANGE 11 W
 TOWN OF GORDON
 COUNTY DOUGLAS

FORM FI-11

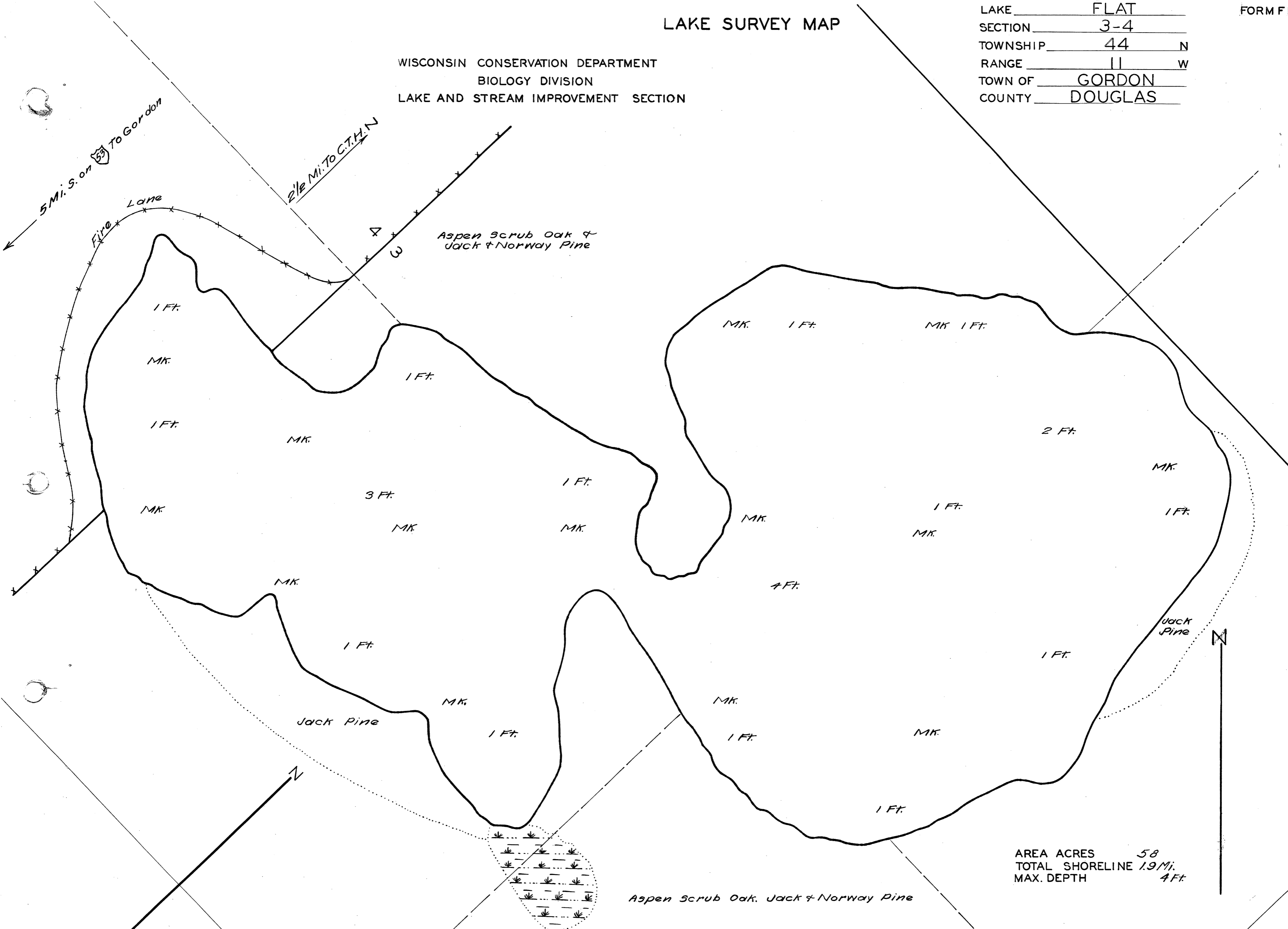

AREA ACRES 58
 TOTAL SHORELINE 1.9 Mi.
 MAX. DEPTH 4 Ft.

SCALE 1 inch Equals 165 Ft.
 0 50 100 200 300 400 500 Ft.

DATE June 24 1941
 COMPILED BY _____
 TRACED BY W.T.Z. (W.P.A.)
 SOURCE OF INFORMATION _____
W.P.A. Lake Survey Project

 SOUNDINGS 165 Foot intervals

 DATES OF MAP REVISION _____

 WORK AGENCY W. P. A.

LAKE IMPROVEMENT RECORD				
TYPE	DATE			
BRUSH REFUGES				
SAPLING TANGLES				
SPAWNING BOXES				
MINNOW SPAWNERS				
TOTAL				

- LEGEND
- WEED BEDS
 - ROCKY SHOALS
 - Sd.* SAND
 - Cl.* CLAY
 - Gr.* GRAVEL
 - Mk.* MUCK
 - DWELLING
 - ABANDONED DWELLING
 - RESORT

Checked
 W.P.S.
 E.M.K.
 6/27/41

Source: Wisconsin Department of Natural Resources 608-266-2621
Flat Lake - Douglas County, Wisconsin DNR Lake Map
June 1941 Historical Lake Map Not for Navigation
A Public Document - Please Identify the Source when using it.