

LAKE SURVEY MAP

WISCONSIN CONSERVATION DEPARTMENT
BIOLOGY DIVISION
LAKE AND STREAM IMPROVEMENT SECTION

LAKE GREEN
SECTION 22-27
TOWNSHIP 40 N
RANGE 11 W
TOWN OF SPRINGBROOK
COUNTY WASHBURN

FORM F-117

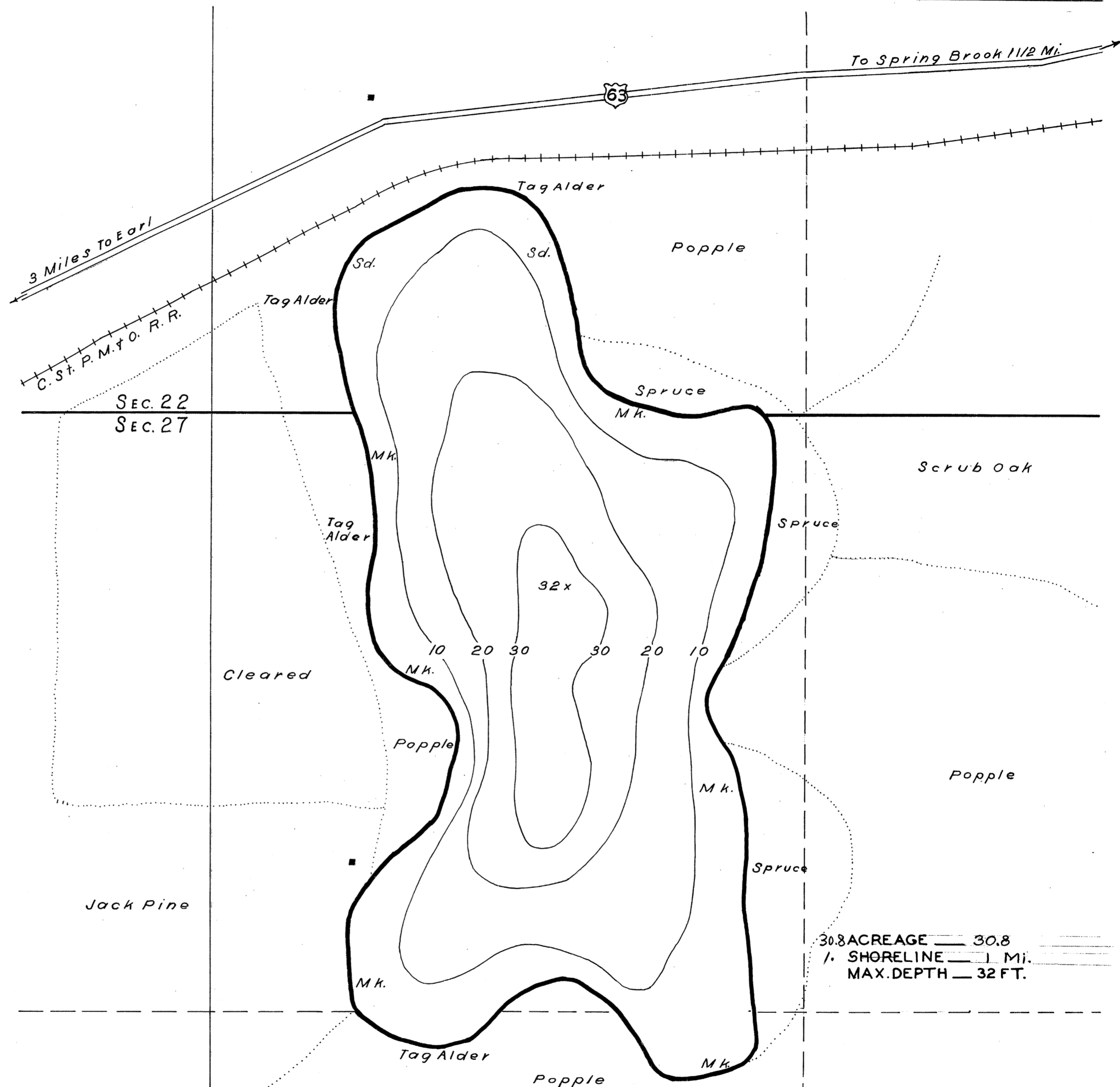

30.8 ACREAGE — 30.8
1/4 SHORELINE — 1 Mi.
MAX. DEPTH — 32 FT.

CHECKED BY
W.P.S. - C.E.K.
5-22-41

DATE Dec. 15 1939
COMPILED BY _____
TRACED BY R.C. (W.P.A.)
SOURCE OF INFORMATION
W.P.A. Lake Survey
Mapping Project
SOUNDINGS _____
DATES OF MAP REVISION _____
WORK AGENCY _____

LAKE IMPROVEMENT RECORD

TYPE	DATE			
o BRUSH REFUGES	_____	_____	_____	_____
w SAPLING TANGLES	_____	_____	_____	_____
□ SPAWNING BOXES	_____	_____	_____	_____
* MINNOW SPAWNERS	_____	_____	_____	_____
TOTAL		_____	_____	_____

SCALE 1 inch Equal 200 Ft.

- LEGEND**
- WEED BEDS
 - ROCKY SHOALS
 - Sd.* SAND
 - cl.* CLAY
 - gr.* GRAVEL
 - Mk.* MUCK
 - DWELLING
 - ABANDONED DWELLING
 - RESORT

Source: Wisconsin Department of Natural Resources 608-266-2621
Green Lake - Washburn County, Wisconsin DNR Lake Map
Date - Dec 1939 - Historical Lake Map - Not for Navigation
A Public Document - Please Identify the Source when using it.