

# LAKE SURVEY MAP

HOINTVILLE LAKE  
WASHBURN COUNTY  
SEC. 21 T. 41 N. R. 13 W.

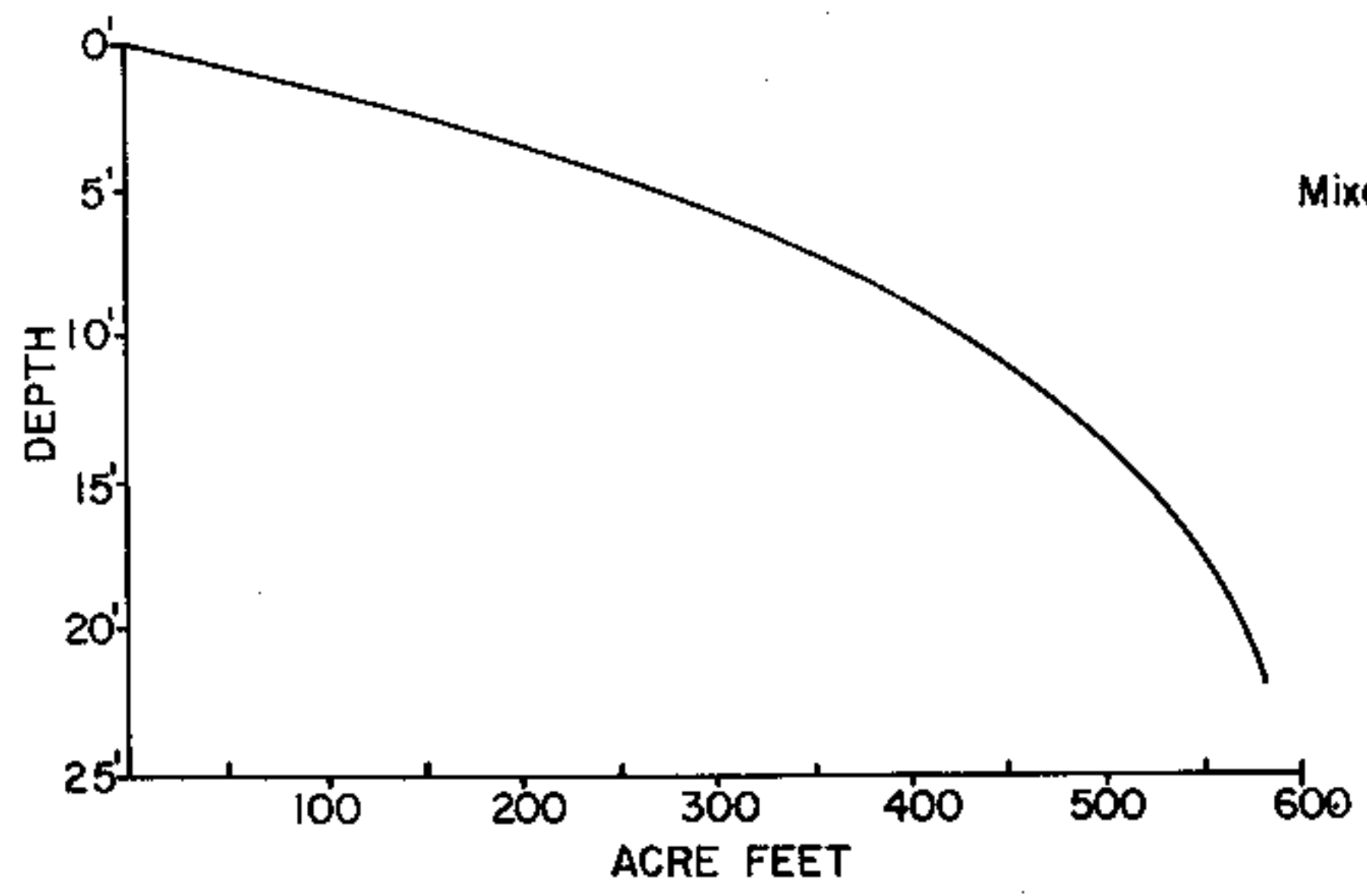
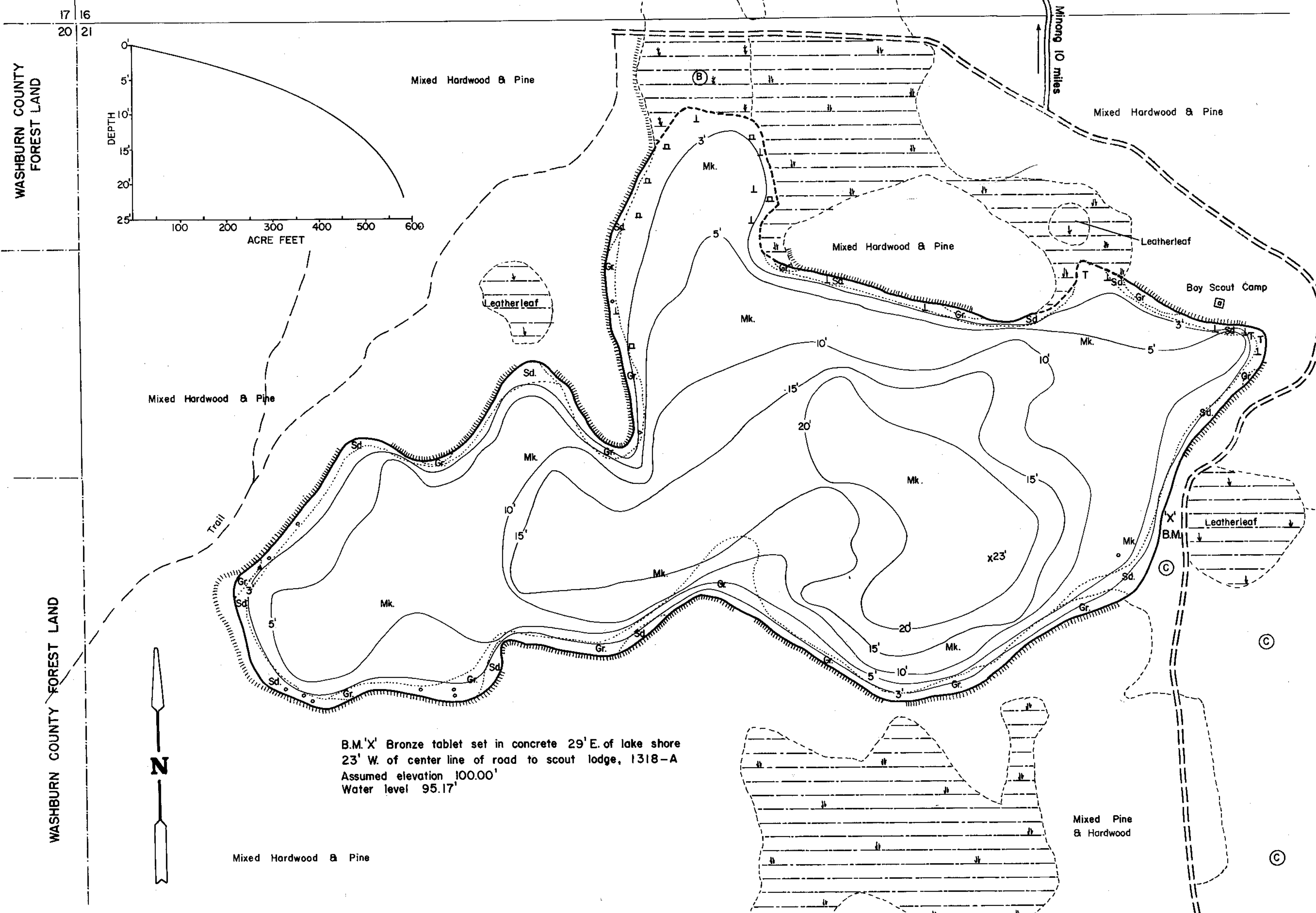

B.M. 'X' Bronze tablet set in concrete 29' E. of lake shore  
23' W. of center line of road to scout lodge, 1318-A  
Assumed elevation 100.00'  
Water level 95.17'

EQUIPMENT RECORDING SONAR MAPPED NOV. 1968  
MONTH YEAR

- | TOPOGRAPHIC SYMBOLS   |                         | LAKE BOTTOM SYMBOLS |                             |
|-----------------------|-------------------------|---------------------|-----------------------------|
| (B) Brush             | Steep slope             | P. Peat             | B Boulders                  |
| (PW) Partially wooded | ~ Indefinite shoreline  | Mk. Muck            | ⊙ Stumps & Snags            |
| (W) Wooded            | ⊕ Marsh                 | C. Clay             | ⊙ Rock danger to navigation |
| (C) Cleared           | ○ Spring                | M. Marl             | T Submergent vegetation     |
| (P) Pastured          | ~ Intermittent stream   | Sd. Sand            | ⊥ Emergent vegetation       |
| (A) Agricultural      | ≡ Permanent inlet       | St. Silt            | ⊥ Floating vegetation       |
| B.M. Bench Mark       | ≡ Permanent outlet      | Gr. Gravel          | ⊕ Brush shelters            |
| ■ Dwelling            | ⊥ Dam                   | R. Rubble           |                             |
| □ Resort              | D.N.R. State owned land | Br. Bedrock         |                             |

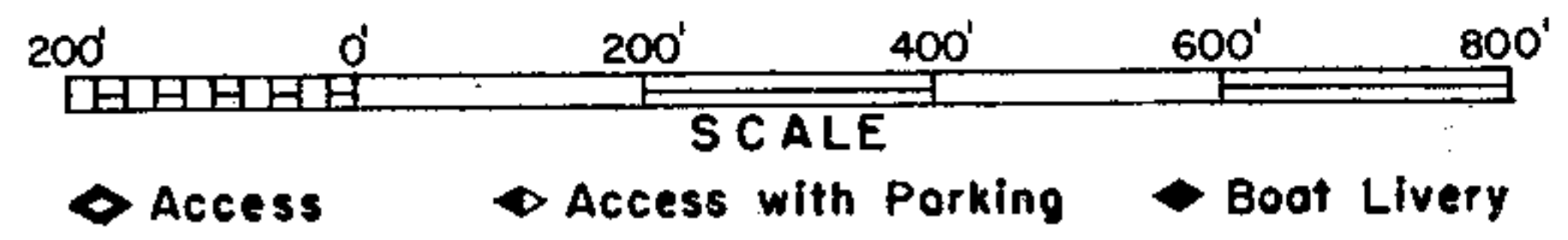

Drawn by: C. Holt  
Field work by: C. Busch, S. Johannes

SPECIES OF FISH	ABUNDANCE		
	Abundant	Common	Present
Muskie			
N. Pike			
Walleye			
L.M. Bass		X	
S.M. Bass			
Panfish	X		
Trout			

WATER AREA 58.4 ACRES  
 UNDER 3 FT. 11.0 %  
 OVER 20 FT. 9.7 %  
 MAX. DEPTH 23 FEET.  
 TOTAL ALK. 58 P.P.M.  
 VOLUME 581.1 ACRE FT.  
 SHORELINE 1.65 MILES

Source: Wisconsin Department of Natural Resources 608-266-2621  
Hointville Lake - Washburn County, Wisconsin DNR Lake Map  
Date – Nov 1968 - Historical Lake Map - Not for Navigation  
A Public Document - Please Identify the Source when using it.