

# LAKE SURVEY MAP

LAKE LITTLE BASS  
 SECTION 4-5-32-33  
 TOWNSHIP 41-42 N  
 RANGE 12 W  
 TOWN OF CHICOG-MINONG  
 COUNTY WASHBURN

FORM FH-117

WISCONSIN CONSERVATION DEPARTMENT  
 BIOLOGY DIVISION  
 LAKE AND STREAM IMPROVEMENT SECTION

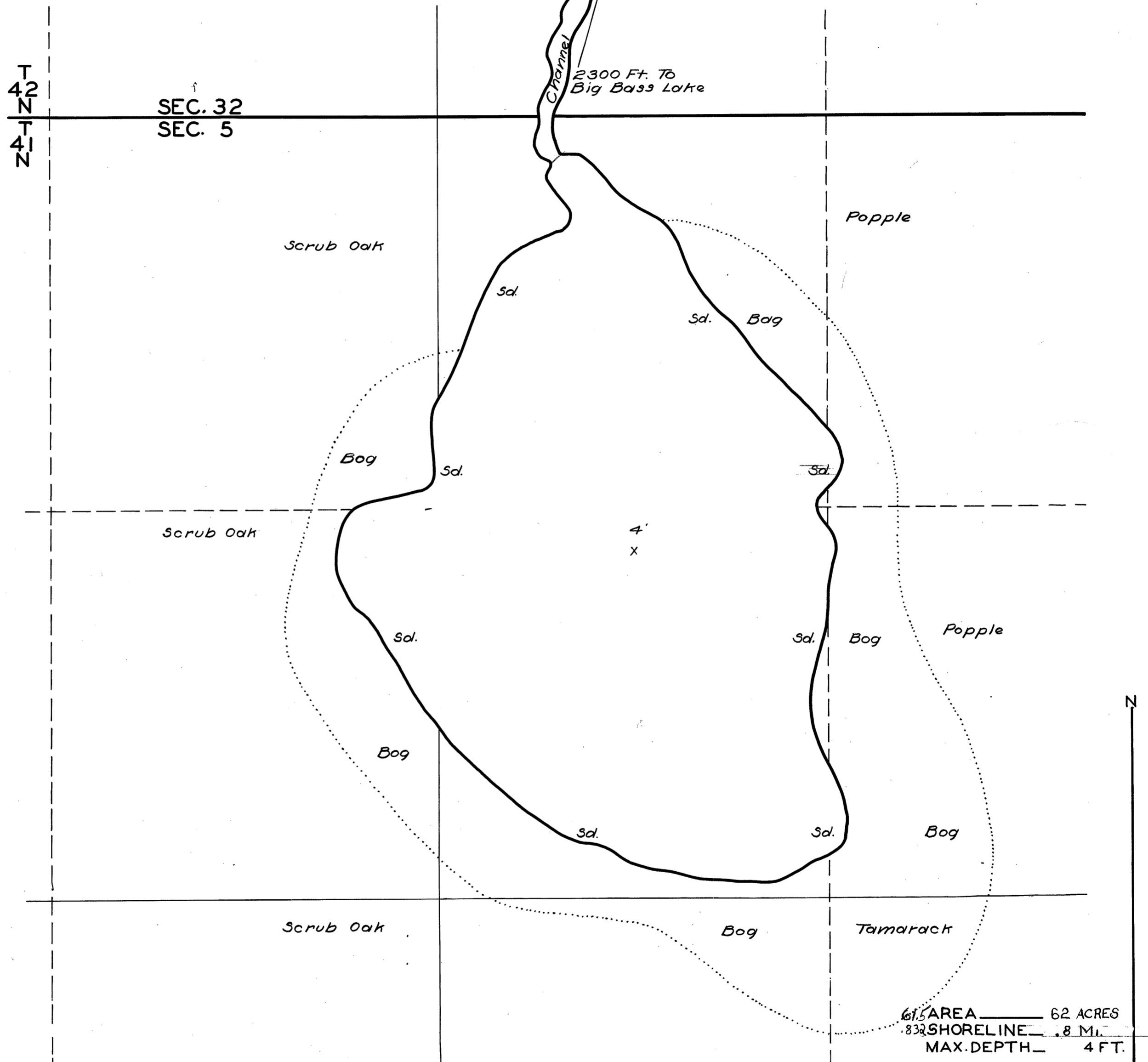

61.5 AREA \_\_\_\_\_ 62 ACRES  
 832 SHORELINE \_\_\_\_\_ .8 Mi.  
 MAX. DEPTH \_\_\_\_\_ 4 FT.

SCALE 1 inch Equal 300 Ft.

CHECKED BY  
 W.P.S.-C.E.V.  
 5-22-41

DATE May 6, 1940  
 COMPILED BY \_\_\_\_\_  
 TRACED BY W.P.S. (W.P.A.)  
 SOURCE OF INFORMATION W.P.A. Lake Survey Project  
 \_\_\_\_\_  
 SOUNDINGS \_\_\_\_\_  
 \_\_\_\_\_  
 DATES OF MAP REVISION \_\_\_\_\_  
 \_\_\_\_\_  
 WORK AGENCY W.P.A.

LAKE IMPROVEMENT RECORD				
TYPE	DATE			
⊙ BRUSH REFUGES	_____	_____	_____	_____
~ SAPLING TANGLES	_____	_____	_____	_____
□ SPAWNING BOXES	_____	_____	_____	_____
* MINNOW SPAWNER S.	_____	_____	_____	_____
TOTAL	_____	_____	_____	_____

- LEGEND
- ⊙ WEED BEDS
  - ~ ROCKY SHOALS
  - Sd. SAND
  - C/ CLAY
  - Gr. GRAVEL
  - Mk. MUCK
  - DWELLING
  - ABANDONED DWELLING
  - ▣ RESORT

Source: Wisconsin Department of Natural Resources 608-266-2621  
Little Bass Lake - Washburn County, Wisconsin DNR Lake Map  
Date – May 1940 - Historical Lake Map - Not for Navigation  
A Public Document - Please Identify the Source when using it.