

Silver Lake
27.5 Acres
26 Ft. Deep

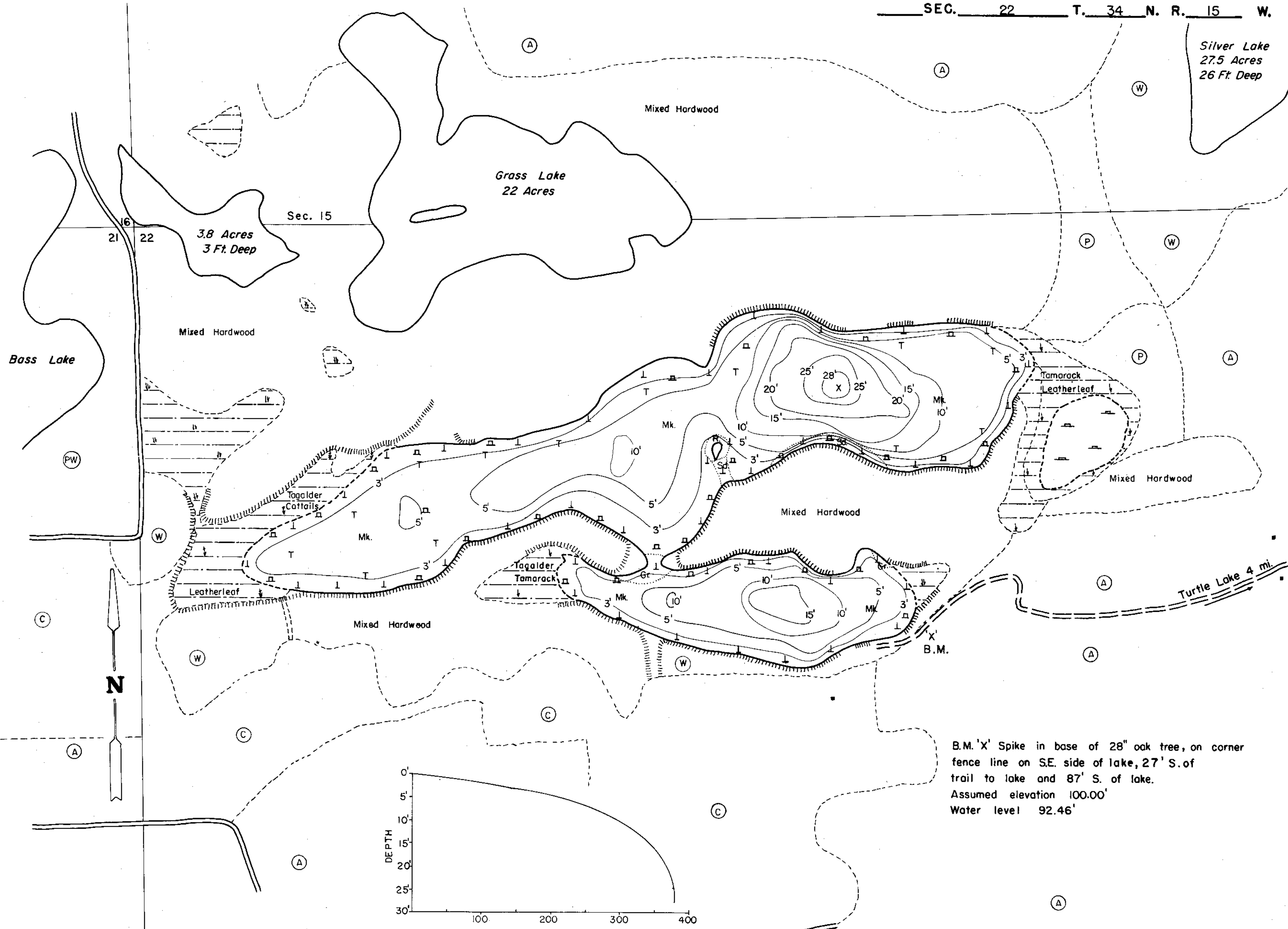

B.M. 'X' Spike in base of 28" oak tree, on corner fence line on SE. side of lake, 27' S. of trail to lake and 87' S. of lake.
Assumed elevation 100.00'
Water level 92.46'

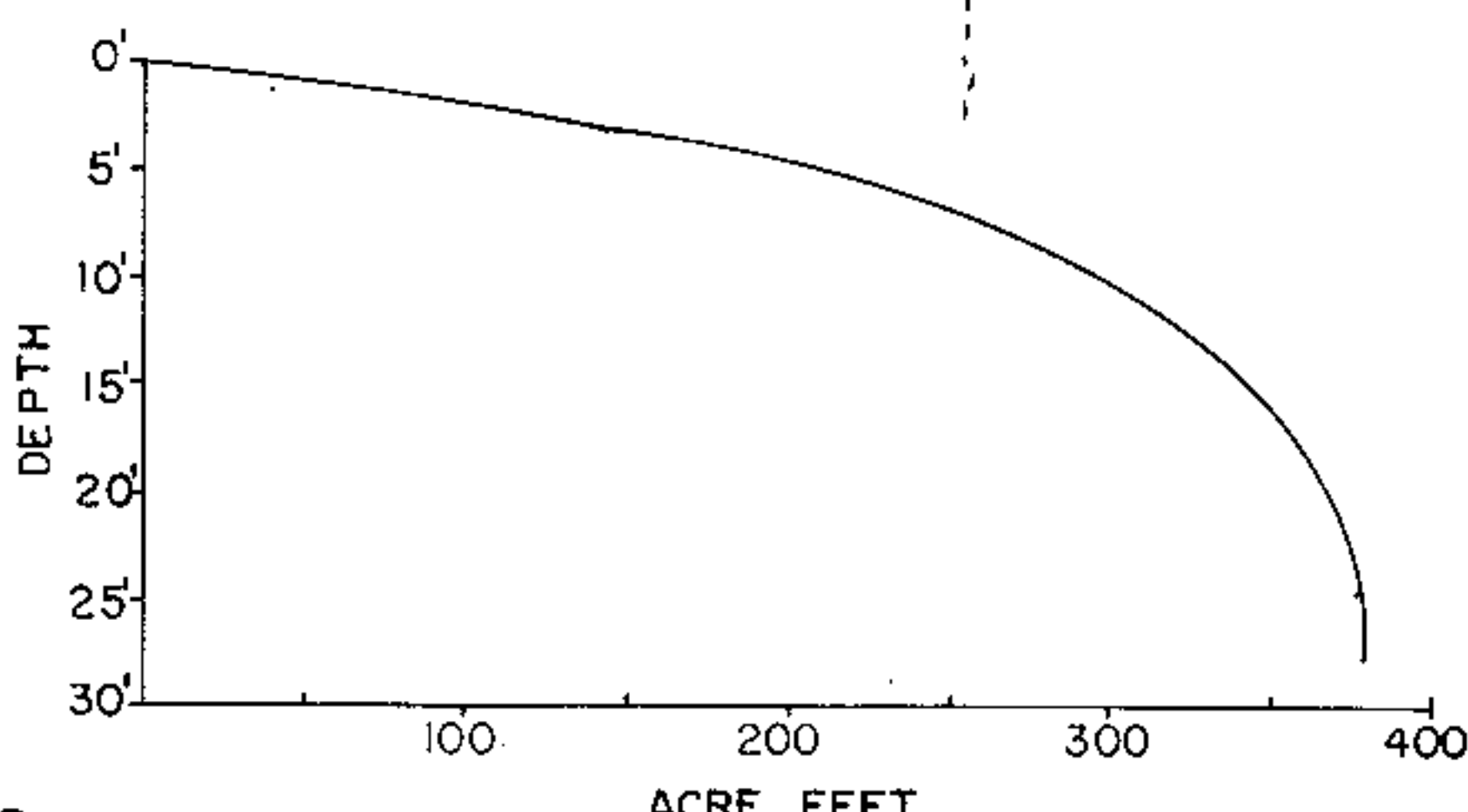

EQUIPMENT RECORDING SONAR MAPPED SEPT 1969

- TOPOGRAPHIC SYMBOLS
- (B) Brush
 - (PW) Partially wooded
 - (W) Wooded
 - (C) Cleared
 - (P) Pastured
 - (A) Agricultural
 - B.M. Bench Mark
 - Dwelling
 - Resort
 - ⊠ Camp
 - ||||| Steep slope
 - - - Indefinite shoreline
 - Marsh
 - Spring
 - Intermittent stream
 - Permanent inlet
 - Permanent outlet
 - Dam
 - D.N.R. State owned land

- LAKE BOTTOM SYMBOLS
- P. Peat
 - Mk. Muck
 - C. Clay
 - M. Marl
 - Sd. Sand
 - St. Silt
 - Gr. Gravel
 - R. Rubble
 - Br. Bedrock
 - B Boulders
 - Stumps & Snags
 - Rock danger to navigation
 - Submergent vegetation
 - Emergent vegetation
 - Floating vegetation
 - Brush shelters



Access Access with Parking Boat Livery
 Drawn by: C. Holt
 Field work by: C. Busch, G. Lund, S. Johannes

SPECIES OF FISH	Abundance		
	Abundant	Common	Present
Muskie			
N. Pike		X	
Walleye			
L.M. Bass	X		
S.M. Bass			
Panfish	X		
Trout			

WATER AREA 53.9 ACRES
 UNDER 3 FT. 21 %
 OVER 20 FT. 6 %
 MAX. DEPTH 28 FEET.
 TOTAL ALK. 11 P.P.M.
 VOLUME 3806 ACRE FT.
 SHORELINE 2.20 MILES
 SHORELINE 2.24 MILES WITH IS.

Source: Wisconsin Department of Natural Resources 608-266-2621
Little Horseshoe Lake – Polk County, Wisconsin DNR Lake Map
Date – Sep 1969 - Historical Lake Map - Not for Navigation
A Public Document - Please Identify the Source when using it.