

LAKE SURVEY MAP

MUD LAKE
WASHBURN COUNTY
SEC. 16, 17, 20, 21 T. 40 N. R. 10 W.

Bass Lake
187.5 Acres
35 Ft. Deep

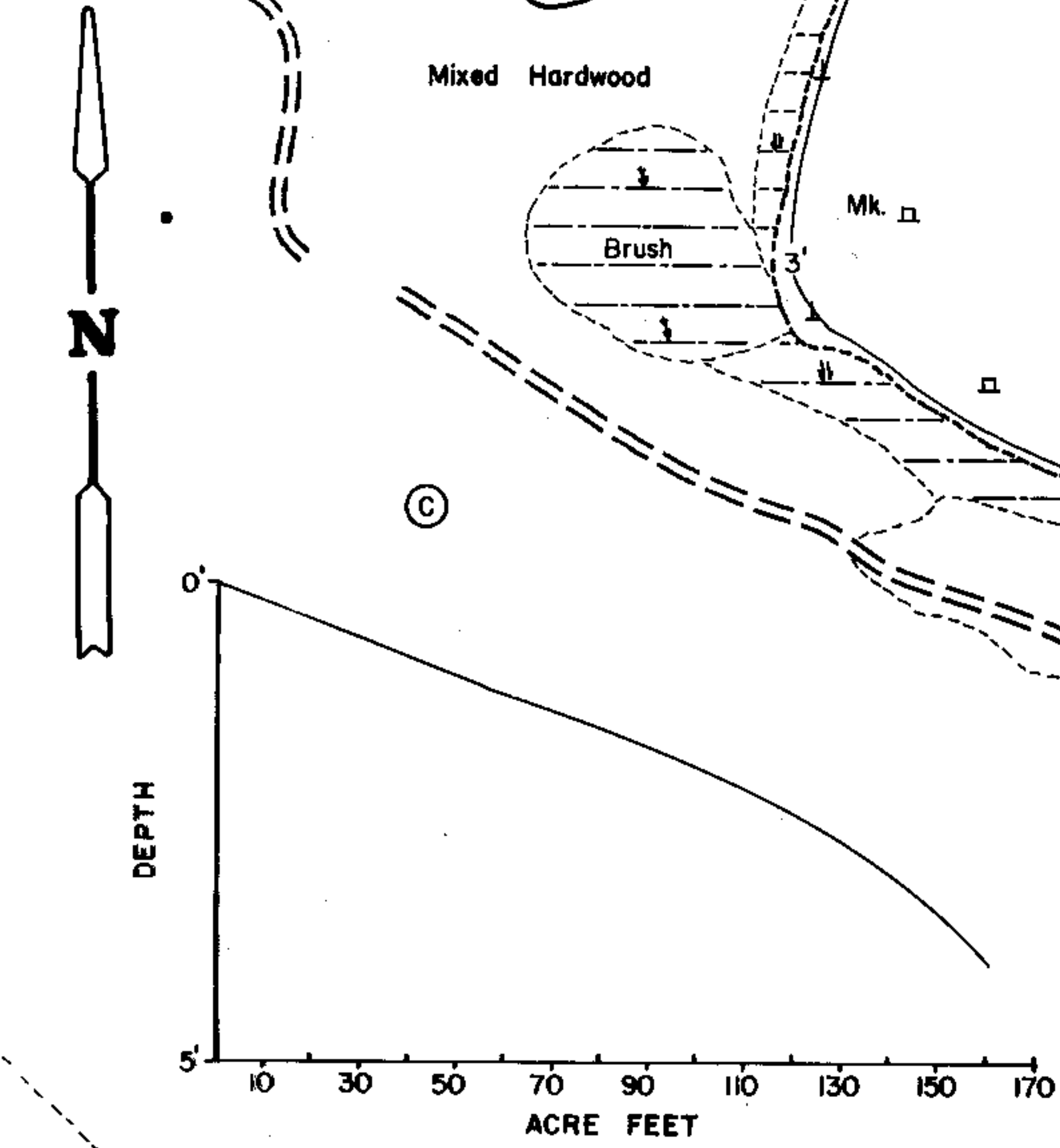
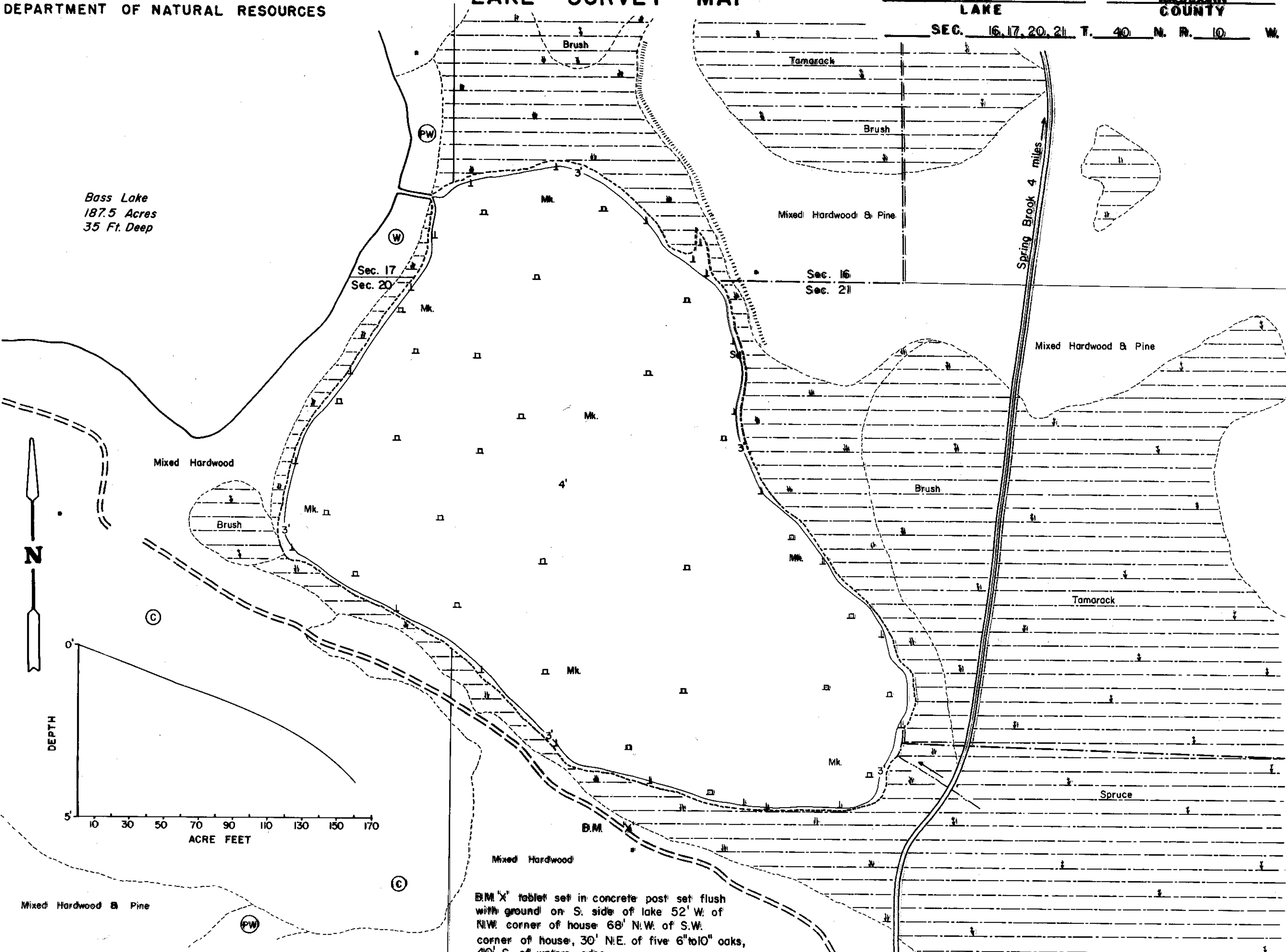

B.M. 'X' tablet set in concrete post set flush with ground on S. side of lake 52' W. of N.W. corner of house 68' N.W. of S.W. corner of house, 30' N.E. of five 6" to 10" oaks, 40' S. of waters edge
Assumed elevation 100.00'
Water level 90.19'

EQUIPMENT RECORDING SONAR MAPPED		OCT 1968	
TOPOGRAPHIC SYMBOLS		LAKE BOTTOM SYMBOLS	
(B) Brush	Steep slope	P. Peat	B. Boulders
(PW) Partially wooded	Indefinite shoreline	Mk. Muck	Stumps & Snags
(W) Wooded	Marsh	C. Clay	Rock danger to navigation
(C) Cleared	Spring	M. Marl	T. Submergent vegetation
(P) Pastured	Intermittent stream	Sd. Sand	Emergent vegetation
(A) Agricultural	Permanent inlet	Sf. Silt	Floating vegetation
B.M. Bench Mark	Permanent outlet	Gr. Gravel	Brush shelters
Dwelling	Dam	R. Rubble	
Resort	D.N.R. State owned land	Br. Bedrock	
Camp			

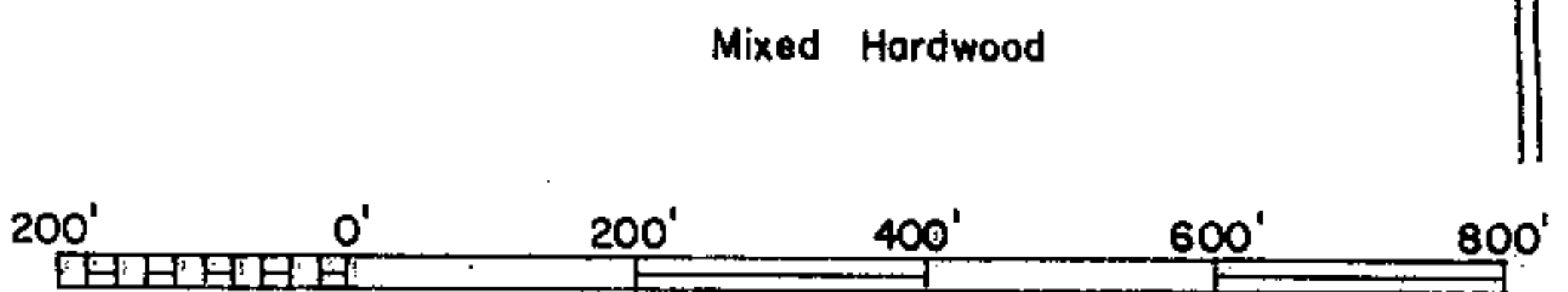

Access Access with Parking Boat Livery
Drawn by: C. Holt
Field work by: C. Busch, C. Olson, S. Johannes.

SPECIES OF FISH	Abundance		
	Abundant	Common	Present
Muskie			
N. Pike			
Walleye			X
L.M. Bass			
S.M. Bass			
Panfish	X		
Trout			

WATER AREA 53.4 ACRES
UNDER 3 FT. 3.7 %
OVER 20 FT. 0 %
MAX. DEPTH 4 FEET.
TOTAL ALK. 32 P.P.M.
VOLUME 160.9 ACRE FT.
SHORELINE 1.1 MILES

Source: Wisconsin Department of Natural Resources 608-266-2621
Mud Lake - Washburn County, Wisconsin DNR Lake Map
Date – Oct 1968 - Historical Lake Map - Not for Navigation
A Public Document - Please Identify the Source when using it.