

LAKE SURVEY MAP

NORTHEAST LAKE
BAYFIELD COUNTY
SEC. 23, 26 T. 44 N. R. 7 E.W.

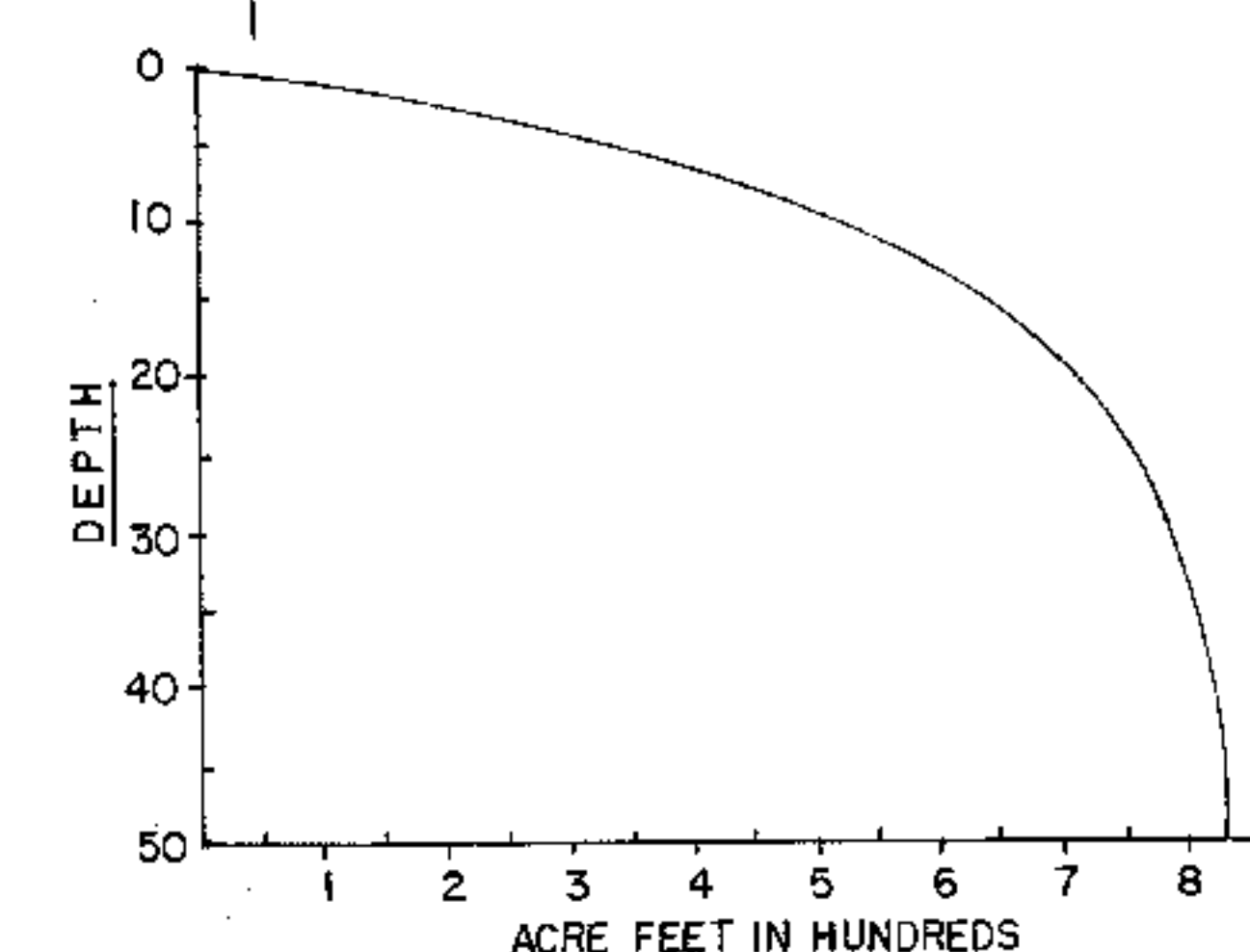
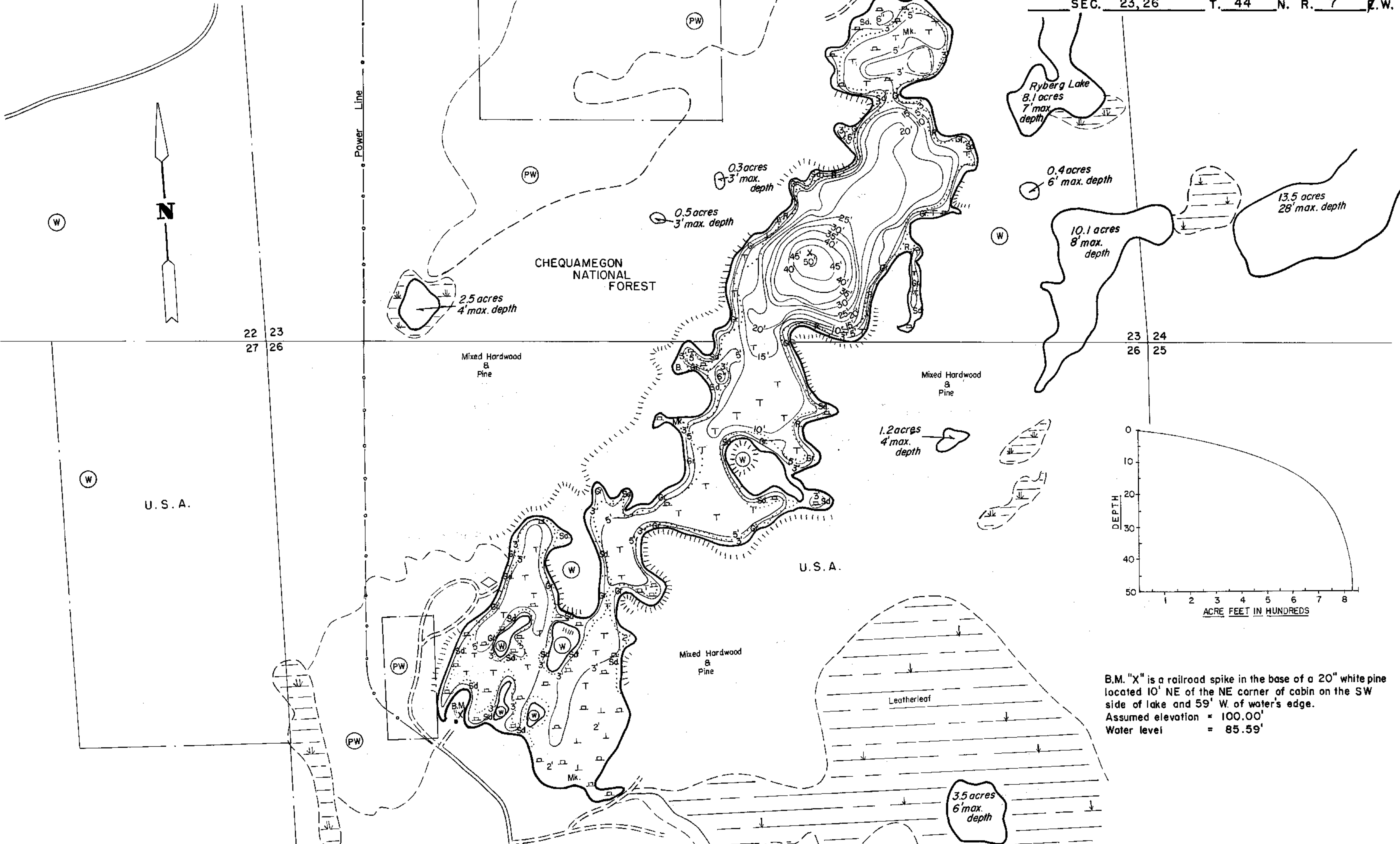

B.M. "X" is a railroad spike in the base of a 20" white pine located 10' NE of the NE corner of cabin on the SW side of lake and 59' W. of water's edge.
Assumed elevation = 100.00'
Water level = 85.59'

EQUIPMENT RECORDING SONAR MAPPED SEPT. 1976

TOPOGRAPHIC SYMBOLS		LAKE BOTTOM SYMBOLS	
(B) Brush	Steep slope	P. Peat	B Boulders
(PW) Partially wooded	- - - Indefinite shoreline	Mk. Muck	⊙ Stumps & Snags
(W) Wooded	Marsh	C. Clay	⊙ Rock danger to navigation
(C) Cleared	~ ~ ~ Spring	M. Marl	T Submergent vegetation
(P) Pastured	~ ~ ~ Intermittent stream	Sd. Sand	⊥ Emergent vegetation
(A) Agricultural	==== Permanent inlet	St. Silt	⊥ Floating vegetation
B.M. Bench Mark	==== Permanent outlet	Gr. Gravel	⊥ Brush shelters
■ Dwelling	⊥ Dam	R. Rubble	
□ Resort	⊥ D.N.R. State owned land	Br. Bedrock	
⊠ Camp			



Access Access with Parking Boat Livery

Drawn by: R. Williams
Field work by: C. Busch, K. Cable, L. Sather

SPECIES OF FISH	Abundance		
	Abundant	Common	Present
Muskie			
N. Pike			
Walleye			
L. M. Bass	X		
S. M. Bass			
Panfish	X		
Trout			

WATER AREA 88.2 ACRES
UNDER 3 FT. 22 %
OVER 20 FT. 13 %
MAX. DEPTH 50 FEET.
TOTAL ALK. 24 P.P.M.
VOLUME 829.95 ACRE FT.
MAIN SHORELINE 3.9 MI.
ISLAND SHORELINE .83 MI.

Source: Wisconsin Department of Natural Resources 608-266-2621
Northeast Lake – Bayfield County, Wisconsin DNR Lake Map
Date – Sep 1976 - Historical Lake Map - Not for Navigation
A Public Document - Please Identify the Source when using it.