

LAKE SURVEY MAP

LAKE ONE MILE
 SECTION 1-12
 TOWNSHIP 43 N
 RANGE 12 W
 TOWN OF GORDON, WASCOTT
 COUNTY DOUGLAS

FORM FI-117

WISCONSIN CONSERVATION DEPARTMENT
 BIOLOGY DIVISION
 LAKE AND STREAM IMPROVEMENT SECTION

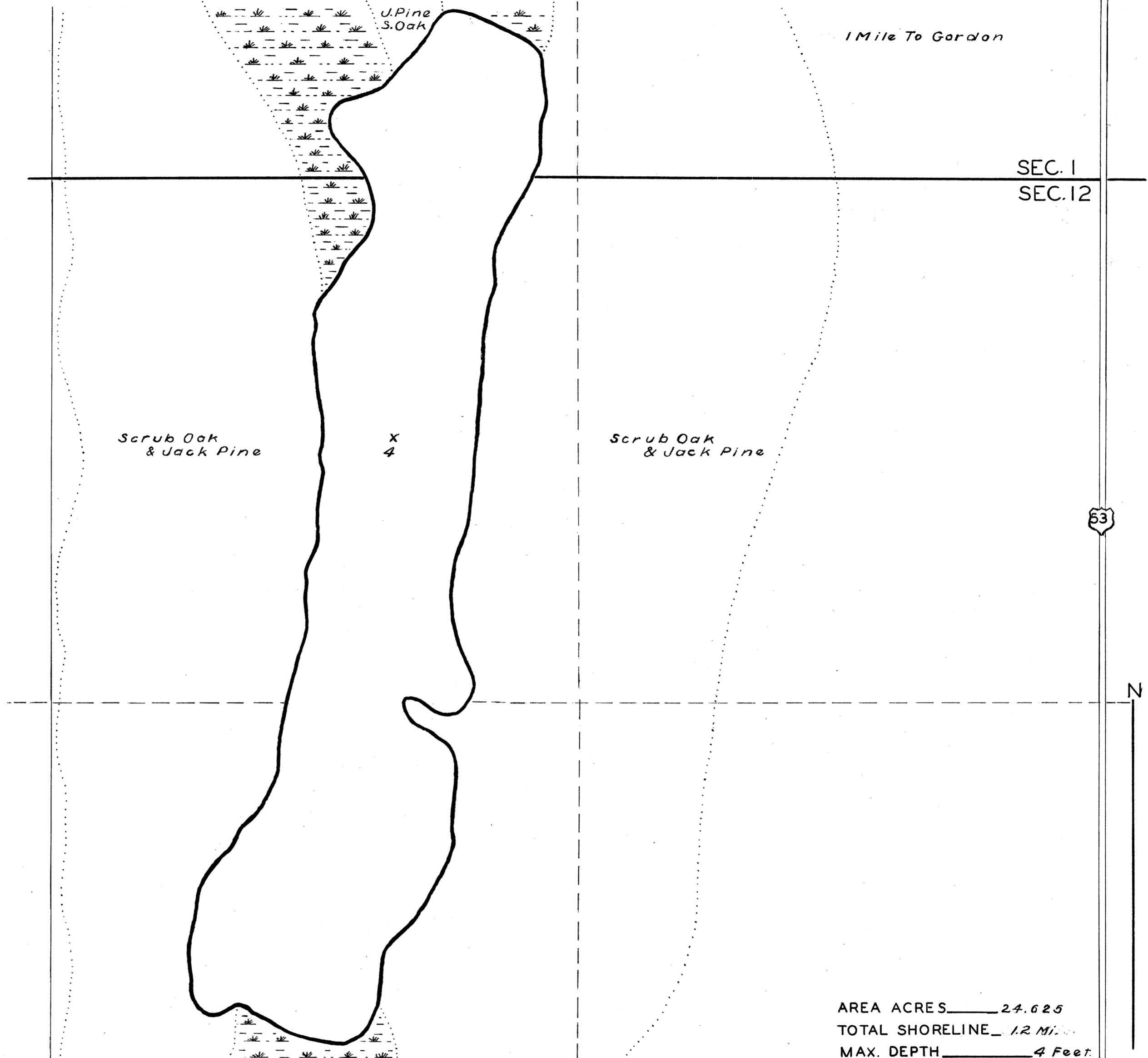

AREA ACRES 24.625
 TOTAL SHORELINE 1.2 Miles
 MAX. DEPTH 4 Feet

SCALE 1 inch Equals 220 Feet

DATE Jan 13 1941
 COMPILED BY _____
 TRACED BY NLM (WPA)
 SOURCE OF INFORMATION WPA Lake Survey Project

 SOUNDING At 165 Foot Intervals

 DATES OF MAP REVISION _____

 WORK AGENCY W.P.A.

LAKE IMPROVEMENT RECORD

TYPE	DATE	_____	_____	_____	_____
⊕ BRUSH REFUGES	_____	_____	_____	_____	_____
⊕ SAPLING TANGLES	_____	_____	_____	_____	_____
□ SPAWNING BOXES	_____	_____	_____	_____	_____
* MINNOW SPAWERS	_____	_____	_____	_____	_____
TOTAL	_____	_____	_____	_____	_____

LEGEND

⊕	WEED BEDS
⊕	ROCKY SHOALS
Sd.	SAND
Cl.	CLAY
Gr.	GRAVEL
Mk.	MUCK
■	DWELLING
□	ABANDONED DWELLING
■	

Checked
 W.P.S.
 E.M.K.
 7/2/41

Source: Wisconsin Department of Natural Resources 608-266-2621
One Mile Lake - Douglas County, Wisconsin DNR Lake Map
Date Jan. 1941 - Historical Lake Map - Not for Navigation
A Public Document - Please Identify the Source when using it.