

LAKE SURVEY MAP

LAKE PICKEREL
 SECTION 20-21
 TOWNSHIP 43 N
 RANGE 12 W
 TOWN OF WASCOTT
 COUNTY DOUGLAS

FORM FH17

WISCONSIN CONSERVATION DEPARTMENT
 BIOLOGY DIVISION
 LAKE AND STREAM IMPROVEMENT SECTION

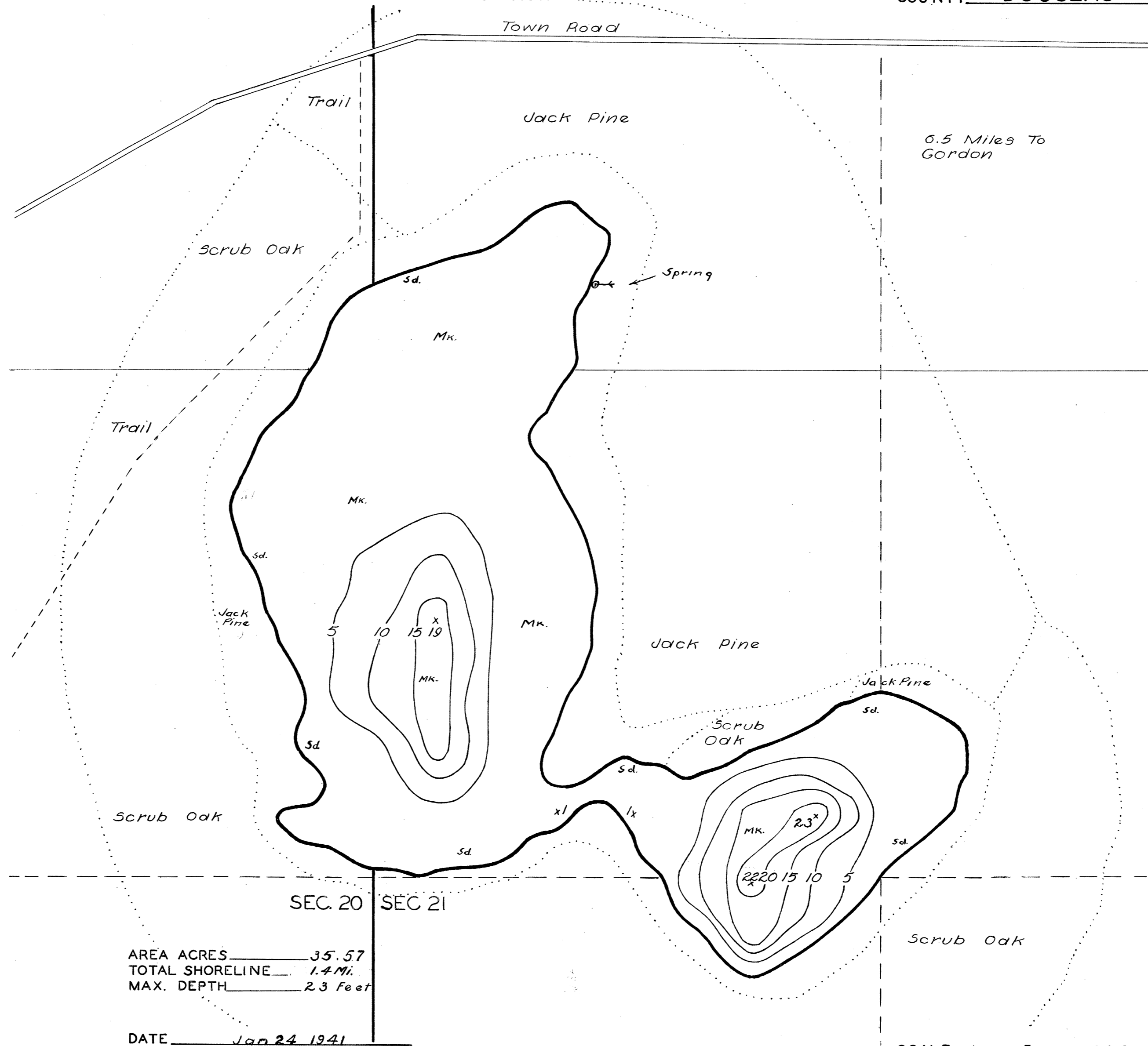

AREA ACRES 35.57
 TOTAL SHORELINE 1.4 Mi.
 MAX. DEPTH 2.3 Feet

DATE Jan 24 1941
 COMPILED BY _____
 TRACED BY W.P.S. N.L.M. (WPA)
 SOURCE OF INFORMATION WPA Lake Survey Project
 SOUNDINGS At 165 Foot Intervals
 DATES OF MAP REVISION _____
 WORK AGENCY W. P. A.

LAKE IMPROVEMENT RECORD

TYPE	DATE			
☉ BRUSH REFUGES	_____	_____	_____	_____
~ SAPLING TANGLES	_____	_____	_____	_____
☐ SPAWNING BOXES	_____	_____	_____	_____
* MINNOW SPAWNERS	_____	_____	_____	_____
TOTAL	_____	_____	_____	_____

LEGEND

- ☉ WEED BEDS
- ☼ ROCKY SHOALS
- Sd SAND
- Cl CLAY
- Gr GRAVEL
- Mk MUCK
- ☐ DWELLING
- ☐ ABANDONED DWELLING
- ☐ RESORT

SCALE 1 inch Equals 220 Feet.

Checked
W.P.S.
EMK.
6/30/41

Source: Wisconsin Department of Natural Resources 608-266-2621
Pickerel Lake - Douglas County, Wisconsin DNR Lake Map
Date Jan. 1941 - Historical Lake Map - Not for Navigation
A Public Document - Please Identify the Source when using it.