

LAKE SURVEY MAP

PINE LAKE POLK COUNTY
SEC. 14, 23 T. 32 N. R. 18 W.

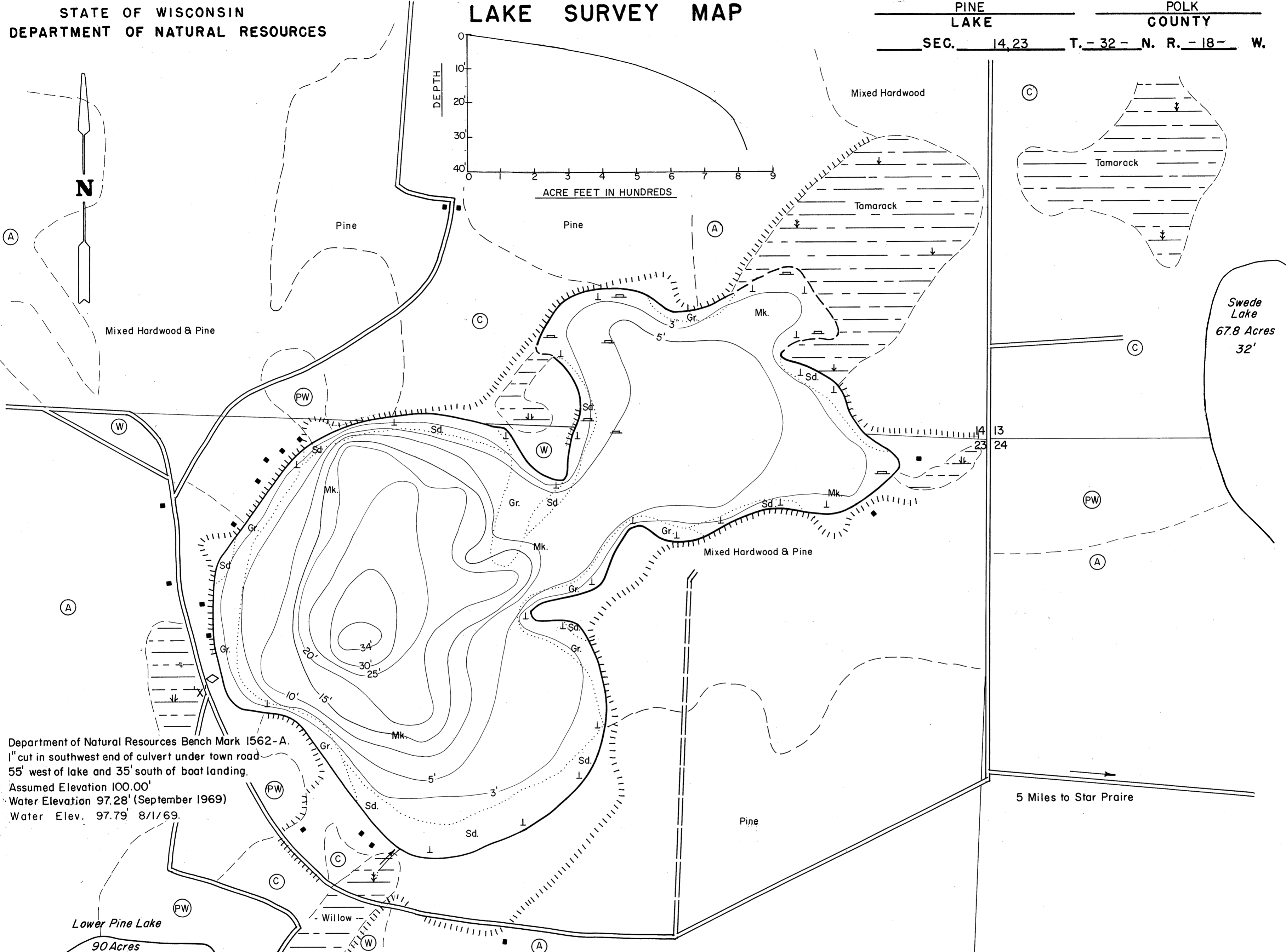
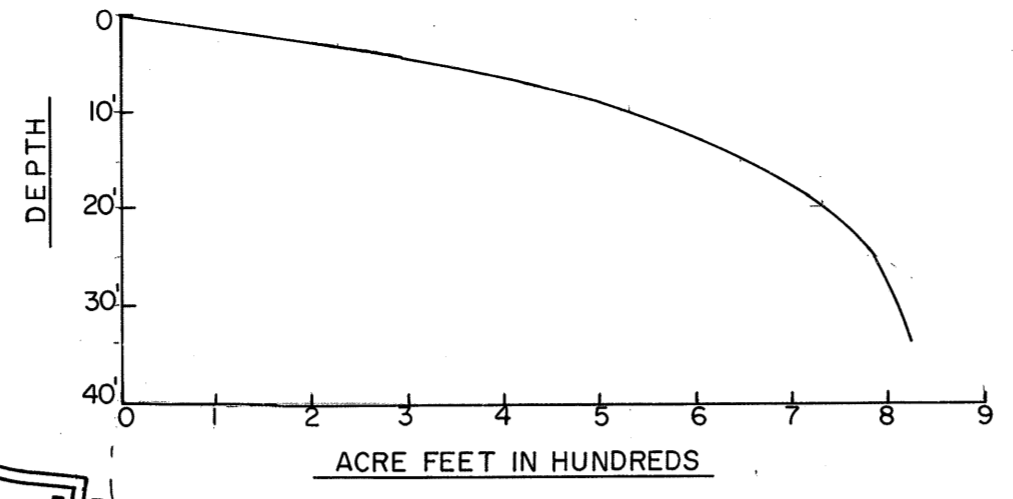
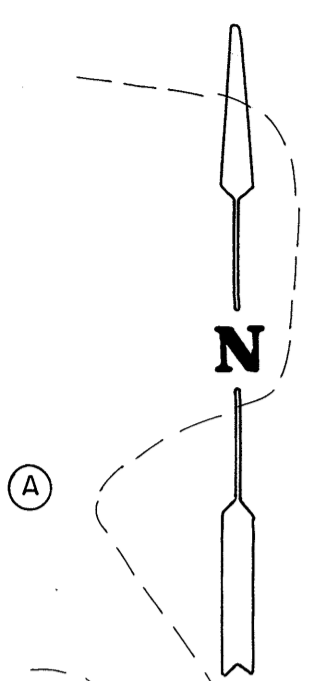

Department of Natural Resources Bench Mark 1562-A.
1" cut in southwest end of culvert under town road
55' west of lake and 35' south of boat landing.
Assumed Elevation 100.00'
Water Elevation 97.28' (September 1969)
Water Elev. 97.79' 8/1/69.

EQUIPMENT RECORDING SONAR MAPPED AUGUST 1969
MONTH YEAR

- | TOPOGRAPHIC SYMBOLS | | LAKE BOTTOM SYMBOLS | |
|-----------------------|----------------------------|---------------------|-----------------------------|
| (B) Brush | Steep slope | P. Peat | B Boulders |
| (PW) Partially wooded | - - - Indefinite shoreline | Mk. Muck | ⊙ Stumps & Snags |
| (W) Wooded | ⊞ Marsh | C. Clay | ⊙ Rock danger to navigation |
| (C) Cleared | ○ Spring | M. Marl | T Submergent vegetation |
| (P) Pastured | - - - Intermittent stream | Sd. Sand | ⊥ Emergent vegetation |
| (A) Agricultural | ≡ Permanent inlet | St. Silt | ⊥ Floating vegetation |
| B.M. Bench Mark | ≡ Permanent outlet | Gr. Gravel | ⊥ Brush shelters |
| ■ Dwelling | ⊥ Dam | R. Rubble | |
| □ Resort | D.N.R. State owned land | Bc. Bedrock | |
| ⊞ Camp | | | |

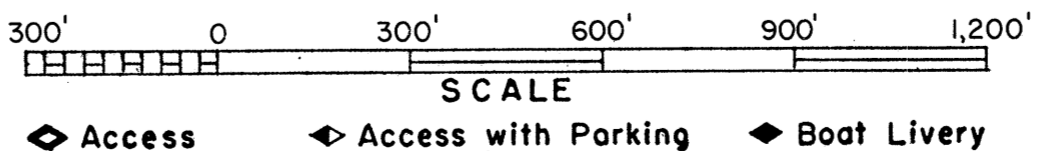

Access Access with Parking Boat Livery
Drawn by: J. Roth
Field work by: C. Busch, C. Belter, S. Johannes

SPECIES OF FISH	ABUNDANCE		
	Abundant	Common	Present
Muskie			
N. Pike		X	
Walleye			
L.M. Bass		X	
S.M. Bass			
Panfish	X		
Trout			

WATER AREA 82.3 ACRES
UNDER 3 FT. 16 %
OVER 20 FT. 17 %
MAX. DEPTH 34 FEET.
TOTAL ALK. 31 P.P.M.
VOLUME 811.2 ACRE FT.
SHORELINE 2.02 MILES

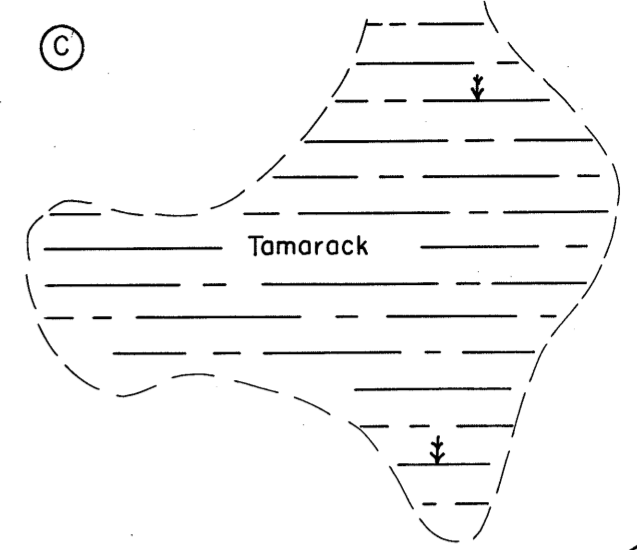

Swede Lake
67.8 Acres
32'

5 Miles to Star Praire

Source: Wisconsin Department of Natural Resources 608-266-2621
Pine Lake – Polk County, Wisconsin DNR Lake Map
Date – Aug 1969 - Historical Lake Map - Not for Navigation
A Public Document - Please Identify the Source when using it.