

W.C.D. B.M. 'X' spike in white pine on E. side of lake
Assumed elev. 100.0
Water elev. 91.0

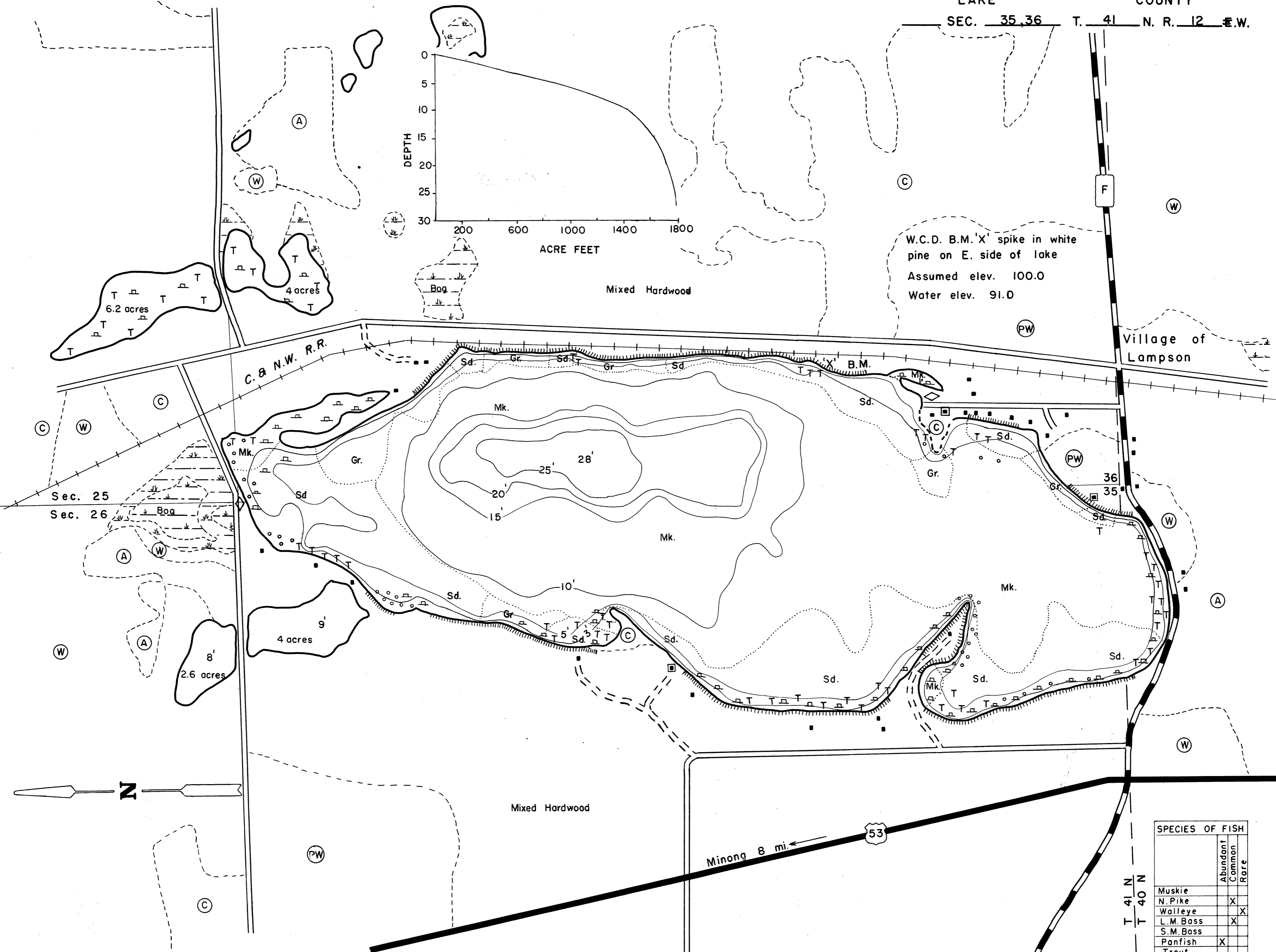

SPECIES OF FISH		
	Abundant	Common
	Rate	Rate
Muskie		
N. Pike	X	
Walleye		X
L.M. Bass		X
S.M. Bass		
Panfish	X	
Trout		

AREA 187.5 ACRES
 UNDER 3FT. 9.6 %
 OVER 20FT. 9.1 %
 VOLUME 1786.8 ACRE FT.
 TOTAL ALK. 19 P.P.M.
 SHORELINE 32 MILES
 MAX. DEPTH 28 FEET

EQUIPMENT RECORDING SONAR MAPPED SEPT 1965
 MO. YR.

WATER ELEV. 91.0

- TOPOGRAPHIC SYMBOLS
- (B) Brush
 - (PW) Partially wooded
 - (W) Wooded
 - (C) Cleared
 - (P) Pastured
 - (A) Agricultural
 - B.M. Bench Mark
 - Dwelling
 - Resort
 - ||||| Steep slope
 - - - Indefinite shoreline
 - Marsh
 - Spring
 - Intermittent stream
 - Permanent inlet
 - Permanent outlet
 - Dam

- LAKE BOTTOM SYMBOLS
- P. Peat
 - Mk. Muck
 - M. Marl
 - Sd. Sand
 - St. Silt
 - Gr. Gravel
 - R. Rubble
 - C. Clay
 - Br. Bedrock
 - Stumps & Snags
 - T Submergent vegetation
 - Emergent vegetation
 - Floating vegetation

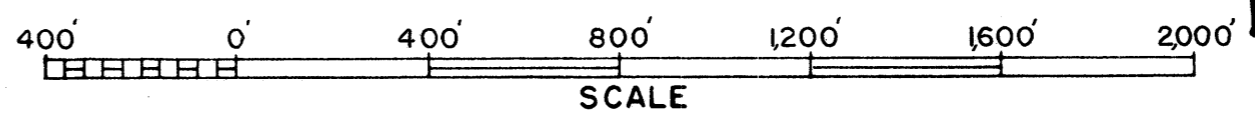

◇ Access ◇ Access with Parking ◆ Boat Livery
 Field work by L. Sather, C. Olson, G. Miller Drawn by: C. Holt

Source: Wisconsin Department of Natural Resources 608-266-2621
Silver Lake - Washburn County, Wisconsin DNR Lake Map
Date – Sep 1965 - Historical Lake Map - Not for Navigation
A Public Document - Please Identify the Source when using it.