

STATE OF WISCONSIN
DEPARTMENT OF NATURAL RESOURCES

LAKE SURVEY MAP

TOMAHAWK LAKE BAYFIELD COUNTY
SEC. 20 T. 45 N. R. 9 W.

D.N.R. B.M. 1370B

Spike in base of 18" Jack Pine
58' N. of lake, and 42' E. of centerline
of access road at park

Elev. 91.21'
Water level 83.00'
Reading taken 7/21/71

Sand Bar Lake
113.6 Acres
51 Ft. Deep

Priest Lake
29.5 Acres
52 Ft. Deep

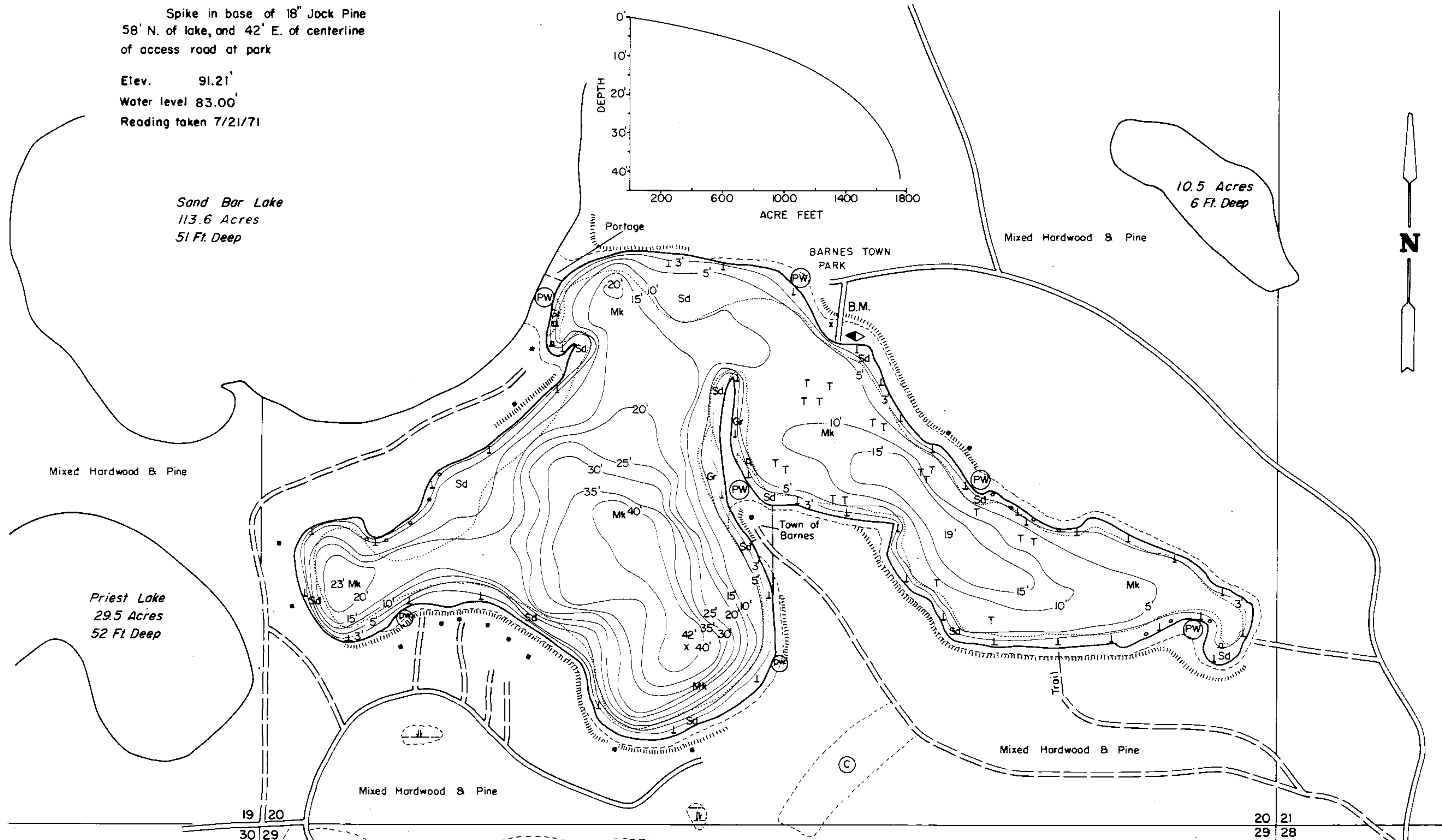

B.M. 1370-A, IS A BRONZE CAP MARKED D.N.R. SET IN A
CONCRETE POST LOCATED 10' S.E. OF A CLUMP OF NORWAY
PINE, 148' N. OF WATER, 39' W. OF CENTERLINE OF ACCESS
ROAD AT TOWN OF BARNES PARK ON N.E. SIDE OF LAKE.
ASSUMED ELEV. 100.00'
WATER LEVEL 83.89'
READING TAKEN 7/27/72

EQUIPMENT RECORDING SONAR MAPPED JULY 1971

- TOPOGRAPHIC SYMBOLS
- (B) Brush
 - (PW) Partially wooded
 - (W) Wooded
 - (C) Cleared
 - (P) Pastured
 - (A) Agricultural
 - B.M. Bench Mark
 - Dwelling
 - Resort
 - ▣ Camp

- LAKE BOTTOM SYMBOLS
- P. Peat
 - Mk. Muck
 - C. Clay
 - M. Marl
 - Sd. Sand
 - St. Silt
 - Gr. Gravel
 - R. Rubble
 - Bc. Bedrock
 - B. Boulders
 - ⊙ Stumps & Snags
 - ⊙ Rock danger to navigation
 - T Submergent vegetation
 - ⊥ Emergent vegetation
 - ⊥ Floating vegetation
 - ⊥ Brush shelters



◆ Access ◆ Access with Parking ◆ Boat Livery

Drawn by: C. Holt
Field work by: C. Busch, G. Lund, L. Sather

SPECIES OF FISH	ABUNDANCE		
	Abundant	Common	Present
Muskie			
N. Pike			
Walleye			
L. M. Bass		X	
S. M. Bass		X	
Panfish	X		
Cisco	X		
Smelt			X

WATER AREA 134.1 ACRES
UNDER 3 FT. 18 %
OVER 20 FT. 21 %
MAX. DEPTH 42 FEET.
TOTAL ALK. 30 P.P.M.
VOLUME 1760 ACRE FT.
SHORELINE 2.94 MILES

Drummond 15 mi

Source: Wisconsin Department of Natural Resources 608-266-2621
Tomahawk Lake – Bayfield County, Wisconsin DNR Lake Map
Date – Jul 1971 - Historical Lake Map - Not for Navigation
A Public Document - Please Identify the Source when using it.