

LAKE SURVEY MAP

WARD LAKE POLK COUNTY
SEC. 14 T. 36 - N. R. 16 - W.

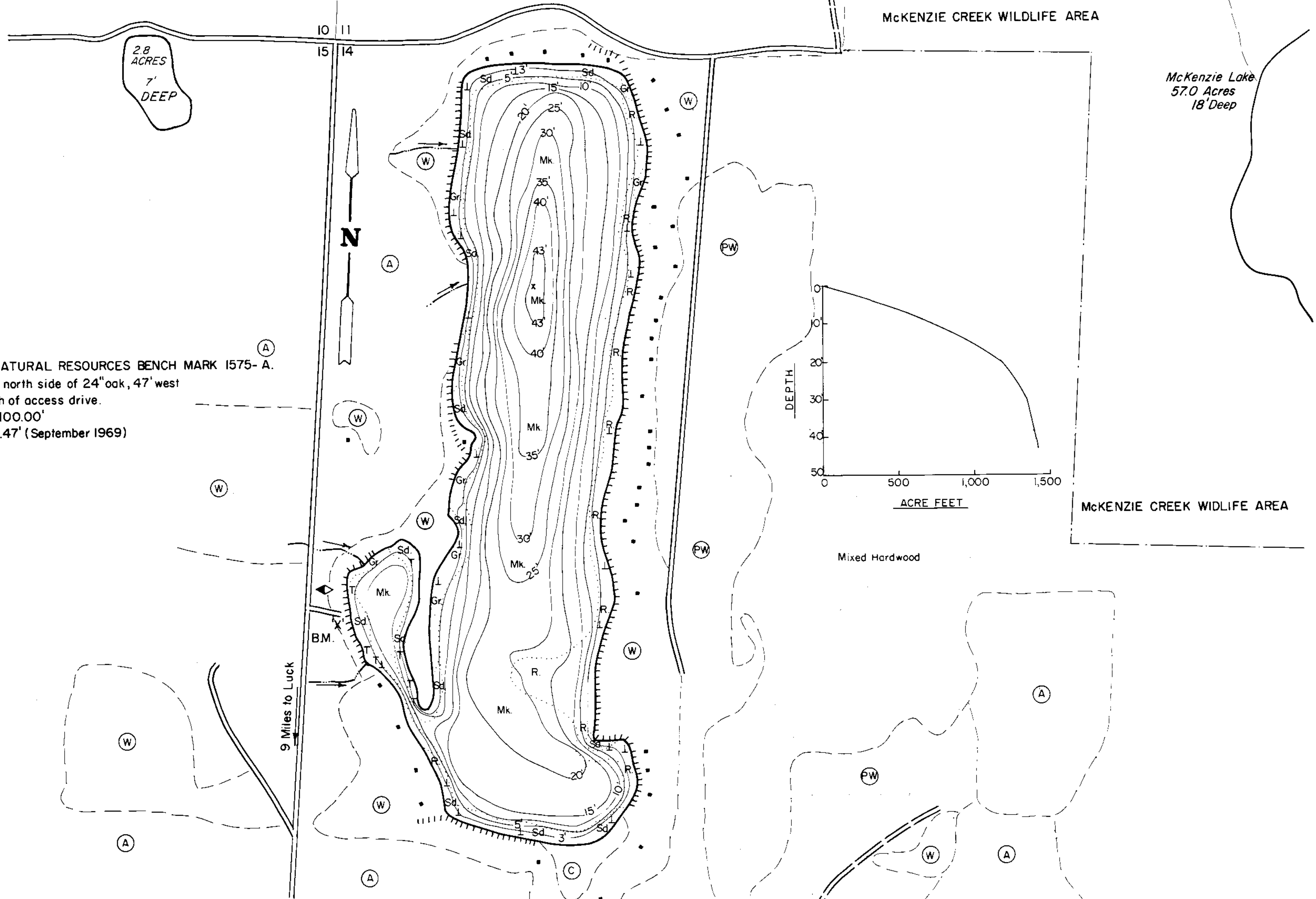

DEPARTMENT OF NATURAL RESOURCES BENCH MARK 1575-A.
Railroad spike set in north side of 24" oak, 47' west of lake, and 25' south of access drive.
Assumed Elevation 100.00'
Water Elevation 88.47' (September 1969)

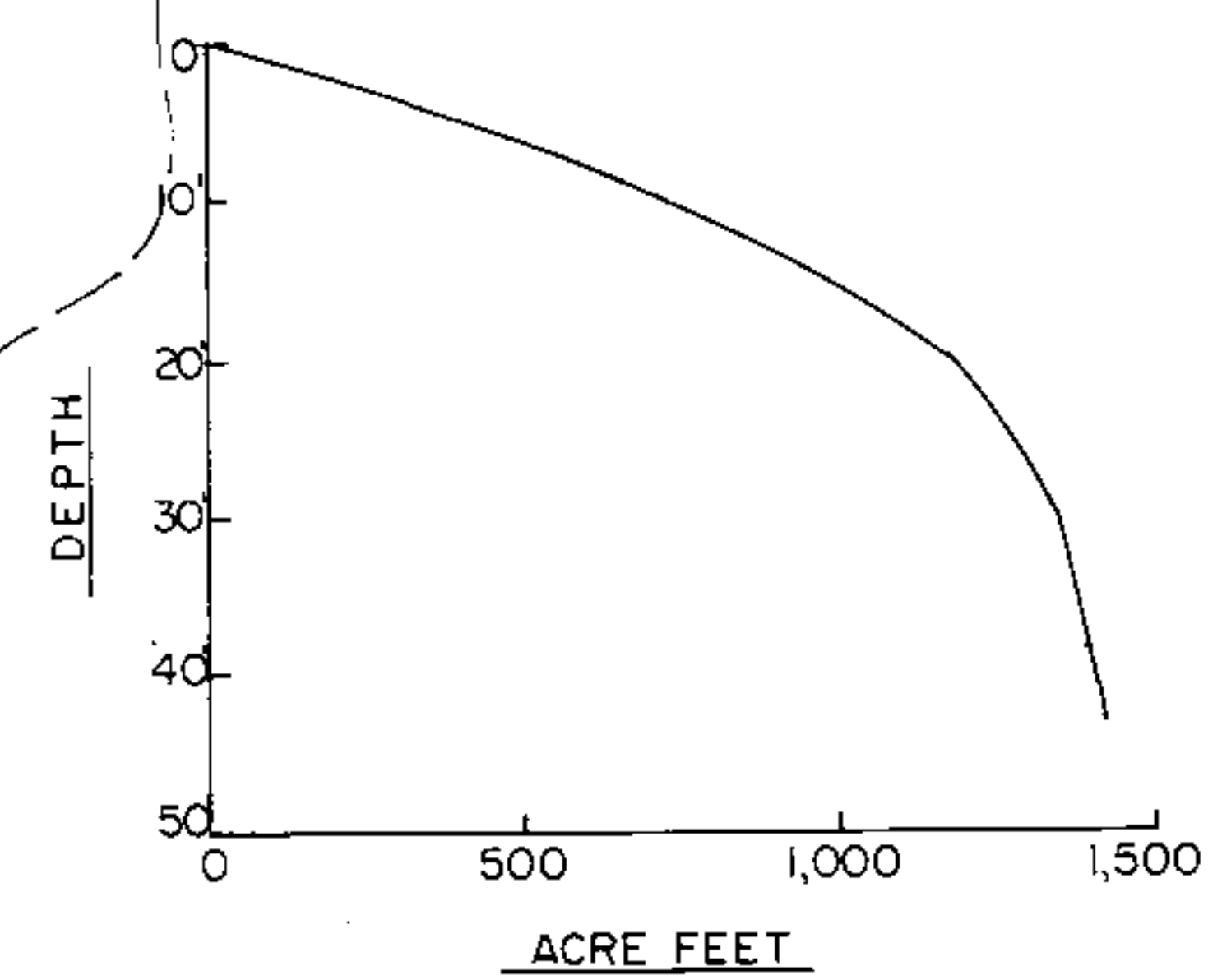

EQUIPMENT RECORDING SONAR MAPPED AUGUST 1969

TOPOGRAPHIC SYMBOLS		LAKE BOTTOM SYMBOLS	
(B) Brush	Steep slope	P. Peat	B. Boulders
(PW) Partially wooded	Indefinite shoreline	Mk. Muck	Stumps & Snags
(W) Wooded	Marsh	C. Clay	Rock danger to navigation
(C) Cleared	Spring	M. Marl	T Submergent vegetation
(P) Pastured	Intermittent stream	Sd. Sand	Emergent vegetation
(A) Agricultural	Permanent inlet	St. Silt	Floating vegetation
B.M. Bench Mark	Permanent outlet	Gr. Gravel	Brush shelters
Resort	Dam	R. Rubble	
Camp	D.N.R. State owned land	Br. Bedrock	



Access Access with Parking Boat Livery

Drawn by: J. Roth
Field work by: C. Belter, C. Busch, S. Johannes

SPECIES OF FISH	Abundance		
	Abundant	Common	Present
Muskie			
N. Pike	X		
Walleye	X		
L. M. Bass			X
S. M. Bass			X
Panfish	X		
Trout			

WATER AREA 90.6 ACRES
UNDER 3 FT. 14 %
OVER 20 FT. 35 %
MAX. DEPTH 43 FEET.
TOTAL ALK. 17 P.P.M.
VOLUME 1,416.6 ACRE FT.
SHORELINE 2.31 MILES

Source: Wisconsin Department of Natural Resources 608-266-2621
Ward Lake – Polk County, Wisconsin DNR Lake Map
Date – Aug 1969 - Historical Lake Map - Not for Navigation
A Public Document - Please Identify the Source when using it.