

LAKE SURVEY MAP

WILKERSON
LAKE

WASHBURN
COUNTY

SEC. 7, 18

T. -39- N. R. -13- W.

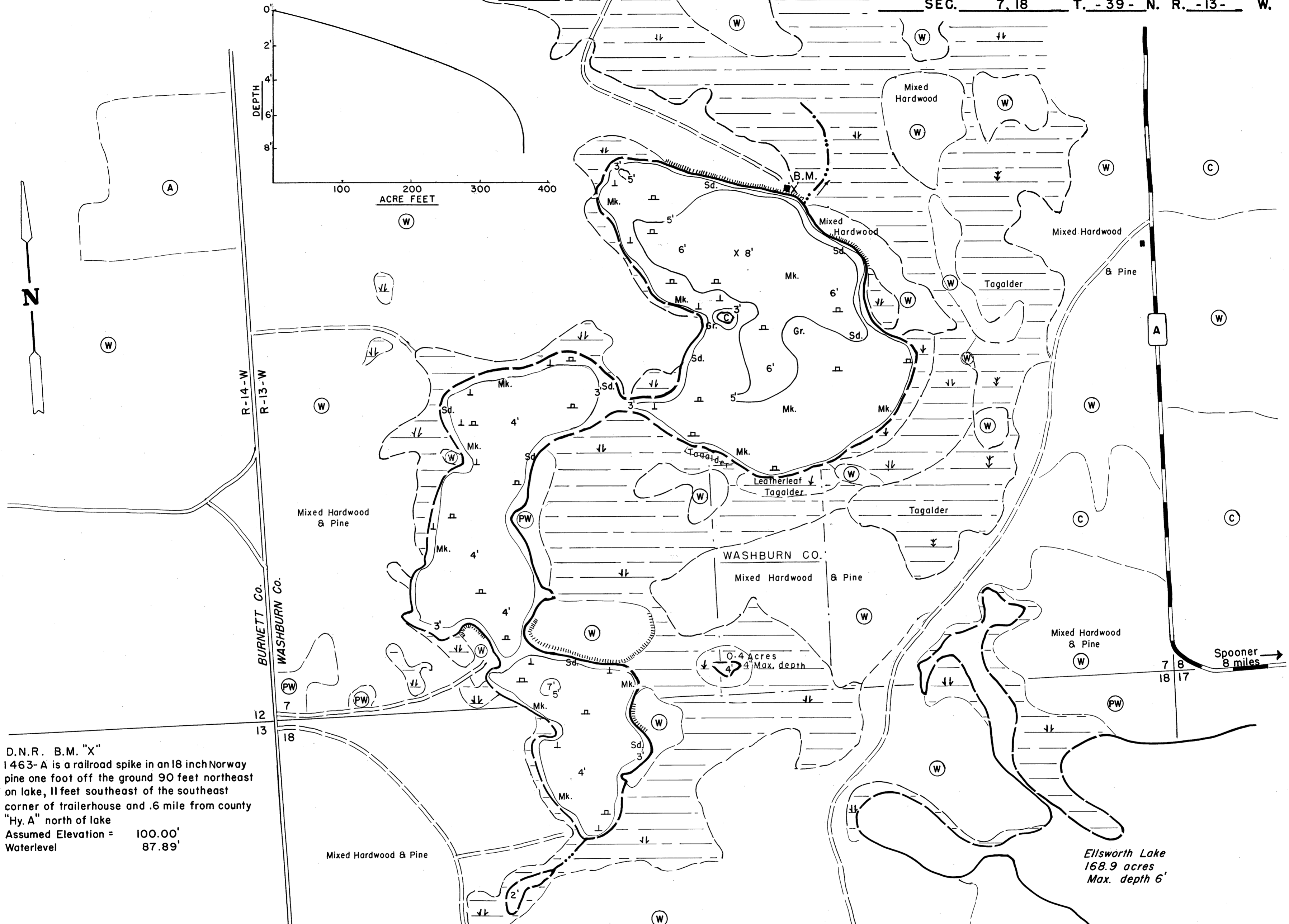

D.N.R. B.M. "X"
1463-A is a railroad spike in an 18 inch Norway pine one foot off the ground 90 feet northeast on lake, 11 feet southeast of the southeast corner of trailerhouse and .6 mile from county "Hy. A" north of lake
Assumed Elevation = 100.00'
Waterlevel = 87.89'

EQUIPMENT MAPPED JUNE 1969
SOUNDING POLE MONTH YEAR
LAKE BOTTOM SYMBOLS

- | TOPOGRAPHIC SYMBOLS | | LAKE BOTTOM SYMBOLS | |
|-----------------------|-------------------------|---------------------|-----------------------------|
| (B) Brush | Steep slope | P. Peat | B Boulders |
| (PW) Partially wooded | ~ Indefinite shoreline | Mk. Muck | o Stumps & Snags |
| (W) Wooded | ~ Marsh | C. Clay | ⊙ Rock danger to navigation |
| (C) Cleared | o Spring | M. Marl | T Submergent vegetation |
| (P) Pastured | ~ Intermittent stream | Sd. Sand | ⊥ Emergent vegetation |
| (A) Agricultural | ~ Permanent inlet | St. Silt | ⊥ Floating vegetation |
| B.M. Bench Mark | ~ Permanent outlet | Gr. Gravel | ⊥ Brush shelters |
| ■ Dwelling | ~ Dam | R. Rubble | |
| □ Resort | D.N.R. State owned land | Br. Bedrock | |
| □ Camp | | | |



◆ Access ◆ Access with Parking ◆ Boat Livery

Drawn by: W. Snyders
Field work by: C. Busch, C. Belter, S. Johannes

SPECIES OF FISH

ANNUAL WINTERKILL	Abundance	
	Abundant	Common
Muskie		
N. Pike		
Walleye		
L.M. Bass		
S.M. Bass		
Panfish		
Trout		

WATER AREA 85.6 ACRES
UNDER 3 FT. 13 %
OVER 20 FT. 0 %
MAX. DEPTH 8 FEET.
TOTAL ALK. 19 P.P.M.
VOLUME 358.4 ACRE FT.
SHORELINE 2.86 MILES
WITHOUT ISL. 2.81 MILES

Ellsworth Lake
168.9 acres
Max. depth 6'

Spoooner 8 miles

Source: Wisconsin Department of Natural Resources 608-266-2621
Wilkerson Lake - Washburn County, Wisconsin DNR Lake Map
Date – Jun 1969 - Historical Lake Map - Not for Navigation
A Public Document - Please Identify the Source when using it.