

LAKE SURVEY MAP

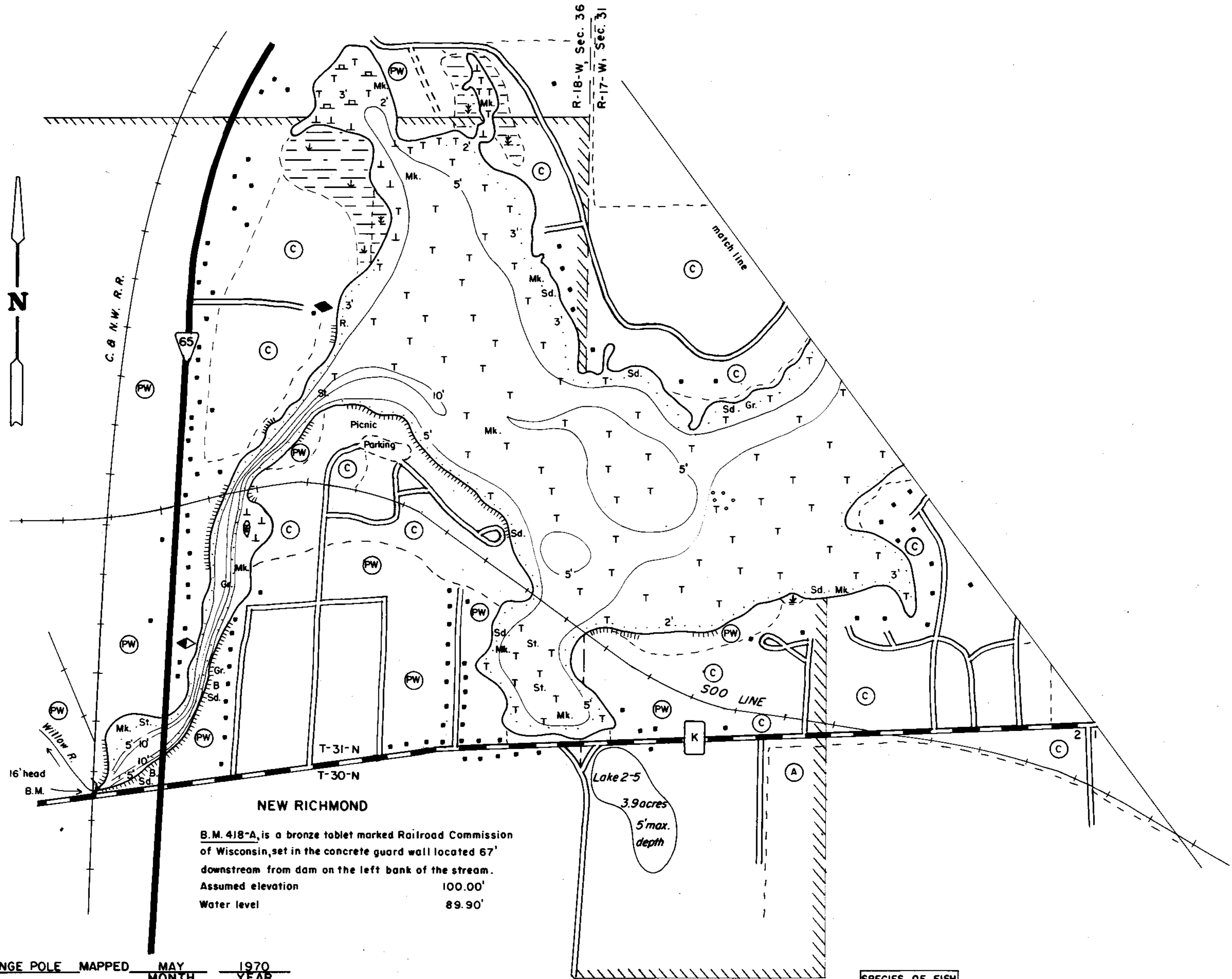

EQUIPMENT SONAR & RANGE POLE MAPPED MAY 1970

- | TOPOGRAPHIC SYMBOLS | | LAKE BOTTOM SYMBOLS | |
|-----------------------|----------------------------|---------------------|-----------------------------|
| (B) Brush | Steep slope | P. Peat | B Boulders |
| (PW) Partially wooded | ----- Indefinite shoreline | Mk. Muck | ⊙ Stumps & Snags |
| (W) Wooded | ⊕ Marsh | C. Clay | ⊙ Rock danger to navigation |
| (C) Cleared | ⊕ Spring | M. Marl | T Submergent vegetation |
| (P) Pastured | ~ Intermittent stream | Sd. Sand | ⊥ Emergent vegetation |
| (A) Agricultural | ≡ Permanent inlet | St. Silt | ⊕ Floating vegetation |
| B.M. Bench Mark | ≡ Permanent outlet | Gr. Gravel | ⊕ Brush shelters |
| ■ Dwelling | ⊕ Dam | R. Rubble | |
| ⊕ Resort | D.N.R. State owned land | Bc. Bedrock | |
| ⊕ Camp | | | |



◆ Access ◆ Access with Parking ◆ Boat Livery

Drawn by: T. Ginder
Field work by: S. Hagen

SPECIES OF FISH	Abundance		
	Abundant	Common	Present
Muskie			
N. Pike		X	
Walleye		X	
L.M. Bass		X	
S.M. Bass		X	
Panfish	X		
Trout			

WATER AREA 235.90 ACRES
 UNDER 3 FT. 39 %
 OVER 20 FT. 0 %
 MAX. DEPTH 15 FEET.
 TOTAL ALK. 130 P.P.M.
 VOLUME 826 ACRE FT.
 SHORELINE 7.91 MILES

LAKE SURVEY MAP

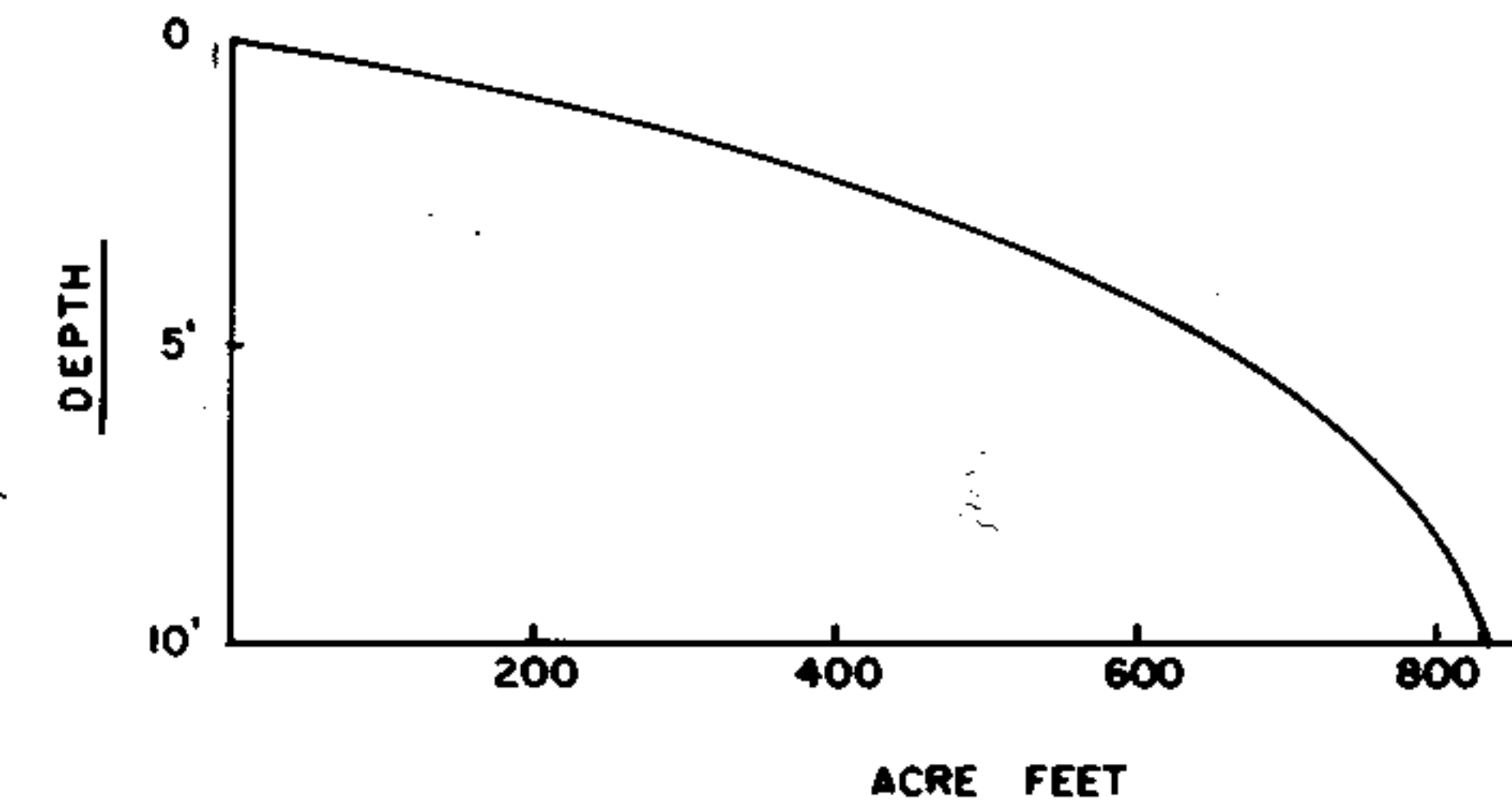
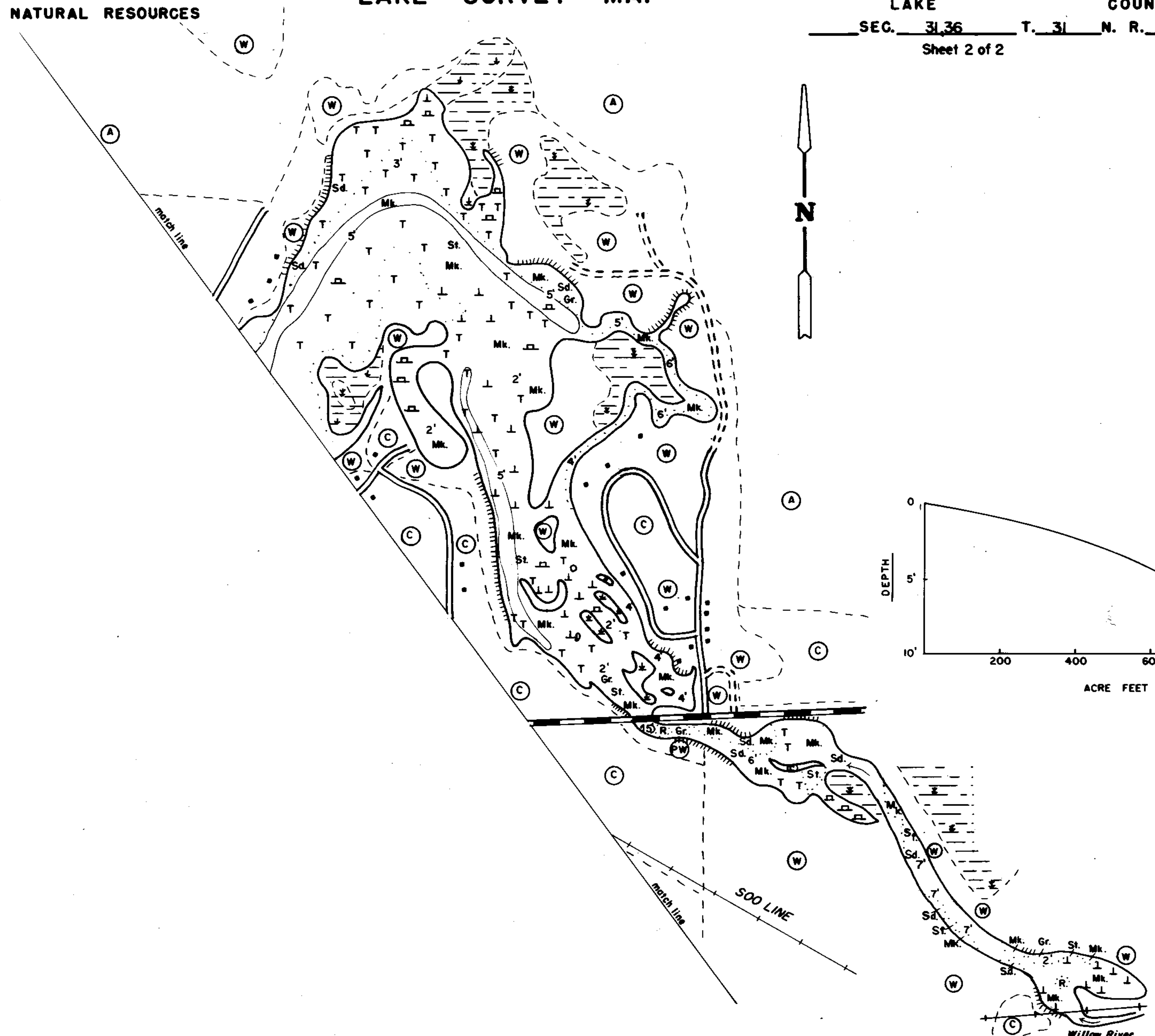

EQUIPMENT SONAR & RANGE POLE MAPPED MAY 1970

TOPOGRAPHIC SYMBOLS		LAKE BOTTOM SYMBOLS	
MONTH		YEAR	
(B) Brush	Steep slope	P. Peat	B Boulders
(W) Partially wooded	----- Indefinite shoreline	Mk. Muck	☼ Stumps & Snags
(W) Wooded	Marsh	C. Clay	☼ Rock danger to navigation
(C) Cleared	Spring	M. Marl	T Submergent vegetation
(P) Pastured	Intermittent stream	Sd. Sand	⊥ Emergent vegetation
(A) Agricultural	Permanent inlet	St. Silt	⊥ Floating vegetation
B.M. Bench Mark	Permanent outlet	Gr. Gravel	⊥ Brush shelters
■ Dwelling	Dam	R. Rubble	
■ Resort	D.N.R. State owned land	Bc. Bedrock	
■ Camp			



◆ Access ◆ Access with Parking ◆ Boat Livery

Drawn by: T. Ginder
Field work by: S. Hagen

SPECIES OF FISH	Abundance		
	Abundant	Common	Present
Muskie			
N. Pike		X	
Walleye		X	
L. M. Bass		X	
S. M. Bass		X	
Panfish	X		
Trot			

WATER AREA 235.90 ACRES
UNDER 3 FT. 39 %
OVER 20 FT. 0 %
MAX. DEPTH 15 FEET.
TOTAL ALK. 130 P.P.M.
VOLUME 826 ACRE FT.
SHORELINE 7.91 MILES

Source: Wisconsin Department of Natural Resources 608-266-2621
New Richmond Flowage – St. Croix County, Wisconsin DNR Lake Map
Date – May 1970 - Historical Lake Map - Not for Navigation
A Public Document - Please Identify the Source when using it.