

B.M. 'X' Rail road spike in the base of the  
W. side of a 24" oak, 9' W of centerline  
of access road and 120' N. of lake  
Assumed elevation 100.00'  
Water level 93.10'

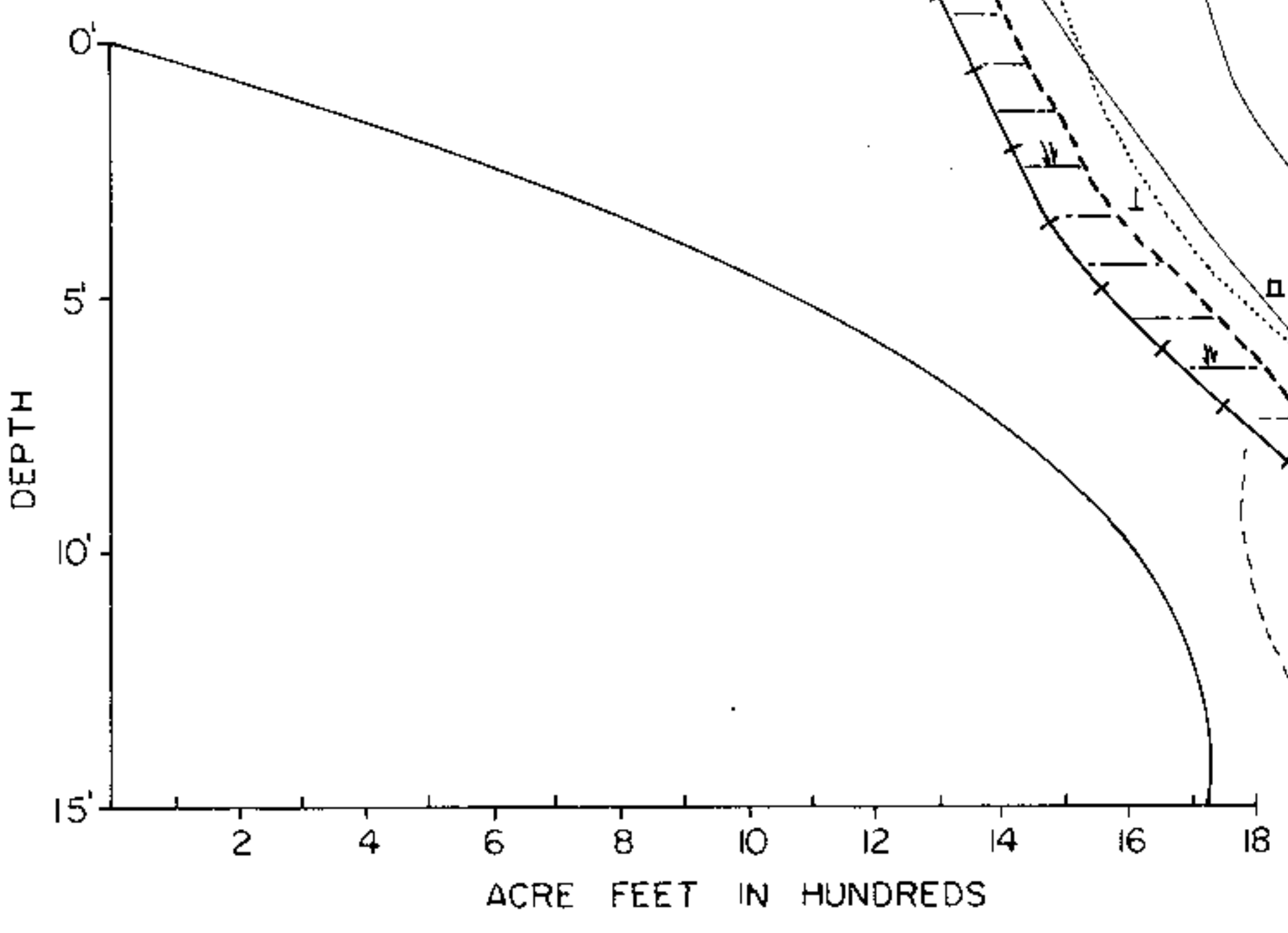
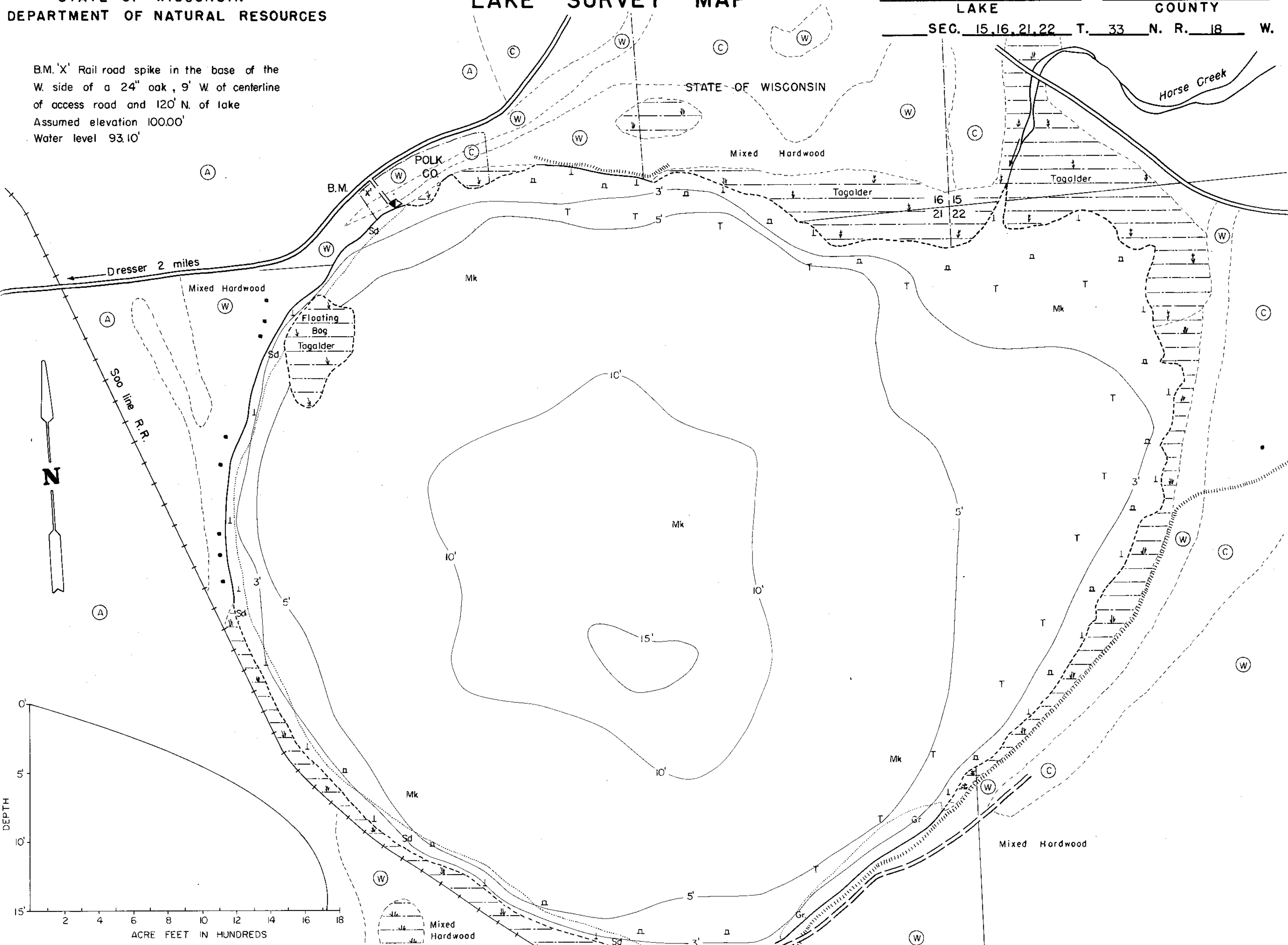

EQUIPMENT RECORDING SONAR MAPPED MAY 1971

- TOPOGRAPHIC SYMBOLS**
- (B) Brush
  - (PW) Partially wooded
  - (W) Wooded
  - (C) Cleared
  - (P) Pastured
  - (A) Agricultural
  - B.M. Bench Mark
  - Dwelling
  - Resort
  - Camp
  - ||||| Steep slope
  - - - Indefinite shoreline
  - Marsh
  - Spring
  - Intermittent stream
  - Permanent inlet
  - Permanent outlet
  - D.N.R. State owned land

- LAKE BOTTOM SYMBOLS**
- P. Peat
  - Mk. Muck
  - C. Clay
  - M. Marl
  - Sd. Sand
  - St. Silt
  - Gr. Gravel
  - R. Rubble
  - Br. Bedrock
  - B Boulders
  - Stumps & Snags
  - Rock danger to navigation
  - T Submergent vegetation
  - Emergent vegetation
  - Floating vegetation
  - Brush shelters



◆ Access    ◆ Access with Parking    ◆ Boat Livery

Drawn by: C. Holt  
Field work by: C. Busch, G. Lund, L. Sother

SPECIES OF FISH	Abundance		
	Abundant	Common	Present
Winterkill			
Muskie			
N. Pike		X	
Walleye			
L.M. Bass		X	
S.M. Bass			
Panfish	X		
Trout			

WATER AREA 245.9 ACRES  
 UNDER 3 FT. 12.2 %  
 OVER 20 FT. 0 %  
 MAX. DEPTH 15 FEET.  
 TOTAL ALK. 76 P.P.M.  
 VOLUME 1724 ACRE FT.  
 SHORELINE 3.29 MILES

Source: Wisconsin Department of Natural Resources 608-266-2621  
East Lake – Polk County, Wisconsin DNR Lake Map  
Date – May 1971 - Historical Lake Map - Not for Navigation  
A Public Document - Please Identify the Source when using it.