

LAKE SURVEY MAP

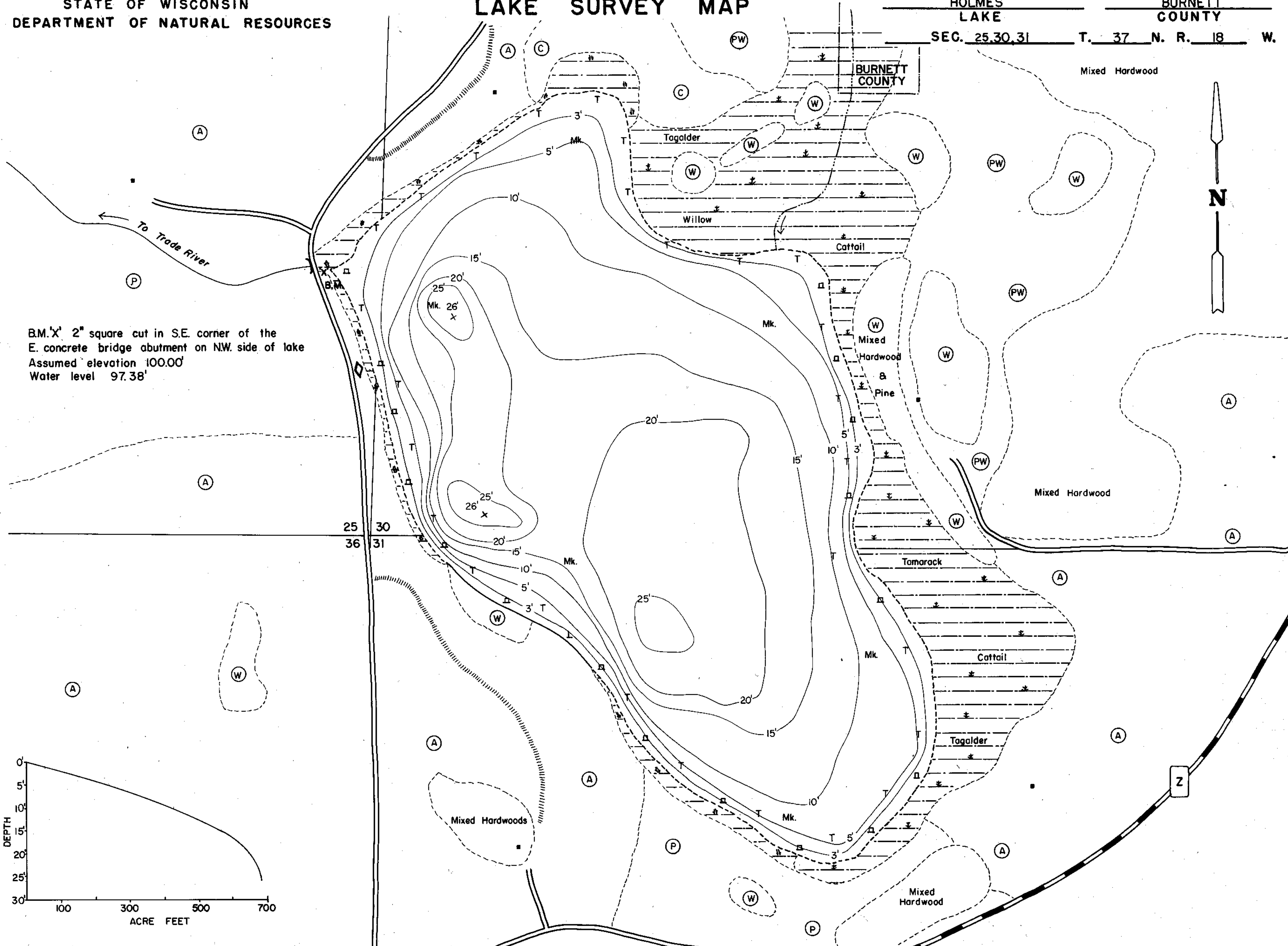

B.M. 'X' 2" square cut in S.E. corner of the E. concrete bridge abutment on NW. side of lake
Assumed elevation 100.00'
Water level 97.38'

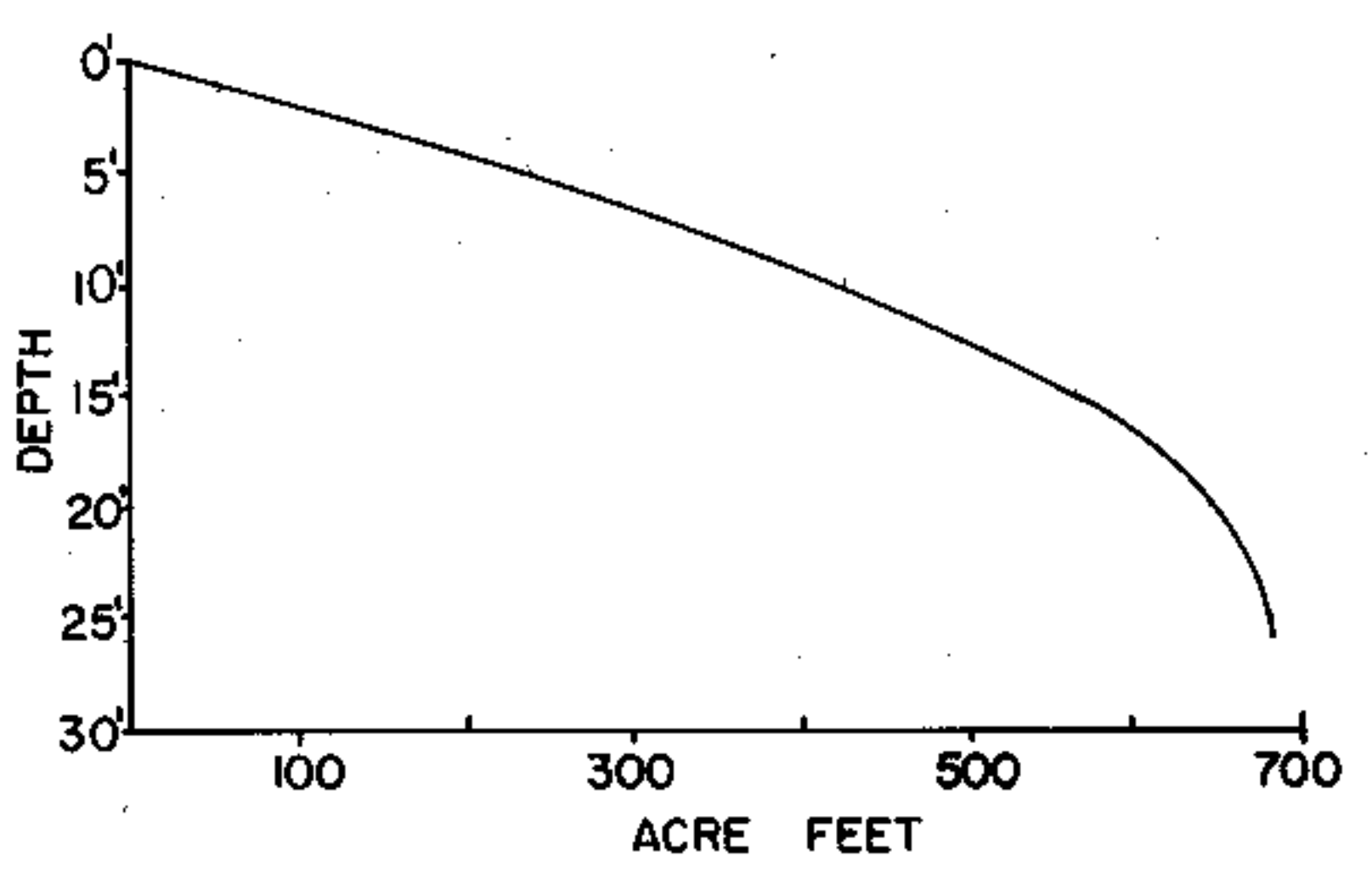

EQUIPMENT RECORDING SONAR MAPPED JULY 1970

- TOPOGRAPHIC SYMBOLS**
- (B) Brush
 - (PW) Partially wooded
 - (W) Wooded
 - (C) Cleared
 - (P) Pastured
 - (A) Agricultural
 - B.M. Bench Mark
 - Dwelling
 - Resort
 - Camp
 - ||||| Steep slope
 - - - Indefinite shoreline
 - Marsh
 - Spring
 - Intermittent stream
 - Permanent inlet
 - Permanent outlet
 - Dam
 - D.N.R. State owned land

- LAKE BOTTOM SYMBOLS**
- P. Peat
 - Mk. Muck
 - C. Clay
 - M. Marl
 - Sd. Sand
 - St. Silt
 - Gr. Gravel
 - R. Rubble
 - Br. Bedrock
 - B Boulders
 - Stumps & Snags
 - Rock danger to navigation
 - T Submergent vegetation
 - L Emergent vegetation
 - F Floating vegetation
 - Brush shelters

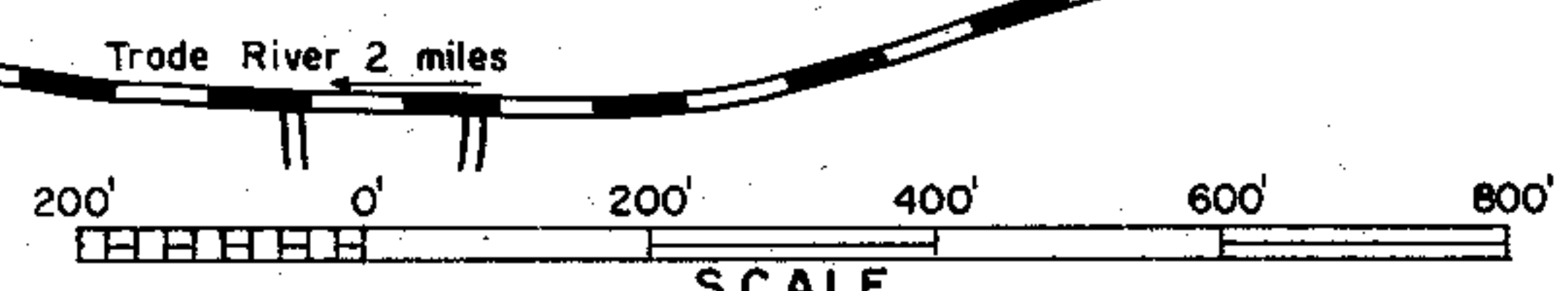

Access Access with Parking Boat Livery
Drawn by: C. Holt
Field work by: C. Busch, C. Stocks, L. Sather

SPECIES OF FISH	Abundant Common Present		
	Abundant	Common	Present
Muskie			
N. Pike			X
Walleye			X
L.M. Bass			X
S.M. Bass			X
Panfish			X
Trout			X
Carp	X		

WATER AREA 54.1 ACRES
UNDER 3 FT. 13 %
OVER 20 FT. 3 %
MAX. DEPTH 26 FEET.
TOTAL ALK. 143 P.P.M.
VOLUME 685.7 ACRE FT.
SHORELINE 128 MILES

Source: Wisconsin Department of Natural Resources 608-266-2621
Holmes Lake – Burnett County, Wisconsin DNR Lake Map
Date – Jul 1970 - Historical Lake Map - Not for Navigation
A Public Document - Please Identify the Source when using it.