

Big & Little

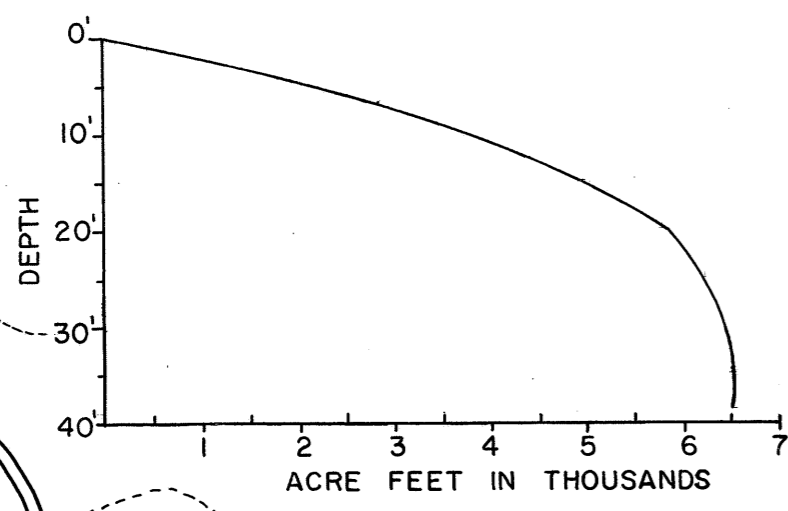
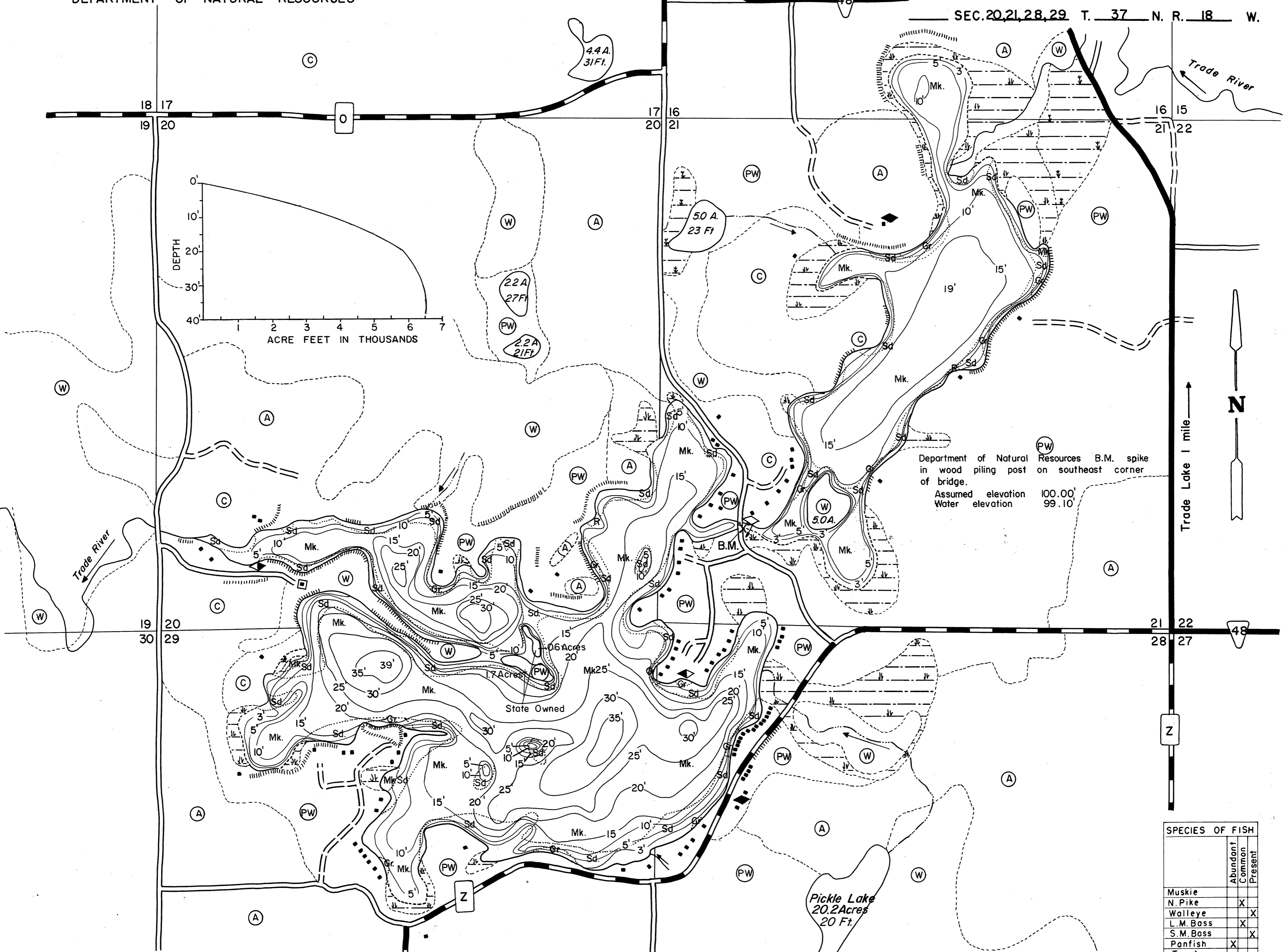

Department of Natural Resources B.M. spike
in wood piling post on southeast corner
of bridge.
Assumed elevation 100.00'
Water elevation 99.10'

EQUIPMENT RECORDING SONAR MAPPED MAY 1968
MO. YR.

- TOPOGRAPHIC SYMBOLS
- (B) Brush
 - (PW) Partially wooded
 - (W) Wooded
 - (C) Cleared
 - (P) Pastured
 - (A) Agricultural
 - B.M. Bench Mark
 - Dwelling
 - Resort
 - ||||| Steep slope
 - - - Indefinite shoreline
 - Marsh
 - Spring
 - Intermittent stream
 - Permanent inlet
 - Permanent outlet
 - Dam

- LAKE BOTTOM SYMBOLS
- P. Peat
 - Mk. Muck
 - C. Clay
 - M. Marl
 - Sd. Sand
 - St. Silt
 - Gr. Gravel
 - R. Rubble
 - Br. Bedrock
 - Stumps & Snags
 - T Submergent vegetation
 - Emergent vegetation
 - Floating vegetation

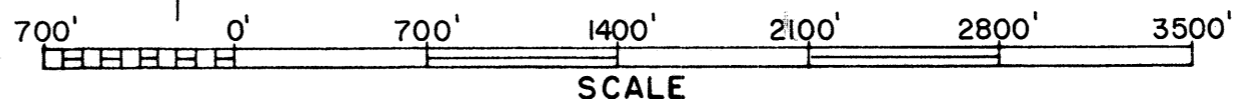

◇ Access ◇ Access with Parking ◆ Boat Livery
Field work by: C. Busch, C. Olson, L. Sather Drawn by: C. Holt

SPECIES OF FISH		
	Abundant	Present
Muskie		
N. Pike	X	
Walleye		X
L. M. Bass	X	
S. M. Bass		X
Panfish	X	
Trout		

425.6 WITHOUT IS.
AREA 433.7 ACRES
UNDER 3 FT. 2.3 %
OVER 20 FT. 46.2 %
VOLUME 6522.3 ACRE FT.
TOTAL ALK. 91 P.P.M.
SHORELINE 8.4 MILES
MAX. DEPTH 39 FEET

Source: Wisconsin Department of Natural Resources 608-266-2621
Big Trade Lake – Burnett County, Wisconsin DNR Lake Map
Date – May 1968 - Historical Lake Map - Not for Navigation
A Public Document - Please Identify the Source when using it.