

BURNETT CO. 34 35  
POLK CO. 3 2

Atlas 2 miles

35 36 T-37-N  
2 1 T-36-N

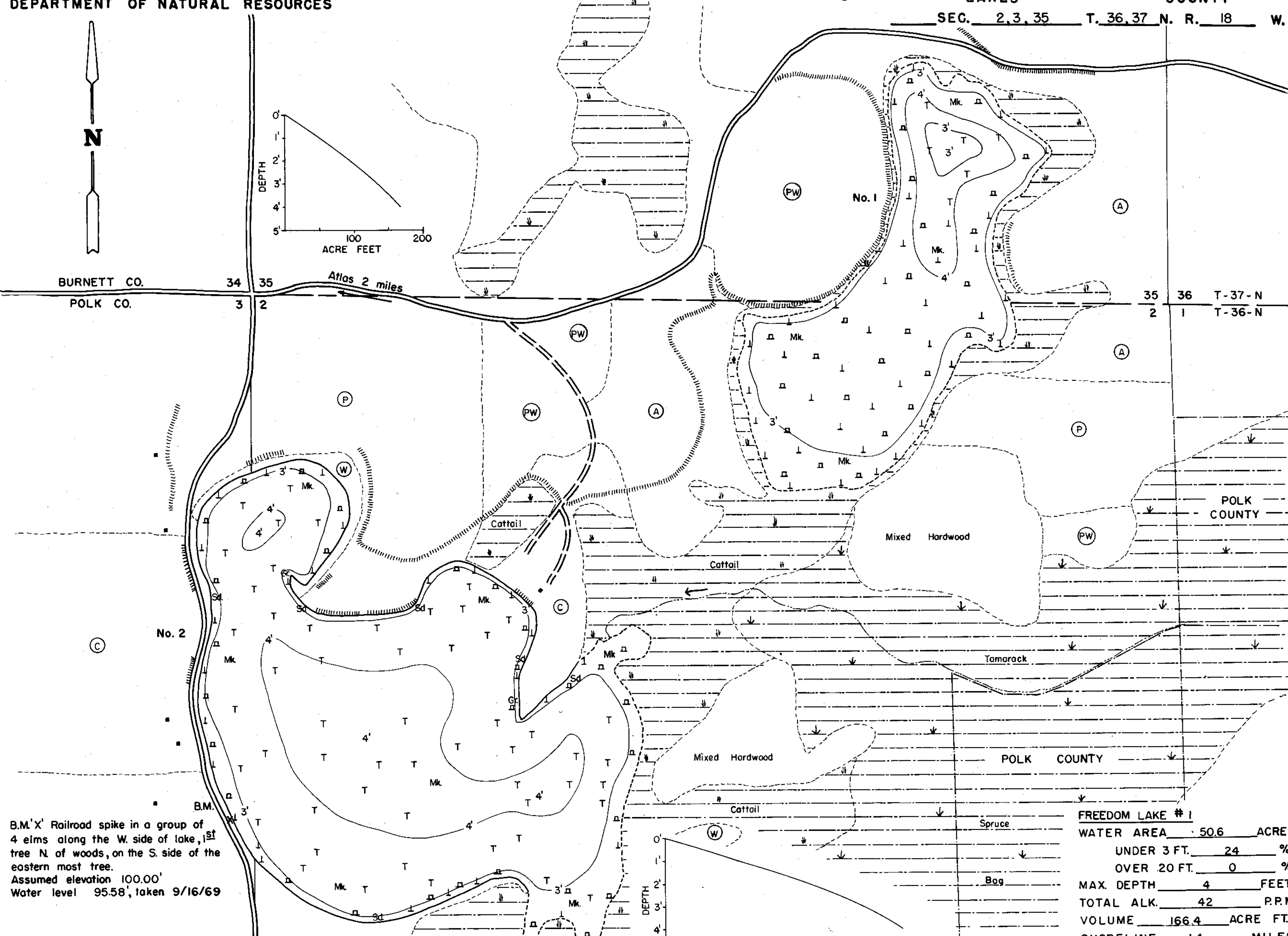

B.M. 'X' Railroad spike in a group of 4 elms along the W. side of lake, 1st tree N. of woods, on the S. side of the eastern most tree.  
Assumed elevation 100.00'  
Water level 95.58', taken 9/16/69

EQUIPMENT RECORDING SONAR MAPPED SEPT 1969  
MONTH YEAR

- TOPOGRAPHIC SYMBOLS
- (B) Brush
  - (PW) Partially wooded
  - (W) Wooded
  - (C) Cleared
  - (P) Pastured
  - (A) Agricultural
  - B.M. Bench Mark
  - Dwelling
  - Resort
  - Camp
  - ||||| Steep slope
  - Indefinite shoreline
  - Marsh
  - Spring
  - Intermittent stream
  - Permanent inlet
  - Permanent outlet
  - Dam
  - D.N.R. State owned land

- LAKE BOTTOM SYMBOLS
- P. Peat
  - Mk. Muck
  - C. Clay
  - M. Marl
  - Sd. Sand
  - St. Silt
  - Gr. Gravel
  - R. Rubble
  - Br. Bedrock
  - B Boulders
  - Stumps & Snags
  - Rock danger to navigation
  - T Submergent vegetation
  - ↓ Emergent vegetation
  - ↑ Floating vegetation
  - Brush shelters

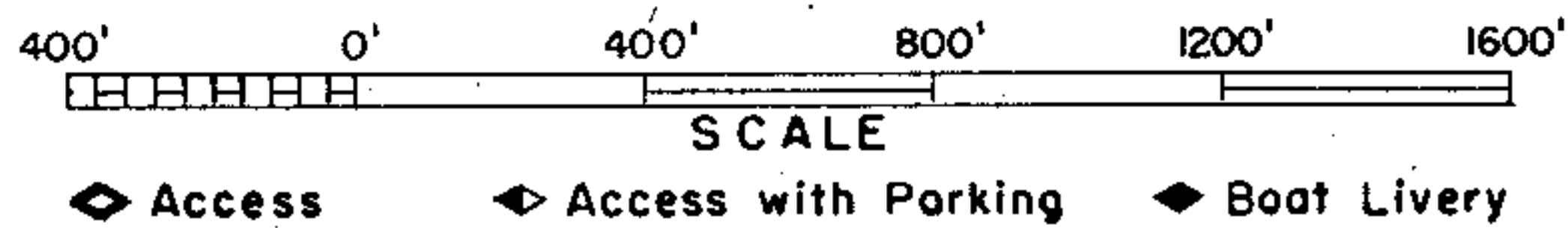

Drawn by: C. Holt  
Field work by: C. Busch, G. Lund, J. Sather

SPECIES OF FISH	Abundant Common Present		
	Abundant	Common	Present
Muskie			X
N. Pike			X
Walleye			X
L.M. Bass			X
S.M. Bass			X
Panfish	X		
Trout			

**FREEDOM LAKE #1**  
 WATER AREA 50.6 ACRES  
 UNDER 3 FT. 24 %  
 OVER 20 FT. 0 %  
 MAX. DEPTH 4 FEET.  
 TOTAL ALK. 42 P.P.M.  
 VOLUME 166.4 ACRE FT.  
 SHORELINE 1.4 MILES

**FREEDOM LAKE #2**  
 WATER AREA 105.6 ACRES  
 UNDER 3 FT. 19 %  
 OVER 20 FT. 0 %  
 MAX. DEPTH 4 FEET.  
 TOTAL ALK. 48 P.P.M.  
 VOLUME 343.0 ACRE FT.  
 SHORELINE 2.3 MILES

Source: Wisconsin Department of Natural Resources 608-266-2621  
Freedom Lakes – Burnett/Polk Counties, Wisconsin DNR Lake Map  
Date – Sep 1969 - Historical Lake Map - Not for Navigation  
A Public Document - Please Identify the Source when using it.