

LAKE SURVEY MAP

SPIRIT LAKE
SEC. 1, 2, 11, 12 T. 37 N. R. 18 W.
BURNETT COUNTY

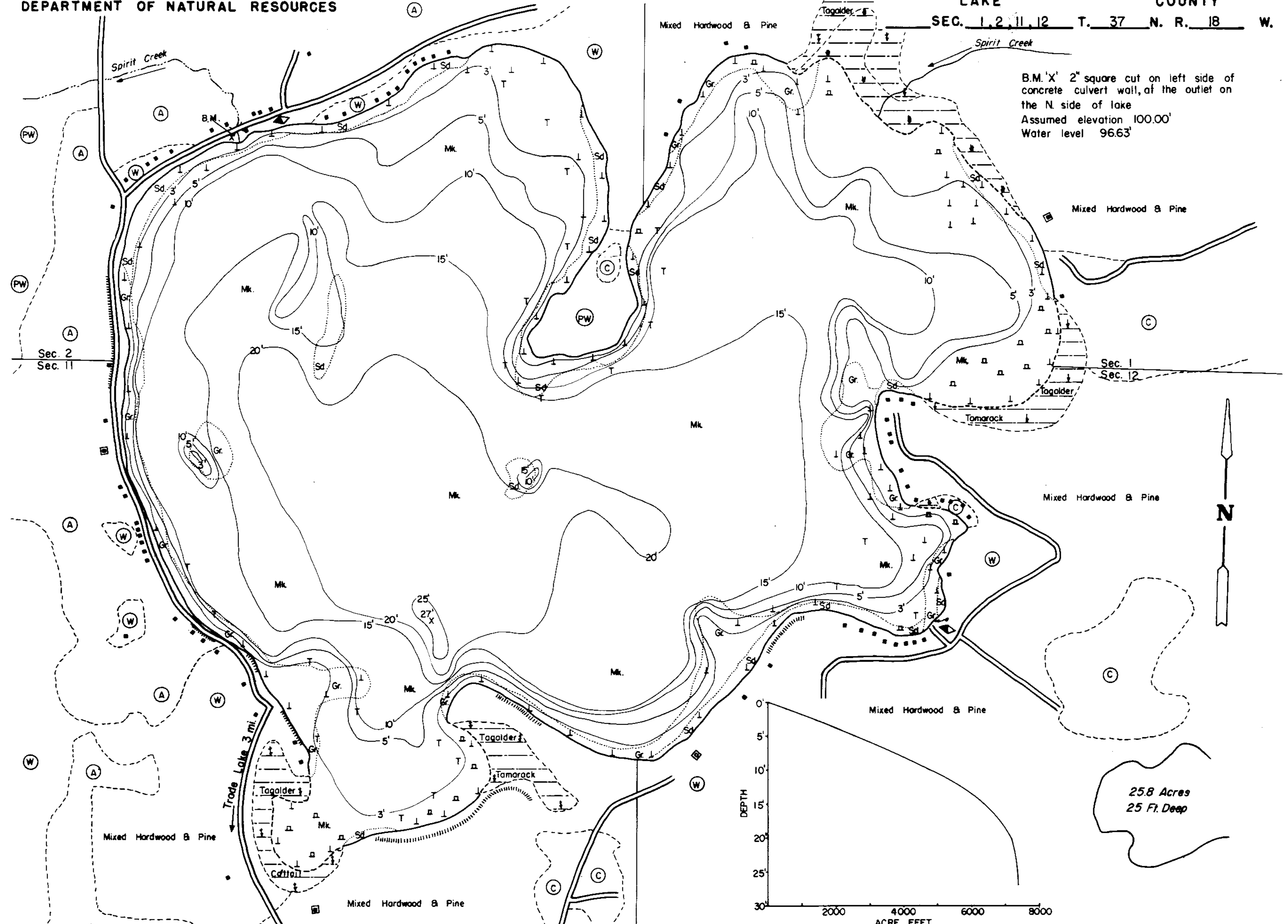

B.M. 'X' 2" square cut on left side of concrete culvert wall, at the outlet on the N side of lake
Assumed elevation 100.00'
Water level 96.63'

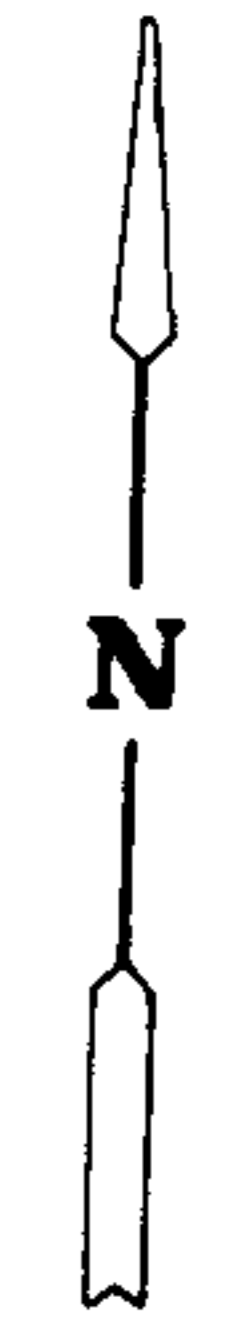

25.8 Acres
25 Ft. Deep

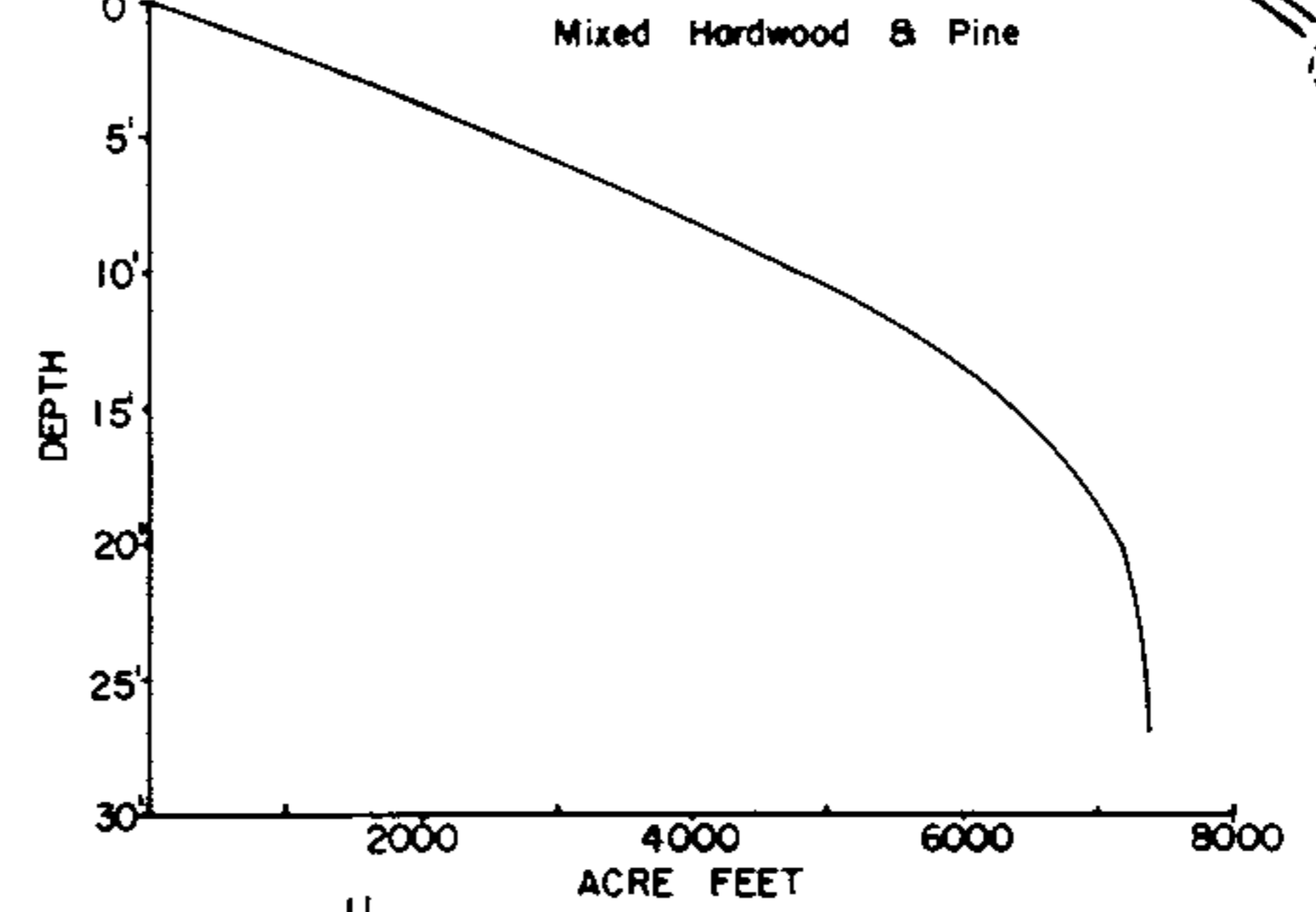

EQUIPMENT RECORDING SONAR MAPPED SEPT 1969

- | TOPOGRAPHIC SYMBOLS | | LAKE BOTTOM SYMBOLS | |
|-----------------------|----------------------------|---------------------|-----------------------------|
| (B) Brush | Steep slope | P. Peat | B Boulders |
| (PW) Partially wooded | - - - Indefinite shoreline | Mk. Muck | ⊙ Stumps & Snags |
| (W) Wooded | ⊞ Marsh | C. Clay | ⚡ Rock danger to navigation |
| (C) Cleared | ⊞ Spring | M. Marl | T Submergent vegetation |
| (P) Pastured | ⊞ Intermittent stream | Sd. Sand | ⊥ Emergent vegetation |
| (A) Agricultural | ⊞ Permanent inlet | St. Silt | ⊞ Floating vegetation |
| B.M. Bench Mark | ⊞ Permanent outlet | Gr. Gravel | ⊞ Brush shelters |
| ■ Dwelling | ⊞ Dam | R. Rubble | |
| ⊞ Resort | ⊞ D.N.R. State owned land | Bc. Bedrock | |
| ⊞ Camp | | | |

500' 0' 500' 1000' 1500' 2000'
SCALE
◆ Access ◆ Access with Parking ◆ Boat Livery
Drawn by: C. Holt
Field work by: C. Busch, G. Lund, S. Johannes

SPECIES OF FISH	Abundance		
	Abundant	Common	Present
Muskie			
N. Pike	X		
Walleye		X	
L.M. Bass	X	X	
S.M. Bass	X		
Panfish	X		
Trout			

WATER AREA 593.3 ACRES
UNDER 3 FT. 12 %
OVER 20 FT. 14 %
MAX. DEPTH 27 FEET.
TOTAL ALK. 102 P.P.M.
VOLUME 7351.9 ACRE FT.
SHORELINE 5.40 MILES

Source: Wisconsin Department of Natural Resources 608-266-2621
Spirit Lake – Burnett County, Wisconsin DNR Lake Map
Date – Sep 1969 - Historical Lake Map - Not for Navigation
A Public Document - Please Identify the Source when using it.