

LAKE SURVEY MAP

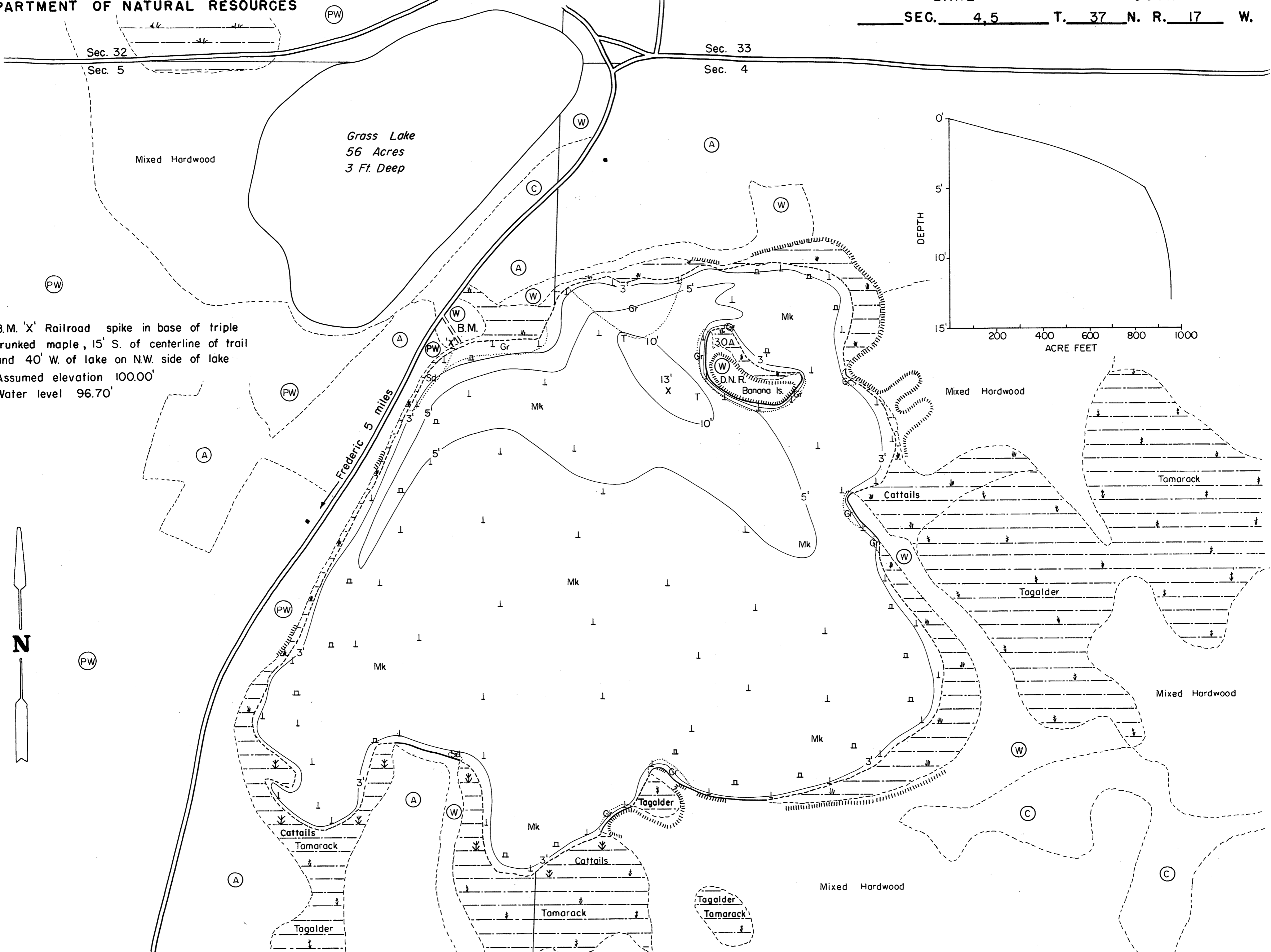

B.M. 'X' Railroad spike in base of triple trunked maple, 15' S. of centerline of trail and 40' W. of lake on N.W. side of lake
Assumed elevation 100.00'
Water level 96.70'

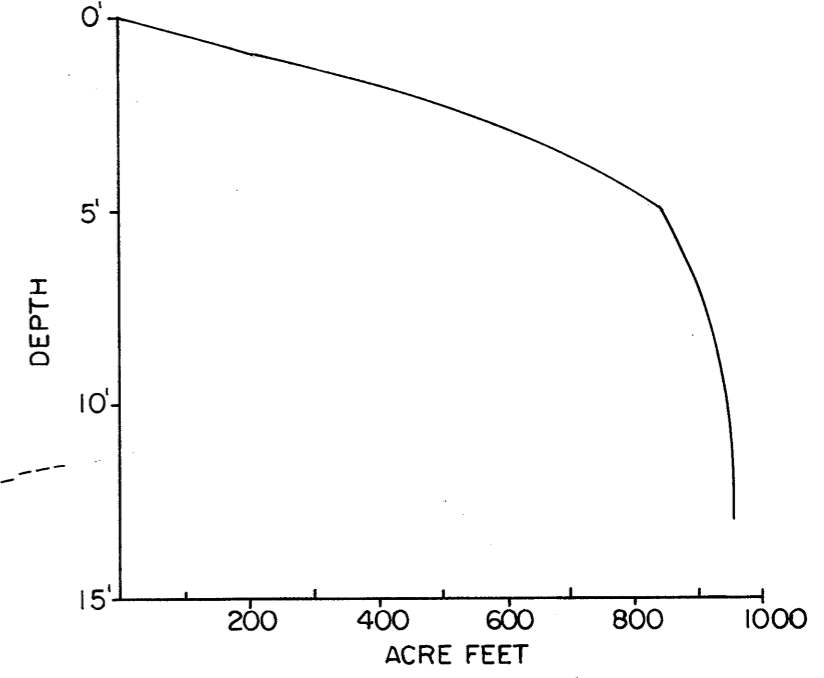

EQUIPMENT RECORDING SONAR MAPPED JUNE 1971

- TOPOGRAPHIC SYMBOLS**
- (B) Brush
 - (PW) Partially wooded
 - (W) Wooded
 - (C) Cleared
 - (P) Pastured
 - (A) Agricultural
 - B.M. Bench Mark
 - Dwelling
 - Resort
 - Camp
 - ||||| Steep slope
 - - - Indefinite shoreline
 - Marsh
 - Spring
 - Intermittent stream
 - Permanent inlet
 - Permanent outlet
 - Dam
 - D.N.R. State owned land

- LAKE BOTTOM SYMBOLS**
- P. Peat
 - Mk. Muck
 - C. Clay
 - M. Marl
 - Sd. Sand
 - St. Silt
 - Gr. Gravel
 - R. Rubble
 - Br. Bedrock
 - B Boulders
 - Stumps & Snags
 - Rock danger to navigation
 - T Submergent vegetation
 - Emergent vegetation
 - Floating vegetation
 - Brush shelters

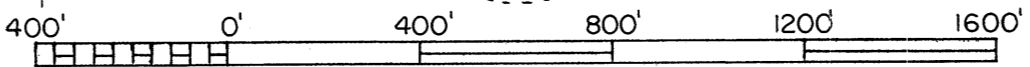

◆ Access ◆ Access with Parking ◆ Boat Livery

Drawn by: C. Holt
Field work by: C. Busch, G. Lund, L. Sather

SPECIES OF FISH	Abundant Common Present		
	Abundant	Common	Present
Muskie			
N. Pike	X		
Walleye			
L. M. Bass	X		
S. M. Bass			
Panfish	X		
Trout			

WATER AREA 208.4 ACRES
UNDER 3 FT. 4.1 %
OVER 20 FT. 0 %
MAX. DEPTH 13 FEET.
TOTAL ALK. 90 P.P.M.
VOLUME 957 ACRE FT.
SHORELINE 2.67 MILES
SHORELINE 2.97 MILES WITH IS.

Source: Wisconsin Department of Natural Resources 608-266-2621
Blom Lake – Polk County, Wisconsin DNR Lake Map
Date – Jun 1971 - Historical Lake Map - Not for Navigation
A Public Document - Please Identify the Source when using it.