

LAKE SURVEY MAP

SOMERS LAKE
POLK COUNTY
SEC. 27,28 T. 37 N. R. 16 W.

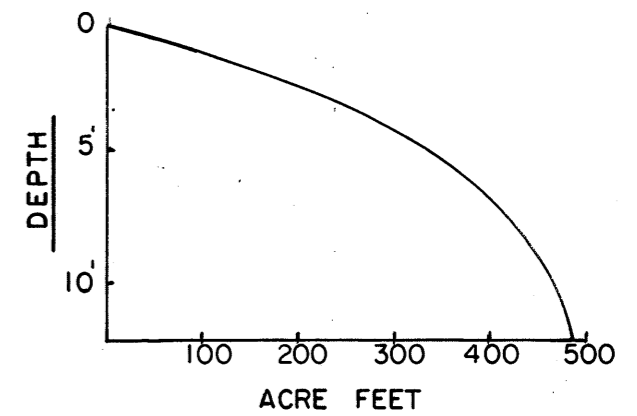
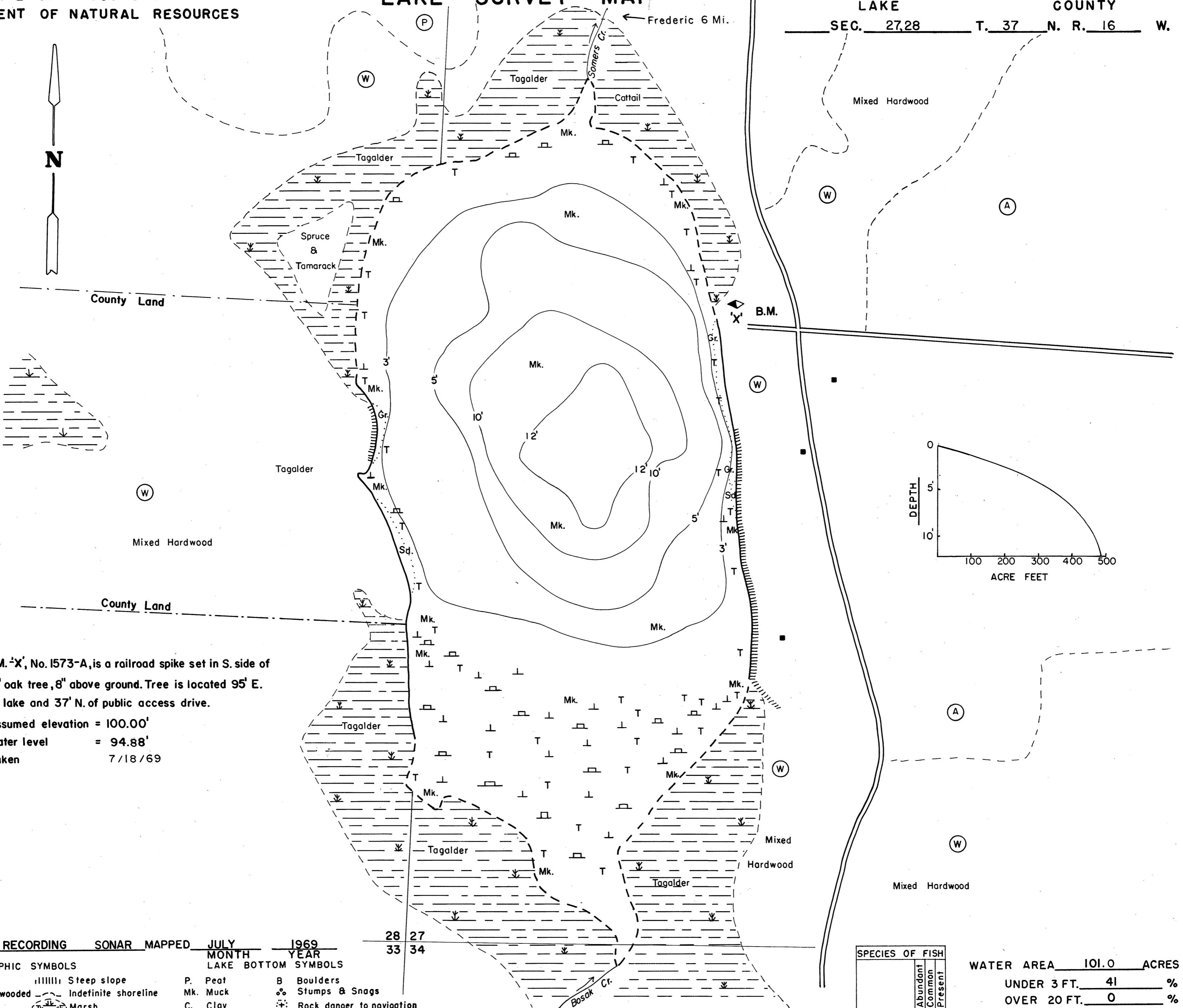

B.M. 'X', No. 1573-A, is a railroad spike set in S. side of 14' oak tree, 8" above ground. Tree is located 95' E. of lake and 37' N. of public access drive.
Assumed elevation = 100.00'
Water level = 94.88'
Taken 7/18/69

EQUIPMENT RECORDING SONAR MAPPED JULY 1969
MONTH YEAR
33 34

TOPOGRAPHIC SYMBOLS		LAKE BOTTOM SYMBOLS	
(B) Brush	Steep slope	P. Peat	B Boulders
(PW) Partially wooded	- - - Indefinite shoreline	Mk. Muck	o Stumps & Snags
(W) Wooded	Marsh	C. Clay	⊙ Rock danger to navigation
(C) Cleared	o Spring	M. Marl	T Submergent vegetation
(P) Pastured	- - - Intermittent stream	Sd. Sand	⊥ Emergent vegetation
(A) Agricultural	==== Permanent inlet	St. Silt	⊕ Floating vegetation
B.M. Bench Mark	==== Permanent outlet	Gr. Gravel	⊕ Brush shelters
■ Dwelling	⊕ Dam	R. Rubble	
□ Resort	D.N.R. State owned land	Br. Bedrock	
□ Camp			

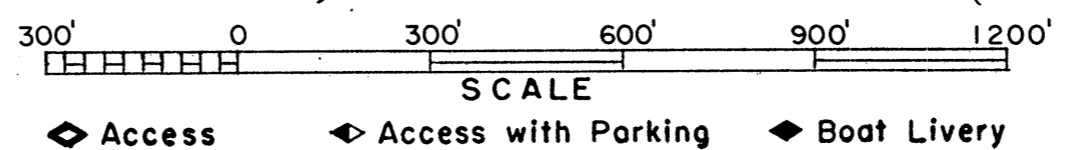

Access Access with Parking Boat Livery
Drawn by: T. Ginder
Field work by: C. Busch, C. Belter, & S. Johannes

SPECIES OF FISH	ABUNDANCE		
	Abundant	Common	Present
Muskie			
N. Pike		X	
Walleye			
L.M. Bass			
S.M. Bass			
Panfish	X		
Trout			

WATER AREA 101.0 ACRES
UNDER 3 FT. 41 %
OVER 20 FT. 0 %
MAX. DEPTH 12 FEET.
TOTAL ALK. 49 P.P.M.
VOLUME 483.7 ACRE FT.
SHORELINE 1.78 MILES

Source: Wisconsin Department of Natural Resources 608-266-2621
Somers Lake – Polk County, Wisconsin DNR Lake Map
Date – Jul 1969 - Historical Lake Map - Not for Navigation
A Public Document - Please Identify the Source when using it.