

Pine Lake  
147 acres  
53' max. depth

Sedge Lake  
20 acres  
3' max. depth

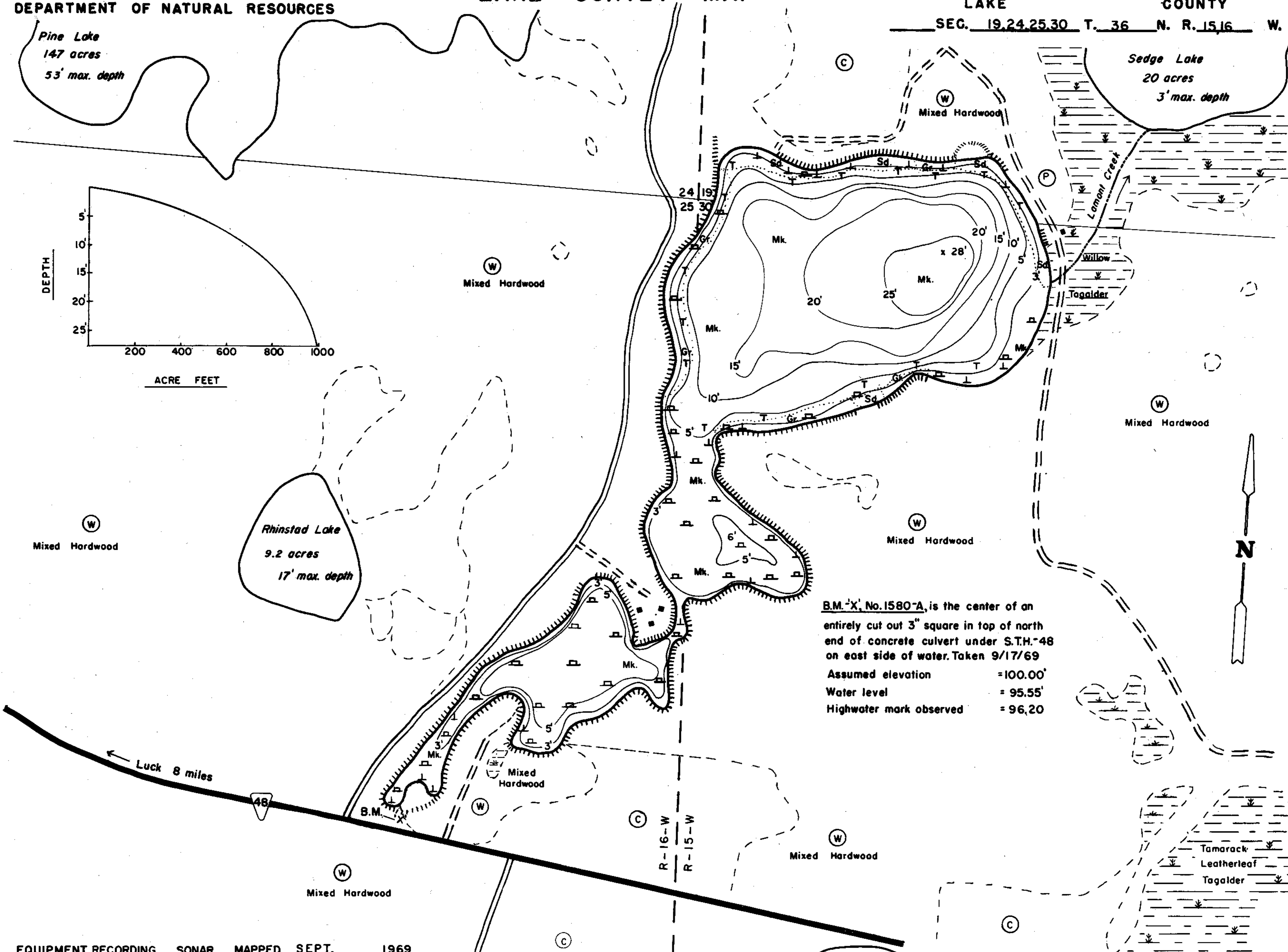
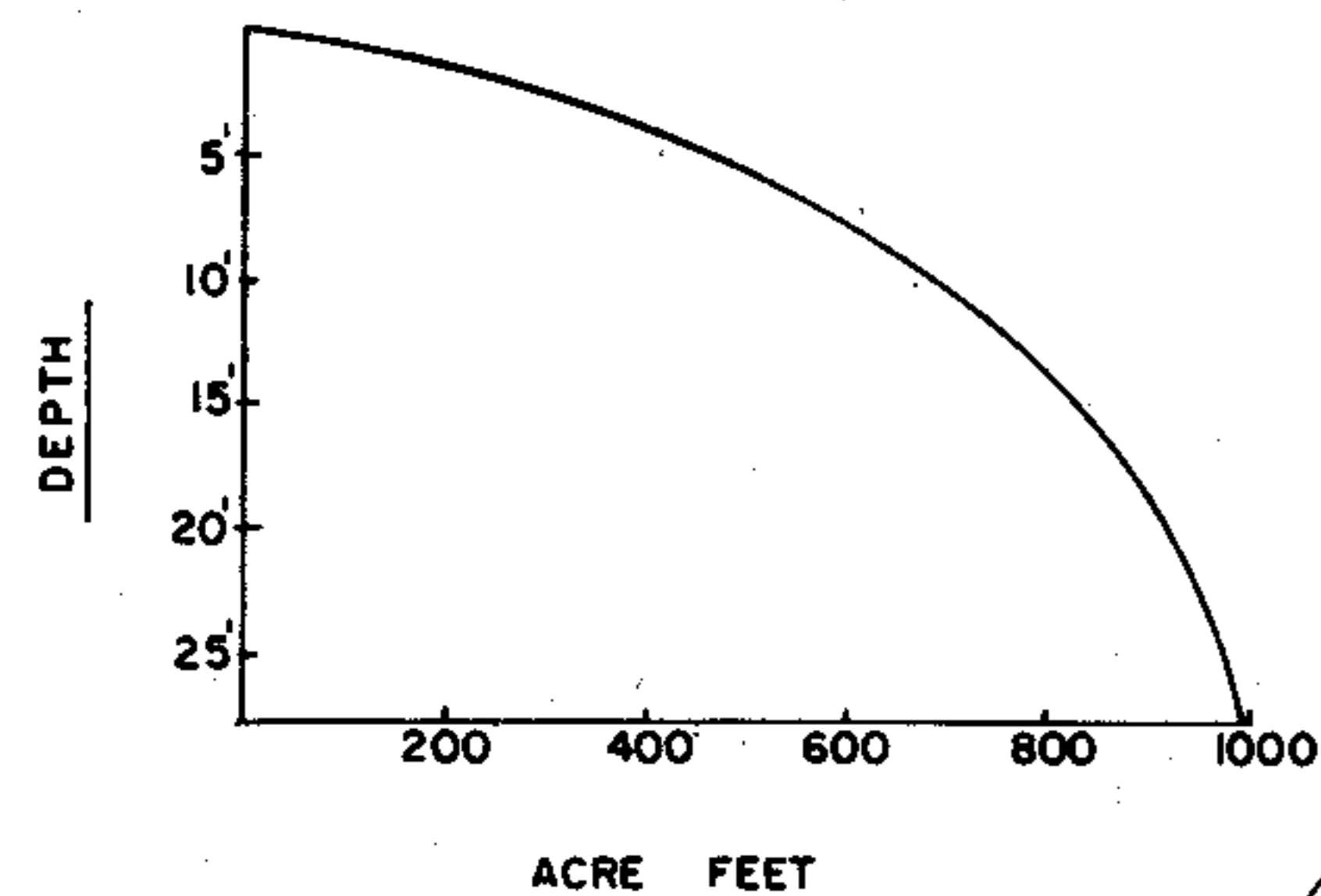

B.M. 'X', No. 1580-A, is the center of an entirely cut out 3" square in top of north end of concrete culvert under S.T.H.-48 on east side of water. Taken 9/17/69  
Assumed elevation = 100.00'  
Water level = 95.55'  
Highwater mark observed = 96.20

EQUIPMENT RECORDING SONAR MAPPED SEPT. 1969		MONTH YEAR	
TOPOGRAPHIC SYMBOLS		LAKE BOTTOM SYMBOLS	
(B) Brush	Steep slope	P. Peat	B. Boulders
(PW) Partially wooded	- - - Indefinite shoreline	Mk. Muck	o Stumps & Snags
(W) Wooded	Marsh	C. Clay	⊗ Rock danger to navigation
(C) Cleared	o Spring	M. Marl	T Submergent vegetation
(P) Pastured	--- Intermittent stream	Sd. Sand	⊥ Emergent vegetation
(A) Agricultural	==== Permanent inlet	St. Silt	⊥ Floating vegetation
B.M. Bench Mark	==== Permanent outlet	Gr. Gravel	⊥ Brush shelters
■ Dwelling	⊥ Dam	R. Rubble	
□ Resort	D.N.R. State owned land	Bc. Bedrock	
⊠ Camp			



Access Access with Parking Boat Livery  
Drawn by: T. Ginder  
Field work by: C. Busch, G. Lund, S. Johannes

SPECIES OF FISH	Abundance		
	Abundant	Common	Present
Muskie			
N. Pike			
Walleye			
L.M. Bass			X
S.M. Bass			
Panfish	X		
Trout			

WATER AREA 96.3 ACRES  
UNDER 3 FT. 13 %  
OVER 20 FT. 14 %  
MAX. DEPTH 28 FEET.  
TOTAL ALK. 27 P.P.M.  
VOLUME 992.3 ACRE FT.  
SHORELINE 2.93 MILES

Tamarack  
Leatherleaf  
Tagalder

Source: Wisconsin Department of Natural Resources 608-266-2621  
Lamont Lake – Polk County, Wisconsin DNR Lake Map  
Date – Sep 1969 - Historical Lake Map - Not for Navigation  
A Public Document - Please Identify the Source when using it.