

# LAKE SURVEY MAP

LAKE \_\_\_\_\_ SNAKE \_\_\_\_\_  
 SECTION \_\_\_\_\_ 19 \_\_\_\_\_  
 TOWNSHIP \_\_\_\_\_ 43 \_\_\_\_\_ N  
 RANGE \_\_\_\_\_ 10 \_\_\_\_\_ W  
 TOWN OF \_\_\_\_\_ WASCOTT \_\_\_\_\_  
 COUNTY \_\_\_\_\_ DOUGLAS \_\_\_\_\_ 18 17  
 19 20

WISCONSIN CONSERVATION DEPARTMENT  
 BIOLOGY DIVISION  
 LAKE AND STREAM IMPROVEMENT SECTION

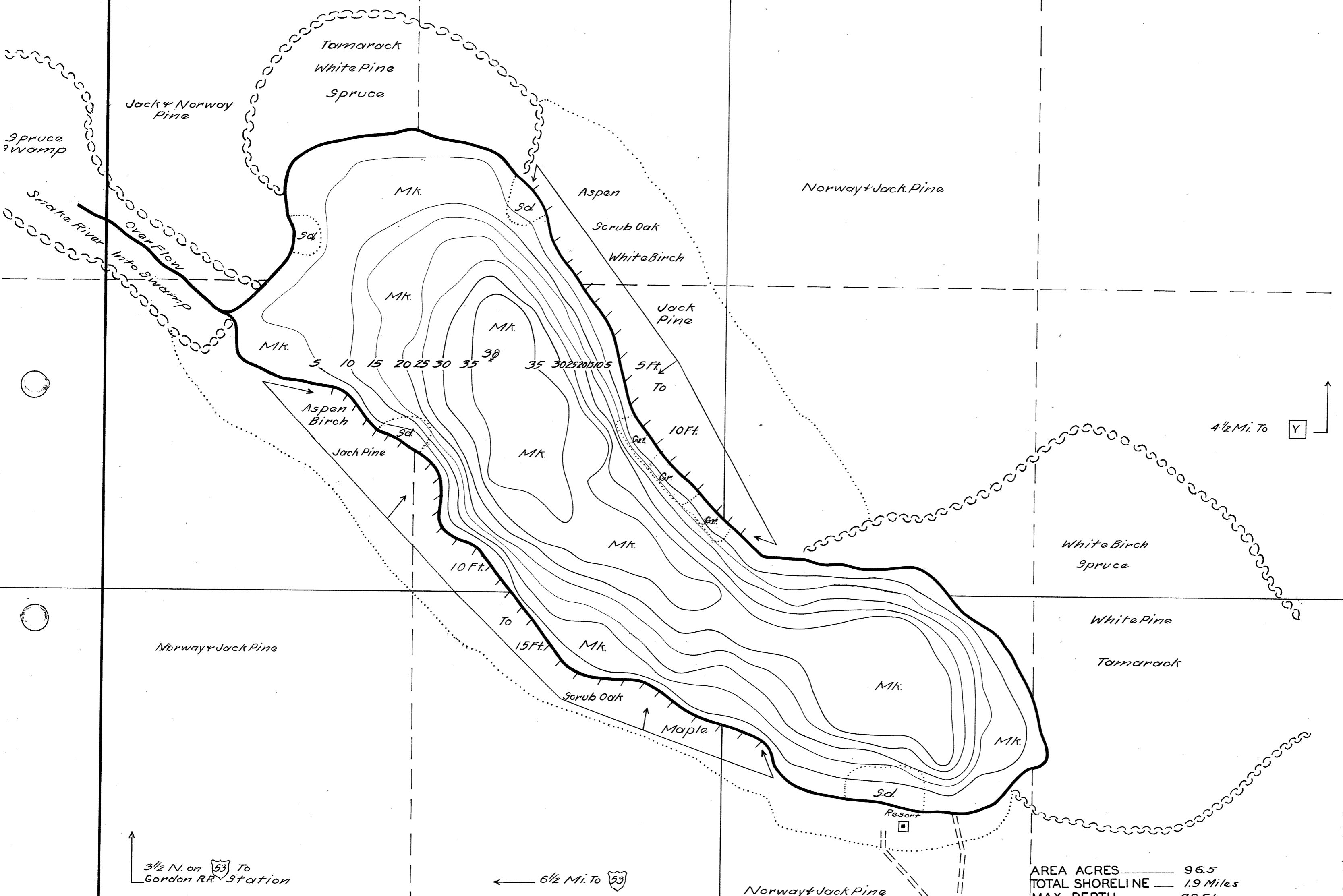

3 1/2 N. on 53 To  
Gordon RR Station

6 1/2 Mi. To 53

4 1/2 Mi. To Y

AREA ACRES \_\_\_\_\_ 96.5  
 TOTAL SHORELINE \_\_\_\_\_ 1.9 Miles  
 MAX. DEPTH \_\_\_\_\_ 38 Ft

DATE July 18, 1941  
 COMPILED BY \_\_\_\_\_  
 TRACED BY W.T.Z. (W.P.A.)  
 SOURCE OF INFORMATION \_\_\_\_\_  
W.P.A. Lake Survey Project  
 SOUNDINGS 16.5 Ft. intervals  
 DATE OF MAP REVISION \_\_\_\_\_  
 WORK AGENCY W.P.A.

### LAKE IMPROVEMENT RECORD

TYPE	DATE			
o BRUSH REFUGES				
~ SAPLING TANGLES				
□ SPAWNING BOXES				
* MINNOW SPAWNERS				
TOTAL				

SCALE 1 inch Equals 330 Ft.  
 0 100 200 300 400 500 Ft

- LEGEND
- WEED BEDS
  - ROCKY SHOALS
  - SAND
  - CLAY
  - GRAVEL
  - MUCK
  - DWELLING
  - ABANDONED DWELLING
  - RESORT
  - PRONOUNCED RIDGE

Source: Wisconsin Department of Natural Resources 608-266-2621  
Snake Lake - Douglas County, Wisconsin DNR Lake Map  
July 1941 Historical Lake Map - Not for Navigation  
A Public Document - Please Identify the Source when using it.