

EQUIPMENT RECORDING SONAR MAPPED JUNE 1963 MO. YR.

- TOPOGRAPHIC SYMBOLS
- (B) Brush
 - (PW) Partially wooded
 - (W) Wooded
 - (C) Cleared
 - (P) Pastured
 - (A) Agricultural
 - B.M. Bench Mark
 - Dwelling
 - Resort
 - ||||| Steep slope
 - - - Indefinite shoreline
 - Marsh
 - Spring
 - Intermittent stream
 - Permanent inlet
 - Permanent outlet
 - Dam
- LAKE BOTTOM SYMBOLS
- P. Peat
 - Mk. Muck
 - C. Clay
 - M. Marl
 - Sd. Sand
 - St. Silt
 - Gr. Gravel
 - R. Rubble
 - Br. Bedrock
 - T Submergent vegetation
 - ↑ Emergent vegetation
 - Floating vegetation
 - Stumps
- WATER ELEV. 110.60'

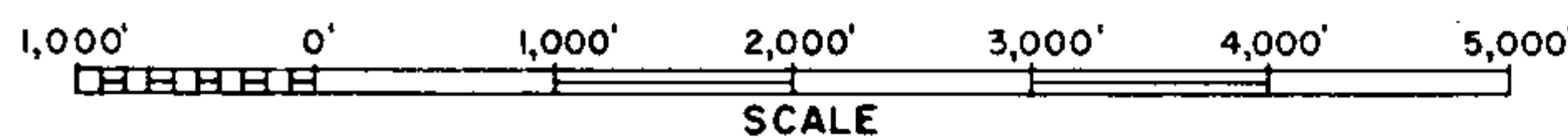

◇ Access ◇ Access with Parking ◆ Boat Livery

Field work by L.Sather R.Hopke M.Perkins Drawn by E.Eaton

SPECIES OF FISH		
	Abundant	Rare
Muskie		
N. Pike	X	
Walleye	X	
L.M. Bass	X	
S.M. Bass		
Panfish	X	
Trout		

3,072 WITH ISLANDS.
 AREA 2,502.6 ACRES
 UNDER 5 FT. 19 %
 OVER 20 FT. 2 %
 VOLUME 24,088.0 ACRE FT.
 TOTAL ALK. 23 P.P.M.
 SHORELINE 31.4 MILES
 MAX. DEPTH 33 FEET

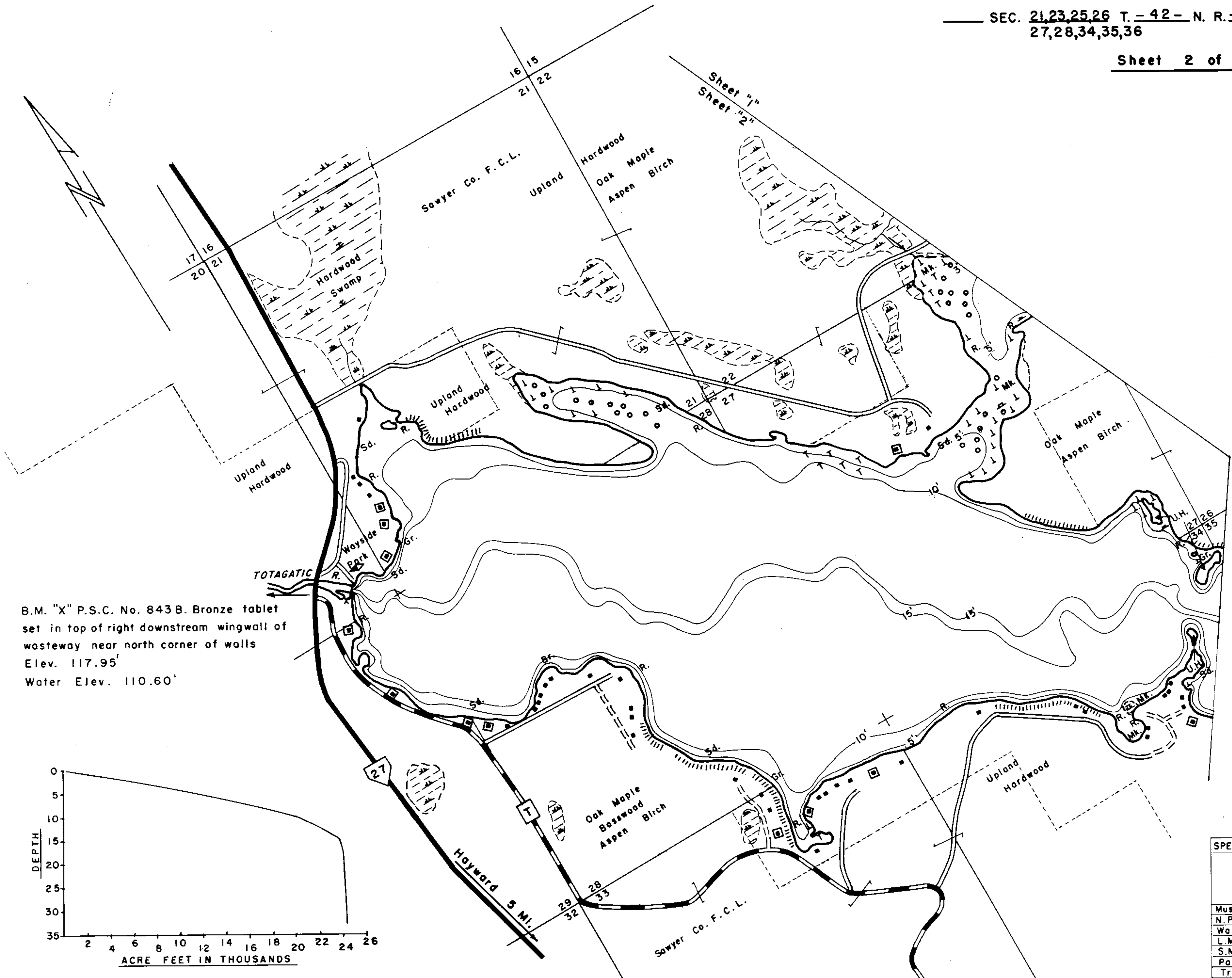

B.M. "X" P.S.C. No. 843 B. Bronze tablet set in top of right downstream wingwall of wasteway near north corner of walls Elev. 117.95' Water Elev. 110.60'

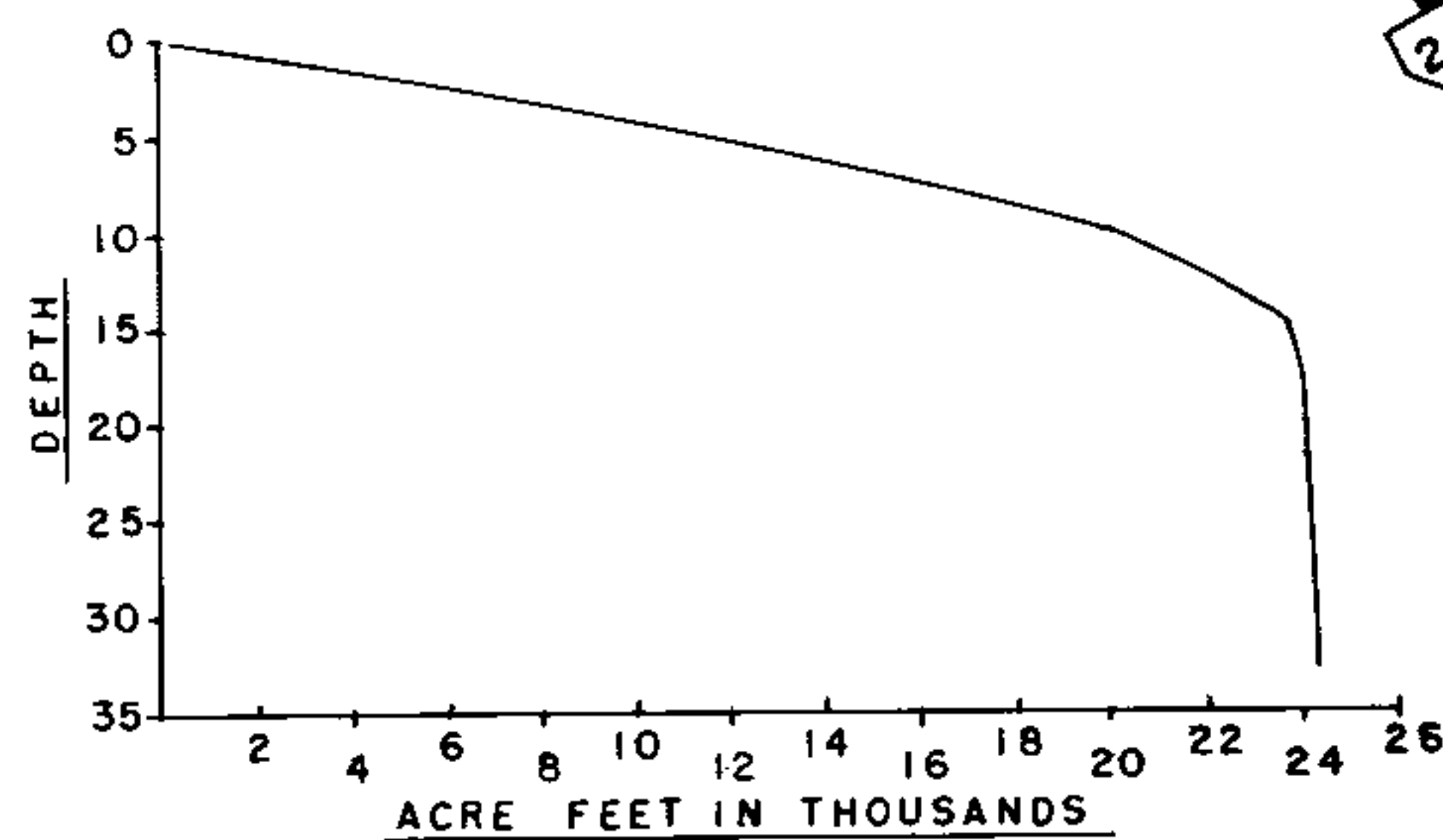

SPECIES OF FISH		
	Abundant	Rare
Muskie		
N. Pike	X	
Walleye	X	
L.M. Bass	X	
S.M. Bass		
Panfish	X	
Trout		

EQUIPMENT RECORDING SONAR MAPPED JUNE 1963 MO. YR.

- TOPOGRAPHIC SYMBOLS
- Brush
 - Partially wooded
 - Wooded
 - Cleared
 - Pastured
 - Agricultural
 - B.M. Bench Mark
 - Dwelling
 - Resort
 - Steep slope
 - Indefinite shoreline
 - Marsh
 - Spring
 - Intermittent stream
 - Permanent inlet
 - Permanent outlet
 - Dam

- LAKE BOTTOM SYMBOLS
- P. Peat
 - Mk. Muck
 - C. Clay
 - M. Marl
 - Sd. Sand
 - St. Silt
 - Gr. Gravel
 - R. Rubble
 - Br. Bedrock
 - T. Submergent vegetation
 - Emergent vegetation
 - Floating vegetation
 - Stumps

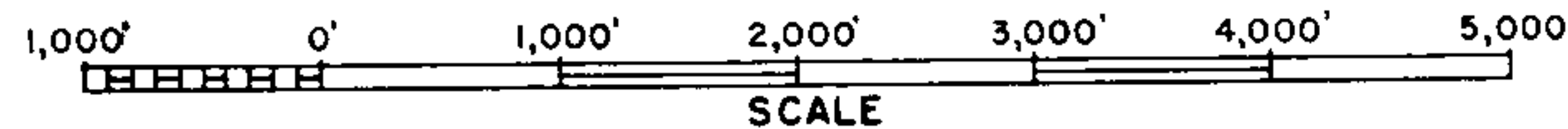

Access Access with Parking Boat Livery

Field work by L.Sather R.Hopke M.Perkins Drawn by E.Eaton

3,072. WITH ISLANDS
 AREA 2,502.6 ACRES
 UNDER 5 FT. 19 %
 OVER 20 FT. 2 %
 VOLUME 24,088.0 ACRE FT.
 TOTAL ALK. 23 P.P.M.
 SHORELINE 31.4 MILES
 MAX. DEPTH 33 FEET

Source: Wisconsin Department of Natural Resources 608-266-2621
Nelson Lake (Totagatic Flowage) – Sawyer County, Wisconsin DNR Lake Map
Date – Jun 1963 - Historical Lake Map - Not for Navigation
A Public Document - Please Identify the Source when using it.