

LAKE SURVEY MAP

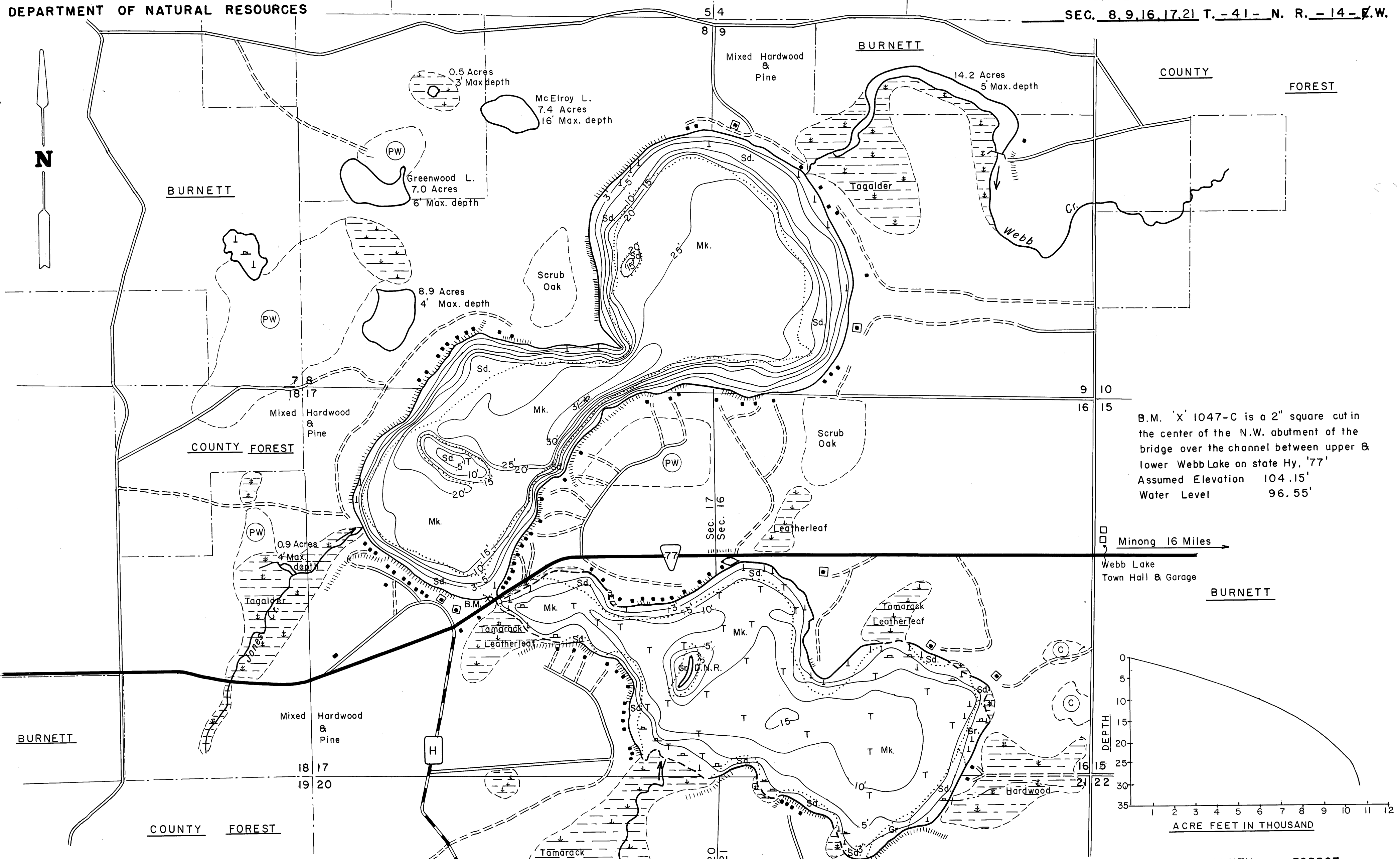

B.M. 'X' 1047-C is a 2" square cut in the center of the N.W. abutment of the bridge over the channel between upper & lower Webb Lake on state Hy. '77'
Assumed Elevation 104.15'
Water Level 96.55'

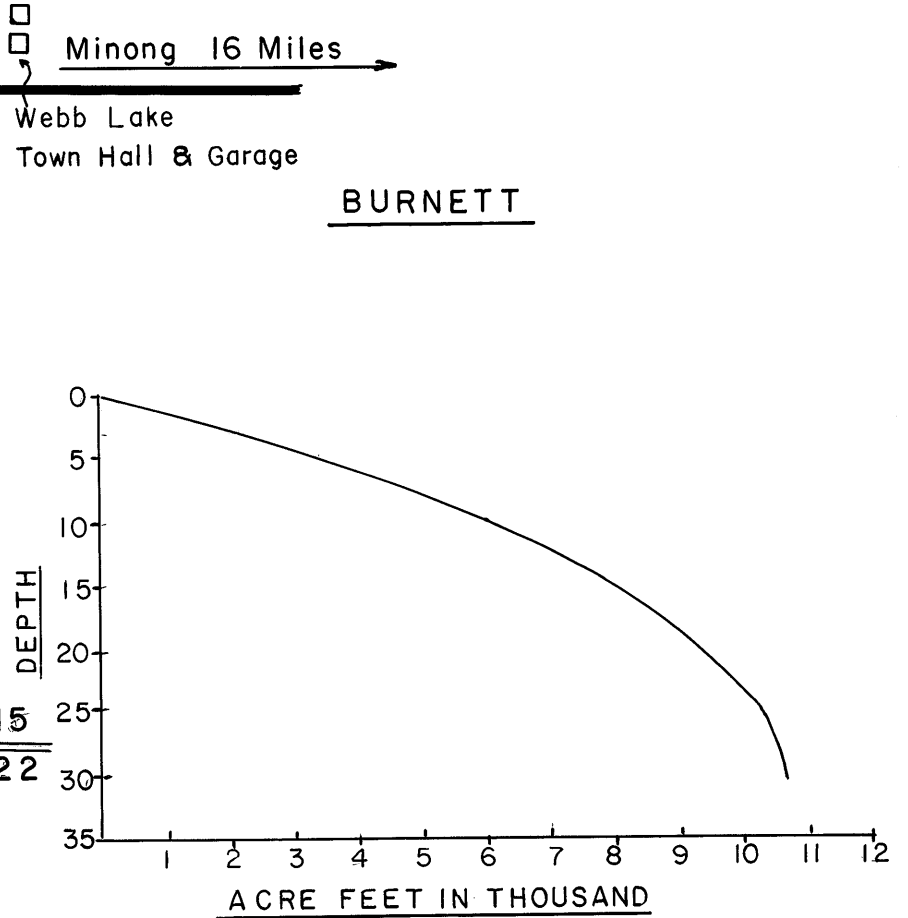

- EQUIPMENT RECORDING SONAR MAPPED JUNE 1973
- | TOPOGRAPHIC SYMBOLS | | LAKE BOTTOM SYMBOLS | |
|-----------------------|----------------------------|---------------------|-----------------------------|
| (B) Brush | Steep slope | P. Peat | B Boulders |
| (PW) Partially wooded | ----- Indefinite shoreline | Mk. Muck | o Stumps & Snags |
| (W) Wooded | ----- Marsh | C. Clay | ⚡ Rock danger to navigation |
| (C) Cleared | o Spring | M. Marl | T Submergent vegetation |
| (P) Pastured | ----- Intermittent stream | Sd. Sand | ⊥ Emergent vegetation |
| (A) Agricultural | ----- Permanent inlet | St. Silt | ⊥ Floating vegetation |
| B.M. Bench Mark | ----- Permanent outlet | Gr. Gravel | ⊥ Brush shelters |
| ■ Dwelling | ⊥ Dam | R. Rubble | |
| □ Resort | D.N.R. State owned land | Br. Bedrock | |
| □ Camp | | | |

SPECIES OF FISH	Abundance		
	Abundant	Common	Present
Muskie			
N. Pike		X	
Walleye			X
L.M. Bass	X		
S.M. Bass			
Panfish	X		
Trout			

WATER AREA 761.8 ACRES
 UNDER 3 FT. 12 %
 OVER 20 FT. 33 %
 MAX. DEPTH 31 FEET.
 TOTAL ALK. 6 P.P.M.
 VOLUME 10,609.2 ACRE FT.
 MAIN SHORELINE 7.65 MI.
 ISLAND SHORELINE .17 MI.

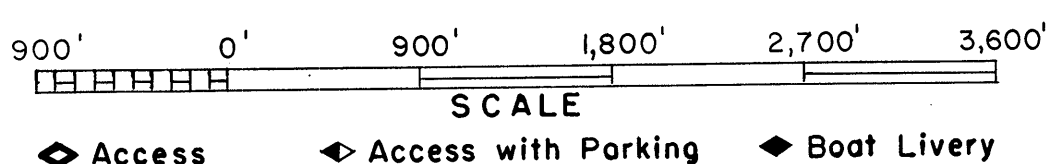

◆ Access ◀ Access with Parking ◆ Boat Livery
 Drawn by: E. Eaton
 Field work by: C. Busch, G. Lund, K. Cable, L. Sather

Source: Wisconsin Department of Natural Resources 608-266-2621
Webb Lake – Burnett County, Wisconsin DNR Lake Map
Date – Jun 1973 - Historical Lake Map - Not for Navigation
A Public Document - Please Identify the Source when using it.