

LAKE SURVEY MAP

TRANUS LAKE
SEC. 19, 30 T. 41 N. R. 10 W.

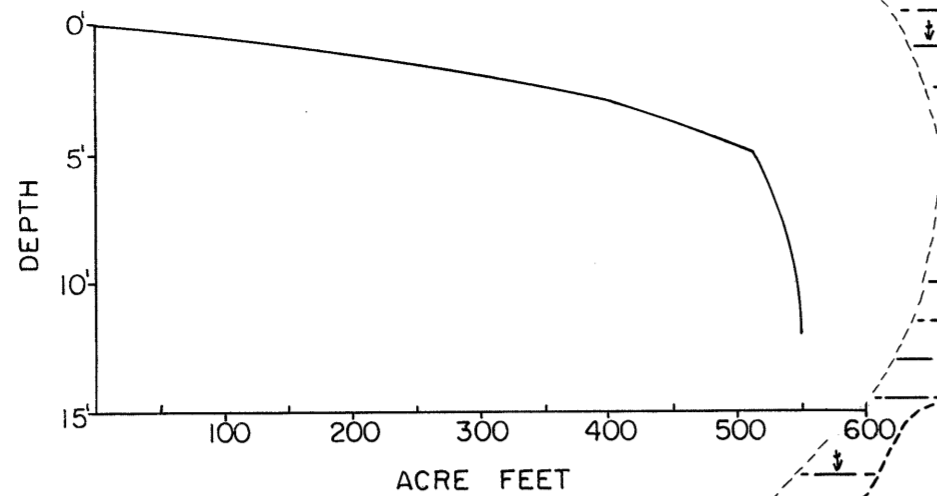
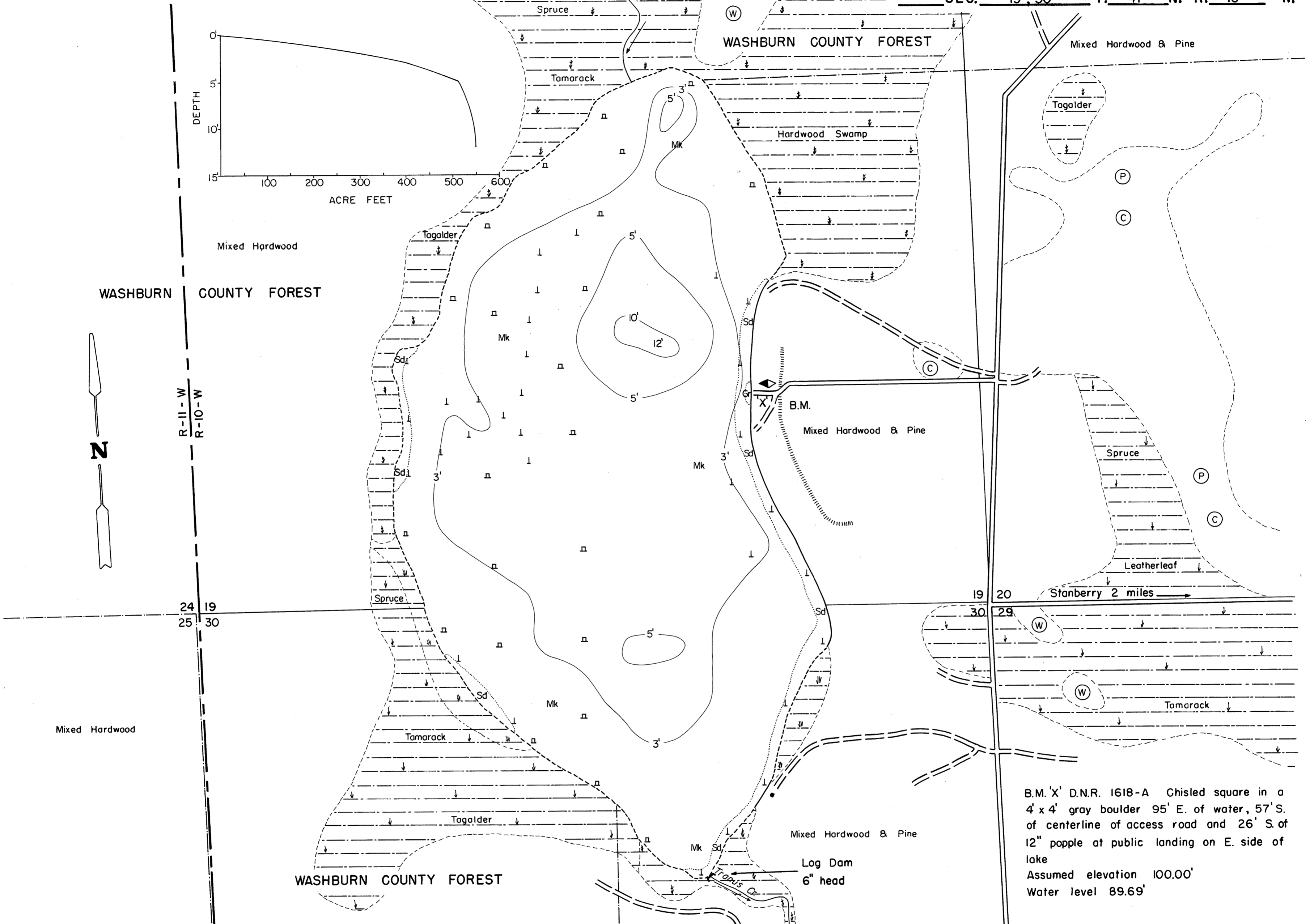

B.M. 'X' D.N.R. 1618-A Chisled square in a 4' x 4' gray boulder 95' E. of water, 57' S. of centerline of access road and 26' S. of 12" popple at public landing on E. side of lake
Assumed elevation 100.00'
Water level 89.69'

EQUIPMENT RECORDING SONAR MAPPED JUNE 1971

- TOPOGRAPHIC SYMBOLS**
- (B) Brush
 - (PW) Partially wooded
 - (W) Wooded
 - (C) Cleared
 - (P) Pastured
 - (A) Agricultural
 - B.M. Bench Mark
 - Dwelling
 - Resort
 - Camp

- LAKE BOTTOM SYMBOLS**
- P. Peat
 - Mk. Muck
 - C. Clay
 - M. Marl
 - Sd. Sand
 - St. Silt
 - Gr. Gravel
 - R. Rubble
 - Br. Bedrock
 - B Boulders
 - Stumps & Snags
 - Rock danger to navigation
 - T Submergent vegetation
 - Emergent vegetation
 - Floating vegetation
 - Brush shelters

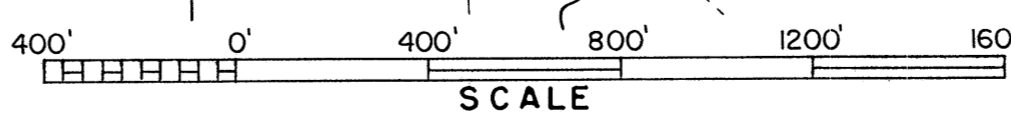

Access Access with Parking Boat Livery
Drawn by: C. Holt
Field work by: C. Busch, G. Lund, L. Sather

SPECIES OF FISH	Abundance		
	Abundant	Common	Present
Winterkill			
Muskie			X
N. Pike			X
Walleye			X
L.M. Bass			X
S.M. Bass			X
Panfish	X		
Trout			

WATER AREA 174.7 ACRES
 UNDER 3 FT. 45 %
 OVER 20 FT. 0 %
 MAX. DEPTH 12 FEET.
 TOTAL ALK. 44 P.P.M.
 VOLUME 550 ACRE FT.
 SHORELINE 2.21 MILES

Source: Wisconsin Department of Natural Resources 608-266-2621
Tranus Lake - Washburn County, Wisconsin DNR Lake Map
Date – Jun 1971 - Historical Lake Map - Not for Navigation
A Public Document - Please Identify the Source when using it.