

LAKE SURVEY MAP

UPPER OX LAKE DOUGLAS COUNTY
SEC. 14 T. 44 N. R. 11 W.

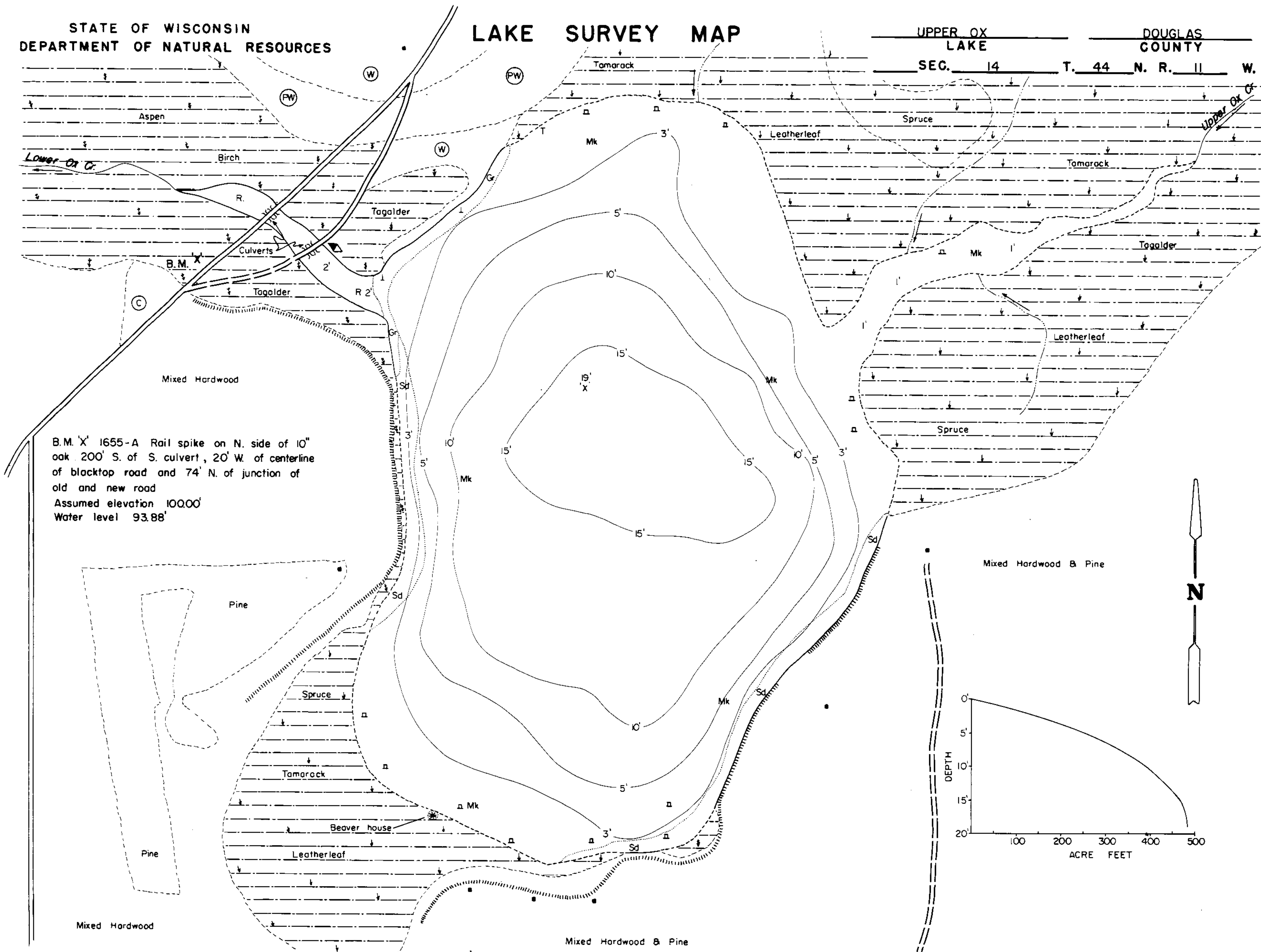

B.M. X' 1655-A Rail spike on N. side of 10" oak 200' S. of S. culvert, 20' W. of centerline of blacktop road and 74' N. of junction of old and new road
Assumed elevation 10000'
Water level 93.88'

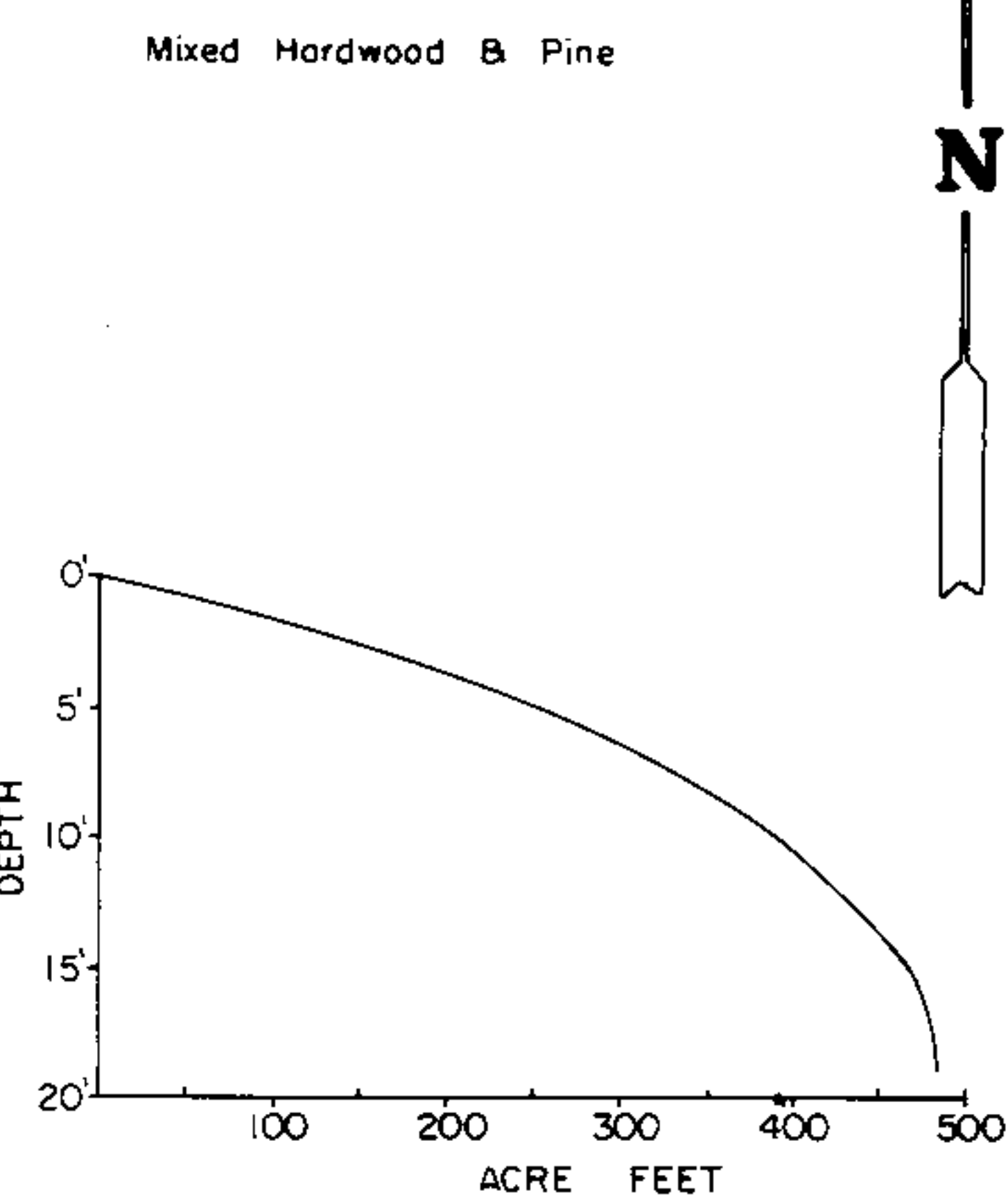

EQUIPMENT RECORDING SONAR MAPPED MAY 1971

TOPOGRAPHIC SYMBOLS		LAKE BOTTOM SYMBOLS	
(B) Brush	Steep slope	P. Peat	B Boulders
(PW) Partially wooded	~ Indefinite shoreline	Mk. Muck	o Stumps & Snags
(W) Wooded	~ Marsh	C. Clay	⊗ Rock danger to navigation
(C) Cleared	~ Spring	M. Marl	T Submergent vegetation
(P) Pastured	~ Intermittent stream	Sd. Sand	⊥ Emergent vegetation
(A) Agricultural	~ Permanent inlet	St. Silt	⊠ Floating vegetation
B.M. Bench Mark	~ Permanent outlet	Gr. Gravel	⊕ Brush shelters
■ Dwelling	~ Dam	R. Rubble	
□ Resort	D.N.R. State owned land	Br. Bedrock	
□ Camp			

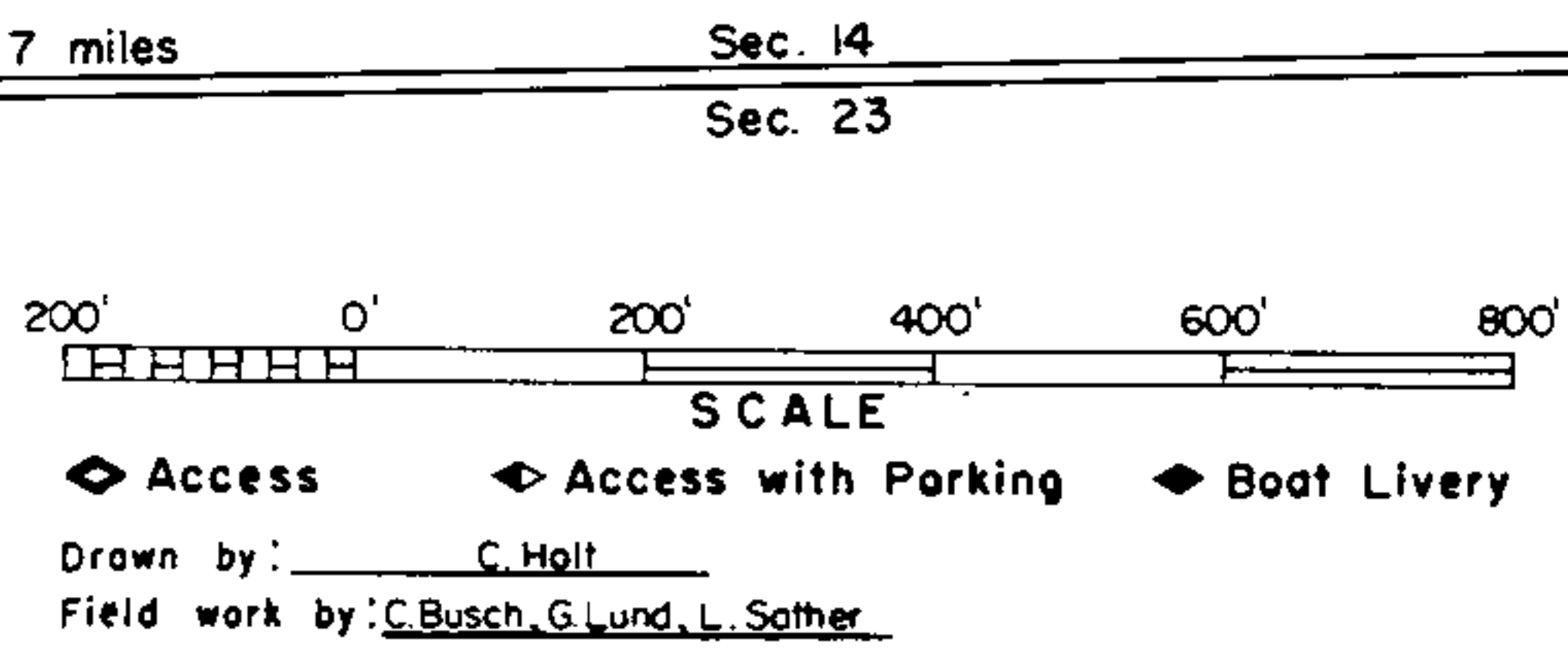

SPECIES OF FISH	Abundance		
	Abundant	Common	Present
Muskie			
N. Pike		X	
Walleye			
L. M. Bass	X		
S. M. Bass			
Panfish	X		
Trout			

WATER AREA 63.8 ACRES
UNDER 3 FT. 275 %
OVER 20 FT. 0 %
MAX. DEPTH 19 FEET.
TOTAL ALK. 114 P.P.M.
VOLUME 482 ACRE FT.
SHORELINE 1.76 MILES

Source: Wisconsin Department of Natural Resources 608-266-2621
Upper Ox Lake – Douglas County, Wisconsin DNR Lake Map
Date – May 1971- Historical Lake Map - Not for Navigation
A Public Document - Please Identify the Source when using it.