

LAKE SURVEY MAP

HEWITT LAKE IRON COUNTY
SEC. 10, 15 T. 44 N. R. 4 E.

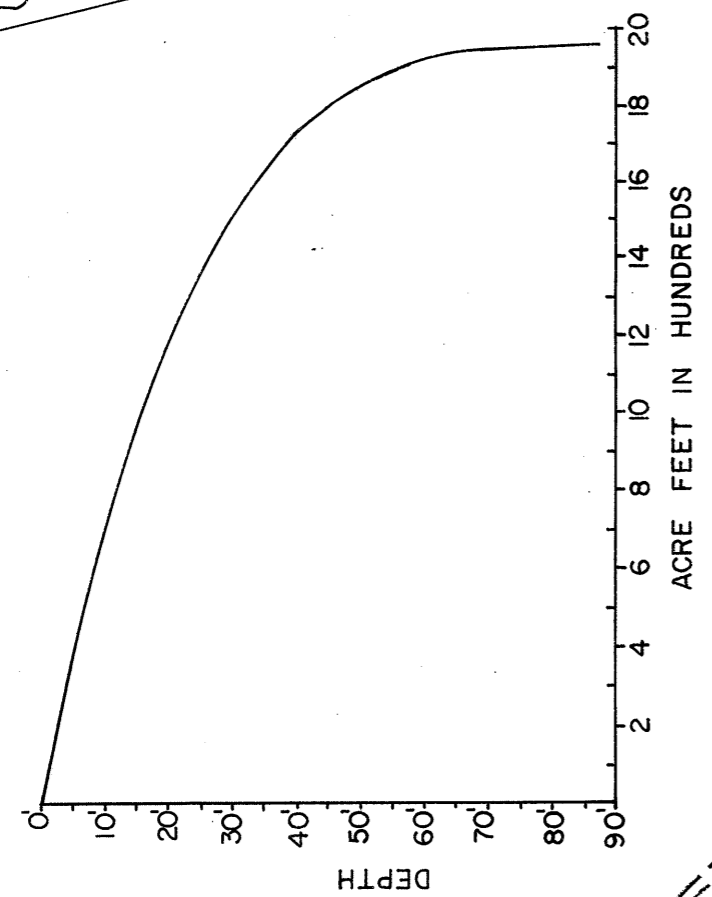

Department of Natural Resources Bench Mark 1744-A.
Railroad spike set in maple tree 14' from center of road
and 29.4' from lakeshore
Assumed Elevation 100.00'
Water Elevation 95.15' (July 1970)

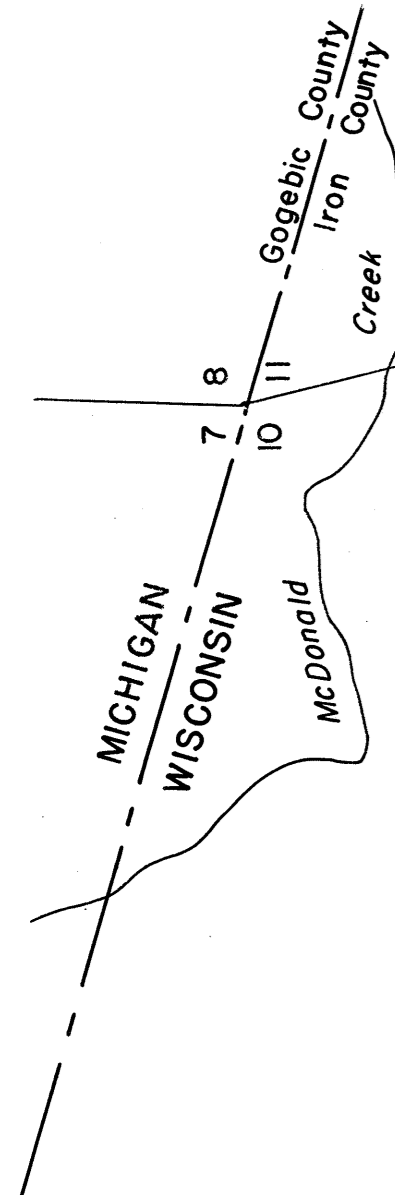
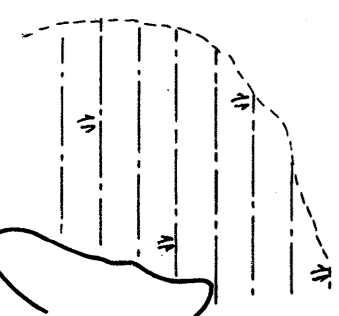
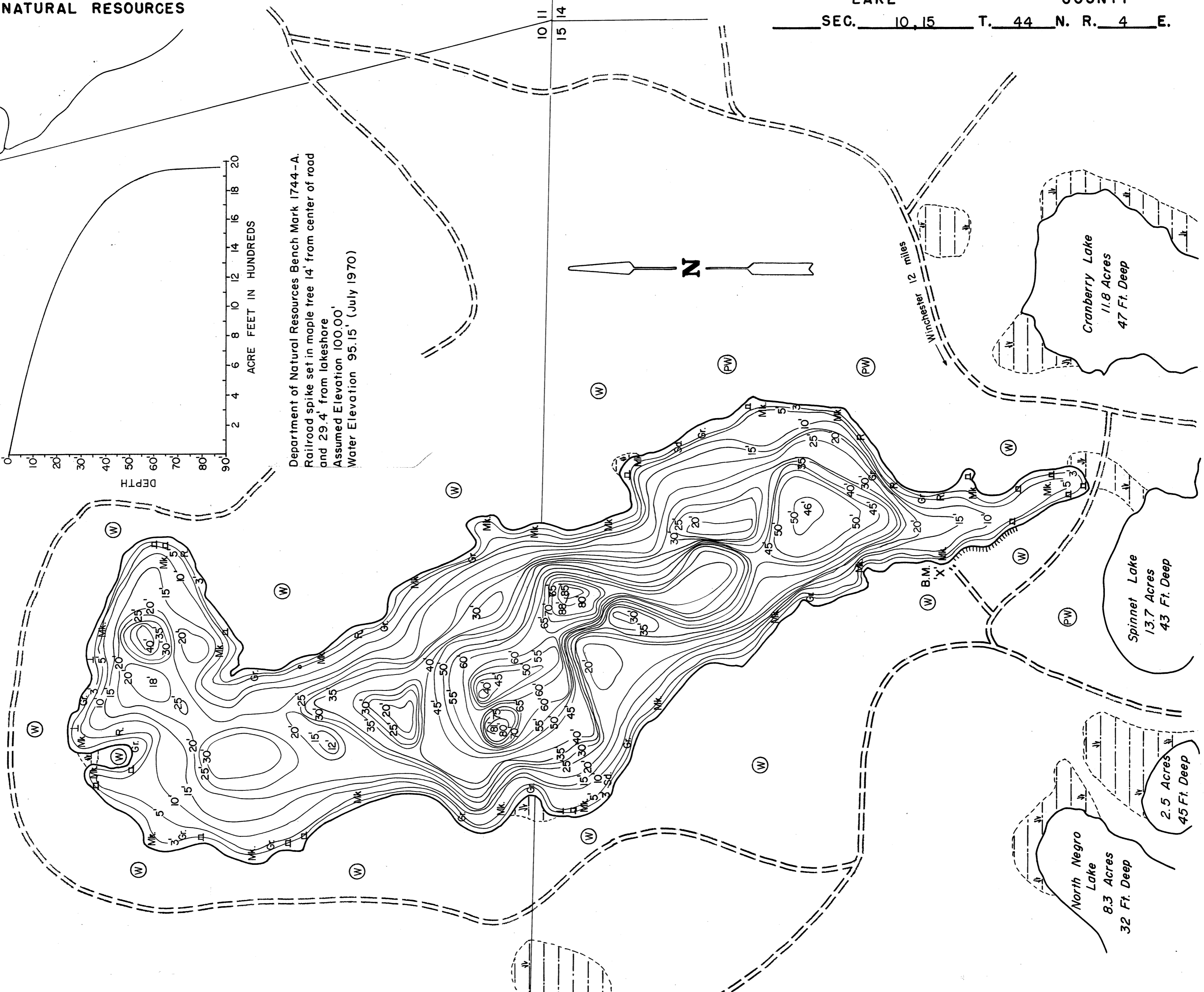
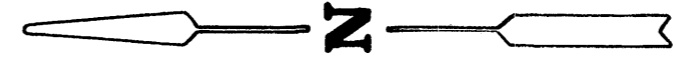

EQUIPMENT RECORDING SONAR MAPPED SEPT 1968
MONTH YEAR

- TOPOGRAPHIC SYMBOLS**
- (B) Brush
 - (PW) Partially wooded
 - (W) Wooded
 - (C) Cleared
 - (P) Pastured
 - (A) Agricultural
 - B.M. Bench Mark
 - Dwelling
 - Resort
 - Camp
 - ||||| Steep slope
 - ~ Indefinite shoreline
 - Marsh
 - Spring
 - Intermittent stream
 - Permanent inlet
 - Permanent outlet
 - Dam
 - D.N.R. State owned land

- LAKE BOTTOM SYMBOLS**
- P. Peat
 - Mk. Muck
 - C. Clay
 - M. Marl
 - Sd. Sand
 - St. Silt
 - Gr. Gravel
 - R. Rubble
 - Br. Bedrock
 - B Boulders
 - Stumps & Snags
 - Rock danger to navigation
 - Submergent vegetation
 - Emergent vegetation
 - Floating vegetation
 - Brush shelters



◆ Access ◆ Access with Parking ◆ Boat Livery

Drawn by: C. Holt
Field work by: P. Michelson, J. Smith

SPECIES OF FISH	Abundance		
	Abundant	Common	Present
Muskie		X	
N. Pike		X	
Walleye			X
L.M. Bass			X
S.M. Bass			X
Panfish			X
Trout			

WATER AREA 77.9 ACRES
 UNDER 3 FT. 8 %
 OVER 20 FT. 56 %
 MAX. DEPTH 88 FEET.
 TOTAL ALK. 7 P.P.M.
 VOLUME 1959.8 ACRE FT.
 SHORELINE 2.3 MILES

Source: Wisconsin Department of Natural Resources 608-266-2621
Hewitt Lake- Iron County, Wisconsin DNR Lake Map
Date Sep 1968 - Historical Lake Map - Not for Navigation
A Public Document - Please Identify the Source when using it.