

# LAKE SURVEY MAP

AMMICON LAKE  
426 acres  
31' max. depth

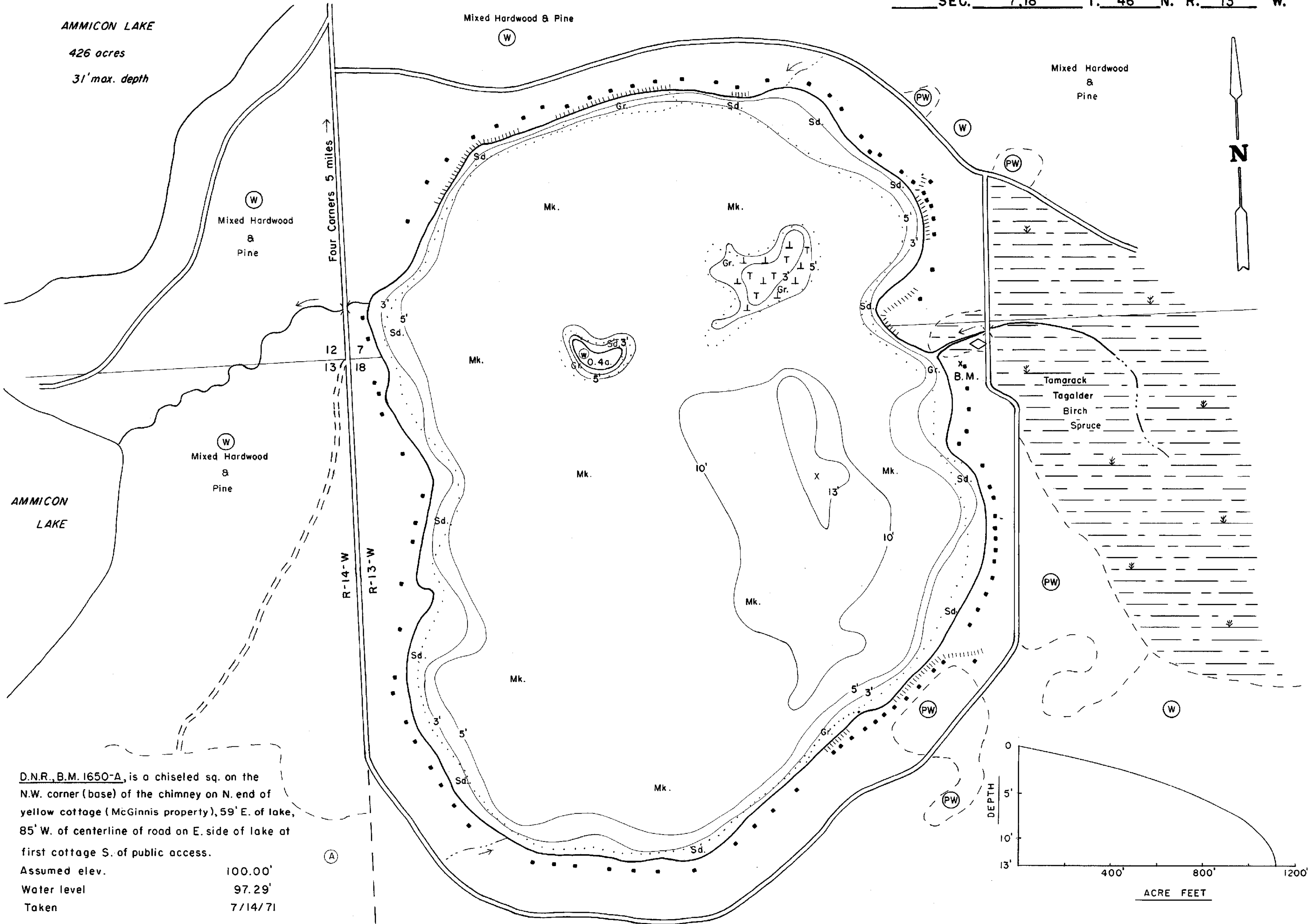

D.N.R. B.M. 1650-A, is a chiseled sq. on the N.W. corner (base) of the chimney on N. end of yellow cottage (McGinnis property), 59' E. of lake, 85' W. of centerline of road on E. side of lake at first cottage S. of public access.

Assumed elev. 100.00'  
Water level 97.29'  
Taken 7/14/71

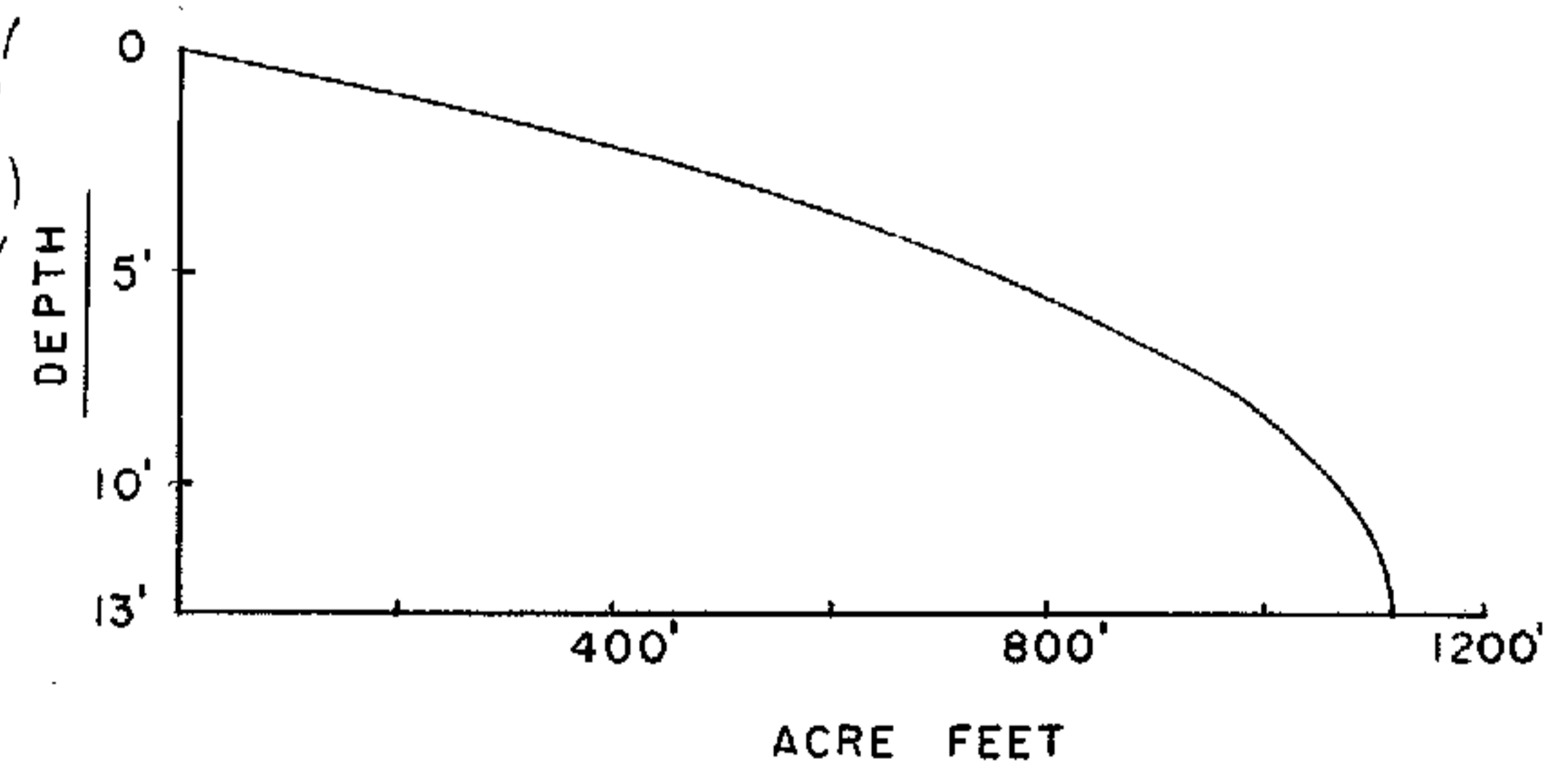

EQUIPMENT RECORDING SONAR MAPPED JULY 1971

TOPOGRAPHIC SYMBOLS

(B) Brush	Steep slope
(PW) Partially wooded	- - - Indefinite shoreline
(W) Wooded	Marsh
(C) Cleared	Spring
(P) Pastured	Intermittent stream
(A) Agricultural	Permanent inlet
B.M. Bench Mark	Permanent outlet
■ Dwelling	Dam
■ Resort	D.N.R. State owned land
■ Camp	

LAKE BOTTOM SYMBOLS

P. Peat	B Boulders
Mk. Muck	⊙ Stumps & Snags
C. Clay	⊙ Rock danger to navigation
M. Marl	T Submergent vegetation
Sd. Sand	⊥ Emergent vegetation
St. Silt	Floating vegetation
Gr. Gravel	Brush shelters
R. Rubble	
Br. Bedrock	



Access Access with Parking Boat Livery  
 Drawn by: T. Ginder  
 Field work by: C. Busch, G. Lund, & L. Sather

SPECIES OF FISH

	Abundant	Common	Present
Muskie		X	
N. Pike		X	
Walleye		X	
L.M. Bass			X
S.M. Bass			X
Panfish		X	
Trout			

WATER AREA 153.8 ACRES  
 UNDER 3 FT. 8 %  
 OVER 20 FT. 0 %  
 MAX. DEPTH 13 FEET.  
 TOTAL ALK. 22 P.P.M.  
 VOLUME 1113.3 ACRE FT.  
 SHORELINE 1.95 MILES  
 WITH ISLAND 2.06 MILES

Source: Wisconsin Department of Natural Resources 608-266-2621  
Dowling Lake – Douglas County, Wisconsin DNR Lake Map  
Date – Jul 1971- Historical Lake Map - Not for Navigation  
A Public Document - Please Identify the Source when using it.